

C-101/K-101.18

**NEW MEXICO OIL CONSERVATION COMMISSION
WELL LOCATION AND ACREAGE DEDICATION PLAT**

Form C-102
Supersedes C-128
Effective 1-1-65

All distances must be from the outer boundaries of the Section

| | | | | | |
|--|---|-----------------------------|---|----------------------|--------------------------------------|
| Operator Phillips Petroleum Co. | | | Lease Leamex | | Well No. 45 |
| Grid Letter D | Section 23 | Township 17 South | Range 33 East | County Lea | |
| Actual Surface Location of Well: 660 feet from the North line and 660 feet from the West line | | | | | |
| Ground Elev. Elev. 4142.9 | Producing Formation Grayburg-San Andres | | Pool Maljamar-Grayburg/San Andres | | Dedicated Acreage 40 Acres |

- 1 Outline the acreage dedicated to the subject well by colored pencil or hatchure marks on the plat below.
- 2 If more than one lease is dedicated to the well, outline each and identify the ownership thereof (both as to working interest and royalty).
- 3 If more than one lease of different ownership is dedicated to the well, have the interests of all owners been consolidated by communitization, unitization, force-pooling, etc?

☐ Yes ☐ No If answer is "yes," type of consolidation _____

If answer is "no," list the owners and tract descriptions which have actually been consolidated. (Use reverse side of this form if necessary.) _____

No allowable will be assigned to the well until all interests have been consolidated (by communitization, unitization, forced-pooling, or otherwise) or until a non-standard unit, eliminating such interests, has been approved by the Commission.

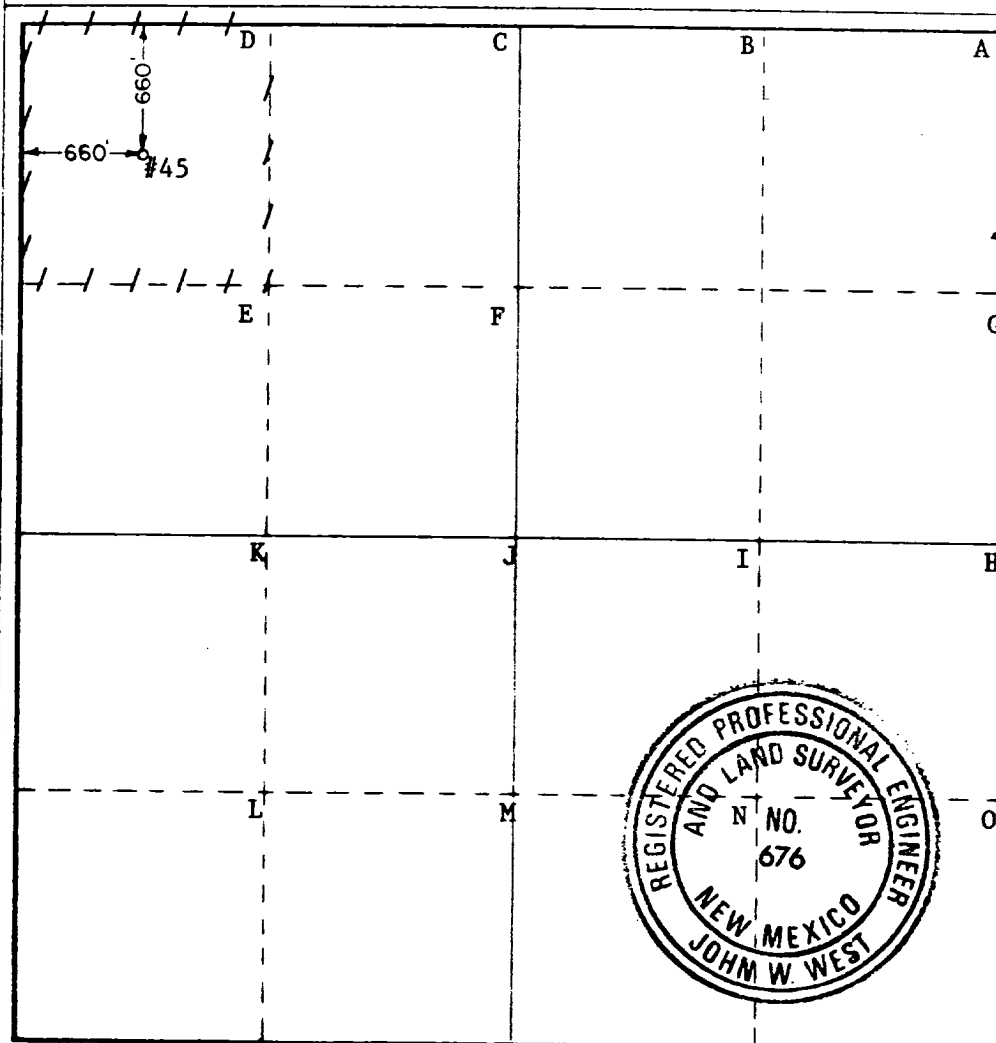

CERTIFICATION

I hereby certify that the information contained herein is true and complete to the best of my knowledge and belief.

[Signature]
Name
W. J. Mueller

Position
Engineering Supervisor, Reserv.

Company
Phillips Petroleum Company

Date
September 23, 1987

I hereby certify that the well location shown on this plat was plotted from field notes of actual surveys made by me or under my supervision, and that the same is true and correct to the best of my knowledge and belief.

Date Surveyed
August 27, 1987

Registered Professional Engineer and/or Land Surveyor

[Signature]
Certificate No. **JOHN W. WEST, 676**

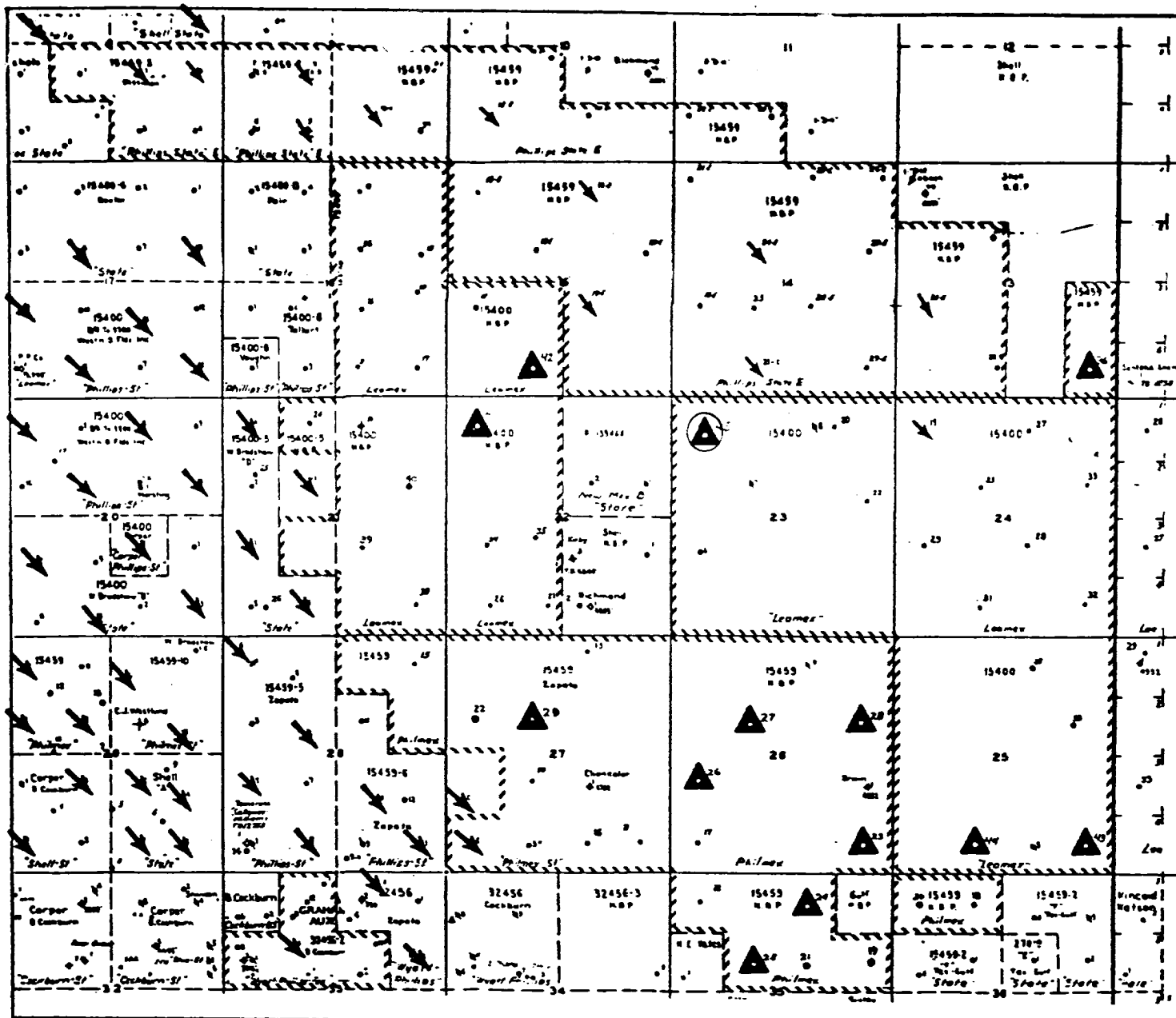

Existing Injector



PHILLIPS PETROLEUM COMPANY

Leamex Lease

Phillips E State Lease

Philmex Lease

Wyatt A Federal Lease

Maljamar Waterfloods
Lea County, New Mexico

New Well Location



0 2000' 4000'
SCALE

NOTE: Any existing wells contained within quarter-quarter section of proposed new well are operated by Phillips Petroleum Company.

FIELD PRACTICES AND STANDARDS

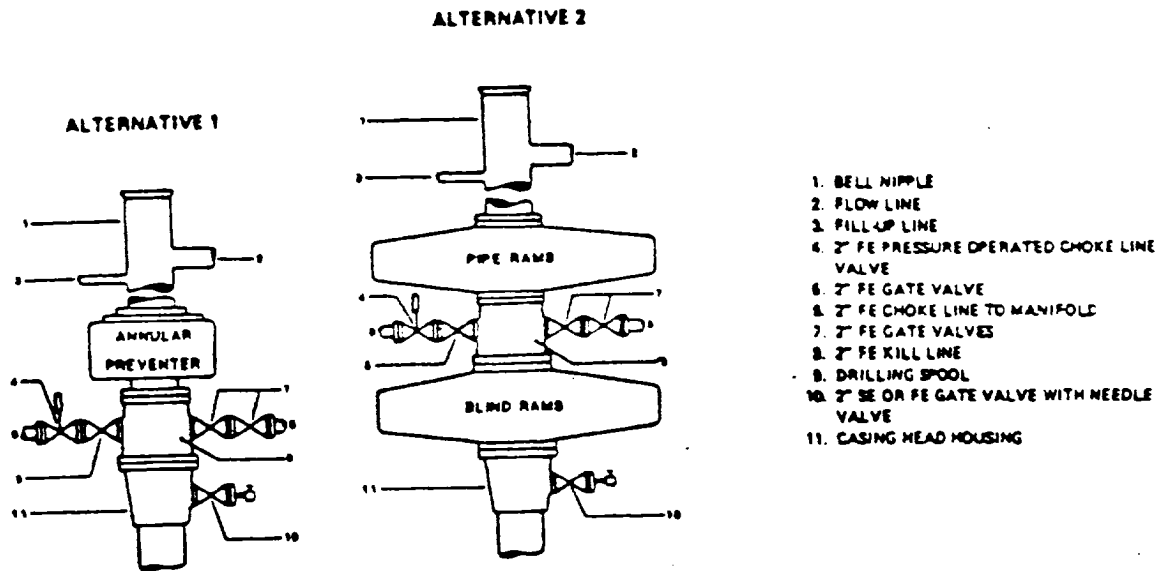

NOTE: THE DRILLING SPOOL MAY BE LOCATED BELOW BOTH SETS OF RAMS IF A DOUBLE PREVENTER IS USED AND IT DOES NOT HAVE SUITABLE OUTLETS BETWEEN RAMS

Figure 7-9. Standard Hydraulic Blowout Preventer Assembly
(2 M or 3 M Working Pressure) Alternative 1

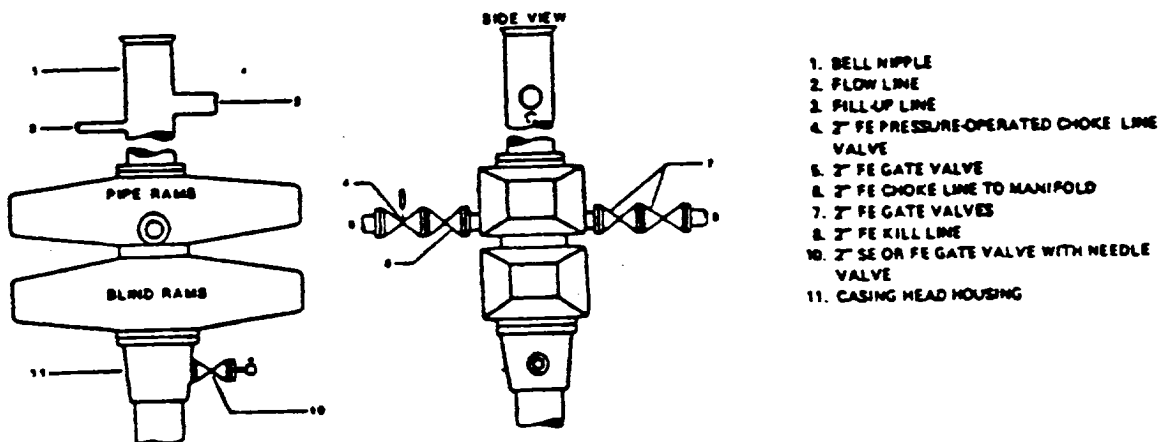

Figure 7-10. Standard Hydraulic Blowout Preventer Assembly
(2 M or 3 M Working Pressure) Alternative 3 (without Drilling Spool)