

BASIN DRILLING CORP.

650 LAKE POINTE TOWERS WEST • 4013 NORTHWEST EXPRESSWAY • OKLAHOMA CITY, OKLA. 73118 (405) 840-2911

BASIN DRILLING CORP.

DEVIATION SURVEY

TEXACO INC. - S.A. BOWMAN FEDERAL #4

Section 29-19S-32E, Lea County, NM

<u>DATE</u>	<u>DEPTH</u>	<u>DEGREE</u>
12/01/87	500'	1/2
12/09/87	928'	3/4
12/10/87	1,405'	1/2
12/10/87	1,905'	2
12/11/87	2,159'	3
12/11/87	2,254'	3
12/11/87	2,442'	2 3/4
12/13/87	2,944'	2
12/17/87	3,818'	1
12/18/87	4,309'	1/2
12/18/87	4,822'	1/2
12/19/87	5,320'	3/4
12/19/87	5,810'	3/4
12/21/87	6,850'	1

SIGNED BY:

Pete Martin

TITLE: Drilling Cost Analyst

CORPORATION ACKNOWLEDGMENT

STATE OF OKLAHOMA)
) SS.
COUNTY OF CANADIAN)

On this 3rd day of February, 1988, before me, the undersigned, a Notary Public, in and for the County and State aforesaid, personally appeared Pete Martin to me known to be the identical person who signed the name of the maker thereof to the within and foregoing instrument as its Drilling Cost Analyst and acknowledge to me that he executed and same as his free and voluntary act and deed of said corporation, for the uses and purposes therein set forth.

Given under my hand and seal the day and year last above written.



My Commission Expires:
11/18/90

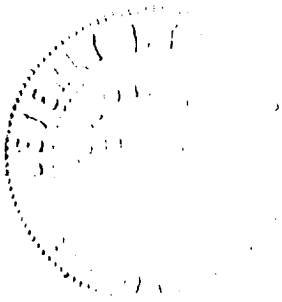

UNITED STATES
DEPARTMENT OF THE INTERIOR
BUREAU OF LAND MANAGEMENT

SUBMIT IN TRIPLICATE
(Other instructions on reverse side)

Budget Bureau No. 1004-0110
Expires August 31, 1985

5. LEASE DESIGNATION AND SERIAL NO.

LC-063586

6. IF INDIAN, ALLOTTEE OR TRIBE NAME

7. UNIT AGREEMENT NAME

8. FARM OR LEASE NAME

S. A. Bowman Federal

9. WELL NO.

4

10. FIELD AND POOL OR WILDCAT

Lusk Delaware, West

11. SEC., T., R., M., OR BLK. AND SURVEY OR AREA

Sec. 29, 19S, 32E

12. COUNTY OR PARISH 13. STATE

Lea

NM

SUNDRY NOTICES AND REPORTS ON WELLS

(Do not use this form for proposals to drill or to deepen or plug back to a different reservoir. Use "APPLICATION FOR PERMIT—" for such proposals.)

1

OIL WELL ☒ GAS WELL ☐ OTHER ☐

2. NAME OF OPERATOR

Texaco Inc.

3. ADDRESS OF OPERATOR

PO Box 728, Hobbs, New Mexico 88240

4. LOCATION OF WELL (Report location clearly and in accordance with any State requirements.* See also space 17 below.)

At surface

Unit Letter N, 990' FSL and 1659' FWL

14. PERMIT NO.

30-025-30164

15. ELEVATIONS (Show whether DF, RT, GR, etc.)

3564' KB 3552' GR

16. Check Appropriate Box To Indicate Nature of Notice, Report, or Other Data

NOTICE OF INTENTION TO:

TEST WATER SHUT-OFF

FRACTURE TREAT

SHOOT OR ACIDIZE

REPAIR WELL

(Other)

PULL OR ALTER CASING

MULTIPLE COMPLETE

ABANDON*

CHANGE PLANS

SUBSEQUENT REPORT OF:

WATER SHUT-OFF

FRACTURE TREATMENT

SHOOTING OR ACIDIZING

(Other)

REPAIRING WELL

ALTERING CASING

ABANDONMENT*

Completion ☒

(NOTE: Report results of multiple completion on Well Completion or Recompletion Report and Log form.)

17. DESCRIBE PROPOSED OR COMPLETED OPERATIONS (Clearly state all pertinent details, and give pertinent dates, including estimated date of starting any proposed work. If well is directionally drilled, give subsurface locations and measured and true vertical depths for all markers and zones pertinent to this work.)*

- 1) MIRU pulling unit. Install BOP. Drill out cement and DV tool at 3690'. Test DV tool to 1500 psig-OK. Drill cement from 6465'-6650'. PBTD 6650'. Test 5 1/2" casing to 1500 psig from 11:30 PM to 12:00 Midnight, 12/30/87.
- 2) Spot 10% acetic acid from 6250'-6450'. Run GR-CCL from 6000'-6545'.
- 3) Perforate the 5 1/2" casing with 2 JSPF, 33/8" casing guns, from 6428'-6439' (24 holes).
- 4) RIH with packer and 2 7/8" tubing. Set packer at 6292'. Acidize perfs 6428'-6439' with 2500 gallons of 15% NEFE acid and 23 balls. 4 BPM at 1800-3000 psig ISIP 1500 psig. Flowed and swabbed back load water.
- 5) Ran Base GR. Sand frac the perfs at 6428'-6439' with 20,000 gallons of 30# HPG gelled 2% KCL water and 30,000# of 20/40 sand. 10 BPM at 2600-3550 psig. ISIP 1500 psig. After Frac Survey indicated major frac 6428'-6468'.
- 6) POH with tubing and packer. Place well on pump. Pump 11 days.
- 7) Pump 50 gallons of Halliburton's Hyflow III in 100 bbls. lease crude down casing. Flush with 101 bbls. of lease crude. Shut-in overnight. Place well on production.
- 8) January 24, 1988, 24 hour OPT, pump 115 BOPD, 8 BWPD, 88 MCFPD, GOR 765.

18. I hereby certify that the foregoing is true and correct

397-3571

SIGNED

TITLE Hobbs Area Superintendent

DATE 2/3/88

(This space for Federal or State office use)

APPROVED BY

TITLE

DATE

CONDITIONS OF APPROVAL, IF ANY:

ACCEPTED FOR RECORD

FEB 25 1988

*See Instructions on Reverse Side

CARLSBAD, NEW MEXICO

RECEIVED

FEB 29 1988
OCD
HOBBS OFFICE

UNITED STATES
DEPARTMENT OF THE INTERIOR
BUREAU OF LAND MANAGEMENT

SUBMIT IN TRI
(Other) Instructio
verse alder

Approved
Budget Bureau N-1004-1-3
Expires August 31, 1985

5. LEASE DESIGNATION AND SERIAL

LC-063586

6. IF INDIAN, ALLOTTEE OR TRIBE NAME

SUNDRY NOTICES AND REPORTS ON WELLS

(Do not use this form for proposals to drill or to deepen or plug back to a different reservoir.
Use "APPLICATION FOR PERMIT—" for such proposals.)

1. OIL WELL <input checked="" type="checkbox"/> GAS WELL <input type="checkbox"/> OTHER <input type="checkbox"/>	7. UNIT AGREEMENT NAME
2. NAME OF OPERATOR Texaco Inc.	8. FARM OR LEASE NAME S. A. Bowman FED.
3. ADDRESS OF OPERATOR PO Box 728, Hobbs, New Mexico 88240	9. WELL NO. 4
4. LOCATION OF WELL (Report location clearly and in accordance with any State requirements. See also space 17 below.) At surface Unit Letter N, 990 FSL & 1659 FWL	10. FIELD AND POOL OR WILDCAT Lusk Delaware, West
14. PERMIT NO.	11. SEC., T., R., M., OR BLK. AND SURVEY OR AREA Sec. 29, T19S, R32E
15. ELEVATIONS (Show whether DF, RT, GR, etc.) 3552' GL	12. COUNTY OR PARISH Lea
	13. STATE NM

16. Check Appropriate Box To Indicate Nature of Notice, Report, or Other Data

NOTICE OF INTENTION TO:		SUBSEQUENT REPORT OF:	
TEST WATER SHUT-OFF <input type="checkbox"/>	PULL OR ALTER CASING <input type="checkbox"/>	WATER SHUT-OFF <input type="checkbox"/>	REPAIRING WELL <input type="checkbox"/>
FRACTURE TREAT <input type="checkbox"/>	MULTIPLE COMPLETE <input type="checkbox"/>	FRACTURE TREATMENT <input type="checkbox"/>	ALTERING CASING <input type="checkbox"/>
SHOOT OR ACIDIZE <input type="checkbox"/>	ABANDON* <input type="checkbox"/>	SHOOTING OR ACIDIZING <input type="checkbox"/>	ABANDONMENT* <input type="checkbox"/>
REPAIR WELL <input type="checkbox"/>	CHANGE PLANS <input type="checkbox"/>	(Other) Drilling <input checked="" type="checkbox"/>	
(Other) <input type="checkbox"/>		(NOTE: Report results of multiple completion on Well Completion or Recompletion Report and Log form.)	

17. DESCRIBE PROPOSED OR COMPLETED OPERATIONS (Clearly state all pertinent details, and give pertinent dates, including estimated date of starting any proposed work. If well is directionally drilled, give subsurface locations and measured and true vertical depths for all markers and zones pertinent to this work.)*

Spud 14 3/4" hole at 6:45 PM, 12/8/87
Ran 22 jts. (916') 11 3/4", 42#, H-40, ST & C casing, set at 928'
Ran 88 jts. (3812') 8 5/8", 32#, J-55 & S-80, ST & C casing, set at 3842

- 1) Ran GR/Sonic 6850' to 3824'. GR/CAL/LTD 6850' to 3824', GR/CNL 6850'-2650' GR/MSFL/DLL 6850' to 3824', no problems logging.
- 2) Ran 166 jts. (6838') 5 1/2", 17#, L-80, 15.5#, J-55, ST & C casing, set at 6850'.
- 3) Cement 1st stage with 1150 sxs. Class "H" 1/4# flocele 0.6% Halad-9. Circulate 47 sxs.
- 4) Cement 2nd stage with 350 sxs. HLW with 1/4# flocele and 250 sxs. Class "H" with 2% CaCl, circulated 101 sxs.
- 5) TD 6850'. ND BOP. NU and test wellhead to 3000 psi.
- 6) Release Basin Rig #7 at 2:00 PM, 12/23/87.

18. I hereby certify that the foregoing is true and correct
SIGNED [Signature] 397-3571
TITLE Hobbs Area Superintendent DATE 1/13/88
(This space for Federal or State office use)

APPROVED BY _____ TITLE _____ DATE _____
CONDITIONS OF APPROVAL, IF ANY:

ACCEPTED FOR RECORD

FEB 1 1988

*See Instructions on Reverse Side

SJS
CARLSBAD, NEW MEXICO

UNITED STATES
DEPARTMENT OF THE INTERIOR
LAND MANAGEMENT

SUBMIT IN TRIPLICATE
(Other instructions on reverse side)

Budget Bureau N. 1001-1
Expires August 31, 1985
LEASE DESIGNATION AND SERIAL

LC 063584

SUNDRY NOTICES AND REPORTS ON WELLS

(Do not use this form for proposals to drill or to deepen or plug back to a different reservoir.
Use APPLICATION FOR PERMIT for such proposals.)

1. OIL WELL <input checked="" type="checkbox"/> GAS WELL <input type="checkbox"/> OTHER <input type="checkbox"/>	6. IF INDIAN, ALLOTTEE OR TRIBE NAME
2. NAME OF OPERATOR Texaco Inc.	7. UNIT AGREEMENT NAME
3. ADDRESS OF OPERATOR PO Box 728, Hobbs, New Mexico 88240	8. FARM OR LEASE NAME S. A. Bowman Fed
4. LOCATION OF WELL (Report location clearly and in accordance with any State requirements. See also space 17 below) At surface Unit Letter N, 990 FSL & 1659 FWL	9. WELL NO. 4
14. PERMIT NO.	10. FIELD AND POOL OR WILDCAT Lusk Delaware, West
15. ELEVATIONS (Show whether DF, RT, GR, etc.) 3552' GL	11. SEC., T., R., M., OR BLK. AND SURVEY OR AREA Sec. 29, 19S, 32E
	12. COUNTY OR PARISH Lea
	13. STATE NM

Check Appropriate Box To Indicate Nature of Notice, Report, or Other Data

NOTICE OF INTENTION TO:		SUBSEQUENT REPORT OF:	
TEST WATER SHUT-OFF <input type="checkbox"/>	PULL OR ALTER CASING <input type="checkbox"/>	WATER SHUT-OFF <input type="checkbox"/>	REPAIRING WELL <input type="checkbox"/>
FRACTURE TREAT <input type="checkbox"/>	MULTIPLE COMPLETE <input type="checkbox"/>	FRACTURE TREATMENT <input type="checkbox"/>	ALTERING CASING <input type="checkbox"/>
SHOOT OR ACIDIZE <input type="checkbox"/>	ABANDON* <input type="checkbox"/>	SHOOTING OR ACIDIZING <input type="checkbox"/>	ABANDONMENT* <input type="checkbox"/>
REPAIR WELL <input type="checkbox"/>	CHANGE PLANS <input type="checkbox"/>	(Other) Commence Drilling Op. <input checked="" type="checkbox"/>	
(Other) <input type="checkbox"/>		(NOTE: Report results of multiple completion on Well Completion or Recompletion Report and Log form.)	

17. DESCRIBE PROPOSED OR COMPLETED OPERATIONS (Clearly state all pertinent details, and give pertinent dates, including estimated date of starting any proposed work. If well is directionally drilled, give subsurface locations and measured and true vertical depths for all markers and zones pertinent to this work.) *

Spud 14 3/4" hole at 6:45 PM, 12/8/87

- 1) Ran 22 jts. (916') 11 3/4", 42#, H-40, ST & C casing, set at 928'.
- 2) Cement with 1000 sxs. Class "H" 2% CaCl 1/4# flocele. P. D. 4:45 PM, 12/9/87. Circulated 396 sxs.
- 3) Tested 11 3/4" casing from 2:30 PM to 3:00 PM. Tested to 1000 psig. Held OK.
- 4) Ran 88 jts. (3812') 8 5/8", 32#, J-55 & S-80, LT & C casing, set at 3842'.
- 5) Cement 1st stage with 700 sxs. Class "H" 10# gilsonite 1/2# flocele, 0.6% Halad 9, cement with no returns. P. D. inflate ECP. Open DV tool. Broke circulation with 74 bbls. Pump 155 bbls. and lost returns.
- 6) Pump 100 sxs. Class "H" flocele thru DV over displaced 5 bbls. WOC 8 1/4 hours. Broke circulation with 90% returns.
- 7) Ran temp. survey. TOC 125'.
- 8) Tested 8 5/8" casing from 6:15 PM to 6:45 PM. Tested to 1500 psig. Held OK.

18. I hereby certify that the foregoing is true and correct

SIGNED

Ja Hea

TITLE

397-3571

Hobbs Area Superintendent

DATE

12/21/87

(This space for Federal or State office use)

APPROVED BY

CONDITIONS OF APPROVAL, IF ANY:

TITLE

ACCEPTED FOR RECORD

DATE

JAN 7 1988

*See Instructions on Reverse Side

SJS
CARLSBAD, NEW MEXICO

UNITED STATES
DEPARTMENT OF THE INTERIOR
BUREAU OF LAND MANAGEMENT

30-025-30164

APPLICATION FOR PERMIT TO DRILL, DEEPEN, OR PLUG BACK

1a. TYPE OF WORK

DRILL ☒

DEEPEN ☐

PLUG BACK ☐

b. TYPE OF WELL

OIL
WELL ☒

GAS
WELL ☐

OTHER

SINGLE
ZONE ☐

MULTIPLE
ZONE ☐

2. NAME OF OPERATOR

Texaco Inc.

3. ADDRESS OF OPERATOR

P. O. Box 728, Hobbs, New Mexico, 88240

4. LOCATION OF WELL (Report location clearly and in accordance with any State requirements.)*

At surface 990' FSL & 1659' FWL (Unit Letter N)

At proposed prod. zone Same

14. DISTANCE IN MILES AND DIRECTION FROM NEAREST TOWN OR POST OFFICE*

6 Miles Northwest of Halfway, New Mexico

10. DISTANCE FROM PROPOSED*

LOCATION TO NEAREST
PROPERTY OR LEASE LINE, FT.
(Also to nearest drlg. unit line, if any)

330

16. NO. OF ACRES IN LEASE

80

17. NO. OF ACRES ASSIGNED
TO THIS WELL

40

18. DISTANCE FROM PROPOSED LOCATION*
TO NEAREST WELL, DRILLING, COMPLETED,
OR APPLIED FOR, ON THIS LEASE, FT.

1st well

19. PROPOSED DEPTH

6850'

20. ROTARY OR CABLE TOOLS

Rotary

21. ELEVATIONS (Show whether DF, RT, GR, etc.)

3552' GR

22. APPROX. DATE WORK WILL START*

December 1, 1987

23.

PROPOSED CASING AND CEMENTING PROGRAM

SIZE OF HOLE	SIZE OF CASING	WEIGHT PER FOOT	SETTING DEPTH	QUANTITY OF CEMENT
24"	20"	94#	40'	Redimix to surface
15"	11-3/4"	42#	950'	1000 sxs CIRCULATE
11"	8-5/8"	32# & 36#	3800'	1400 sxs CIRCULATE
7-7/8"	5-1/2"	15.5# & 17#	6850'	1350 sxs

CEMENTING PROGRAM

SURFACE CASING: 1000 sxs. Class "H" with 1/4# Flocele and 2% CaCl (15.6 ppg, 1.18 cuft/sx, 5.2 gal wtr/sx)

INTERMEDIATE CASING: First Stage: 400 sx Class "H" with 10# Gilsonite & 1/2# Flocele (15.6 ppg, 1.24 cuft/sx, 5.2 gal wtr/sx) Second Stage: 800 sx ELW with 15# salt & 1/4# Flocele (12.7 ppg, 2.10 cuft/sx, 11 gal wtr/sx) followed by 200 sx Class "H" w/1/4# Flocele (15.6 ppg, 1.18 cuft/sx, 5.2 gal wtr/sx). DV tool @ 2800' w/ECP below.

PRODUCTION CASING: 500 sxs. Light Weight cement with 1/4# Flocele (12.4 ppg, 1.99 cuft/sx, 11 gal wtr/sx), followed by 850 sx Class "H" with 1/4# Flocele (15.6 ppg, 1.18 cuft/sx, 5.2 gal wtr/sx).

There are no other wells in this 1/4 1/4 section.

IN ABOVE SPACE DESCRIBE PROPOSED PROGRAM: If proposal is to deepen or plug back, give data on present productive zone and proposed new productive zone. If proposal is to drill or deepen directionally, give pertinent data on subsurface locations and measured and true vertical depths. Give blowout preventer program, if any.

24.

SIGNED

L. J. Seeman

TITLE

L. J. SEEMAN

Dist. Petr. Engr.

DATE

11/10/87

(This space for Federal or State office use)

PERMIT NO.

APPROVAL DATE

APPROVED BY

TITLE

DATE

11-24-87

CONDITIONS OF APPROVAL, IF ANY:

*See Instructions On Reverse Side

All distances must be from the outer boundaries of the Section.

Operator TEXACO INC.			Lease S. A. Bowman Federal		Well No. 4
Unit Letter N	Section 29	Township 19-S	Range 32-E	County Lea	
Actual Footage Location of Well: 990' feet from the South line and 1659' feet from the West line					
Ground Level Elev. 3552'	Producing Formation Brushy Canyon	Pool Lusk Delaware, West	Dedicated Acreage: 40 Acres		

1. Outline the acreage dedicated to the subject well by colored pencil or hatchure marks on the plat below.
2. If more than one lease is dedicated to the well, outline each and identify the ownership thereof (both as to working interest and royalty).
3. If more than one lease of different ownership is dedicated to the well, have the interests of all owners been consolidated by communitization, unitization, force-pooling, etc?

☐ Yes ☐ No If answer is "yes," type of consolidation _____

If answer is "no," list the owners and tract descriptions which have actually been consolidated. (Use reverse side of this form if necessary.) _____

No allowable will be assigned to the well until all interests have been consolidated (by communitization, unitization, forced-pooling, or otherwise) or until a non-standard unit, eliminating such interests, has been approved by the Division.

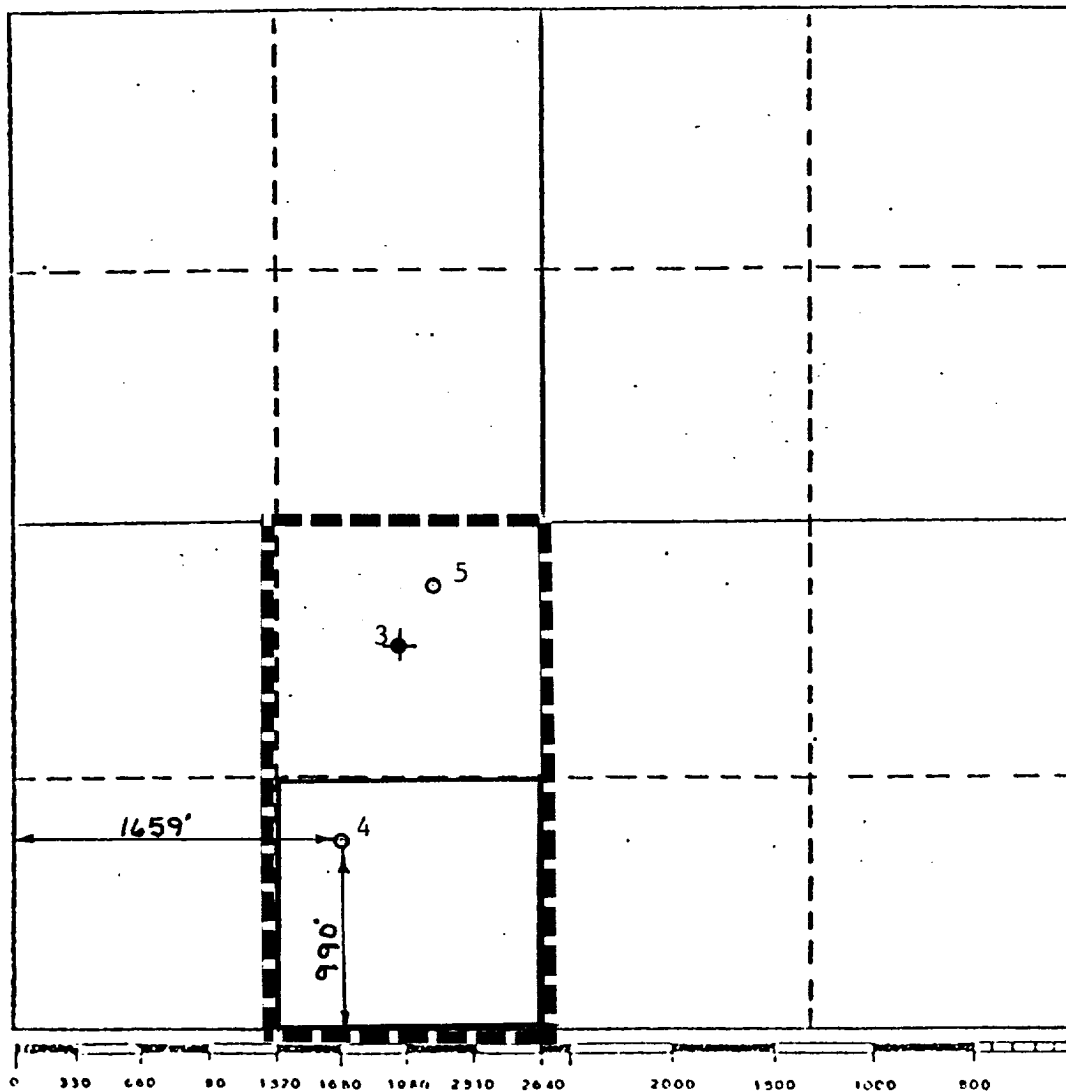

CERTIFICATION

I hereby certify that the information contained herein is true and complete to the best of my knowledge and belief.

B. L. Eiland

Name

B. L. Eiland

Position

Division Surveyor

Company

Texaco Inc.

Date

October 28, 1987

I hereby certify that the well location shown on this plat was plotted from field notes of actual surveys made by me or under my supervision, and that the same is true and correct to the best of my knowledge and belief.

Date Surveyed
NEW
October 19, 1987

Registered Professional Engineer
and/or Land Surveyor

B. L. Eiland
B. L. Eiland

Certificate No.

4386

RECEIVED
NOV 25 1987
OCD
HOBBS OFFICE

DRILLING CONTROL **CONDITION III-3000 PSI WP**

H₂S TRIM REQUIRED
YES _____ NO _____

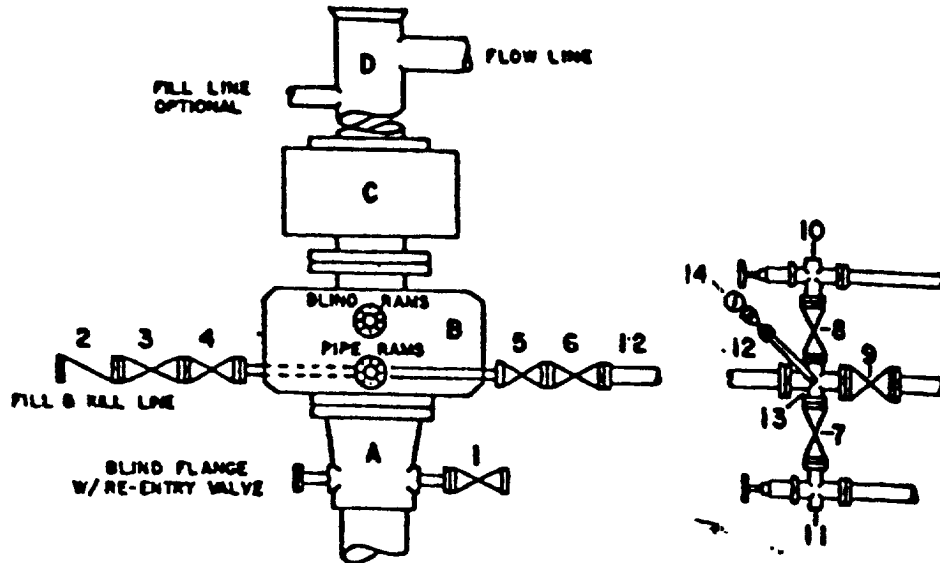

DRILLING CONTROL

MATERIAL LIST - CONDITION III

- | | |
|------------|---------------------------------------------------------------------------------------------------------------------------------------------------------------------------------------------------------------------------------------------------------------------------------------------------------------------------------------------------------------------------------------------------|
| A | Tenaco Wellhead |
| B | 3000# W.P. Dual ram type preventer, hydraulic operated with 1" steel, 3000# W.P. control lines (where sub-structure height is adequate, 2-3000# W.P. single ram preventers may be utilized with 3000# W.P. drilling spool with 2" minimum flanged outlet for kill line and 3" minimum flanged outlet for choke line. The drilling spool is to be installed below the single ram type preventers.) |
| C | 3000# W.P. Annular Preventer with 1" steel, 3000# W.P. control lines |
| D | Bell Nipple with flowline and fill-up outlets (kill line may also be used for fill-up line.) |
| 1,3,4, 7,8 | 2" minimum 3000# W.P. flanged full opening steel gate valve, or Halliburton Lo Torc Plug valve |
| 2 | 2" minimum 3000# W.P. back pressure valve |
| 5,6,9 | 3" minimum 3000# W.P. flanged full opening steel gate valve, or Halliburton Lo Torc Plug valve |
| 12 | 3" minimum Schedule 80, Grade B, seamless line pipe |
| 13 | 2" minimum x 3" minimum 3000# W.P. flanged cross |
| 10,11 | 2" minimum 3000# W.P. adjustable choke bodies |
| 14 | Cameron Mud Gauge or equivalent (location optional in choke line.) |



TEXACO, INC.
MIDLAND DIVISION
MIDLAND, TEXAS



SCALE	DATE	EST NO	DRG NO
DRAWN BY			
CHECKED BY			
APPROVED BY			

EXHIBIT D

RECEIVED
NOV 12 1978
FBI
HONOLULU OFFICE

ELF
Recd 1-12-88