

UNITED STATES  
DEPARTMENT OF THE INTERIOR  
BUREAU OF LAND MANAGEMENT  
SUBMIT IN TRIPLICATE  
P.O. BOX 1980  
HOBBS NEW MEXICO 88240

Budget Bureau No. 1004-1  
Expires August 31, 1985  
5. LEASE DESIGNATION AND SERIAL NO.  
LC-063586  
6. IF INDIAN, ALLOTTEE OR TRIBE NAME

SUNDRY NOTICES AND REPORTS ON WELLS

(Do not use this form for proposals to drill or to deepen or plug back to a different reservoir.  
Use "APPLICATION FOR PERMIT--" for such proposals.)

1. OIL WELL <input checked="" type="checkbox"/> GAS WELL <input type="checkbox"/> OTHER <input type="checkbox"/>	7. UNIT AGREEMENT NAME
2. NAME OF OPERATOR Texaco Inc.	8. FARM OR LEASE NAME S. A. Bowman Federal
3. ADDRESS OF OPERATOR PO Box 728, Hobbs, New Mexico 88240	9. WELL NO. 5
4. LOCATION OF WELL (Report location clearly and in accordance with any State requirements. See also space 17 below.) At surface Unit Letter K, 2310' FSL & 2160' FWL	10. FIELD AND POOL OR WILDCAT Lusk Delaware, West
14. PERMIT NO.	11. SEC., T., R., M., OR BLK. AND SURVEY OR AREA Sec. 29, 19S, 32E
15. ELEVATIONS (Show whether DF, RT, GR, etc.) 3553' GR	12. COUNTY OR PARISH Lea
	13. STATE NM

Check Appropriate Box To Indicate Nature of Notice, Report, or Other Data

NOTICE OF INTENTION TO:

TEST WATER SHUT-OFF	<input type="checkbox"/>	PULL OR ALTER CASING	<input type="checkbox"/>
FRACTURE TREAT	<input type="checkbox"/>	MULTIPLE COMPLETE	<input type="checkbox"/>
SHOOT OR ACIDIZE	<input type="checkbox"/>	ABANDON*	<input type="checkbox"/>
REPAIR WELL	<input type="checkbox"/>	CHANGE PLANS	<input type="checkbox"/>
(Other)	<input type="checkbox"/>		

SUBSEQUENT REPORT OF:

WATER SHUT-OFF	<input type="checkbox"/>	REPAIRING WELL	<input type="checkbox"/>
FRACTURE TREATMENT	<input type="checkbox"/>	ALTERING CASING	<input type="checkbox"/>
SHOOTING OR ACIDIZING	<input type="checkbox"/>	ABANDONMENT*	<input type="checkbox"/>
(Other)	<input checked="" type="checkbox"/>	Commence Drilling Opns.	<input checked="" type="checkbox"/>

(Note: Report results of multiple completion on Well Completion or Recompletion Report and Log form.)

17. DESCRIBE PROPOSED OR COMPLETED OPERATIONS. Clearly state all pertinent details, and give pertinent dates, including estimated date of starting any proposed work. If well is directionally drilled, give subsurface locations and measured and true vertical depths for all markers and zones pertinent to this work.\*

Spud 14 3/4" hole at 10:45 AM, 1/17/88.  
Ran 21 jts., 11 3/4", 42#, H-40, ST & C casing, set at 895'.  
Ran 90 jts., 8 5/8", 32#, S-80, ST & C casing, set at 3796'.

- 1) Ran 160 jts., 5 1/2", 15.5# & 17#, L-80 & J-55, ST & C casing, set at 6850'.
- 2) Cemented 1st stage with 760 sxs. Class "H" 8# Sa H 0.6% Halad-9 1/4# flocele, 400 sxs. Class "H" 5# KCL .4% Halad-9 0.3% Super CBL 1/4# flocele. Set DV packer circulated 266 sxs.
- 3) Cemented 2nd stage with 450 sxs. HLW 1/4# flocele, 100 sxs. Class "H" 2% CaCl. Circulated 112 sxs.
- 4) Test 5 1/2" casing to 1500 psig for 30 minutes, held ok.
- 5) Released rig at 9:15 PM, 2/4/88.

18. I hereby certify that the foregoing is true and correct

SIGNED Ja Head  
(This space for Federal or State office use)

397-3571  
TITLE Hobbs Area Superintendent

DATE 2/22/88

APPROVED BY  
CONDITIONS OF APPROVAL, IF ANY:

TITLE

DATE

\*See Instructions on Reverse Side

SJS

UNITED STATES  
DEPARTMENT OF THE INTERIOR  
BUREAU OF LAND MANAGEMENT

SUBMIT IN TR (Other instructions on reverse side)

Form approved  
Budget Bureau No. 1004-0135  
Expires August 31, 1985

5. LEASE DESIGNATION AND SERIAL NO.

LC-063 586

6. IF INDIAN, ALLOTTEE OR TRIBE NAME

SUNDRY NOTICES AND REPORTS ON WELLS

(Do not use this form for proposals to drill or to deepen or plug back to a different reservoir.  
Use "APPLICATION FOR PERMIT—" for such proposals.)

1. OIL WELL ☒ GAS WELL ☐ OTHER ☐

2. NAME OF OPERATOR

Texaco Inc.

3. ADDRESS OF OPERATOR

PO Box 728, Hobbs, New Mexico 88240

4. LOCATION OF WELL (Report location clearly and in accordance with any State requirements.\*  
See also space 17 below.)  
At surface

Unit Letter K, 2310' FSL & 2160' FWL

14. PERMIT NO.

15. ELEVATIONS (Show whether DF, RT, GR, etc.)

3553' GR

Sec. 29, 19S, 32E

12. COUNTY OR PARISH 13. STATE

Lea

NM

16. Check Appropriate Box To Indicate Nature of Notice, Report, or Other Data

NOTICE OF INTENTION TO:

TEST WATER SHUT-OFF

FRACTURE TREAT

SHOOT OR ACIDIZE

REPAIR WELL

(Other)

PULL OR ALTER CASING

MULTIPLE COMPLETION

ABANDON\*

CHANGE PLANS

SUBSEQUENT REPORT OF:

WATER SHUT-OFF

FRACTURE TREATMENT

SHOOTING OR ACIDIZING

(Other) Commence Drilling Opns.

REPAIRING WELL

ALTERING CASING

ABANDONMENT\*

(NOTE: Report results of multiple completion on Well Completion or Recompletion Report and Log form.)

17. DESCRIBE PROPOSED OR COMPLETED OPERATIONS (Clearly state all pertinent details, and give pertinent dates, including estimated date of starting any proposed work. If well is directionally drilled, give subsurface locations and measured and true vertical depths for all markers and zones pertinent to this work.)

Spud 14 3/4" hole at 10:45 AM, 1/17/88

- 1) Ran 21 jts., 11 3/4", 42#, H-40, ST & C casing, set at 895'.
- 2) Cement with 1000 sxs. Class "H" 2% CaCl 1/4# flocele. PD 12:30 PM, 1/18/88 circulated 337 sxs. Set slips, cut off. NU and test BOP to 3000 psi.
- 3) Test 11 3/4" casing to 600 psi from 10:00 AM to 10:30 AM, 1/19/88. Test OK.
- 4) Ran 90 jts. 8 5/8", 32#, S-80, ST & C casing, set at 3796'.
- 5) Cemented first stage with 600 sxs. Class "H" with 10# Gilsonite, 1/2# Flocele and 0.6% Halad 9, 15.6 ppg. Casing pressure to 2500 psi with 168 bbls. of disp. Calculate 267 sxs. out shoe. Set slips, CO and install WH. Attempt to circulate DV tool.
- 6) Test BOP to 3000 psig. Rot. head to 2100 psig, and manifold to 1000 psig. Tag cement at 2416'. Drill cement to 2731'. TOH with 7 7/8" bit and PU DV opening. Drill cement to 2731' and shoulder on opening sleeve. Bump and move sleeve 4". Unable to pump with 3000 psig.
- 7) Circulate thru DV tool. Cement with 800 sxs. HLW 15# salt 1/4# Flocele 200 sxs. Class "H" Flocele. Closed in casing with 700#. Circulated 137 sxs. cement to surface. WOC.
- 8) Drill cement inside 8 5/8" casing at 3236'.
- 9) Tag cement 2525', cement drill firm. Prepare to test DV tool.
- 10) Test 8 5/8" casing to 1300 psi from 12:15 PM to 12:45 PM, 1/26/88.

18. I hereby certify that the foregoing is true and correct

SIGNED

TITLE Hobbs Area Superintendent

397-3571

DATE 2/3/88

(This space for Federal or State office use)

APPROVED BY

TITLE

DATE

CONDITIONS OF APPROVAL, IF ANY:

\*See Instructions on Reverse Side

Title 18 U.S.C. Section 1001, makes it a crime for any person knowingly and willfully to make to any department or agency of the United States any false, fictitious or fraudulent statements or representations as to any matter within its jurisdiction.

RECEIVED

ACQUISITION

MAR 5 1988

SJS

CALROAD INC. MEXICO

RECEIVED  
JUN 14 1988  
CCD  
HOBBS OFFICE

UNITED STATES  
DEPARTMENT OF THE INTERIOR  
BUREAU OF LAND MANAGEMENT

SUBMIT IN DUPLICATE

(See instructions on  
reverse side)

Form approved,  
Budget Bureau No. 1004-0137  
Expires August 31, 1985

WELL COMPLETION OR RECOMPLETION REPORT AND LOG \*

5. LEASE DESIGNATION AND SERIAL NO.

LC-063586

6. IF INDIAN, ALLOTTEE OR TRIBE NAME

7. UNIT AGREEMENT NAME

8. FARM OR LEASE NAME

S. A. Bowman Federal

9. WELL NO.

5

10. FIELD AND POOL, OR WILDCAT

Lusk Delaware, West

11. SEC. T., R., M., OR BLOCK AND SURVEY  
OR AREA

Sec. 29, 19S, 32E

12. COUNTY OR  
PARISH

Lea

13. STATE

NM

1a. TYPE OF WELL:

OIL WELL ☒ GAS WELL ☐ DRY ☐ Other ☐

b. TYPE OF COMPLETION:

NEW WELL ☒ WORK OVER ☐ DEEP-EN ☐ PLUG BACK ☐ DIFF. RESVR. ☐ Other ☐

2. NAME OF OPERATOR

Texaco Inc.

3. ADDRESS OF OPERATOR

PO Box 728, Hobbs, New Mexico 88240

4. LOCATION OF WELL (Report location clearly and in accordance with any State requirements)\*

At surface Unit Letter K, 2310' FSL & 2160' FWL

At top prod. interval reported below

At total depth

14. PERMIT NO.

DATE ISSUED

15. DATE SPUDDED

1/17/88

16. DATE T.D. REACHED

2/2/88

17. DATE COMPL. (Ready to prod.)

2/25/88

18. ELEVATIONS (DF, RKB, RT, GR, ETC.)\*

3553' GR

19. ELEV. CASINGHEAD

---

20. TOTAL DEPTH, MD & TVD

6850'

21. PLUG BACK T.D., MD & TVD

6601'

22. IF MULTIPLE COMPL.,  
HOW MANY\*

23. INTERVALS  
DRILLED BY

ROTARY TOOLS

CABLE TOOLS

X

24. PRODUCING INTERVAL(S), OF THIS COMPLETION—TOP, BOTTOM, NAME (MD AND TVD)\*

25. WAS DIRECTIONAL  
SURVEY MADE

Yes

Delaware Formation (Brushy Canyon) at 6431'-46'

26. TYPE ELECTRIC AND OTHER LOGS RUN

GR-CNL-FDC, GR-BHCS, GR-ML, GR-DIL-SP

27. WAS WELL CORED

No

28. CASING RECORD (Report all strings set in well)

CASING SIZE	WEIGHT, LB./FT.	DEPTH SET (MD)	HOLE SIZE	CEMENTING RECORD	AMOUNT PULLED
11 3/4"	42#	395'	14 3/4"	1000 sxs. "H", cmt circ	
8 5/8"	32#	3796'	11 3/4"	1400 sxs. "H", cmt circ	
5 1/2"	15.5#, 17#	6850'	8 5/8"	1610 sxs. "H", cmt circ	

29. LINER RECORD

SIZE	TOP (MD)	BOTTOM (MD)	SACKS CEMENT*	SCREEN (MD)	SIZE	DEPTH SET (MD)	PACKER SET (MD)
					2 7/8"	6489'	

31. PERFORATION RECORD (Interval, size and number)

2 spf at 6431'-46' (32 holes)

32. ACID, SHOT, FRACTURE, CEMENT SQUEEZE, ETC.

DEPTH INTERVAL (MD)	AMOUNT AND KIND OF MATERIAL USED
6431'-46'	2500 gallons 15% NEFE acid
	20,000 gallons 30# XL gel
	30,000# 20-40 sand

33.\*

PRODUCTION

DATE FIRST PRODUCTION		PRODUCTION METHOD (Flowing, gas lift, pumping—size and type of pump)					WELL STATUS (Producing or shut-in)	
2/25/88		Pumping, 1 3/4" pump					Producing	
DATE OF TEST	HOURS TESTED	CHOKE SIZE	PROD'N. FOR TEST PERIOD	OIL—BBL.	GAS—MCF.	WATER—BBL.	GAS-OIL RATIO	
3/2/88	24	Pump	→	200	277	86 LW	1385	
FLOW, TUBING PRESS.	CASING PRESSURE	CALCULATED 24-HOUR RATE	OIL—BBL.	GAS—MCF.	WATER—BBL.	OIL GRAVITY-API (CORR.)		
---	---	→	200	277	86 LW	39.7° at 60°F		
34. DISPOSITION OF GAS (Sold, used for fuel, vented, etc.)								

34. DISPOSITION OF GAS (Sold, used for fuel, vented, etc.)

Sold

TEST WITNESSED BY

Dan Jones, Foreman

35. LIST OF ATTACHMENTS

Deviation Survey (logs previously submitted by Atlas)

36. I hereby certify that the foregoing and attached information is complete and correct as determined from all available records

SIGNED

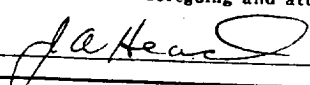

TITLE Hobbs Area Superintendent

397-3571

DATE 3/7/88

\*(See Instructions and Spaces for Additional Data on Reverse Side)

37. SUMMARY OF POROUS ZONES: (Show all important zones of porosity and contents thereof; cored intervals; and all drill-stem, tests, including depth interval tested, cushion used, time tool open, flowing and shut-in pressures, and recoveries):

38. GEOLOGIC MARKERS

FORMATION	TOP	BOTTOM	DESCRIPTION, CONTENTS, ETC.	NAME	TOP	
					MEAS. DEPTH	TRUE VERT. DEPTH
Red Beds Anhydrite Salts Tansill Yates 7 Rivers Capitan Reef Delaware Sands	Surface 890' 1075' 2345' 2532' 2765' 2875' 4485'	890' 1075' 2345' 2532' 2765' 2875' 4485' TD	Sand Anhydrite and Salts Salts Dolomite Sand and Dolomite Dolomite Limestone Sand, Shale, Dolomite			

HOBBS OFFICE  
OCD

MAR 7 - 1988

RECEIVED

UNITED STATES  
DEPARTMENT OF THE INTERIOR  
BUREAU OF LAND MANAGEMENT

APPLICATION FOR PERMIT TO DRILL, DEEPEN, OR PLUG BACK

1a. TYPE OF WORK

DRILL ☒

DEEPEN ☐

PLUG BACK ☐

b. TYPE OF WELL

OIL  
WELL ☒

GAS  
WELL ☐

OTHER

SINGLE  
ZONE ☒

MULTIPLE  
ZONE ☐

2. NAME OF OPERATOR

Texaco Inc.

3. ADDRESS OF OPERATOR

P. O. Box 728, Hobbs, New Mexico 88240

4. LOCATION OF WELL (Report location clearly and in accordance with any State requirements.)\*

At surface

2310' FSL & 2160' FWL (Unit Letter K)

At proposed prod. zone

Same

14. DISTANCE IN MILES AND DIRECTION FROM NEAREST TOWN OR POST OFFICE\*

6 Miles Northwest of Halfway, New Mexico

15. DISTANCE FROM PROPOSED\*

LOCATION TO NEAREST  
PROPERTY OR LEASE LINE, FT.  
(Also to nearest drlg. unit line, if any)

330'

16. NO. OF ACRES IN LEASE

80

18. DISTANCE FROM PROPOSED LOCATION\*

TO NEAREST WELL, DRILLING, COMPLETED, 1412' from

No. 4

19. PROPOSED DEPTH

6850'

21. ELEVATIONS (Show whether DF, RT, GR, etc.)

3553'

17. NO. OF ACRES ASSIGNED  
TO THIS WELL

40

20. ROTARY OR CABLE TOOLS

Rotary

22. APPROX. DATE WORK WILL START\*

December 16, 1987

23. PROPOSED CASING AND CEMENTING PROGRAM

SIZE OF HOLE	SIZE OF CASING	WEIGHT PER FOOT	SETTING DEPTH	QUANTITY OF CEMENT
24"	20"	94#	40'	Redimix to surface
15"	11-3/4"	42#	950'	1000 sacks CIRCULATE
11"	8-5/8"	32# & 36#	3800'	1400 sacks CIRCULATE
7-7/8"	5-1/2"	15.5# & 17#	6850'	1350 sacks

CEMENTING PROGRAM

SURFACE CASING: 1000 sacks Class "H" w/1/4# Flocele and 2% CaCl (15.6 ppg, 1.18 cu. ft./sx., 5.2 gal. wtr./sx.).

INTERMEDIATE CASING: 1st Stage: 400 sacks Class "H" w/10# Gilsonite & 1/2# Flocele (15.6 ppg, 1.25 cu. ft./sx., 5.2 gal. wtr./sx.).

2nd Stage: 800 sacks HLW w/15# Salt & 1/4# Flocele (12.7 ppg, 2.10 cu. ft./sx., 11 gal wtr./sx.) followed by 200 sacks Class "H" w/1/4# Flocele (15.6 ppg, 1.18 cu. ft./sx., 5.2 gal wtr./sx.). DV Tool @ 2800' w/ECP below.

PRODUCTION CASING: 500 sacks Light Weight cement w/1/4# Flocele (12.4 ppg, 1.99 cu. ft./sx., 11 gal wtr./sx.) followed by 850 sacks Class "H" w/1/4# Flocele (15.6 ppg, 1.18 cu. ft./sx., 5.2 gal. wtr./sx.).

THERE ARE NO OTHER WELLS OPERATING IN THIS 1/4, 1/4 SECTION.  
IN ABOVE SPACE DESCRIBE PROPOSED PROGRAM: If proposal is to deepen or plug back, give data on present productive zone and proposed new productive zone. If proposal is to drill or deepen directionally, give pertinent data on subsurface locations and measured and true vertical depths. Give blowout preventer program, if any.

24.

SIGNED

*L. J. Seeman*

L. J. Seeman

TITLE

District Petroleum Engineer

DATE

11/13/87

(This space for Federal or State office use)

PERMIT NO.

APPROVAL DATE

APPROVED BY

TITLE

DATE

11-24-87

CONDITIONS OF APPROVAL, IF ANY:

\*See Instructions On Reverse Side

**RECEIVED**  
NOV 25 1987  
OCD  
HOBBS OFFICE

All distances must be from the outer boundaries of the Section.

Operator <b>TEXACO INC.</b>		Lease <b>S. A. Bowman Federal</b>		Well No. <b>5</b>
Unit Letter <b>K</b>	Section <b>29</b>	Township <b>19-S</b>	Range <b>32-E</b>	County <b>Lea</b>
Actual Footage Location of Well: <b>2310'</b> feet from the <b>South</b> line and <b>2160'</b> feet from the <b>West</b> line				
Ground Level Elev. <b>3553'</b>	Producing Formation <b>Brushy Canyon</b>	Pool <b>Lusk Delaware, West</b>	Dedicated Acreage: <b>40</b> Acres	

1. Outline the acreage dedicated to the subject well by colored pencil or hatchure marks on the plat below.
2. If more than one lease is dedicated to the well, outline each and identify the ownership thereof (both as to working interest and royalty).
3. If more than one lease of different ownership is dedicated to the well, have the interests of all owners been consolidated by communitization, unitization, force-pooling, etc?

☐ Yes ☐ No If answer is "yes," type of consolidation \_\_\_\_\_

If answer is "no," list the owners and tract descriptions which have actually been consolidated. (Use reverse side of this form if necessary.) \_\_\_\_\_

No allowable will be assigned to the well until all interests have been consolidated (by communitization, unitization, forced-pooling, or otherwise) or until a non-standard unit, eliminating such interests, has been approved by the Division.

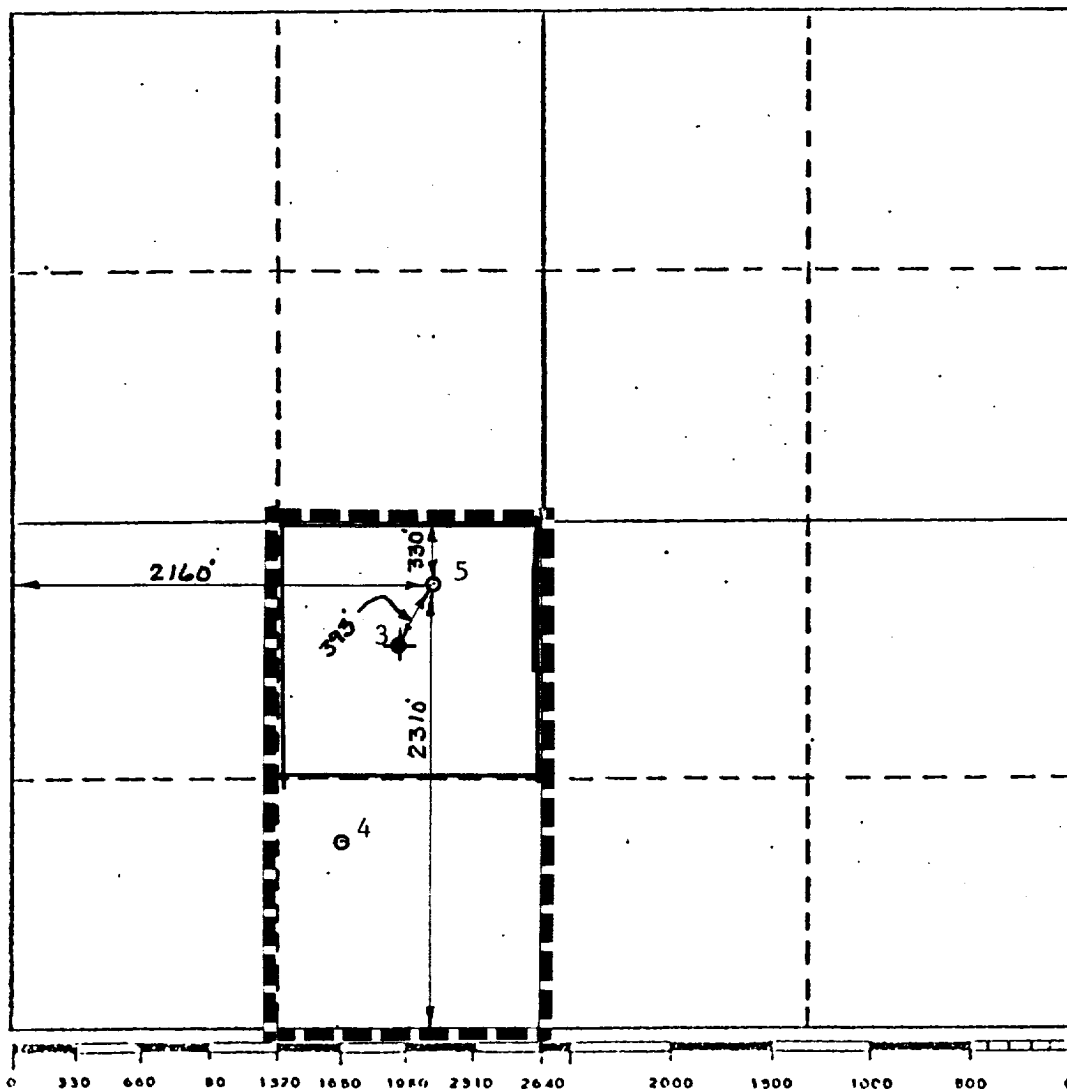

CERTIFICATION

I hereby certify that the information contained herein is true and complete to the best of my knowledge and belief.

*B. L. Eiland*

Name  
**B. L. Eiland**  
Position  
**Division Surveyor**  
Company  
**Texaco Inc.**  
Date  
**October 28, 1987**

I hereby certify that the well location shown on this plat was plotted from field notes of actual surveys made by me or under my supervision, and that the same is true and correct to the best of my knowledge and belief.

REGISTERED LAND SURVEYOR  
NEW MEXICO  
Date Surveyed  
**October 29, 1987**  
Registered Professional Engineer and/or Land Surveyor  
*B. L. Eiland*  
Certificate No.  
**4386**



# **DRILLING CONTROL** **CONDITION III-3000 PSI WP**

H<sub>2</sub>S TRIM REQUIRED  
 YES \_\_\_\_\_ NO \_\_\_\_\_

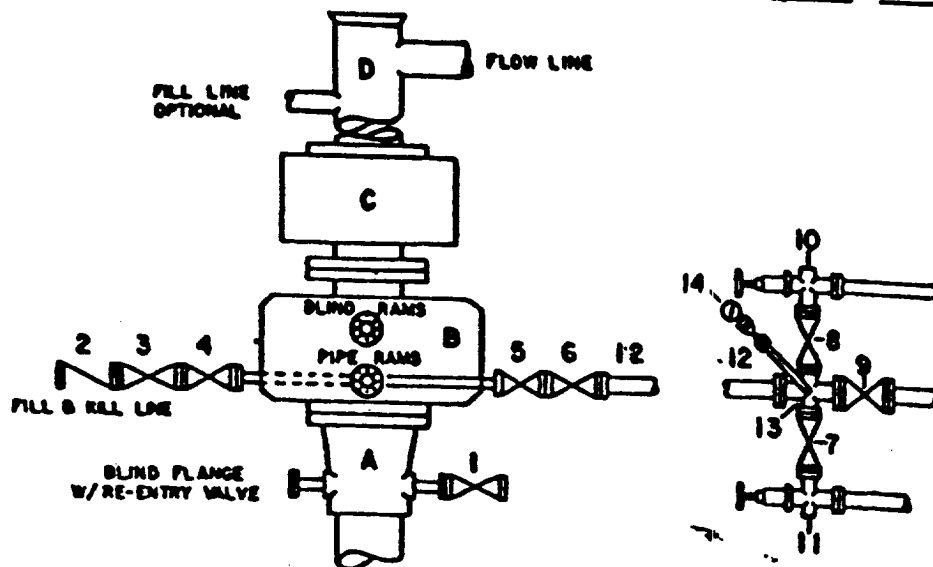

## DRILLING CONTROL

### MATERIAL LIST - CONDITION III

- A Texaco Wellhead
- B 3000# W.P. Dual ram type preventer, hydraulic operated with 1" steel, 3000# W.P. control lines (where sub-structure height is adequate, 2-3000# W.P. single ram preventers may be utilized with 3000# W.P. drilling spool with 2" minimum flanged outlet for kill line and 3" minimum flanged outlet for choke line. The drilling spool is to be installed below the single ram type preventers.)
- C 3000# W.P. Annular Preventer with 1" steel, 3000# W.P. control lines
- D Bell Nipple with flowline and fill-up outlets (kill line may also be used for fill-up line.)
- 1,3,4, 7,8 2" minimum 3000# W.P. flanged full opening steel gate valve, or Halliburton Lo Torc Plug valve
- 2 2" minimum 3000# W.P. back pressure valve
- 5,6,9 3" minimum 3000# W.P. flanged full opening steel gate valve, or Halliburton Lo Torc Plug valve
- 12 3" minimum Schedule 80, Grade B, seamless line pipe
- 13 2" minimum x 3" minimum 3000# W.P. flanged cross
- 10,11 2" minimum 3000# W.P. adjustable choke bodies
- 14 Cameron Mud Gauge or equivalent (location optional in Choke line.)



**TEXACO, INC.**  
 MIDLAND DIVISION  
 MIDLAND, TEXAS



SCALE	DATE	EST. NO.	DWG. NO.
DRAWN BY			
CHECKED BY			
APPROVED BY			

**EXHIBIT D**

RECEIVED  
NOV 25 1987  
OCD  
HOBBS OFFICE

ELF  
Recd 3/25/88

Recd 4-13-88  
Bureau Building