

**NEW MEXICO OIL CONSERVATION COMMISS. N**  
**WELL LOCATION AND ACREAGE DEDICATION PLAT**

Form C-102  
 Supersedes C-128  
 Effective 1-1-65

All distances must be from the outer boundaries of the Section.

Operator Shell Western E. & P. Inc.			Lease North Hobbs Unit SECTION 33		Well No. 433
Unit Letter I	Section 33	Township 18 South	Range 38 East	County Lea	
Actual Footage Location of Well: (SURFACE/BOTTOMHOLE) 1847/1867 feet from the South line and 985/360 feet from the East line					
Ground Level Elev. 3630.7	Producing Formation SAN ANDRES		Pool HOBBS (G/SA)	Dedicated Acreage: 40 Acres	

1. Outline the acreage dedicated to the subject well by colored pencil or hachure marks on the plat below.
2. If more than one lease is dedicated to the well, outline each and identify the ownership thereof (both as to working interest and royalty).
3. If more than one lease of different ownership is dedicated to the well, have the interests of all owners been consolidated by communitization, unitization, force-pooling, etc?

☒ Yes    ☐ No    If answer is "yes," type of consolidation UNITIZATION

If answer is "no," list the owners and tract descriptions which have actually been consolidated. (Use reverse side of this form if necessary.) \_\_\_\_\_

No allowable will be assigned to the well until all interests have been consolidated (by communitization, unitization, forced-pooling, or otherwise) or until a non-standard unit, eliminating such interests, has been approved by the Commission.

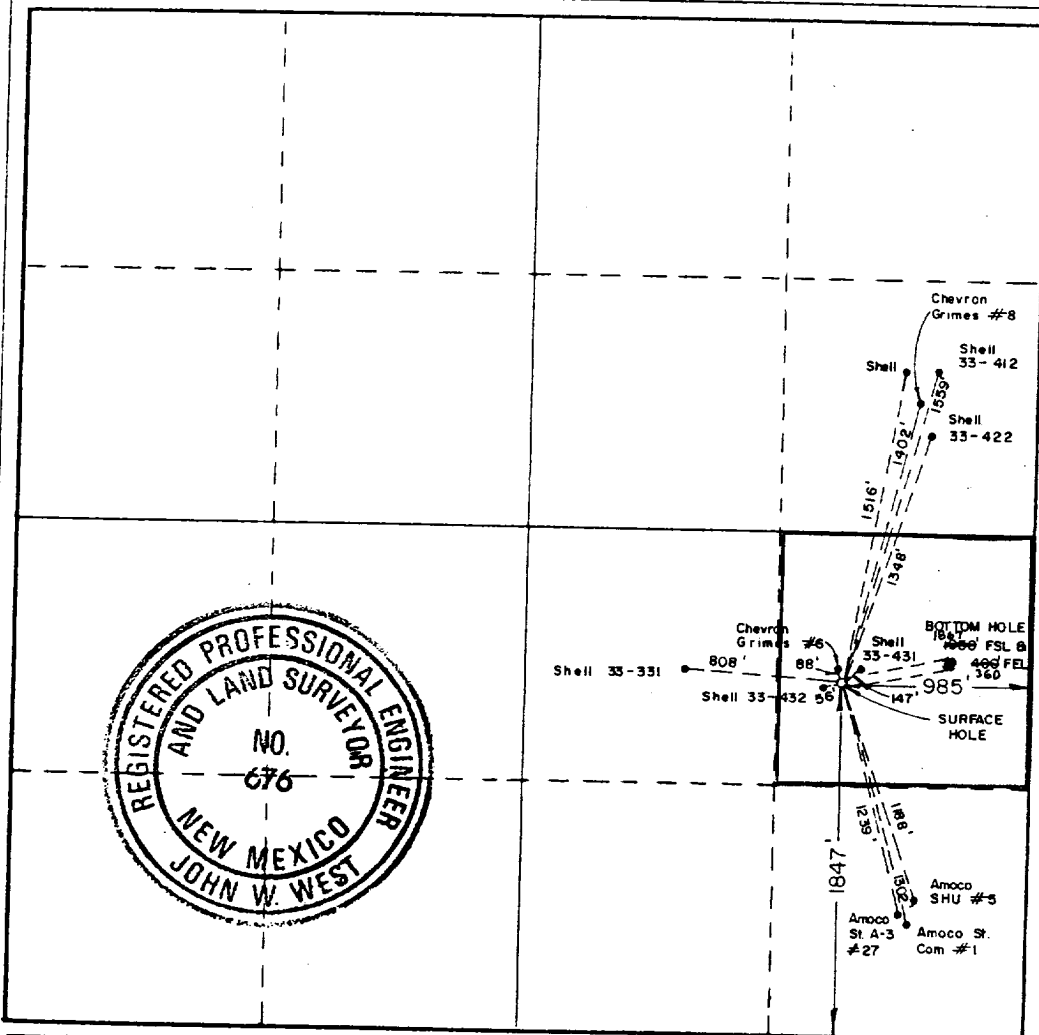

**CERTIFICATION**

I hereby certify that the information contained herein is true and complete to the best of my knowledge and belief.

Name A. J. FORE  
 Position **SUPERVISOR REG. & PERMITTING**  
 Company **SHELL WESTERN E&P INC.**  
 Date **JULY 20, 1988**

I hereby certify that the well location shown on this plat was plotted from field notes of actual surveys made by me or under my supervision, and that the same is true and correct to the best of my knowledge and belief.

Date Surveyed **February 26, 1988**  
 Registered Professional Engineer and/or Land Surveyor [Signature]

Certificate No. **JOHN W. WEST, 676**  
**RONALD J. EIDSON, 3239**

RECEIVED

JUL 25 1988

NOBBS CHARGE