

STATE OF NEW MEXICO  
ENERGY AND MINERALS DEPARTMENT

OIL CONSERVATION DIVISION

P O BOX 2088  
SANTA FE, NEW MEXICO 87501

Form C-101  
Revised 10-1-78

NO. OF COPIES RECEIVED	
DISTRIBUTION	
SANTA FE	
FILE	
U.S.G.S	
LAND OFFICE	
OPERATOR	

5a. Indicate Type of Lease  
State ☒ Fee ☐

5. State Oil & Gas Lease No  
**B-2148**

APPLICATION FOR PERMIT TO DRILL, DEEPEN OR PLUG BACK

1a. Type of Work  
DRILL ☒ DEEPEN ☐ PLUG BACK ☐  
b. Type of Well  
Oil ☒ Gas ☐ Other ☐  
Well ☒ Well ☐ Single Zone ☒ Multiple Zone ☐

7. Unit Agreement Name

8. Farm or Lease Name  
**Leamex**

2. Name of Operator  
**Phillips Petroleum Company**

9. Well No  
**49**

3. Address of Operator  
**4001 Penbrook Street, Odessa, Texas 79762**

10. Field and Pool, or Wildcat  
**Vacuum Gb/SA**

4. Location of Well  
Unit Letter **G** Located **2130 feet** From the **North** Line  
And **1980 Feet From The East** Line of Sec **21** TWP **17-S RGE 33-E NMPM**

12. County  
**Lea**

19. Proposed Depth  
**± 4900'**

19A. Formation  
**Grayburg/SA**

20. Rotary or C.T  
**Rotary**

21. Elevations (Show whether DF, RT, etc.)  
**4184.2' GR (Unprepared)**

21A. Kind & Status Plug Bond  
**Blanket**

21B. Drilling Contractor  
**Will advise later**

22. Approx. Date Work Will Start  
**Upon approval**

23. PROPOSED CASING AND CEMENT PROGRAM

SIZE OF HOLE	SIZE OF CASING	WEIGHT PER FOOT	SETTING DEPTH	SACKS OF CEMEN	EST TOP
12-1/4"	8-5/8"	24 # K-55	+ 1430'	1000 5x Class "C"	Surface
7-7/8"	5-1/2"	15.5 # K-55	+ 4800'	1400 5x	Surface

(Caliper volume plus 30% excess.  
Lead: Estimated 1000 sx Class "C"  
W/5% salt; tail w/400 sx Class "C" Neat.)

Use mud additives as required for control.

BOP EQUIP: Series 900, 3000# WP (See attached schematic - Figure 7-9 or 7-10.)

In above space describe proposed program: If proposal is to deepen or plug back, give data on present productive zone and proposed new productive zone. Give blowout preventer program, if any.

I hereby certify that the information above is true and complete to the best of my knowledge and belief.

SIGNED W. J. Mueller

TITLE Engineering Supervisor, Resv.

DATE July 15, 1988

ORIGINAL SIGNED FOR DEPARTMENT

APPROVED BY

TITLE

DATE

CONDITIONS OF APPROVAL, IF ANY:

Permit Expires 6 Months from Approval  
Date Unless Drilling Underway.

NEW MEXICO OIL CONSERVATION COMMISSION  
WELL LOCATION AND ACREAGE DEDICATION PLAT

Form O-102  
Supersedes O-124  
Effective 12-1-85

All distances must be from the outer boundaries of the Section

Operator Phillips Petroleum Company			Lease Leamex		Acres 49
Section C	Section 21	Township 17 South	Range 33 East	County Lea	
Actual Field Location of Well:					
2130 feet from the North line and		1980 feet from the East line			
Ground Level Elev. 4184.2	Producing Formation Grayburg-San Andres		Pool Maljamar Vacuum Grayburg-San Andres		Designated Acreage 40 Acres

1. Outline the acreage dedicated to the subject well by colored pencil or hatchure marks on the plat below.
2. If more than one lease is dedicated to the well, outline each and identify the ownership thereof (both as to working interest and royalty).
3. If more than one lease of different ownership is dedicated to the well, have the interests of all owners been consolidated by communitization, unitization, force-pooling, etc?

☐ Yes ☐ No If answer is "yes," type of consolidation \_\_\_\_\_

If answer is "no," list the owners and tract descriptions which have actually been consolidated. (Use reverse side of this form if necessary.) \_\_\_\_\_

No allowable will be assigned to the well until all interests have been consolidated (by communitization, unitization, forced-pooling, or otherwise) or until a non-standard unit, eliminating such interests, has been approved by the Commission.

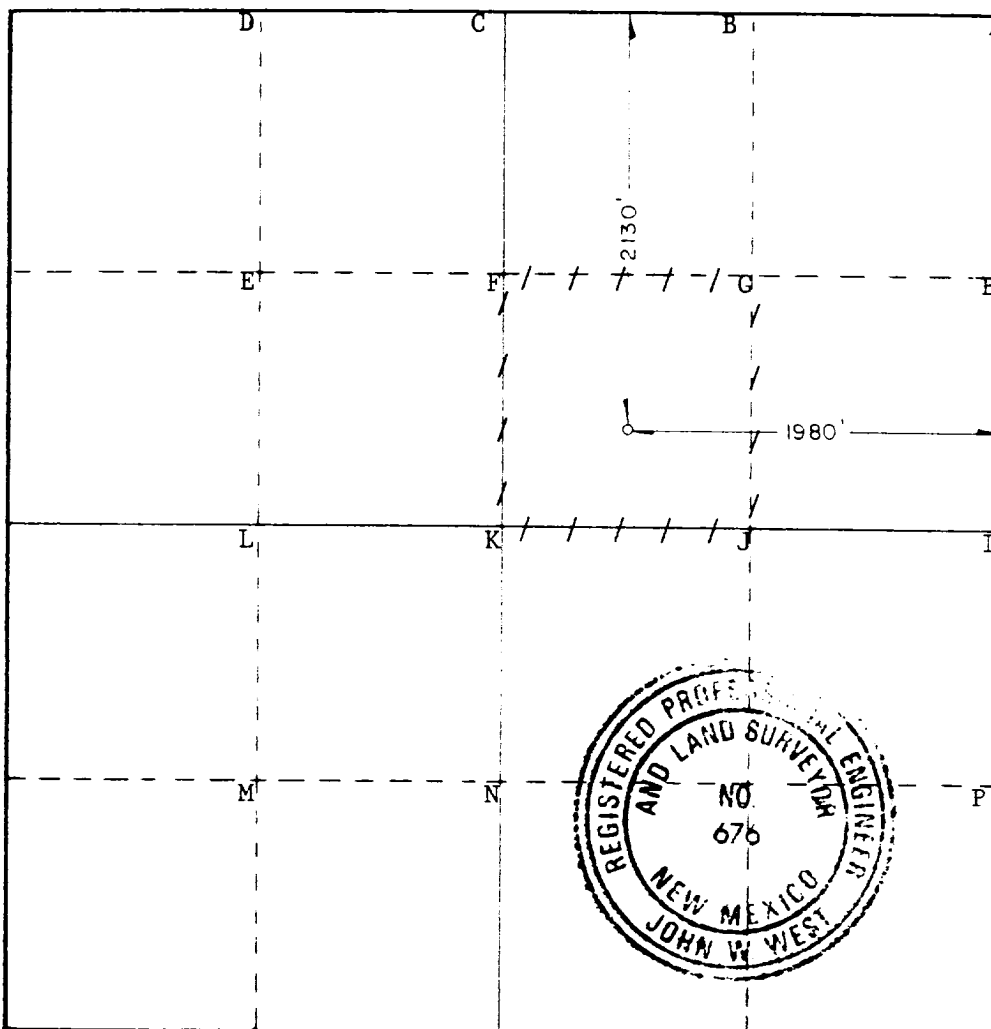

CERTIFICATION

I hereby certify that the information contained herein is true and complete to the best of my knowledge and belief.

*[Signature]*  
W. J. Mueller

Position  
Engineering Supervisor, Resv.

Company  
Phillips Petroleum Company

Date  
July 15, 1988

I hereby certify that the well location shown on this plat was plotted from field notes of actual surveys made by me or under my supervision, and that the same is true and correct to the best of my knowledge and belief.

Date Surveyed

May 31, 1988

Registered Professional Engineer  
and/or Land Surveyor

*[Signature]*  
Certificate No. JOHN W. WEST, 676

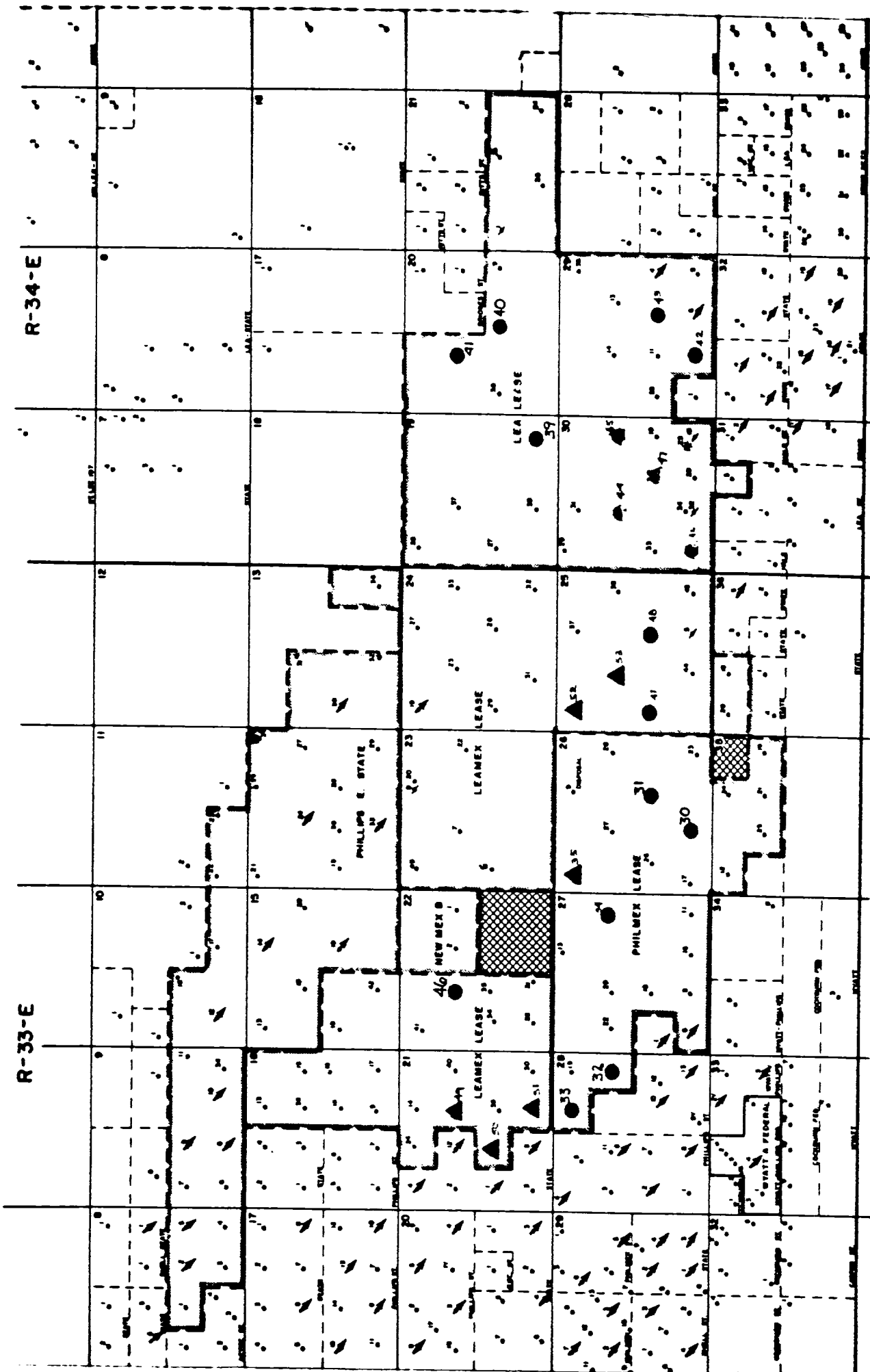

**MALJAMAR - VACUUM**  
 Leo Co., New Mexico

NOTE: Any existing wells contained within quarter-quarter section of proposed new well are operated by Phillips Petroleum Company.

## FIELD PRACTICES AND STANDARDS

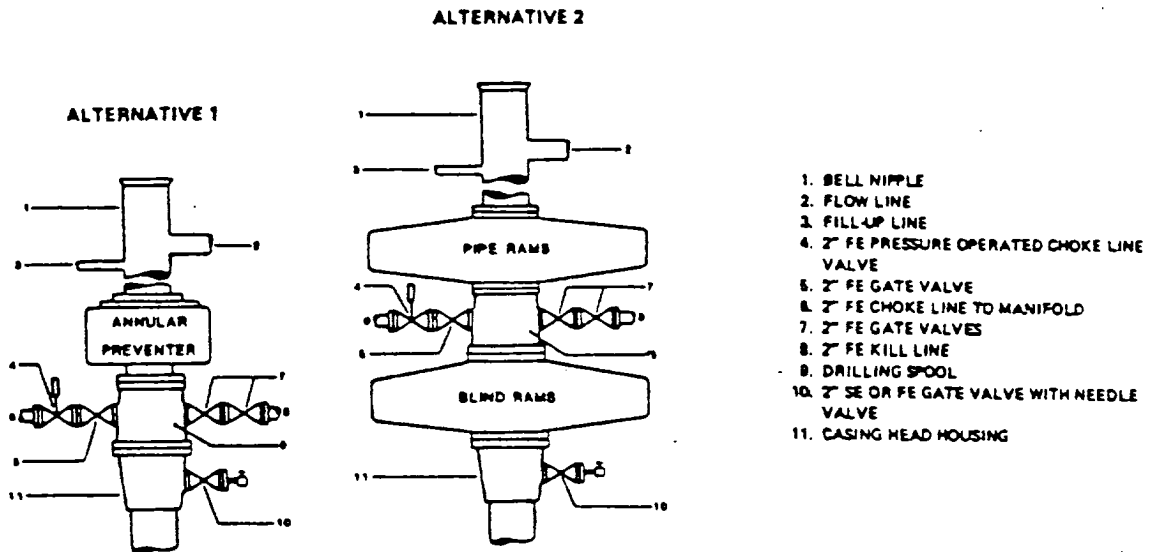

NOTE: THE DRILLING SPOOL MAY BE LOCATED BELOW BOTH SETS OF RAMS IF A DOUBLE PREVENTER IS USED AND IT DOES NOT HAVE SUITABLE OUTLETS BETWEEN RAMS

Figure 7-9. Standard Hydraulic Blowout Preventer Assembly  
(2 M or 3 M Working Pressure) Alternative 1

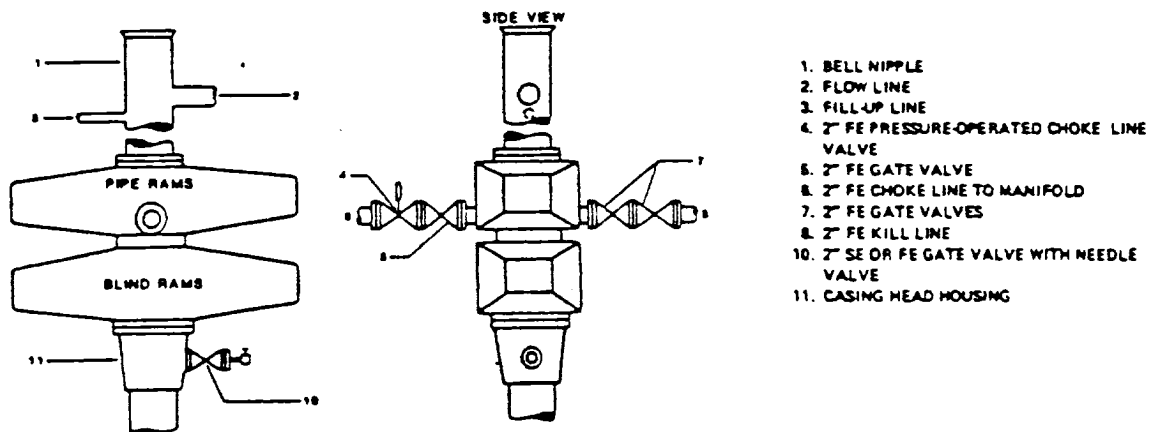

Figure 7-10. Standard Hydraulic Blowout Preventer Assembly  
(2 M or 3 M Working Pressure) Alternative 3 (without Drilling Spool)