

OIL AND MINERALS DEPARTMENT      SANTA FE, NEW MEXICO 87501  
 All data must be from the outer boundaries of the Section  
 Operator: Woodbine Petroleum, Inc.      Lease: MOBIL FEDERAL      Well No. #1  
 Unit Letter: E      Section: 21      Township: 19 SOUTH      Range: 32 EAST      County: LEA  
 Actual Postage Location of Well: 330 feet from the WEST line and 1650 feet from the NORTH line  
 Ground Level Elev. 3589      Producing Formation: Delaware      Pool: Lusk Delaware, West      Dedicated Acres: 40      Acres

1. Outline the acreage dedicated to the subject well by colored pencil or hatchure marks on the plat below.
  2. If more than one lease is dedicated to the well, outline each and identify the ownership thereof (both as to working interest and royalty).      One lease only.
  3. If more than one lease of different ownership is dedicated to the well, have the interests of all owners been consolidated by communitization, unitization, force-pooling, etc?      One lease only.
- ☐ Yes    ☐ No    If answer is "yes," type of consolidation N/A  
 If answer is "no," list the owners and tract descriptions which have actually been consolidated. (Use reverse side of this form if necessary.) N/A  
 No allowable will be assigned to the well until all interests have been consolidated (by communitization, unitization, forced-pooling, or otherwise) or until a non-standard unit, eliminating such interests, has been approved by the Division.

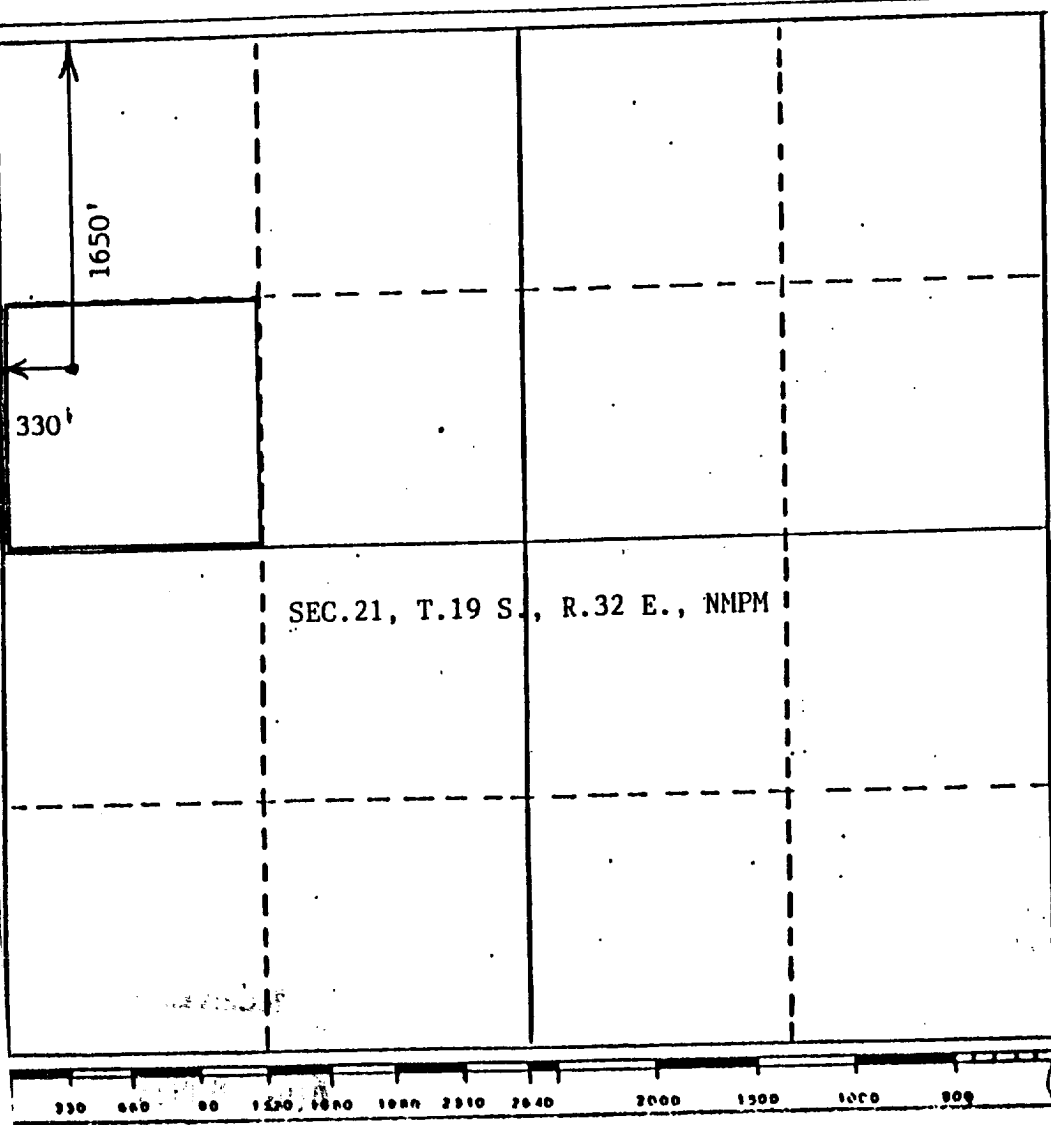

**CERTIFICATION**

I hereby certify that the information contained herein is true and complete to the best of my knowledge and belief.

Don G. Shackelford  
 Name: Don G. Shackelford  
 Position: Executive Vice President  
 Company: Woodbine Petroleum, Inc.  
 Date: March 29, 1988

I hereby certify that the well location shown on this plat was plotted from field notes of actual surveys made by me or under my supervision, and that the same is true and correct to the best of my knowledge and belief.

Date Surveyed: MARCH 29, 1988  
 Registered Professional Engineer and/or Land Surveyor: JOHN B. JACOBESS  
 License No. 1580      State of N.M.      L.S.  
 Certificate No. 1580      PROFESSIONAL ENGINEER

Rec'd 8/8/88

EEF

RECEIVED

AUG 8 1988

GOV  
HONORARY OFFICE