

OIL CONSERVATION DIVISION

P O BOX 2088

SANTA FE, NEW MEXICO 87501

Form C-101
Revised 10-1-78

NO. OF COPIES RECEIVED		
DISTRIBUTION		
SANTA FE		
FILE		
U.S.G.S		
LAND OFFICE		
OPERATOR		

5a Indicate Type of Lease

State ☒ Fee ☐

5 State Oil & Gas Lease No

B-2148

APPLICATION FOR PERMIT TO DRILL, DEEPEN OR PLUG BACK

1a Type of Work DRILL <input checked="" type="checkbox"/> DEEPEN <input type="checkbox"/> PLUG BACK <input type="checkbox"/>		7. Unit Agreement Name	
b Type of Well Oil Well <input checked="" type="checkbox"/> Gas Well <input type="checkbox"/> Other <input type="checkbox"/> Single Zone <input checked="" type="checkbox"/> Multiple Zone <input type="checkbox"/>		8 Farm or Lease Name Leamex	
2 Name of Operator Phillips Petroleum Company		9 Well No 48	
3 Address of Operator 4001 Penbrook Street, Odessa, Texas 79762		10 Field and Pool, or Wildcat Maljamar Gb/SA	
4 Location of Well Unit Letter <u>J</u> Located <u>1980 feet</u> From the <u>South</u> Line And <u>1980 Feet</u> From The <u>East</u> Line of Sec <u>25</u> TWP <u>17-S</u> RGE <u>33-E</u> NMPM			
		12 County Lea	
		19 Proposed Depth <u>±4900'</u>	19A Formation Grayburg/SA
		20. Rotary or C T Rotary	
21 Elevations (Show whether DF, RT, etc) 4104.0' GR (Unprepared)	21A Kind & Status Plug Bond Blanket	21B Drilling Contractor Will advise later	22. Approx Date Work Will Start Upon approval

23 PROPOSED CASING AND CEMENT PROGRAM

SIZE OF HOLE	SIZE OF CASING	WEIGHT PER FOOT	SETTING DEPTH	SACKS OF CEMENT	EST. TOP
12-1/4"	8-5/8"	24# K-55	± 1430'	1000 sx Class "C"	Surface
7-7/8"	5-1/2"	15 5# K-55	± 4800'	1400 sx	Surface

(Caliper volume plus 30% excess.
Lead: Estimated 1000 sx Class "C"
w/5% salt; tail w/400 sx Class "C" Neat.)

Use mud additives as required for control

BOP Equip: Series 900, 3000# WP (See attached schematic - Fig. 7-9 or 7-10)

In above space describe proposed program: If proposal is to deepen or plug back, give data on present productive zone and proposed new productive zone. Give blowout preventer program, if any.

I hereby certify that the information above is true and complete to the best of my knowledge and belief

SIGNED W. J. Mueller

TITLE Engineering Supervisor, Resv.

DATE _____

ORIGINAL SIGNED BY JERRY SEXTON
DISTRICT 1 SUPERVISOR

APPROVED BY

TITLE

DATE 7-13-68

CONDITIONS OF APPROVAL, IF ANY:

Permit Expires 6 Months From Approval
Date Unless Drilling Underway.

N MEXICO OIL CONSERVATION COMMISS
WELL LOCATION AND ACREAGE DEDICATION PLAT

Form C-102
 Supersedes C-128
 Effective 10-65

All distances must be from the outer boundaries of the Section

Owner PHILLIPS PETROLEUM COMPANY			Lease LEAMEX		Section 48
Letter J	Section 25	Township 17 SOUTH	Range 33 EAST	County LEA	
Section Boundary Location of Wells: 1980 feet from the SOUTH line and 1980 feet from the EAST line					
Produced Elev. -104.0	Producing Formation Grayburg-San Andres		Well Maljamar-Grayburg-San Andres		Dedicated Acreage 40.00

- 1 Outline the acreage dedicated to the subject well by colored pencil or hatchure marks on the plat below.
- 2 If more than one lease is dedicated to the well, outline each and identify the ownership thereof both as to working interest and royalty).
3. If more than one lease of different ownership is dedicated to the well, have the interests of all owners been consolidated by communitization, unitization, force-pooling, etc?

☐ Yes ☐ No If answer is "yes," type of consolidation _____

If answer is "no," list the owners and tract descriptions which have actually been consolidated. (Use reverse side of this form if necessary.) _____

No allowable will be assigned to the well until all interests have been consolidated (by communitization, unitization, forced-pooling, or otherwise) or until a non-standard unit, eliminating such interests, has been approved by the Commission.

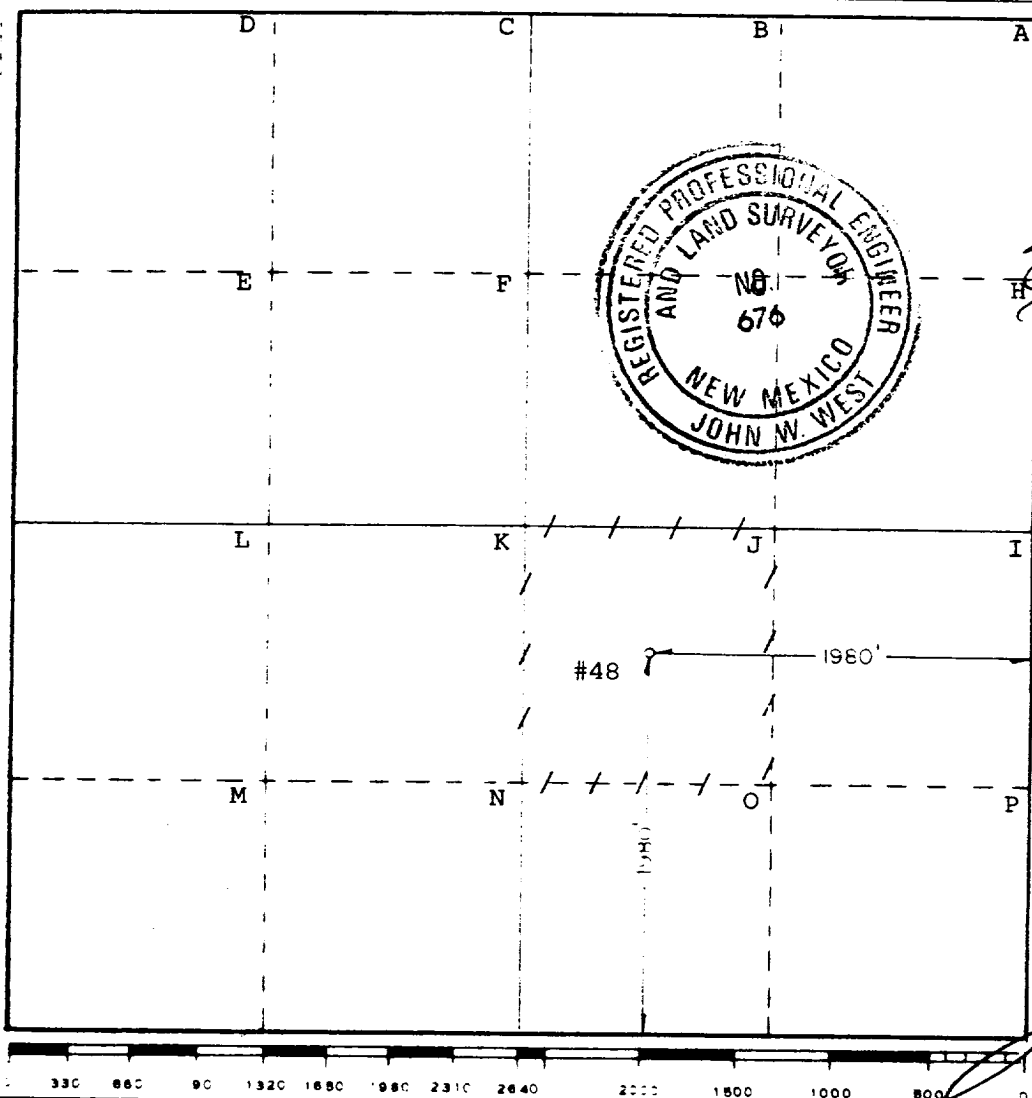

CERTIFICATION	
I hereby certify that the information contained herein is true and complete to the best of my knowledge and belief.	
Signature <i>[Signature]</i>	Name W. J. Mueller
Position Engineering Supervisor, Resv	
Company Phillips Petroleum Company	
Date _____	
I hereby certify that the well location shown on this plat was plotted from field notes of actual surveys made by me or under my supervision, and that the same is true and correct to the best of my knowledge and belief.	
Date Surveyed MAY 5, 1968	
Registered Professional Engineer and/or Land Surveyor <i>[Signature]</i>	
Certificate No. JOHN W. WEST, 676	RONALD J. EIDSON, 3239

96560

held 9-12-88

ELF

RECEIVED

AUG 17 1988

EX-101

RECORDS OFFICE