

NEW MEXICO OIL CONSERVATION COMMISSION
WELL LOCATION AND ACREAGE DEDICATION PLAT

Form O-101
Supersedes O-128
Effective 1-1-85

All distances must be from the outer boundaries of the Section

Owner Phillips Petroleum Company		Lease Leamex		Well No. 54
Section N	Section 23	Township 17 South	Range 34 East	County Lea
Well Location (feet from the West line and South line) 1980 feet from the West line and 660 feet from the South line				
Ground Level Elev. 41-9.2	Producing Formation Grayburg-San Andres	Depth Maljamar Grayburg/San Andres	Estimated Acreage 40 Acres	

1. Outline the acreage dedicated to the subject well by colored pencil or hatchure marks on the plat below.
2. If more than one lease is dedicated to the well, outline each and identify the ownership thereof (both as to working interest and royalty).
3. If more than one lease of different ownership is dedicated to the well, have the interests of all owners been consolidated by communitization, unitization, force-pooling, etc?

☐ Yes ☐ No If answer is "yes," type of consolidation _____

If answer is "no," list the owners and tract descriptions which have actually been consolidated (Use reverse side of this form if necessary.) _____

No allowable will be assigned to the well until all interests have been consolidated (by communitization, unitization, forced-pooling, or otherwise) or until a non-standard unit, eliminating such interests, has been approved by the Commission.

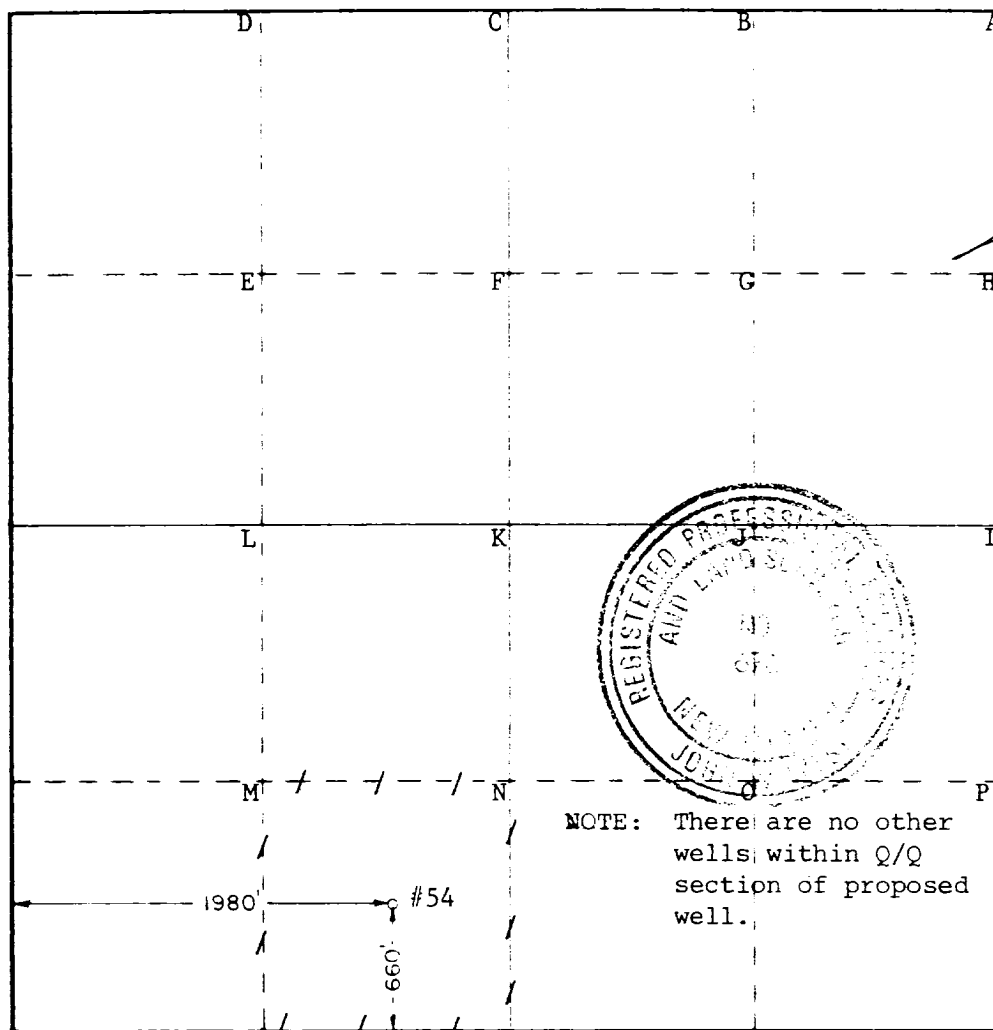

CERTIFICATION

I hereby certify that the information contained herein is true and complete to the best of my knowledge and belief

W. J. Mueller

Engineering Supervisor, Resv.

Phillips Petroleum Company

SEP 20 1988

I hereby certify that the well location shown on this plat was plotted from field notes of actual surveys made by me or under my supervision, and that the same is true and correct to the best of my knowledge and belief

Date Surveyed

September 12, 1988

Registered Professional Engineer and/or Land Surveyor