

Submit to Appropriate  
District Office  
State Lease - 6 copies  
Fee Lease - 5 copies

State of New Mexico  
Energy, Minerals and Natural Resources Department

Form C-101  
Revised 1-1-89

OIL CONSERVATION DIVISION  
P.O. Box 2088  
Santa Fe, New Mexico 87504-2088

DISTRICT I  
P.O. Box 1980, Hobbs, NM 88240

DISTRICT II  
P.O. Drawer DD, Artesia, NM 88210

DISTRICT III  
1000 Rio Brazos Rd., Aztec, NM 87410

API NO. (assigned by OCD on New Wells)
30-025-30504
5. Indicate Type of Lease STATE <input checked="" type="checkbox"/> FEE <input type="checkbox"/>
6. State Oil & Gas Lease No. E-744-15
7. Lease Name or Unit Agreement Name  State E-744-15
8. Well No. 1
9. Pool name or Wildcat Mescalero Escarpe (Bone Spring)

APPLICATION FOR PERMIT TO DRILL, DEEPEN, OR PLUG BACK					
1a. Type of Work: DRILL <input type="checkbox"/> RE-ENTER <input type="checkbox"/> DEEPEN <input type="checkbox"/> PLUG BACK <input checked="" type="checkbox"/>					
b. Type of Well: OIL WELL <input checked="" type="checkbox"/> GAS WELL <input type="checkbox"/> OTHER <input type="checkbox"/> SINGLE ZONE <input type="checkbox"/> MULTIPLE ZONE <input type="checkbox"/>					
2. Name of Operator Marathon Oil Company					
3. Address of Operator P. O. Box 552, Midland, Texas 70702					
4. Well Location Unit Letter <u>I</u> : <u>2086</u> Feet From The <u>South</u> Line and <u>554</u> Feet From The <u>East</u> Line Section <u>15</u> Township <u>18-S</u> Range <u>33-E</u> NMPM <u>Lea</u> County					
10. Proposed Depth 8525'		11. Formation Delaware		12. Rotary or C.T. NA	
13. Elevations (Show whether DF, RT, GR, etc.) 3912' GL, 3922' KB		14. Kind & Status Plug. Bond		15. Drilling Contractor NA	
				16. Approx. Date Work will start 8/18/91	
17. PROPOSED CASING AND CEMENT PROGRAM					
SIZE OF HOLE	SIZE OF CASING	WEIGHT PER FOOT	SETTING DEPTH	SACKS OF CEMENT	EST. TOP
17 1/2"	13 3/8"	48#	450'	410'	Cmt circ
12 1/4"	9 5/8"	40#	3100'	1230'	Cmt circ
8 3/4"	5 1/2"	15.5 & 17#	11,403'	2575'	4910'

Well is currently completed in the First & Second Bone Spring Sands 8626-33', 9430-43', 9452-54', 9456-61' & 9469-76'. Last well test was 14 BOPD, 2 BWPD and gas TSTM. Listed below is the proposed program to plug back the well and recomple to the Corbin, West (Delaware).

1. MIRU pulling unit.
2. POOH w/rods & pump. ND wellhead.
3. NU BOP's. POOH w/tbg.
4. Set CIBP @ ±8575' and bail 50' cmt on top.
5. Test CIPB to 2800 psig.

(continued page 2)

IN ABOVE SPACE DESCRIBE PROPOSED PROGRAM: IF PROPOSAL IS TO DEEPEN OR PLUG BACK, GIVE DATA ON PRESENT PRODUCTIVE ZONE AND PROPOSED NEW PRODUCTIVE ZONE. GIVE BLOWOUT PREVENTER PROGRAM, IF ANY.

I hereby certify that the information above is true and complete to the best of my knowledge and belief.

SIGNATURE S. P. Guidry TITLE Northwest Operations Production Superintendent DATE 9/27/91  
(915)  
TYPE OR PRINT NAME S. P. Guidry TELEPHONE NO. 682-1626

(This space for State Use) Orig. Signed by  
Paul Kautz  
Geologist

APPROVED BY \_\_\_\_\_ TITLE \_\_\_\_\_ DATE \_\_\_\_\_

CONDITIONS OF APPROVAL, IF ANY:

007 07 1991

Item 17 (cont'd)  
Plugback Procedure  
Page 2

6. Run correlation log.
7. Perforate Delaware 5271-90' w/2 JSPF.
8. Acidize Delaware 5271-90' w/2000 gals 7 1/2% NEFE HCl utilizing 55 RCN balls for diversion.
9. Fracture Delaware 5271-90' w/32,522 gals Borate Gel and 93,700# 20/40 Mesh Sand.
10. Shut well in.
11. Swab well to establish productivity.
12. Run tbq, rods and pump.
13. Place well on test pumping to test tank.

Submit to Appropriate  
District Office  
State Lease - 4 copies  
Fee Lease - 3 copies

State of New Mexico  
Energy, Minerals and Natural Resources Department

Form C-102  
Revised 1-1-89

OIL CONSERVATION DIVISION

DISTRICT I  
P.O. Box 1980, Hobbs, NM 88240

P.O. Box 2088  
Santa Fe, New Mexico 87504-2088

DISTRICT II  
P.O. Drawer DD, Artesia, NM 88210

DISTRICT III  
1000 Rio Brazos Rd., Aztec, NM 87410

WELL LOCATION AND ACREAGE DEDICATION PLAT

All Distances must be from the outer boundaries of the section

Operator Marathon Oil Company			Lease State E-744-15		Well No. 1
Unit Letter I	Section 15	Township 18-S	Range 33-E	County NMPM	Lea
Actual Footage Location of Well: 2086 feet from the South line and 554 feet from the East line					
Ground level Elev. 3912' GL	Producing Formation Delaware	Pool Corbin, West	Dedicated Acreage: 40 Acres		
<p>1. Outline the acreage dedicated to the subject well by colored pencil or hatchure marks on the plat below.</p> <p>2. If more than one lease is dedicated to the well, outline each and identify the ownership thereof (both as to working interest and royalty).</p> <p>3. If more than one lease of different ownership is dedicated to the well, have the interest of all owners been consolidated by communitization, unitization, force-pooling, etc.? <input type="checkbox"/> Yes <input type="checkbox"/> No If answer is "yes" type of consolidation _____</p> <p>If answer is "no" list the owners and tract descriptions which have actually been consolidated. (Use reverse side of this form if necessary.) _____</p> <p>No allowable will be assigned to the well until all interests have been consolidated (by communitization, unitization, forced-pooling, or otherwise) or until a non-standard unit, eliminating such interest, has been approved by the Division.</p>					

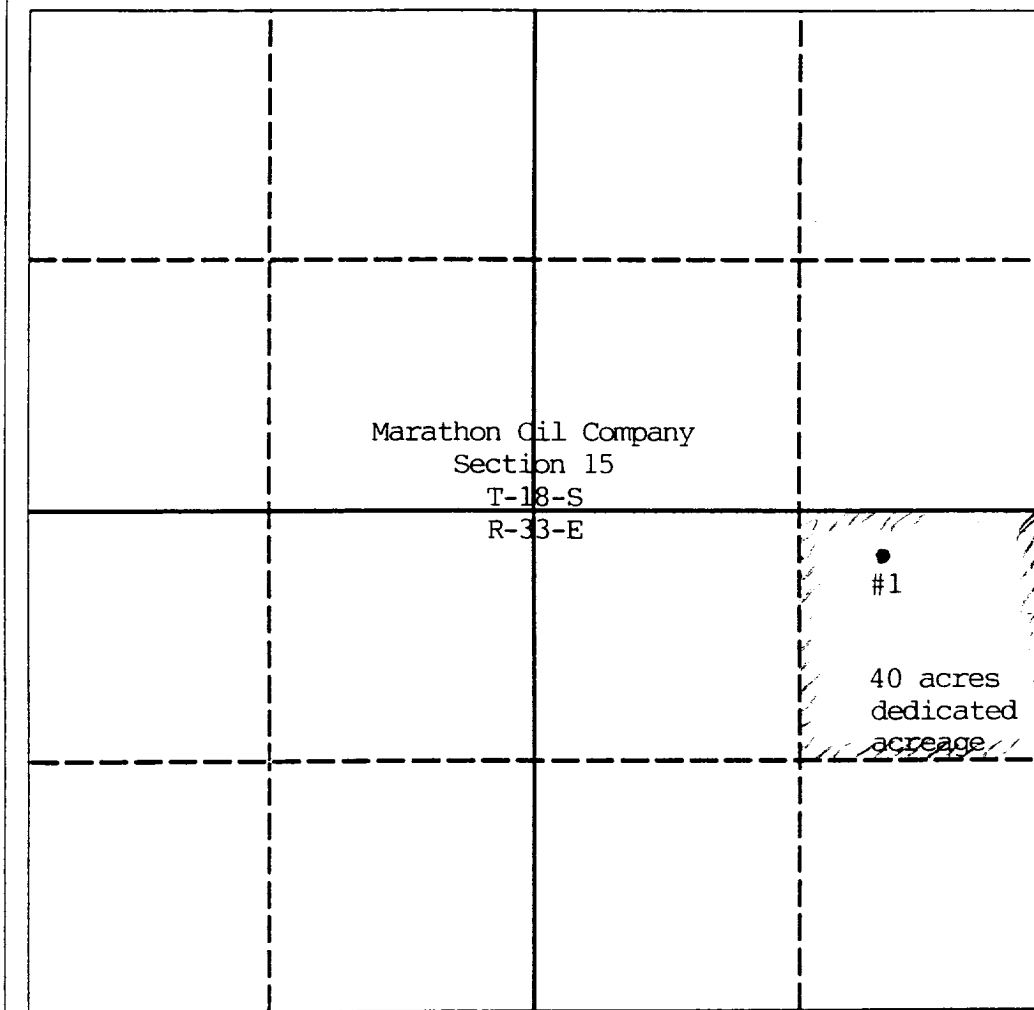

<b>OPERATOR CERTIFICATION</b> I hereby certify that the information contained herein is true, and complete to the best of my knowledge and belief. <i>S. P. Guidry</i> Signature S. P. Guidry Printed Name S. P. Guidry Position Production Superintendent Company Marathon Oil Company Date 9-27-91	
<b>SURVEYOR CERTIFICATION</b> I hereby certify that the well location shown on this plat was plotted from field notes of actual surveys made by me or under my supervision, and that the same is true and correct to the best of my knowledge and belief. Date Surveyed Signature & Seal of Professional Surveyor Certificate No.	

0 330 660 990 1320 1650 1980 2310 2640 2000 1500 1000 500 0