

**NEW MEXICO OIL CONSERVATION COMMISSION
WELL-LOCATION AND ACREAGE DEDICATION PLAT**

Form C-102
Supersedes C-128
Effective 1-1-65

All distances must be from the outer boundaries of the Section.

Operator SOUTHLAND ROYALTY COMPANY operated by MERIDIAN OIL INC.			Lease WEST CORBIN		Well No. 12
Unit Letter B	Section 18	Township 18-SOUTH	Range 33-EAST	County LEA	
Actual Footage Location of Well: <div style="display: flex; justify-content: space-between; align-items: center;"> 660 feet from the NORTH line and 1980 feet from the EAST line </div>					
Ground Level Elev. 3860'	Producing Formation WOLFCAMP		Pool SOUTH CORBIN	Dedicated Acreage: 80 Acres	

1. Outline the acreage dedicated to the subject well by colored pencil or hatchure marks on the plat below.
2. If more than one lease is dedicated to the well, outline each and identify the ownership thereof (both as to working interest and royalty).
3. If more than one lease of different ownership is dedicated to the well, have the interests of all owners been consolidated by communitization, unitization, force-pooling, etc?

☐ Yes ☐ No If answer is "yes," type of consolidation _____

If answer is "no," list the owners and tract descriptions which have actually been consolidated. (Use reverse side of this form if necessary.) _____

No allowable will be assigned to the well until all interests have been consolidated (by communitization, unitization, forced-pooling, or otherwise) or until a non-standard unit, eliminating such interests, has been approved by the Commission.

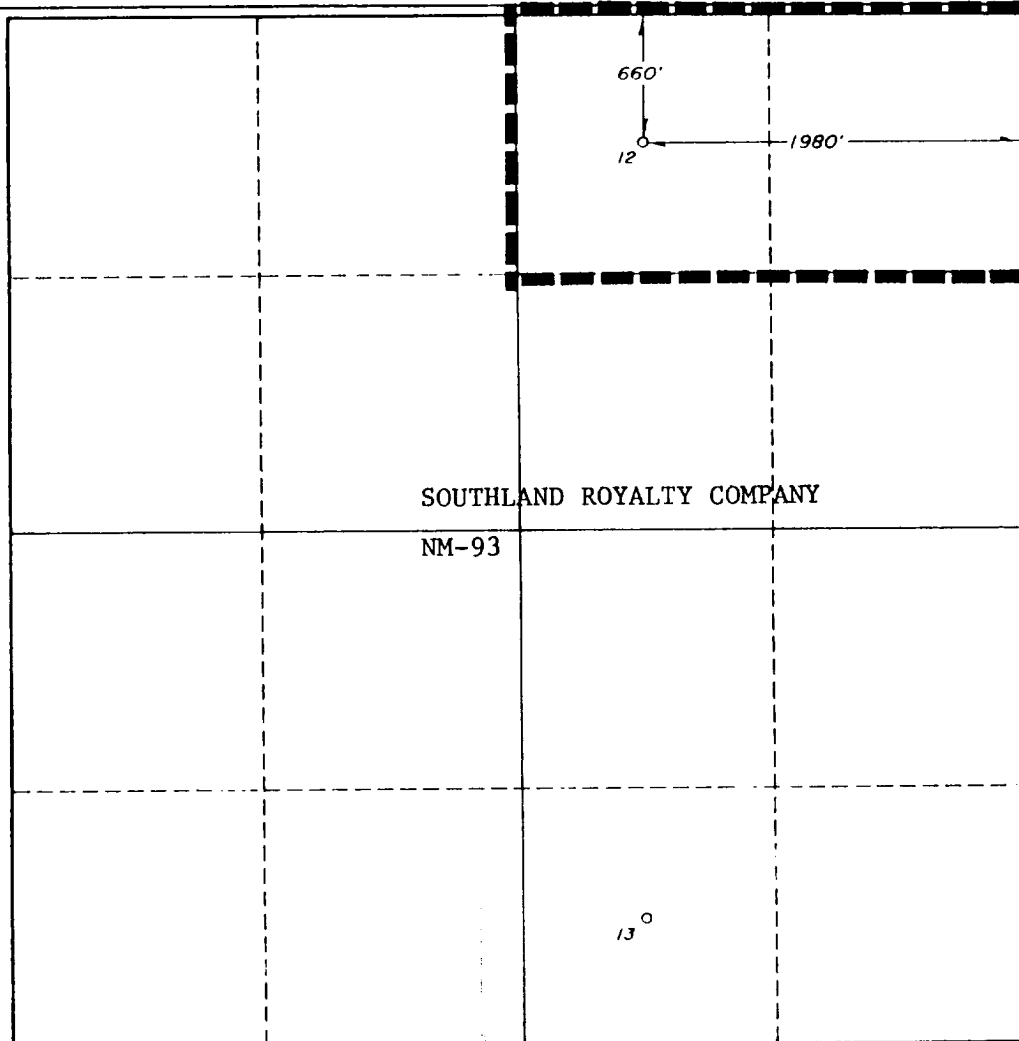

CERTIFICATION

I hereby certify that the information contained herein is true and complete to the best of my knowledge and belief.

Robert L. Bradshaw

Name
Robert L. Bradshaw
Position
Sr. Staff Env./Reg. Spec.
Company
Meridian Oil Inc.
Date
07 June 1989

I hereby certify that the well location shown on this plat was plotted from field notes of actual surveys made by me or under my supervision, and that the same is true and correct to the best of my knowledge and belief.

Date Surveyed
JANUARY 11, 1989
Registered Professional Engineer and/or Land Surveyor

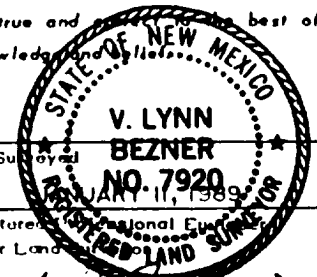

V. Lynn Bezner
Certificate No.
7920

WELL NAME AND NUMBER West Corbin No. 12

LOCATION 1980' FEL & 660' FNL, Section 18, T18S, R33E, Lea County, New Mexico

OPERATOR Meridian Oil Inc.

DRILLING CONTRACTOR TMBR/Sharp Drilling, Inc.

The undersigned hereby certifies that he is an authorized representative of the drilling contractor who drilled the above described well and that he has conducted deviation tests and obtained the following results:

<u>Degrees @ Depth</u>	<u>Degrees @ Depth</u>	<u>Degrees @ Depth</u>	<u>Degrees @ Depth</u>
0.75 348	1.50 6,631	1.25 10,900	
0.75 807	1.50 7,130	0.50 11,450	
0.75 1,308	2.00 7,632		
0.75 1,803	2.00 7,800		
0.25 2,081	2.25 8,107		
1.50 2,580	2.75 8,405		
1.50 2,900	2.75 8,548		
0.75 3,143	3.00 8,869		
1.25 3,609	2.50 8,941		
0.50 4,108	2.75 9,085		
1.00 4,600	2.25 9,334		
0.50 5,050	2.00 9,552		
1.50 5,539	1.50 9,859		
0.75 5,845	2.00 10,338		
1.50 6,321	1.75 10,621		

Drilling Contractor TMBR/Sharp Drilling, Inc.

By

Grady Trotter

Subscribed and sworn to before me this 23rd day of May, 19 89

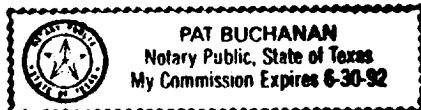

Pat Buchanan
Notary Public

Commission expires: 6-30-92

Midland County, Texas