

Form 3160-5  
(July 1989)  
(Formerly 9-331)

UNITED STATES  
DEPARTMENT OF THE INTERIOR  
BUREAU OF LAND MANAGEMENT

CONTACT RECEIVING  
OFFICE FOR NUMBER  
OF COPIES REQUIRED  
(Other instructions on reverse  
side)

BLM Roswell District  
Modified Form No.  
NMO60-3160-4

**SUNDRY NOTICES AND REPORTS ON WELLS**

(Do not use this form for proposals to drill or to deepen or plug back to a different reservoir.  
Use "APPLICATION FOR PERMIT-" for such proposals.)

1. OIL WELL ☒ GAS WELL ☐ OTHER ☐

2. NAME OF OPERATOR  
**Southland Royalty Company**

3. ADDRESS OF OPERATOR  
**21 Desta Dr., Midland, TX 79705**

3a. AREA CODE & PHONE NO.  
**915/686-5600**

4. LOCATION OF WELL (Report location clearly and in accordance with any State requirements.\*  
See also space 17 below.)  
At surface  
**660' FNL & 1980' FEL**

5. LEASE DESIGNATION AND SERIAL NO.  
**NM-93**

6. IF INDIAN, ALLOTTEE OR TRIBE NAME

7. UNIT AGREEMENT NAME

8. FARM OR LEASE NAME  
**West Corbin Federal**

9. WELL NO.  
**12**

10. FIELD AND POOL, OR WILDCAT  
**South Corbin (Wolfcamp)**

11. SEC., T., R., M., OR BLK. AND  
SURVEY OR AREA  
**Sec. 18, T18S, R33E**

14. PERMIT NO.

15. ELEVATIONS (Show whether DF, RT, GR, etc.)  
**3860' GR.**

12. COUNTY OR PARISH  
**Lea**

13. STATE  
**NM**

**Check Appropriate Box To Indicate Nature of Notice, Report, or Other Data**

16.

NOTICE OF INTENTION TO:

TEST WATER SHUT-OFF ☐  
FRACTURE TREAT ☐  
SHOOT OR ACIDIZE ☐  
REPAIR WELL ☐  
(Other) ☐

PULL OR ALTER CASING ☐  
MULTIPLE COMPLETE ☐  
ABANDON\* ☐  
CHANGE PLANS ☐

SUBSEQUENT REPORT OF:

WATER SHUT-OFF ☐  
FRACTURE TREATMENT ☐  
SHOOTING OR ACIDIZING ☐  
(Other) ☒

REPAIRING WELL ☐  
ALTERING CASING ☐  
ABANDONMENT\* ☐

**Redesignate Proration Unit**

(NOTE: Report results of multiple completion on Well  
Completion or Recompletion Report and Log form.)

17. DESCRIBE PROPOSED OR COMPLETED OPERATIONS (Clearly state all pertinent details, and give pertinent dates, including estimated date of starting any proposed work. If well is directionally drilled, give subsurface locations and measured and true vertical depths for all markers and zones pertinent to this work.)\*

Change proration unit from the 80 acres in the N/2 of the NE/4 to the 80 acres in the W/2 of the NE/4.  
See attached plat showing the standup 80 acres unit.

RECEIVED

APR 3 11 06 AM '90  
CARLSBAD, NEW MEXICO

ACCEPTED FOR RECORD

APR 11 1990

CARLSBAD, NEW MEXICO

18. I hereby certify that the foregoing is true and correct

SIGNED

*Robert L. Bradshaw*

TITLE

**Sr. Staff Env./Reg. Spec.**

DATE

**02 April 1990**

(This space for Federal or State office use)

APPROVED BY

TITLE

DATE

CONDITIONS OF APPROVAL, IF ANY:

**\*See Instructions on Reverse Side**

Title 18 U.S.C. Section 1001, makes it a crime for any person knowingly and willfully to make to any department or agency of the United States any false, fictitious or fraudulent statements or representations as to any matter within its jurisdiction.

MEXICO OIL CONSERVATION COMMISSION  
WELL LOCATION AND ACREAGE DEDICATION PLAT

Form C-162  
Supersedes C-128  
Effective 1-1-65

All distances must be from the outer boundaries of the Section.

Operator <b>SOUTHLAND ROYALTY COMPANY</b>			Lease <b>WEST CORBIN</b>		Well No. <b>12</b>
Unit Letter <b>B</b>	Section <b>18</b>	Township <b>18-SOUTH</b>	Range <b>33-EAST</b>	County <b>LEA</b>	
Actual Footage Location of Well: <b>660</b> feet from the <b>NORTH</b> line and <b>1980</b> feet from the <b>EAST</b> line					
Ground Level Elev. <b>3860'</b>	Producing Formation <b>WOLFCAMP</b>	Pool <b>SOUTH CORBIN</b>		Dedicated Acreage: <b>80</b> Acres	

1. Outline the acreage dedicated to the subject well by colored pencil or hachure marks on the plat below.
2. If more than one lease is dedicated to the well, outline each and identify the ownership thereof (both as to working interest and royalty).
3. If more than one lease of different ownership is dedicated to the well, have the interests of all owners been consolidated by communization, unitization, force-pooling, etc?

☐ Yes ☐ No If answer is "yes," type of consolidation \_\_\_\_\_

If answer is "no," list the owners and tract descriptions which have actually been consolidated. (Use reverse side of this form if necessary.) \_\_\_\_\_

No allowable will be assigned to the well until all interests have been consolidated (by communization, unitization, forced-pooling, or otherwise) or until a non-standard unit, eliminating such interests, has been approved by the Commission.

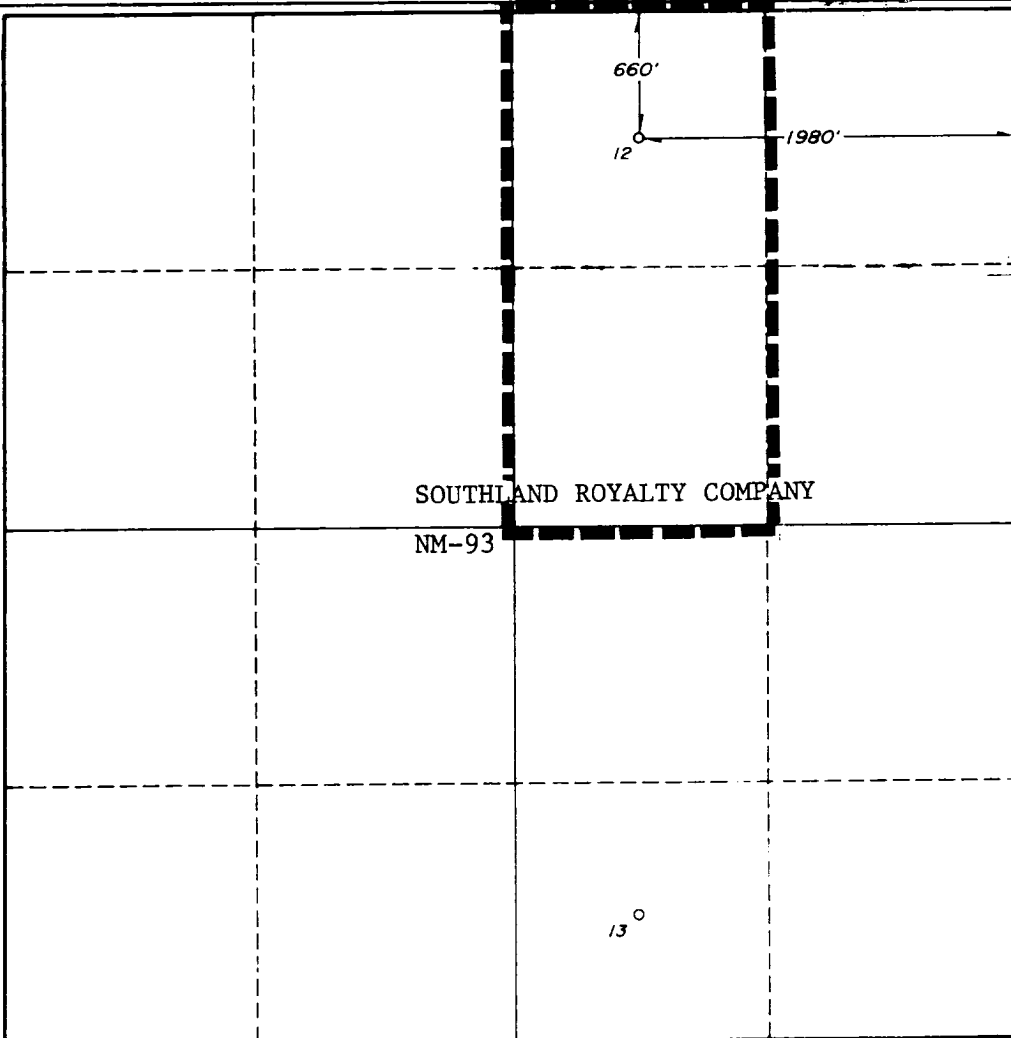

CERTIFICATION

I hereby certify that the information contained herein is true and complete to the best of my knowledge and belief.

*Robert L. Bradshaw*

Name  
**Robert L. Bradshaw**  
Position  
**Sr. Staff Env./Reg. Spec.**  
Company  
**Meridian Oil Inc.**  
Date  
**02 APRIL 1990**

I hereby certify that the well location shown on this plat was plotted from field notes of actual surveys made by me or under my supervision, and that the same is true and correct to the best of my knowledge and belief.

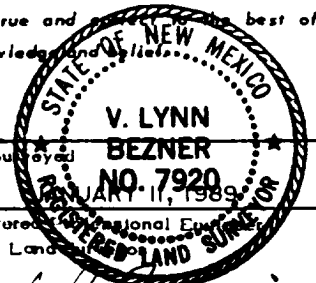

Date Surveyed  
**JANUARY 11, 1989**  
Registered Professional Engineer and/or Land Surveyor  
*V. Lynn Bezner*  
Certificate No.  
**7920**