

NEW MEXICO OIL CONSERVATION COMMISSION
WELL LOCATION AND ACREAGE DEDICATION PLAT

Form C-162
Supersedes C-128
Effective 1-1-65

All distances must be from the outer boundaries of the Section.

Operator MERIDIAN OIL, INC.			Lease FEDERAL MA		Well No. 4
Unit Letter B	Section 21	Township 18-SOUTH	Range 33-EAST	County LEA	
Actual Footage Location of well: 530 feet from the NORTH line and 1910 feet from the EAST line					
Ground Level Elev. 3853'	Producing Formation SOUTH CORBIN		Pool WOLFCAMP		Dedicated Acreage: 80 Acres

1. Outline the acreage dedicated to the subject well by colored pencil or hachure marks on the plat below.
2. If more than one lease is dedicated to the well, outline each and identify the ownership thereof (both as to working interest and royalty).
3. If more than one lease of different ownership is dedicated to the well, have the interests of all owners been consolidated by communitization, unitization, force-pooling, etc?

☐ Yes ☐ No If answer is "yes," type of consolidation _____

If answer is "no," list the owners and tract descriptions which have actually been consolidated. (Use reverse side of this form if necessary.) _____

No allowable will be assigned to the well until all interests have been consolidated (by communitization, unitization, forced-pooling, or otherwise) or until a non-standard unit, eliminating such interests, has been approved by the Commission.

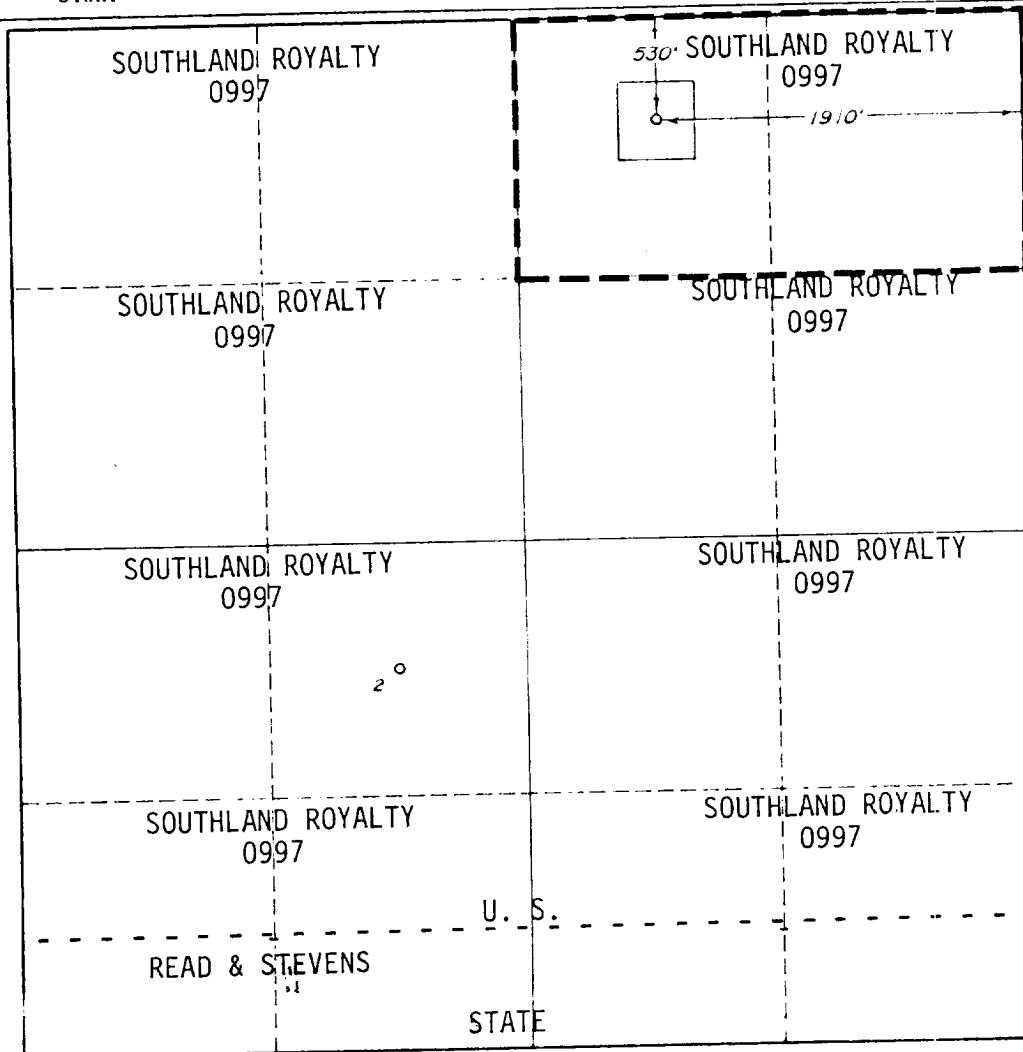

CERTIFICATION

I hereby certify that the information contained herein is true and complete to the best of my knowledge and belief.

Robert L. Bradshaw

Name

Robert L. Bradshaw

Position

St. Staff Env./Reg. Spec.

Company

Meridian Oil Inc.

Date

13 March 1989

I hereby certify that the well location shown on this plat was plotted from field notes of actual surveys made by me or under my supervision, and that the same is true and correct to the best of my knowledge and belief.

Date Surveyed

13 March 1989

Registered and/or Licensed Surveyor

and/or Licensed Surveyor

7920

7920

7920

7920

7920

Amended Plat

RECEIVED

MAR 29 1960

CCC
HOBBS OFFICE