

Submit to Appropriate  
District Office  
State Lease - 4 copies  
Fee Lease - 3 copies

State of New Mexico  
Energy, Minerals and Natural Resources Department

Form C-102  
Revised 1-1-89

OIL CONSERVATION DIVISION

DISTRICT I  
P.O. Box 1980, Hobbs, NM 88240

P.O. Box 2088

Santa Fe, New Mexico 87504-2088

DISTRICT II  
P.O. Drawer DD, Artesia, NM 88210

DISTRICT III  
1000 Rio Brazos Rd., Aztec, NM 87410

WELL LOCATION AND ACREAGE DEDICATION PLAT

All Distances must be from the outer boundaries of the section

Operator Southland Royalty Co.			Lease Federal "21"		Well No. 2
Unit Letter K	Section 21	Township 18-S	Range 33-E	County NMPM	Lea
Actual Footage Location of Well: 1980 feet from the South line and 1980 feet from the West line					
Ground level Elev.	Producing Formation Wolfcamp		Pool South Corbin	Dedicated Acreage: 80 Acres	

- Outline the acreage dedicated to the subject well by colored pencil or hachure marks on the plat below.
- If more than one lease is dedicated to the well, outline each and identify the ownership thereof (both as to working interest and royalty).
- If more than one lease of different ownership is dedicated to the well, have the interest of all owners been consolidated by communitization, unitization, force-pooling, etc.?  
☐ Yes ☐ No If answer is "yes" type of consolidation \_\_\_\_\_  
If answer is "no" list the owners and tract descriptions which have actually been consolidated. (Use reverse side of this form if necessary). \_\_\_\_\_  
No allowable will be assigned to the well until all interests have been consolidated (by communitization, unitization, forced-pooling, or otherwise) or until a non-standard unit, eliminating such interest, has been approved by the Division.

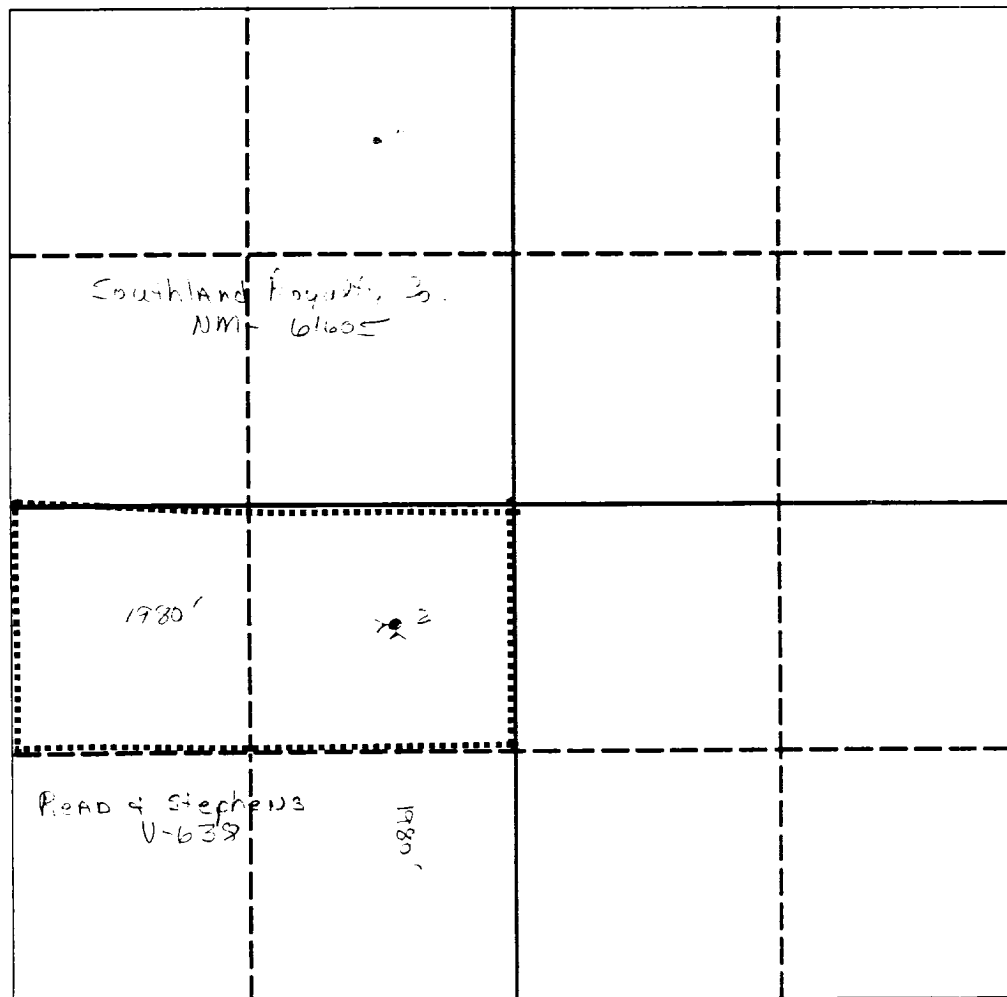

OPERATOR CERTIFICATION

I hereby certify that the information contained herein is true and complete to the best of my knowledge and belief.

Signature  
*Connie L. Malik*  
Printed Name  
Connie L. Malik  
Position  
Reg. Compliance Rep.  
Company  
Southland Royalty Co.  
Date  
10-17-91

SURVEYOR CERTIFICATION

I hereby certify that the well location shown on this plat was plotted from field notes of actual surveys made by me or under my supervision, and that the same is true and correct to the best of my knowledge and belief.

Date Surveyed  
  
Signature & Seal of  
Professional Surveyor

Certificate No.



STATE OF NEW MEXICO  
ENERGY, MINERALS AND NATURAL RESOURCES DEPARTMENT  
OIL CONSERVATION DIVISION  
HOBBS DISTRICT OFFICE

BRUCE KING  
GOVERNOR

July 23, 1991

POST OFFICE BOX 1980  
HOBBS, NEW MEXICO 88241-1980  
(505) 393-6161

Southland Royalty Company  
21 Desta Drive  
Midland, TX 79705

Attn: Connie Malik

Re: Federal "21" #2-K  
Sec. 21, T18S, R33E  
South Corbin Wolfcamp Pool

Gentlemen:

We have a discrepancy in the dedicated acreage for the above-referenced well and one operated by Read & Stevens Inc. (Corbin State #1-N Sec. 21, T18S, R33E).

The S/2 of SW/4 of section 21 is dedicated to the Read & Stevens well, this was authorized by NSL-2537. Southland shows the E/2 SW/4 for their Federal "21" #2. Please file a revised acreage dedication plat for your Federal "21" well #2 outlining the N/2 of SW/4.

Very truly yours,

OIL CONSERVATION DIVISION

Jerry Sexton  
Supervisor, District I

ed

# MERIDIAN OIL

October 17, 1991

State of New Mexico  
Oil Conservation Division  
P. O. Box 1980  
Hobbs, NM 88241-1980

Atten: Evelyn Downs

Re: Southland Royalty Company  
Federal "21" No. 2  
K, Sec 21, T18S, R33E  
South Corbin Wolfcamp Pool

Dear Evelyn

Please find enclosed form C-102 on the above referenced well. This revised plat should correct the discrepancy in the dedicated acreage for our well and the one operated by Read & Stevens Inc. in the same section.

If you need anything further, please call me at 915/688-6898. Thank you for your patience in this matter.

Your very truly,

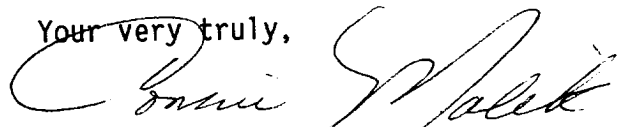

Connie L. Malik  
Regulatory Compliance Rep.

CLM/cm

cc: Well File  
Don McBee  
Maria Perez  
Reading File