

NE EXICO OIL CONSERVATION COMMISS!
WELL LOCATION AND ACREAGE DEDICATION PLAT

Form C-162
Supersedes C-138
Effective 1-4-85

All distances must be from the outer boundaries of the Section.

Operator MERIDIAN OIL, INC.			Lease STATE "16"		Well No. 4
Unit Letter M	Section 16	Township 18-SOUTH	Range 33-EAST	County LEA	
Actual Footage Location of Well: 548 feet from the SOUTH line and 760 feet from the WEST line					
Ground Level Elev.	Producing Formation Wolfcamp		Pool South Corbin		Dedicated Acreage: 80 Acres

1. Outline the acreage dedicated to the subject well by colored pencil or hachure marks on the plat below.
2. If more than one lease is dedicated to the well, outline each and identify the ownership thereof (both as to working interest and royalty).
3. If more than one lease of different ownership is dedicated to the well, have the interests of all owners been consolidated by communitization, unitization, force-pooling, etc?

☐ Yes ☐ No If answer is "yes," type of consolidation _____

If answer is "no," list the owners and tract descriptions which have actually been consolidated. (Use reverse side of this form if necessary.) _____

No allowable will be assigned to the well until all interests have been consolidated (by communitization, unitization, forced-pooling, or otherwise) or until a non-standard unit, eliminating such interests, has been approved by the Commission.

MERIDIAN OIL INC.
LH-1840

MERIDIAN OIL INC.
LG-4087

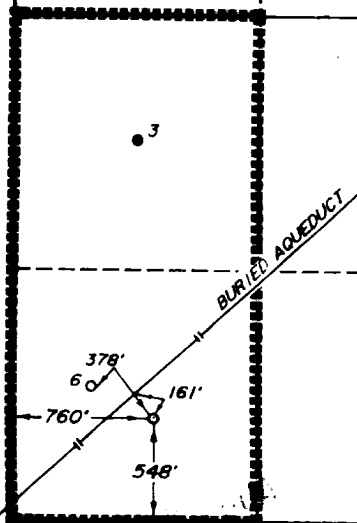

CERTIFICATION

I hereby certify that the information contained herein is true and complete to the best of my knowledge and belief.

Connie Monahan

Name

Connie Monahan

Position

Operations Tech III

Company

Meridian Oil Inc.

Date

August 28, 1989

I hereby certify that the well location shown on this plat was plotted from field notes of actual surveys made by me or under my supervision, and that the same is true and correct to the best of my knowledge and belief.

Date Surveyed

APRIL 27, 1989

Registered Professional Engineer and/or Land Surveyor

V. H. Beyer

Certificate No.

7920