

UNITED STATES  
DEPARTMENT OF THE INTERIOR  
BUREAU OF LAND MANAGEMENT

NM060-3160-2

415  
API # 30-025-30738

APPLICATION FOR PERMIT TO DRILL, DEEPEN, OR PLUG BACK				5. LEASE DESIGNATION AND SERIAL NO. NM-29697		
1a. TYPE OF WORK DRILL <input checked="" type="checkbox"/> DEEPEN <input type="checkbox"/> PLUG BACK <input type="checkbox"/>				6. IF INDIAN, ALLOTTEE OR TRIBE NAME N/A		
b. TYPE OF WELL OIL <input type="checkbox"/> GAS <input type="checkbox"/> SINGLE <input type="checkbox"/> MULTIPLE <input type="checkbox"/> WELL <input checked="" type="checkbox"/> WELL <input type="checkbox"/> OTHER <input type="checkbox"/> ZONE <input checked="" type="checkbox"/> ZONE <input type="checkbox"/>				7. UNIT AGREEMENT NAME N/A		
2. NAME OF OPERATOR Cameron Oil & Gas Company				8. FARM OR LEASE NAME Federal "6"		
3. ADDRESS OF OPERATOR P.O. Box 1455 Roswell, New Mexico 88202-1455				9. WELL NO. 2		
4. LOCATION OF WELL (Report location clearly and in accordance with any State requirements *) At surface 1650 FSL 330 FWL At proposed prod. zone 1650 FSL 330 FWL				10. FIELD AND POOL, OR WILDCAT Maljamar Corbin; Queen		
11. SEC. T., R., M., OR BLK. AND SURVEY OR AREA Sec. 6, T18S, R33E				12. COUNTY OR PARISH Lea		
13. STATE NM				14. DISTANCE IN MILES AND DIRECTION FROM NEAREST TOWN OR POST OFFICE* 8 miles southeast of Maljamar, NM		
15. DISTANCE FROM PROPOSED * LOCATION TO NEAREST PROPERTY OR LEASE LINE, FT. (Also to nearest drlg. unit line, if any)		16. NO. OF ACRES IN LEASE 84		17. NO. OF ACRES ASSIGNED TO THIS WELL 40		
18. DISTANCE FROM PROPOSED LOCATION* TO NEAREST WELL, DRILLING, COMPLETED OR APPLIED FOR, ON THIS LEASE, FT.		19. PROPOSED DEPTH 4200		20. ROTARY OR CABLE TOOLS Rotary		
21. ELEVATIONS (Show whether DF, RT, GR, etc.) 3920 GL				22. APPROX DATE WORK WILL START* on approval		
23. PROPOSED CASING AND CEMENTING PROGRAM						
HOLE SIZE	CASING SIZE	WEIGHT/FOOT	GRADE	THREAD TYPE	SETTING DEPTH	QUANTITY OF CEMENT
See Form 3160-4 Completion Report for HEYCO Ledbetter 6 Federal No. 1, which is original name of this re-entry for casing and cementing data						
No casing will be set as a result of this re-entry.						

This application is for re-entry of HEYCO Ledbetter 6 Federal Well No. 1 to attempt a completion in the Queen Formation. Refer to the Well File of that Well for Casing, Cementing, Logging, and plugging information.

Attachments:

Survey Plat, NMOCD Form C-102  
Drilling Plan

Exhibit A: RE-ENTRY Procedure Summary

Attachment 1.: Form 3160-4 Well Completion Report submitted by HEYCO, operator of original well.

Attachment 2.: Form 3160-5 Sundry Notice -Plugging Report- submitted by HEYCO, operator of original well.

Surface Use Plan

Exhibit B: NMSHD Highway Quad

Exhibit C: USGS Topo Quad (HEYCO app. Ex. A & ASC project map 89-166)

Exhibit D: Vicinity Map ( Ex. B from HEYCO application)

Exhibit E: Lease Map

NOT SUBJECT TO  
PAYMENTS AND  
FEES

IN ABOVE SPACE DESCRIBE PROPOSED PROGRAM: If proposal is to deepen or plug back, give data on present productive zone and proposed new productive zone. If proposal is to drill or deepen directionally, give pertinent data on subsurface locations and measured and true vertical depths. Give blowout preventor program, if any.

24. SIGNED [Signature] TITLE AGENT FOR APPLICANT DATE 2/5/01

(This space for Federal or State office use)

PERMIT NO. \_\_\_\_\_ APPROVAL DATE \_\_\_\_\_

APPROVED BY [Signature] DATE 2/5/01

CONDITIONS OF APPROVAL \_\_\_\_\_

OPER. OGRID NO. 181109  
PROPERTY NO. 26650  
POOL CODE 13280  
EFF. DATE 8-10-01  
API NO. 30-025-30738

\*See Instructions On Reverse Side

District I  
1625 N. French Dr., Hobbs, NM 88240  
District II  
1301 W. Grand Avenue, Artesia, NM 88210  
District III  
1000 Rio Brazos Rd., Aztec, NM 87410  
District IV  
1220 S. St. Francis Dr., Santa Fe, NM 87505

State of New Mexico  
Energy, Minerals & Natural Resources Department  
OIL CONSERVATION DIVISION  
1220 South St. Francis Dr.  
Santa Fe, NM 87505

Form C-102  
Revised August 15, 2000  
Submit to Appropriate District Office  
State Lease - 4 Copies  
Fee Lease - 3 Copies

☐ AMENDED REPORT

WELL LOCATION AND ACREAGE DEDICATION PLAT

<sup>1</sup> API Number 30-025-30738	<sup>2</sup> Pool Code 13280	<sup>3</sup> Pool Name CORBIN Queen
<sup>4</sup> Property Code 26650	<sup>5</sup> Property Name Federal Co	<sup>6</sup> Well Number 2
<sup>7</sup> OGRID No. 181109	<sup>8</sup> Operator Name CAMERON OIL & GAS CO.	<sup>9</sup> Elevation 3920 GL

<sup>10</sup> Surface Location

U/L or lot no. L	Section 6	Township 18S	Range 33E	Lot Idn L	Feet from the 1650	North/South line SOUTH	Feet from the 330	East/West line West	County Lea
---------------------	--------------	-----------------	--------------	--------------	-----------------------	---------------------------	----------------------	------------------------	---------------

<sup>11</sup> Bottom Hole Location If Different From Surface

U/L or lot no.	Section	Township	Range	Lot Idn	Feet from the	North/South line	Feet from the	East/West line	County
----------------	---------	----------	-------	---------	---------------	------------------	---------------	----------------	--------

<sup>12</sup> Dedicated Acres 40	<sup>13</sup> Joint or Infill	<sup>14</sup> Consolidation Code	<sup>15</sup> Order No.
-------------------------------------	-------------------------------	----------------------------------	-------------------------

NO ALLOWABLE WILL BE ASSIGNED TO THIS COMPLETION UNTIL ALL INTERESTS HAVE BEEN CONSOLIDATED OR A NON-STANDARD UNIT HAS BEEN APPROVED BY THE DIVISION

<sup>16</sup> 	<sup>17</sup> OPERATOR CERTIFICATION <i>I hereby certify that the information contained herein is true and complete to the best of my knowledge and belief.</i>  Signature DAVID Sweeney Printed Name Superintendent Title 8-7-01 Date
	<sup>18</sup> SURVEYOR CERTIFICATION <i>I hereby certify that the well location shown on this plat was plotted from field notes of actual surveys made by me or under my supervision, and that the same is true and correct to the best of my belief.</i> Date of Survey Signature and Seal of Professional Surveyor Certificate Number

# OIL CONSERVATION DIVISION

P.O. Box 2088

Santa Fe, New Mexico 87504-2088

## DISTRICT I

P.O. Box 1980, Hobbs, NM 88240

## DISTRICT II

P.O. Drawer DD, Artesia, NM 88210

## DISTRICT III

1000 Rio Brazos Rd., Aztec, NM 87410

## WELL LOCATION AND ACREAGE DEDICATION PLAT

All Distances must be from the outer boundaries of the section

Operator Harvey E. Yates Company			Lease Ledbetter 6 Federal		Well No. 1
Unit Letter L	Section 6	Township 18 South	Range 33 East	County NMPM	Lea
Actual Footage Location of Well: 1650 feet from the South line and 330 feet from the West line					
Ground level Elev. 3919.8	Producing Formation Bone Springs		Pool North Young	Dedicated Acreage: 40 Acres	

- Outline the acreage dedicated to the subject well by colored pencil or hatchure marks on the plat below.
- If more than one lease is dedicated to the well, outline each and identify the ownership thereof (both as to working interest and royalty).
- If more than one lease of different ownership is dedicated to the well, have the interest of all owners been consolidated by communitization, unitization, force-pooling, etc.?  
☐ Yes ☐ No If answer is "yes" type of consolidation \_\_\_\_\_  
If answer is "no" list the owners and tract descriptions which have actually been consolidated. (Use reverse side of this form if necessary.)  
No allowable will be assigned to the well until all interests have been consolidated (by communitization, unitization, forced-pooling, or otherwise) or until a non-standard unit, eliminating such interest, has been approved by the Division.

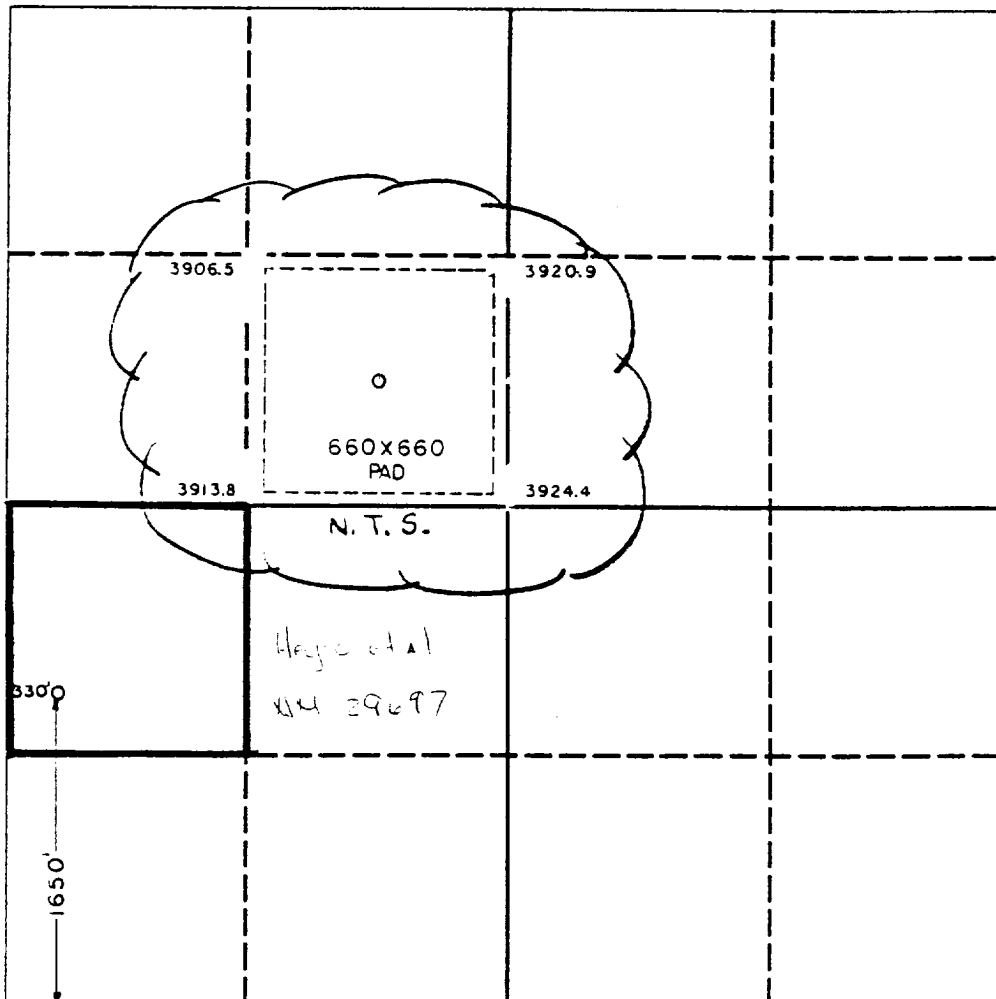

### OPERATOR CERTIFICATION

I hereby certify that the information contained herein is true and complete to the best of my knowledge and belief.

Signature

*N.M. Young*

Printed Name

NM Young

Position

Drilling Superintendent

Company

Harvey E. Yates Company

Date

11/1/89

### SURVEYOR CERTIFICATION

I hereby certify that the well location shown on this plat was plotted from field notes of actual surveys made by me or under my supervision, and that the same is true and correct to the best of my knowledge and belief.

Date Surveyed

October 24, 1989

Signature & Seal of  
Professional Surveyor



**DRILLING PLAN**  
**To Accompany**  
**APPLICATION FOR PERMIT TO DRILL**

*Cameron Oil & Gas Company*  
*FEDERAL "6" WELL No. 2*  
*1650 FSL & 330 FWL*  
*SEC. 6, T18S, R33E, N.M.P.M.*  
*Lea County, New Mexico*

In conjunction with Form 3160-3, Application for Permit to Drill, Cameron Oil & Gas Company submits the following items of pertinent information in accordance with Onshore Oil & Gas Order Nos. 1 & 2, and with all other applicable federal and state regulations.

**1.   Tops of Geologic Markers**

The surface geologic formation is Quaternary Alluvium and Bolson deposits, overlying undifferentiated limestones and anhydrites of Permian age; the tops of geologic markers encountered when the previous well was drilled are as follows:

FORMATION	DEPTH	SUBSEA
Land Surface	0	3920
Rustler	1360	2560
Yates	2865	1055
Seven Rivers	3300	620
Bowers	3774	146
Queen	4080	-160
Penrose	4336	-416
Grayburg	4626	-706
Delaware	5338	-1418
Bone Spring	6290	-2370

**2.   The estimated depths at which water, oil, or gas formations are expected to be encountered:**

**A.   Fresh Water**

Will not be encountered; it is behind two strings of casing which were cemented to surface. See attached form 3160-4 Well Completion Report for description of existing casing program.

**B.   Oil or Gas:**

Formation	Hydrocarbon	Depth
Queen	Oil	4080

Potentially productive horizon is protected by 5-1/2" production casing with cement extending to surface. See attached form 3160-4 Well Completion Report for description of existing casing program.

**3. Pressure Control Equipment**

Blow Out protection will be afforded through the use of a 6 inch 900 series manually operated BOP, rated for 3000 PSI, and equipped with both pipe and blind rams. The BOP will be nipped up on the 8-5/8 inch casing, which was cemented to surface and will now become the production casing at the surface. Equipment will be tested on a daily schedule.

**4. Proposed Casing Program:**

NO casing will be run for this re-entry; the well is already cased and cemented. See attached form 3160-4 Well Completion Report for description of existing casing program.

**5. Mud Program:**

Utilise a freshwater - gel/lime mud system as required to drill out plugs above zone of interest at 4200 feet. Refer to the Attached Sundry Notice filed at time of plugging by HEYCO for plug depths and descriptions. Two percent KCl water will be the fluid in the wellbore at time of perforating for completion.

**6. Testing, Logging, and Coring Programs:**

See attached form 3160-4 Well Completion Report for description of existing casing program and logging and testing conducted at that time. No logging will be conducted as part of this re-entry.

**7. Abnormal Pressures, Temperatures, or other Hazards:**

Lost Circulation Zones:

Zones of lost circulation are not a factor as the well is already cased and cemented to TD.

High Pressure Zones:

Above normal pressures are not a factor as the well is already cased and cemented to TD. Above normal pressures were not reported when the well was originally drilled.

**8. Anticipated Starting Date:**

As soon as possible.

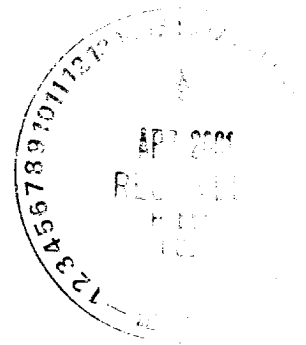

**RE-ENTRY PROCEDURE  
To Accompany  
APPLICATION FOR PERMIT TO DRILL**

*Cameron Oil & Gas Company  
FEDERAL "6" WELL No. 2  
1650 FSL & 330 FWL  
SEC. 6, T18S, R33E, N.M.P.M.  
Lea County, New Mexico*

1. Remove Dry Hole marker, install well head, deadman anchors, and dig workover pit.
2. MIRU well service unit, install BOP. Pick up 7-7/8" bit & 4-3/4" Drill collars. Drill out surface plug, continue in hole w/4-3/4" collars & 2-7/8" tbg. Drill out Cement plug @ 356'-456'. Continue in hole; Drill out plug @ 2420'-2475' or to top of 5-1/2" casing.
3. Continue in hole, rotating, tag top of 5-1/2" x 17# csg. Stub @ 2500'±. Circulate clean & POH.
4. RIH w/4-3/4" bit, 4-3/4" DC & 2-7/8" tbg. Rotate into 5-1/2" csg stub. (If needed, dress off 5-1/2" casing stub with dress-off mill or tapered mill). Drill out cement (bottom @ 2575'±) & continue in hole to 4200'±. Circulate well bore clean & displace with 2% KCL Water. Pressure test casing to 500 psi.
5. POH, lay down DC, tools & tbg. RU wireline truck, RIH w/4-1/2" perforating guns and Gamma Ray tie-in tool. Perforate Queen Formation; POH
6. RIH w/5'1/2" Baker packer (Model R) to end of perfs. Spot 2 bbls of 7-1/2% acid over perfs. Pull packer to 4050 and set. Breakdown perfs and pump away spent acid. Open bypass and spot 1000 gals of 7-1/2% NEFE Acid w/additives to end of packer. Set bypass and acidize perforations.
7. Swab test and evaluate results
8. Frac w/20,000 gals. Oil & 25,000 lbs. Sand. SI overnight; POH, RIH w/production string & pump. Start Well Producing.

EXHIBIT "A"  
CAMERON OIL & GAS  
COMPANY  
FEDERAL "6" WELL No. 2  
UNIT L, Sec 6, T18S, R33E





UNITED STATES  
DEPARTMENT OF THE INTERIOR  
BUREAU OF LAND MANAGEMENT

BLM - CARLETON

Form approved.  
Budget Bureau No. 1004-0137  
Expires August 31, 1985

5. LEASE DESIGNATION AND SERIAL NO.

NM-29697

6. IF INDIAN, ALLOTTEE OR TRIBE NAME

7. UNIT AGREEMENT NAME

8. FARM OR LEASE NAME

Ledbetter 6 Federal

9. WELL NO.

#1

10. FIELD AND POOL, OR WILDCAT

North Young Bone Springs

11. SEC., T., R., M., OR BLOCK AND SURVEY OR AREA

Sec. 6, T18S, R33E

12. COUNTY OR PARISH

Lea

13. STATE

NM

WELL COMPLETION OR RECOMPLETION REPORT AND LOG

1a. TYPE OF WELL:

OIL WELL ☒ GAS WELL ☐ DRY ☐ Other ☐

b. TYPE OF COMPLETION:

NEW WELL ☒ WORK OVER ☐ DEEP-EN ☐ PLUG BACK ☐ DIFF. RESVR. ☐ Other ☐

2. NAME OF OPERATOR

Harvey E. Yates Company

3. ADDRESS OF OPERATOR

P.O. Box 1933, Roswell, New Mexico 88202

4. LOCATION OF WELL (Report location clearly and in accordance with any State requirements)\*

At surface

1650' FSL & 330' FWL

At top prod. interval reported below

At total depth same

14. PERMIT NO.

30-025-30738

DATE ISSUED

11/27/90

15. DATE SPUDDED

12/27/90

16. DATE T.D. REACHED

1/11/90

17. DATE COMPL. (Ready to prod.)

1/30/90

18. ELEVATIONS (DF, RKB, RT, GR, ETC.)\*

3919.8 GL

19. ELEV. CASINGHEAD

3919.8

20. TOTAL DEPTH, MD & TVD

9192

21. PLUG BACK T.D., MD & TVD

9148

22. IF MULTIPLE COMPL., HOW MANY\*

23. INTERVALS DRILLED BY

ROTARY TOOLS

CABLE TOOLS

Rotary

24. PRODUCING INTERVAL(S), OF THIS COMPLETION—TOP, BOTTOM, NAME (MD AND TVD)\*

7974-8962 (oa)

25. WAS DIRECTIONAL SURVEY MADE

No

26. TYPE ELECTRIC AND OTHER LOGS RUN

DLL w/Micro & DN w/GR

27. WAS WELL CORED

No

28. CASING RECORD (Report all strings set in well)

CASING SIZE	WEIGHT, LB./FT.	DEPTH SET (MD)	HOLE SIZE	CEMENTING RECORD	AMOUNT PULLED
13 3/8	54.5	405	17 1/2	425	Circ to surface
8 5/8	32	2983	12 1/4	1400	Circ to surface
5 1/2	17	9192	7 7/8	1275	TOC @ 2500'

29. LINER RECORD

SIZE	TOP (MD)	BOTTOM (MD)	SACKS CEMENT*	SCREEN (MD)	SIZE	DEPTH SET (MD)	PACKER SET (MD)
					2 3/8	8520	

31. PERFORATION RECORD (Interval, size and number)

8628-8962 (11 holes- 2 @ 8930)  
\*8408-24' (2 spf-33 holes)  
\*8250-66' (oa) (2 spf-33 holes)  
\*8049-71 (oa) (1 spf-9 holes)  
\*7974-80 (2 spf-13 holes)

32. ACID, SHOT, FRACTURE, CEMENT SQUEEZE, ETC.

DEPTH INTERVAL (MD)	AMOUNT AND KIND OF MATERIAL USED
8628-8962	Acidz w/3000 gals SRA + 26 BS, Frac w/10,000 gals pre-pad, 110,000 gals BS-40 +171,250# Carbolite *See attached Sundry
*	

33. PRODUCTION

DATE FIRST PRODUCTION 2/2/90		PRODUCTION METHOD (Flowing, gas lift, pumping—size and type of pump) Pumping				WELL STATUS (Producing or shut-in) Shut In	
DATE OF TEST 2/3/90	HOURS TESTED 24	CHOKER SIZE	PROD'N. FOR TEST PERIOD →	OIL—BBL. 10	GAS—MCF. 0	WATER—BBL. 127	GAS-OIL RATIO
FLOW. TUBING PRESS. 0	CASING PRESSURE 0	CALCULATED 24-HOUR RATE →	OIL—BBL. 10	GAS—MCF. 0	WATER—BBL. 127	OIL GRAVITY-API (CORR.)	

34. DISPOSITION OF GAS (Sold, used for fuel, vented, etc.)

TEST WITNESSED BY

Ray Coor

35. LIST OF ATTACHMENTS

Deviation Survey, E-logs & Sundry

36. I hereby certify that the foregoing and attached information is complete and correct as determined from all available records

SIGNED V. Teel V. Teel TITLE Prod Secretary

\*(See Instructions and Spaces for Additional Data on Reverse)

Title 18 U.S.C. Section 1001, makes it a crime for any person knowingly and willfully to make any false, fictitious or fraudulent statements or representations as to any matter

ATTACHMENT "1"  
CAMERON OIL & GAS  
COMPANY  
FEDERAL "6" WELL No. 2  
UNIT L, Sec 6, T18S, R33E

AUG 27 1992

Print Approved.  
Budget Bureau No. 42-81424

UNITED STATES  
DEPARTMENT OF THE INTERIOR  
GEOLOGICAL SURVEY

**SUNDRY NOTICES AND REPORTS ON WELLS**

(Do not use this form for proposals to drill or to deepen or plug back to a different reservoir. Use Form 9-581-C for such proposals.)

1. ☒ oil well ☐ gas well ☐ other

2. NAME OF OPERATOR

Harvey E. Yates Company

3. ADDRESS OF OPERATOR

P.O. Box 1933 Roswell, NM 88202

4. LOCATION OF WELL (REPORT LOCATION CLEARLY. See space 17 below.)

AT SURFACE:

AT TOP PROD. INTERVAL:

AT TOTAL DEPTH:

16. CHECK APPROPRIATE BOX TO INDICATE NATURE OF NOTICE, REPORT, OR OTHER DATA

REQUEST FOR APPROVAL TO:

TEST WATER SHUT-OFF ☐

FRACATURE TREAT ☐

SHOOT OR ACIDIZE ☐

REPAIR WELL ☐

PULL OR ALTER CASING ☐

MULTIPLE COMPLETE ☐

CHANGE ZONES ☐

ABANDON\* ☐

(other) ☐

SUBSEQUENT REPORT OF:

☐  
☐  
☐  
☐  
☐  
☐  
☐  
☒

5. LEASE  
NM 29697

6. IF INDIAN, ALLOTTEE OR TRIBE NAME

7. UNIT AGREEMENT NAME

8. FARM OR LEASE NAME

Ledbetter 6 Federal

9. WELL NO.

1

10. FIELD OR WILDCAT NAME

North Young Bone Spring

11. SEC., T., R., M., OR BLK. AND SURVEY OR AREA

Unit L, Sec 6, T-185, R33E

12. COUNTY OR PARISH

13. STATE

Lea

NM

14. API NO.

30-025-30738

15. ELEVATIONS (SHOW OF, KDB, AND WD)

(NOTE: Report results of multiple completion or some change on Form 9-581.)

17. DESCRIBE PROPOSED OR COMPLETED OPERATIONS (Clearly state all pertinent details, and give pertinent dates, including estimated date of starting any proposed work. If well is directionally drilled, give subsurface locations and measured and true vertical depths for all markers and zones pertinent to this work.)\*

7-28-92 CIBP @ 7900' - Spot 15 sxs on top  
7-28-92 Spot 40 sxs @ 5375' - 5225'  
7-29-92 Spot 50 sxs @ 2575' - 2420' tagged  
7-30-92 Spot 40 sxs @ 456' - 356'  
7-30-92 Spot 20 sxs @ 50' - surface  
7-30-92 Install dry hole marker  
Circulate hole with 9.5 mud  
Pulled 2500' of 5 1/2" casing.

Approved as to ...  
Liability under bond is retained until  
surface restoration is completed.

Subsurface Safety Valve: Manu. and Type \_\_\_\_\_ Set @ \_\_\_\_\_ Ft.

18. I hereby certify that the foregoing is true and correct

SIGNED Jim Yates TITLE Gen. Mgr. DATE 8/27/92

(This space for Federal or State office use)

APPROVED BY Blaine Beland TITLE Geological Engineer DATE 9/16/92  
CONDITIONS OR APPROVAL, IF ANY:

\*See Instructions on Reverse Side

mailed to postman  
8-29-92  
ATTACHMENT "2"  
CAMERON OIL & GAS  
COMPANY  
FEDERAL "6" WELL No. 2  
UNIT L, Sec 6, T18S, R33E



**SURFACE USE PLAN**  
**To Accompany**  
**APPLICATION FOR PERMIT TO DRILL**

*Cameron Oil & Gas Company*  
*FEDERAL "6" WELL No. 2*  
*1650 FSL & 330 FWL*  
*SEC. 6, T18S, R33E, N.M.P.M.*  
*Lea County, New Mexico*

**1. EXISTING ROADS**

**A. REGIONAL MAP**

Exhibit "B" is a portion of the New Mexico State Highway Department Quadrangle No. 107, "Maljamar", showing the regional road network and access from the nearest Federal Highways.

**B. NARRATIVE ACCESS DIRECTIONS**

From Artesia, New Mexico, travel East on U.S. 82 a distance of 31.5 miles to NM 529. Turning on NM 529, travel to mile marker 10.95; turn right and travel southwest on a caliche road for 1.9 miles. Turn left on lease road and travel south for 1/2 mile; Turn left again and travel east 1/2 mile; Turn left and travel northeast 1/4 mile; turn north onto the existing wellpad. Exhibits "C" and "D" illustrate this narrative.

**C. SITE MAP**

Exhibit "C" is a reproduction of a portion of the U.S.G.S. 7.5' Topographic Quadrangle "Dog Lake, NM", showing the wellsite and access roads as constructed.

**D. ROAD MAINTENANCE**

All roads shall be maintained in a condition equal to or better than that which existed prior to the start of operations under this application.

**2. PLANNED ACCESS ROADS**

No new access road will be constructed.



**3. LOCATION OF EXISTING WELLS WITHIN ONE MILE RADIUS AREA OF CONCERN**

- A. Water Wells: None
- B. Disposal Wells: None
- C. Drilling Wells: None at this time
- D. Producing Wells: Numerous, as shown on Exhibits "C", "D", and "E"
- E. Abandoned Wells: Several, as shown on Exhibit "E"

**4. LOCATION OF PRODUCTION FACILITIES**

Upon completion of a producing well the Operator will furnish maps and diagrams showing ON WELL PAD facilities and OFF WELL PAD facilities as proposed along with a SUNDRY NOTICE prior to construction of these facilities.

**5. LOCATION AND TYPE OF WATER SUPPLY**

Drilling fluids will be purchased on location from a licensed commercial water hauling firm who both owns the water and who has transported same by truck over the designated access route. Applicant has no intent to either appropriate waters of the State of New Mexico or acquire any interest in or control over any source of the drilling water purchased from commercial suppliers of those products.

**6. SOURCE OF CONSTRUCTION MATERIALS**

No new construction is contemplated; no caliche will be required.

**7. METHOD OF WASTE DISPOSAL**

**A. Solid Waste:**

- 1. Drill cuttings will be disposed of in the reserve pit.

2. Trash, waste paper, and garbage will be disposed of in a dumpster located on the wellpad and serviced by a commercial disposal company.
3. Salt, starch, bentonite gel, and other related chemicals will be stored in the manufacturer's containers until used; unused and/or damaged containers will be removed from the wellsite.

**B. Liquid Waste:**

1. Human waste will be trucked from the site by the contractor providing the rented portable Chemical Toilet maintained onsite for the rig crews.
2. Drilling Fluid will be allowed to evaporate in the reserve pit until the pit is dry enough to backfill.
3. Water produced during testing of the well will be disposed of in the reserve pit, where it will evaporate.
4. Oil produced during testing of the well will be stored in test tanks until sold and hauled from the site

**8. ANCILLARY FACILITIES**

No ancillary facilities are proposed at this time.

**9. WELLSITE LAYOUT**

- A. This re-entry will be accomplished utilizing a reverse circulation unit and a pulling unit. The specific wellsite arrangement and pit location will be a function of the particular workover unit utilized.
- B. Reserve pits will only need to contain 100-150 bbls. of drilling fluid and will be sized accordingly.
- C. Earthen pits excavated below pad grade will be utilized for the active mud circulation system; the reserve pit used for final separation of suspended



drill cuttings.

- D. Pits are to be lined with a plastic liner which will extend beyond the crest a minimum of 2 ft. and will be anchored with earth in the standard industry practice. Depth of reserve pit will be such that the contained drill cuttings will be buried at least 36 inches when the pit is backfilled.
- E. The reserve pit will be fenced on three sides with a four strand barbwire fence during drilling and completion; after drilling operations cease the remaining side will be fenced. The fence will be removed when the reserve pit is backfilled.

#### **10. SURFACE RESTORATION**

- A Rehabilitation and restoration of the location and reserve pit will start in a timely manner upon the cessation of drilling operations.
- B. The reserve pit shall be allowed to dry, and then backfilled. The area will be leveled and reshaped to eliminate erosion while maintaining the general topography of the preconstruction landform.
- D. Wellpad and access road will be recontoured and re-vegetated according to BLM recommendations in effect at the time of plugging the well. Re-vegetation will be in accordance with BLM recommendations.

#### **11. OTHER INFORMATION**

- A. CULTURAL RESOURCES  
Subsequent to performing a Class I Cultural Resource Investigation, a Class III Cultural Resource Investigation was conducted by Archaeological Survey Consultants on the wellsite and associated access road at the time of the initial permitting. The report of that investigation (ASC project 88-117) was submitted under separate cover.
- B. DEVELOPMENT  
Other than fences, powerlines, and pipelines, there are no other improvements in the area.

**C. OWNERSHIP**

Land surface affected by this application is Fee surface. The Owner of Record is

Herschel & Gary Caviness (505) 676-4201  
Star Route  
Causey, NM 88113

Agreements regarding surface damage and reclamation made by HEYCO are still in effect; Cameron Oil & Gas is HEYCO's successor on this lease, and no new impacts will occur as a result of this application.

**D. LANDFORM AND VEGETATION**

Will not be impacted by this re-entry, as no soil disturbance off the existing pad will occur.

**12. OPERATOR'S REPRESENTATIVE**

Project Coordinator

Mr. David Sweeney (505) 420-1108  
Cameron Oil & Gas Company  
P.O. Box 1455  
Roswell, NM 88201-1455

**13. CERTIFICATION**

I hereby certify that I, or persons under my direct supervision, have inspected the proposed drill site and access route; that I am familiar with the conditions which currently exist; that the statements made in this plan are to the best of my knowledge true and correct; and that the work associated with the operations proposed herein will be performed by the applicant and its contractors and subcontractors in conformity with this plan and the terms and conditions under which it is approved. This statement is subject to the provisions of §18 U.S.C. 1001 for the filing of a false statement.

  
\_\_\_\_\_  
P.R. Patton, Agent for applicant

Date

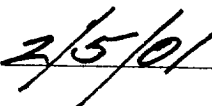

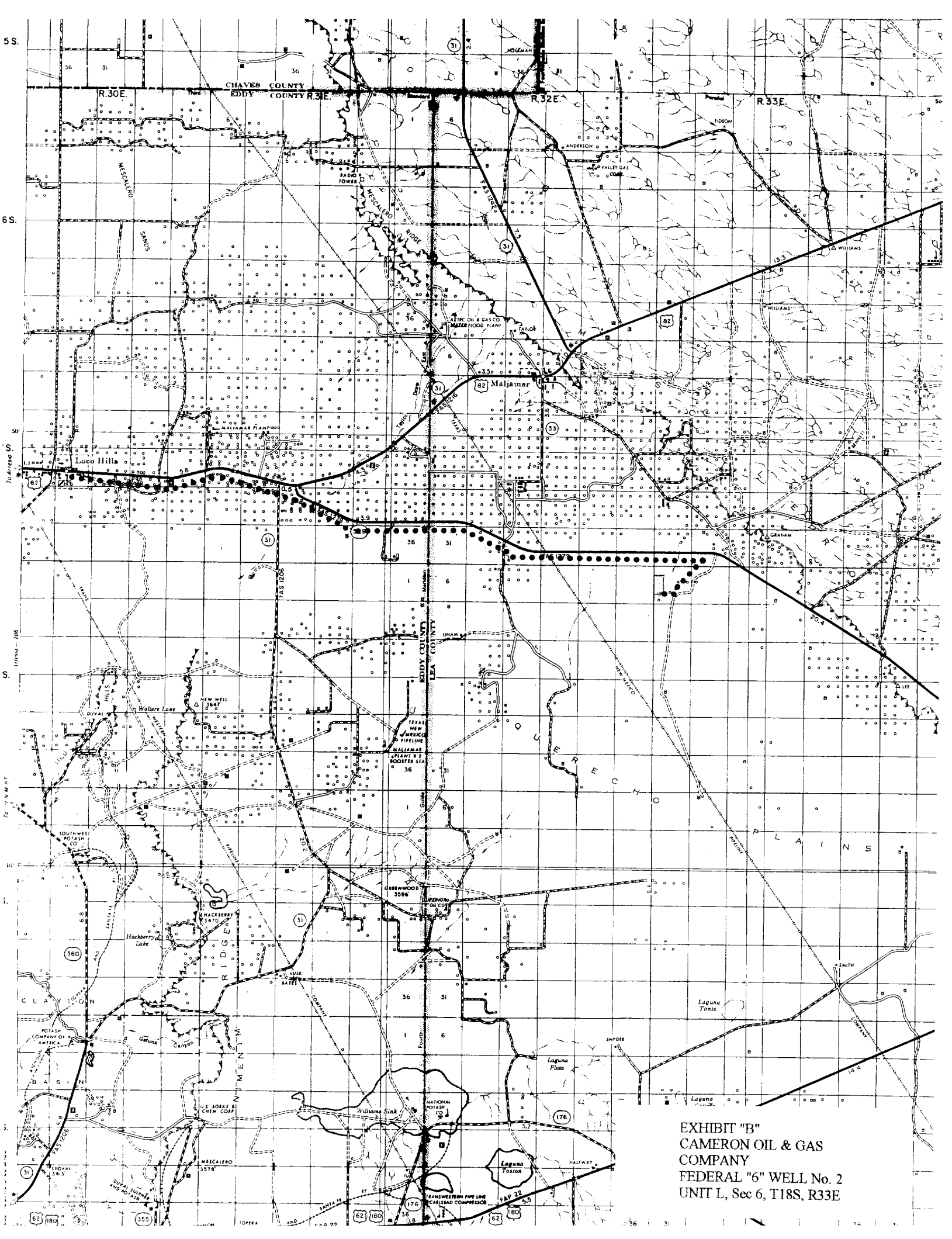
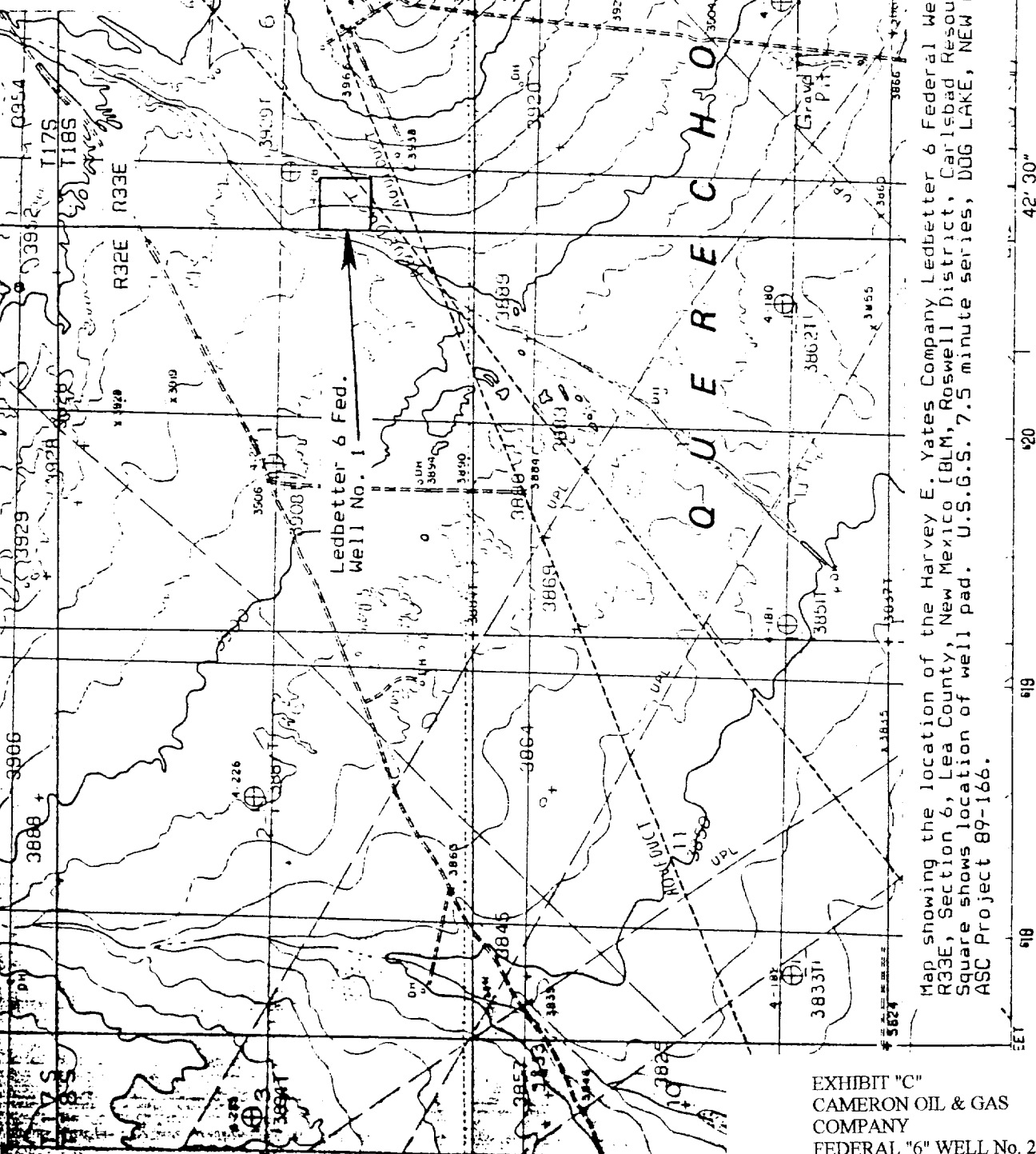

EXHIBIT "B"  
CAMERON OIL & GAS  
COMPANY  
FEDERAL "6" WELL No. 2  
UNIT L, Sec 6, T18S, R33E

Harvey E. Yates Company

Ledbetter 6 Federal #1  
Sec. 6, T18S, R33E  
Lea County, New Mexico



Map showing the location of the Harvey E. Yates Company Ledbetter 6 Federal Well No. 1. T18S, R33E, Section 6, Lea County, New Mexico (BLM, Roswell District, Carlsbad Resource Area, N.M.). Square shows location of well pad. U.S.G.S. 7.5 minute series, DOG LAKE, NEW MEXICO, 1985. ASC Project 89-166.

THE UNITED STATES GEOLOGICAL SURVEY  
USGS, NOS/NOAA  
SERIAL PHOTOGRAPHS TAKEN ..... 1978  
MAP EDITED..... 1965  
TRANSVERSE MERCATOR  
UNIVERSAL TRANSVERSE MERCATOR  
ZONE 13

EXHIBIT "C"  
CAMERON OIL & GAS  
COMPANY  
FEDERAL "6" WELL No. 2  
UNIT L, Sec 6, T18S, R33E

SCALE

**NOTES**

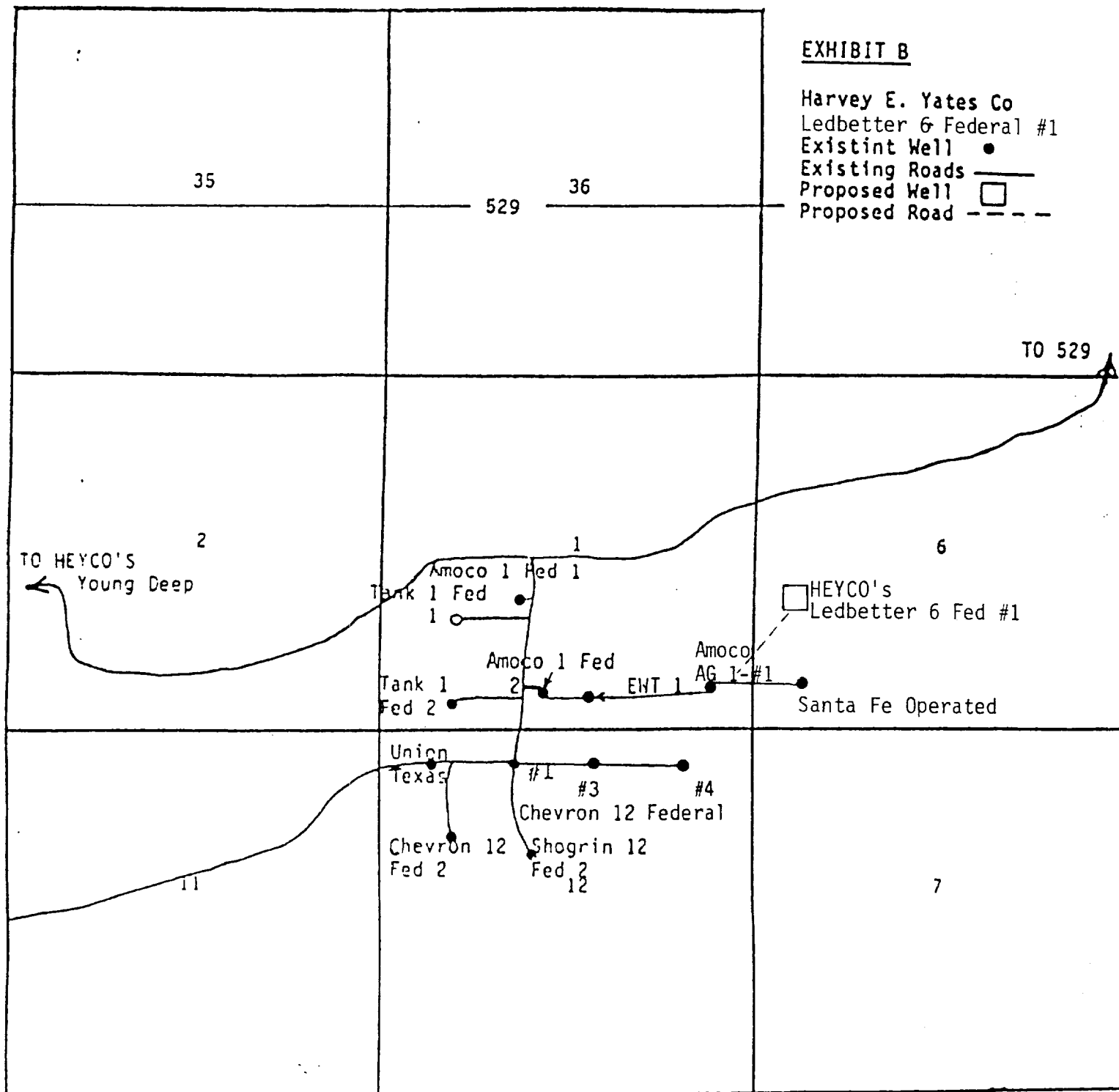

SECTION 1, 12 & 6 TOWNSHIP 18 S RANGE 32 & 33

COUNTY Lea STATE New Mexico

EXHIBIT "D"  
CAMERON OIL & GAS  
COMPANY  
FEDERAL "6" WELL No. 2  
UNIT L, Sec 6, T18S, R33E

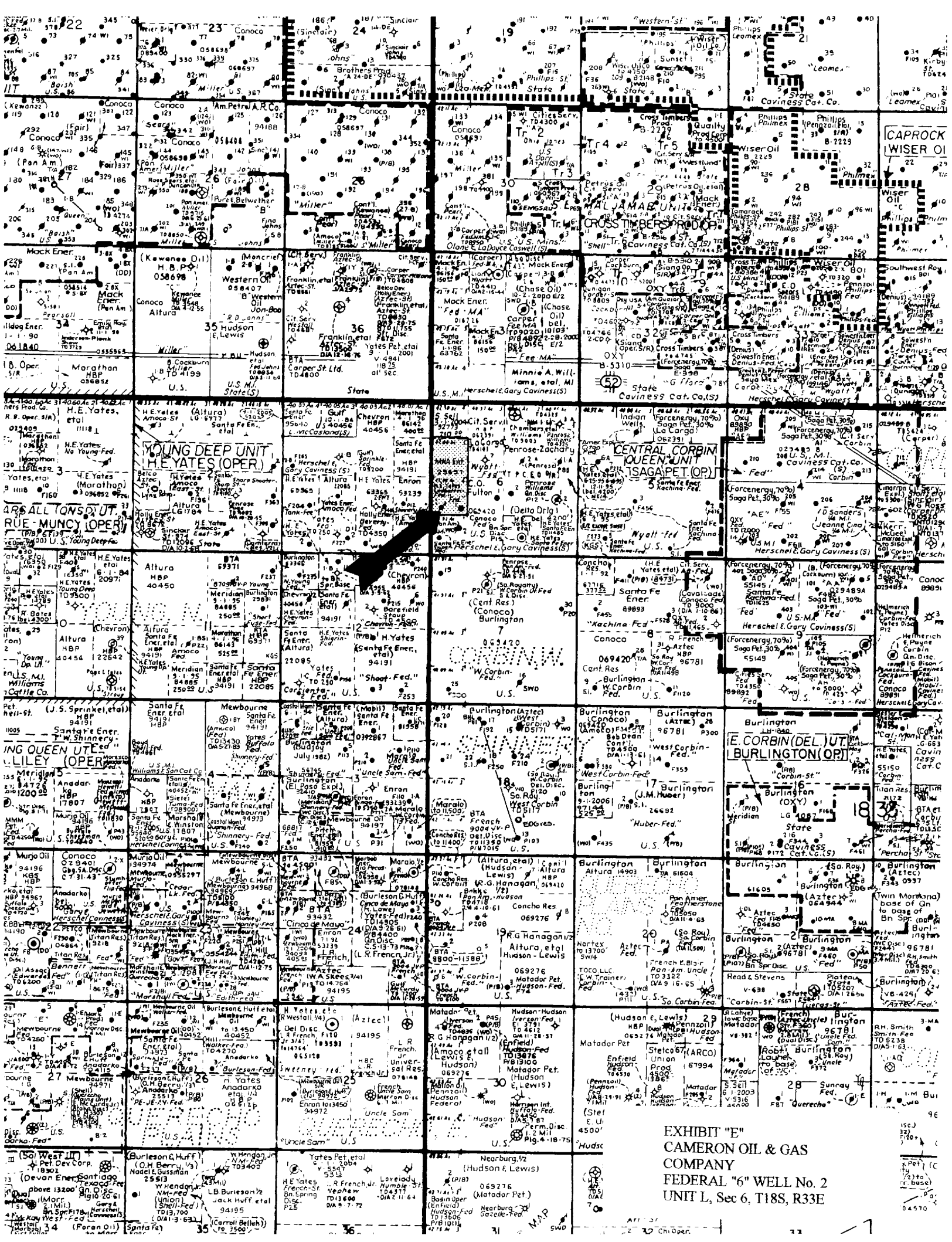

Blow -Out Preventer Diagram  
 Cameron Oil & Gas Company  
 Federal "6" Well No. 2  
 Unit L, Sec. 6, T18S, R33E  
 NMPM, Lea County, NM

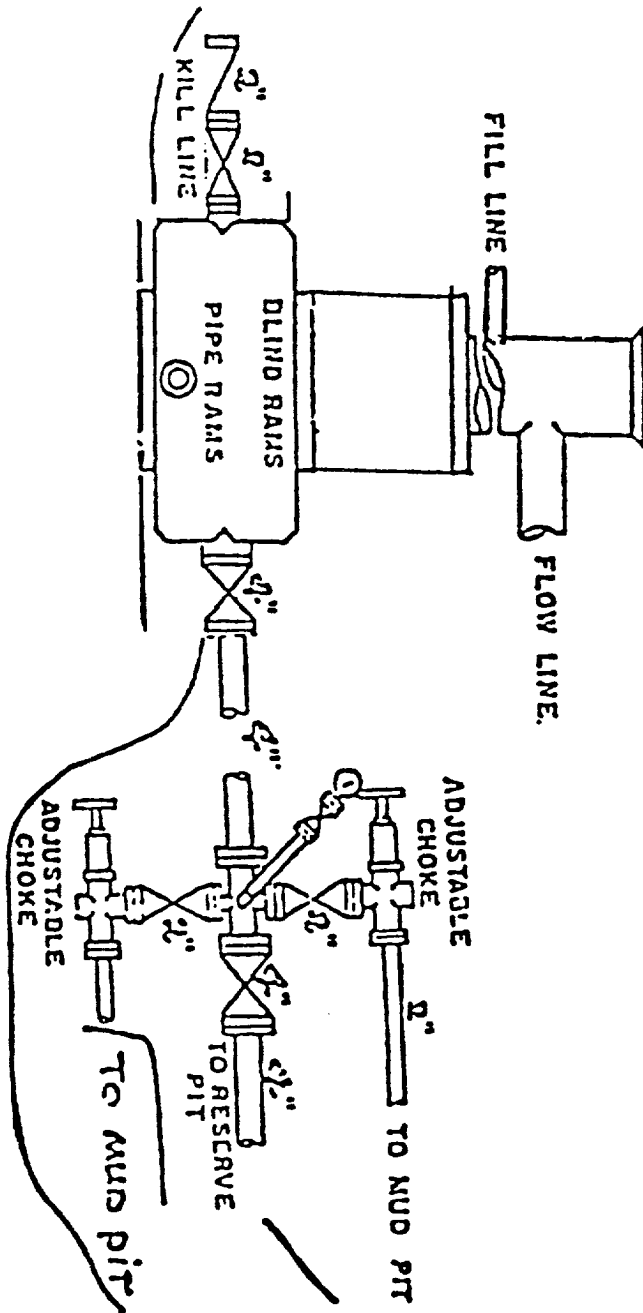

900 Series