

OIL CONSERVATION DIVISION

P.O. Box 2088

Santa Fe, New Mexico 87504-2088

DISTRICT I  
P.O. Box 1980, Hobbs, NM 88240

DISTRICT II  
P.O. Drawer DD, Artesia, NM 88210

DISTRICT III  
1000 Rio Brazos Rd., Aztec, NM 87410

WELL LOCATION AND ACREAGE DEDICATION PLAT

All Distances must be from the outer boundaries of the section

Operator	Lease	Well No.
MERIDIAN OIL, INC.	WEST CORBIN FEDERAL	26
Unit Letter	Section	Township
K	8	8-SOUTH
Range	County	
33-EAST	LEA	
NMPM		

Actual Footage Location of Well:					
1830	feet from the	SOUTH	line and	1980	feet from the
					WEST
					line
Ground level Elev.	Producing Formation	Pool	Dedicated Acreage:		
3897'	WOLFCAMP	SOUTH CORBIN	2.0380 Acres		

1. Outline the acreage dedicated to the subject well by colored pencil or hatchure marks on the plat below
2. If more than one lease is dedicated to the well, outline each and identify the ownership thereof (both as to working interest and royalty).
3. If more than one lease of different ownership is dedicated to the well, have the interest of all owners been consolidated by communitization, unitization, force-pooling, etc.?  
☐ Yes ☐ No If answer is "yes" type of consolidation \_\_\_\_\_

If answer is "no" list the owners and tract descriptions which have actually been consolidated. (Use reverse side of this form if necessary.)

No allowable will be assigned to the well until all interests have been consolidated (by communitization, unitization, forced-pooling, or otherwise) or until a non-standard unit, eliminating such interest, has been approved by the Division.

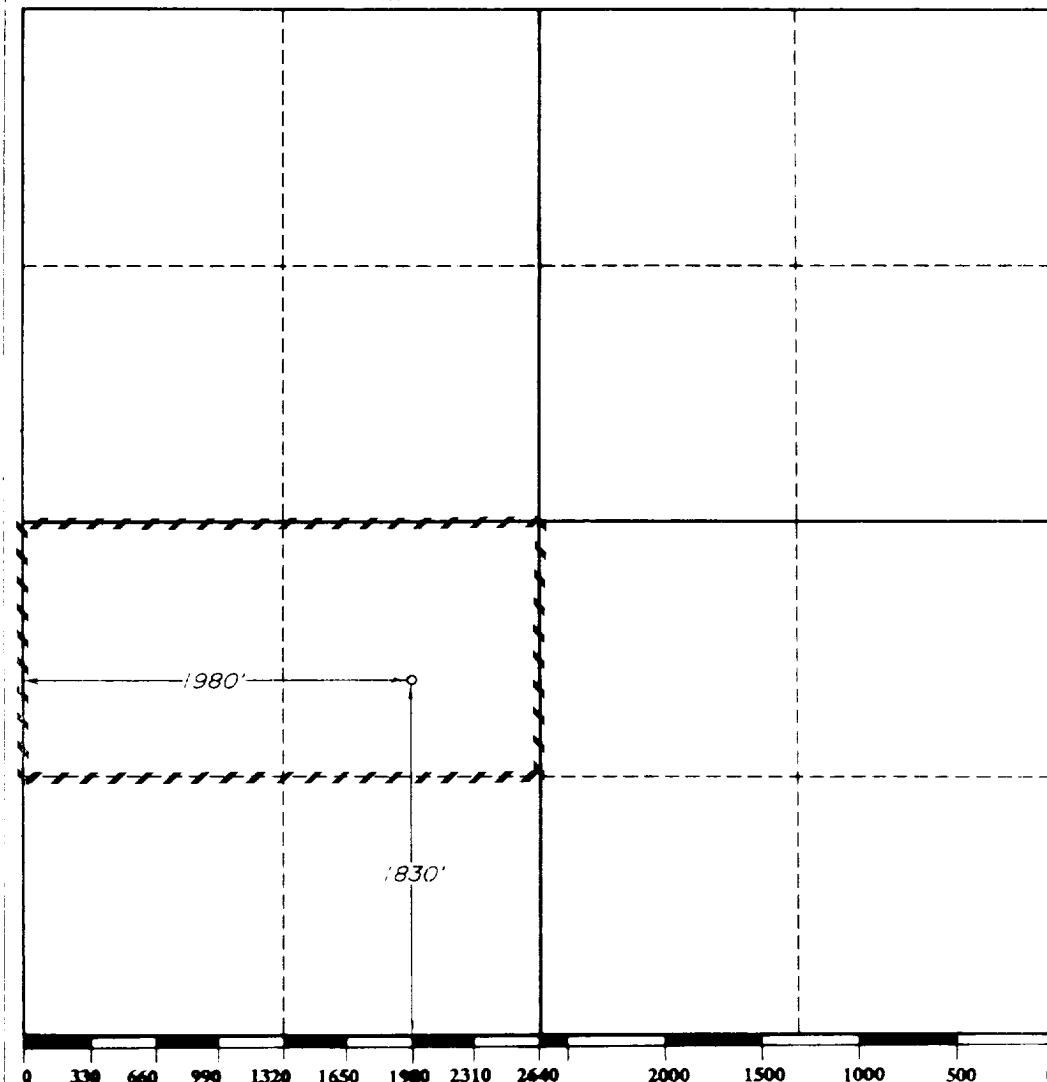

OPERATOR CERTIFICATION

I hereby certify that the information contained herein is true and complete to the best of my knowledge and belief.

*Robert L. Bradshaw*  
Signature

Robert L. Bradshaw  
Printed Name

Sr. Staff Env/Reg Spec.  
Position

Meridian Oil Inc.  
Company

10-24-90  
Date

SURVEYOR CERTIFICATION

I hereby certify that the well location shown on this plat was plotted from field notes of actual surveys made by me or under my supervision, and that the same is true and correct to the best of my knowledge and belief.

Date Surveyed

OCTOBER 24, 1990  
Signature of Registered Professional Surveyor

V. LYNN BEZNER  
NO. 7920

Certificate No.

V. LYNN BEZNER, R.L.S. # 7920

Head 4-30-01

ELF

NOV 15 1951

NOV 15 1951

1951