

Form 3160-5
(July 1989)
(Formerly 9-331)

UNITED STATES
DEPARTMENT OF THE INTERIOR
BUREAU OF LAND MANAGEMENT

CONTACT RECEIVING
OFFICE FOR NUMBER
OF COPIES REQUIRED
(Other instructions on reverse
side)

20025-31065
BLM Roswell District
Modified Form No.
NM060-3160-4

5. LEASE DESIGNATION AND SERIAL NO.
LC-069420

6. IF INDIAN, ALLOTTEE OR TRIBE NAME

SUNDRY NOTICES AND REPORTS ON WELLS

(Do not use this form for proposals to drill or to deepen or plug back to a different reservoir.
Use "APPLICATION FOR PERMIT-" for such proposals.)

1. OIL WELL ☒ GAS WELL ☐ OTHER

7. UNIT AGREEMENT NAME

2. NAME OF OPERATOR
Southland Royalty Company

8. FARM OR LEASE NAME
West Corbin Federal

3. ADDRESS OF OPERATOR
21 Desta Dr., Midland, TX 79705

3a. AREA CODE & PHONE NO.
915-686-5600

9. WELL NO.
25

4. LOCATION OF WELL (Report location clearly and in accordance with any State requirements.*
See also space 17 below.)
At surface

510'FSL & 695'FWL

10. FIELD AND POOL, OR WILDCAT
South Corbin (Wolfcamp)

11. SEC., T., R., M., OR BLK. AND
SURVEY OR AREA

Sec. 7, T18S, R33E

14. PERMIT NO.

15. ELEVATIONS (Show whether DF, RT, GR, etc.)

3866' GR.

12. COUNTY OR PARISH

Lea

13. STATE

NM

16. Check Appropriate Box To Indicate Nature of Notice, Report, or Other Data

NOTICE OF INTENTION TO:

TEST WATER SHUT-OFF

FRACTURE TREAT

SHOOT OR ACIDIZE

REPAIR WELL

(Other)

PULL OR ALTER CASING

MULTIPLE COMPLETE

ABANDON*

CHANGE PLANS

X

SUBSEQUENT REPORT OF:

WATER SHUT-OFF

FRACTURE TREATMENT

SHOOTING OR ACIDIZING

(Other)

REPAIRING WELL

ALTERING CASING

ABANDONMENT*

(NOTE: Report results of multiple completion on Well
Completion or Recompletion Report and Log form.)

17. DESCRIBE PROPOSED OR COMPLETED OPERATIONS (Clearly state all pertinent details, and give pertinent dates, including estimated date of starting any proposed work. If well is directionally drilled, give subsurface locations and measured and true vertical depths for all markers and zones pertinent to this work.)*

Change location from: 510' FSL & 510' FWL

to: 510' FSL & 695' FWL (plat attached).

This change is necessary to make an orthodox location. Field rules require the well to be within 150' of the center of the 1/4 1/4 section.

18. I hereby certify that the foregoing is true and correct

SIGNED Robert L. Bradshaw TITLE Staff Env./Reg. Spec. DATE 03 DECEMBER 1990

(This space for Federal or State office use)

APPROVED BY Robert L. Bradshaw TITLE Staff Env./Reg. Spec. DATE 12/19/90
CONDITIONS OF APPROVAL, IF ANY:

*See Instructions on Reverse Side

RECEIVED
DEC 6 10 55 AM '90
CARE
AREA

Submit to Appropriate
Dist'r 2 Office
State Lease - 4 copies
Fee Lease - 3 copies

State of New Mexico
Energy, Minerals and Natural Resources Department

Form C-102
Revised 1-1-89

OIL CONSERVATION DIVISION

RECEIVED

DISTRICT I
P.O. Box 1980, Hobbs, NM 88240

P.O. Box 2088
Santa Fe, New Mexico 87504-2088

DISTRICT II
P.O. Drawer DD, Artesia, NM 88210

Dec 6 10 55 AM '90

DISTRICT III
1000 Rio Brazos Rd., Aztec, NM 87410

WELL LOCATION AND ACREAGE DEDICATION PLAT

All Distances must be from the outer boundaries of the section

CARL AREA
WELL NO. 25

Operator **MERIDIAN OIL INC.** Lease **WEST CORBIN FEDERAL**

Unit Letter M	Section 7	Township 18-SOUTH	Range 33-EAST	County NMPM	Well No. 25
-------------------------	---------------------	-----------------------------	-------------------------	-----------------------	-----------------------

Actual Footage Location of Well
510 feet from the **SOUTH** line and 695 feet from the **WEST** line

Ground level Elev. **3866'** Producing Formation **WOLFCAMP** Pool **SOUTH CORBIN** Dedicated Acreage **32.980** Acres

- Outline the acreage dedicated to the subject well by colored pencil or hatchure marks on the plat below
- If more than one lease is dedicated to the well, outline each and identify the ownership thereof (both as to working interest and royalty)
- If more than one lease of different ownership is dedicated to the well, have the interest of all owners been consolidated by communitization, unitization, force pooling, etc.?
☐ Yes ☐ No If answer is "yes" type of consolidation _____
If answer is "no" list the owners and tract descriptions which have actually been consolidated. (Use reverse side of this form if necessary)
No allowable will be assigned to the well until all interests have been consolidated (by communitization, unitization, forced pooling, or otherwise) or until a non-standard unit, eliminating such interest, has been approved by the Division.

OPERATOR CERTIFICATION

I hereby certify that the information contained herein is true and complete to the best of my knowledge and belief

Robert L. Bradshaw
Signature

Robert L. Bradshaw
Printed Name

Sr. Staff Env/Reg Spec.
Position

Meridian Oil Inc.
Company

December 3, 1990
Date

SURVEYOR CERTIFICATION

I hereby certify that the well location shown on this plat was plotted from field notes of actual surveys made by me or under my supervision, and that the same is true and correct to the best of my knowledge and belief

Date Surveyed

NOVEMBER 27, 1990
Signature of Seal of Professional Surveyor

BEZNER
NO. 7920

REGISTERED LAND SURVEYOR

V. Lynn Bezner
Certificate No.

V. LYNN BEZNER, R.L.S. # 7920

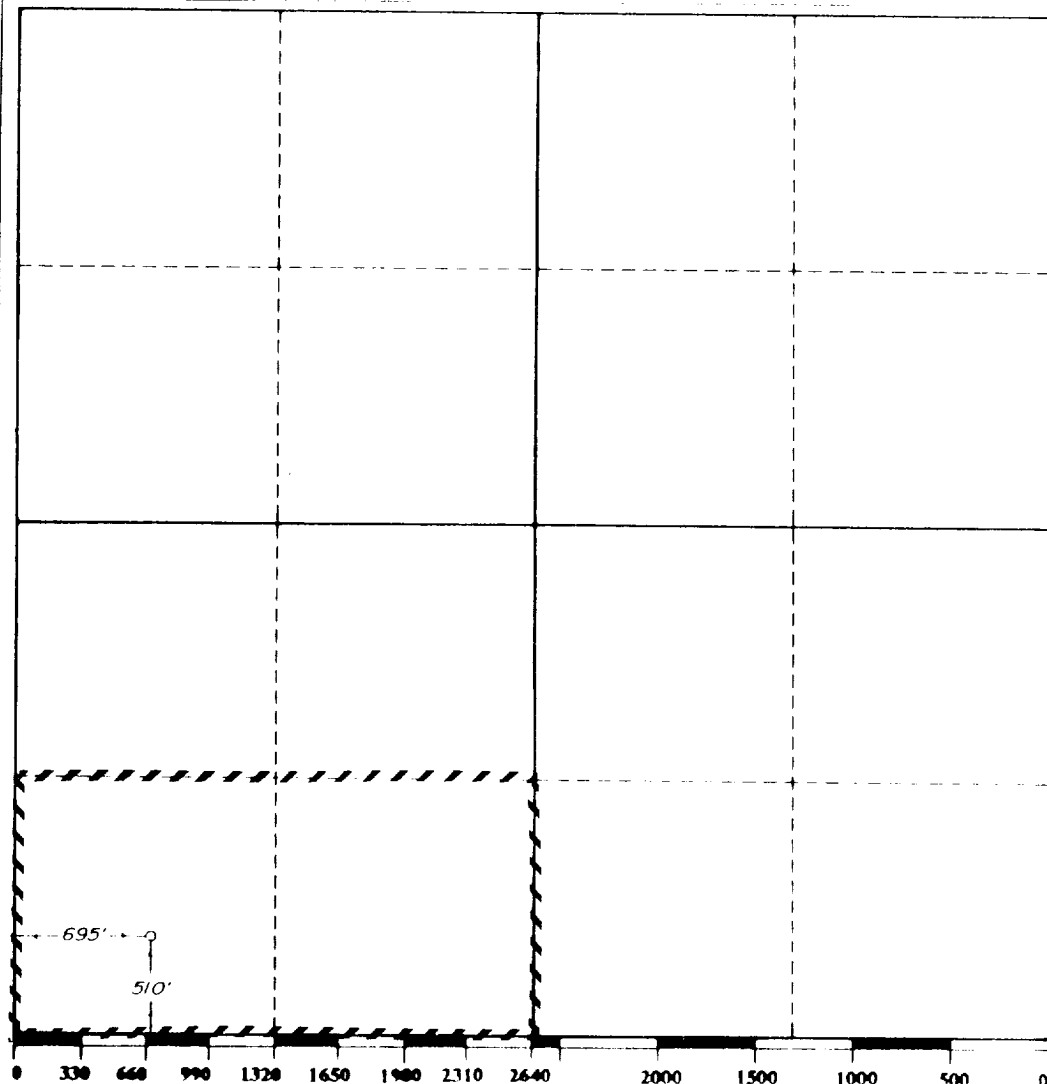

Amended plat