

OIL CONSERVATION DIVISION

P.O. Box 2088
Santa Fe, New Mexico 87504-2088

DISTRICT I
P.O. Box 1980, Hobbs, NM 88240

DISTRICT II
P.O. Drawer DD, Artesia, NM 88210

DISTRICT III
1000 Rio Brazos Rd., Aztec, NM 87410

WELL LOCATION AND ACREAGE DEDICATION PLAT

All Distances must be from the outer boundaries of the section

Operator BTA OIL PRODUCERS			Lease 9004 JV-P FRENCH		Well No. 2
Unit Letter I	Section 24	Township 18-SOUTH	Range 32-EAST	County NMPM LEA	
Actual Footage Location of Well: 1980 feet from the SOUTH line and 510 feet from the EAST line					
Ground level Elev. 3797'	Producing Formation Wolfcamp		Pool Corbin South	Dedicated Acreage: 80 Acres	

- Outline the acreage dedicated to the subject well by colored pencil or hatchure marks on the plat below.
- If more than one lease is dedicated to the well, outline each and identify the ownership thereof (both as to working interest and royalty).
- If more than one lease of different ownership is dedicated to the well, have the interest of all owners been consolidated by communitization, unitization, force-pooling, etc.?
☐ Yes ☐ No If answer is "yes" type of consolidation _____
If answer is "no" list the owners and tract descriptions which have actually been consolidated. (Use reverse side of this form if necessary). _____
No allowable will be assigned to the well until all interests have been consolidated (by communitization, unitization, forced-pooling, or otherwise) or until a non-standard unit, eliminating such interest, has been approved by the Division.

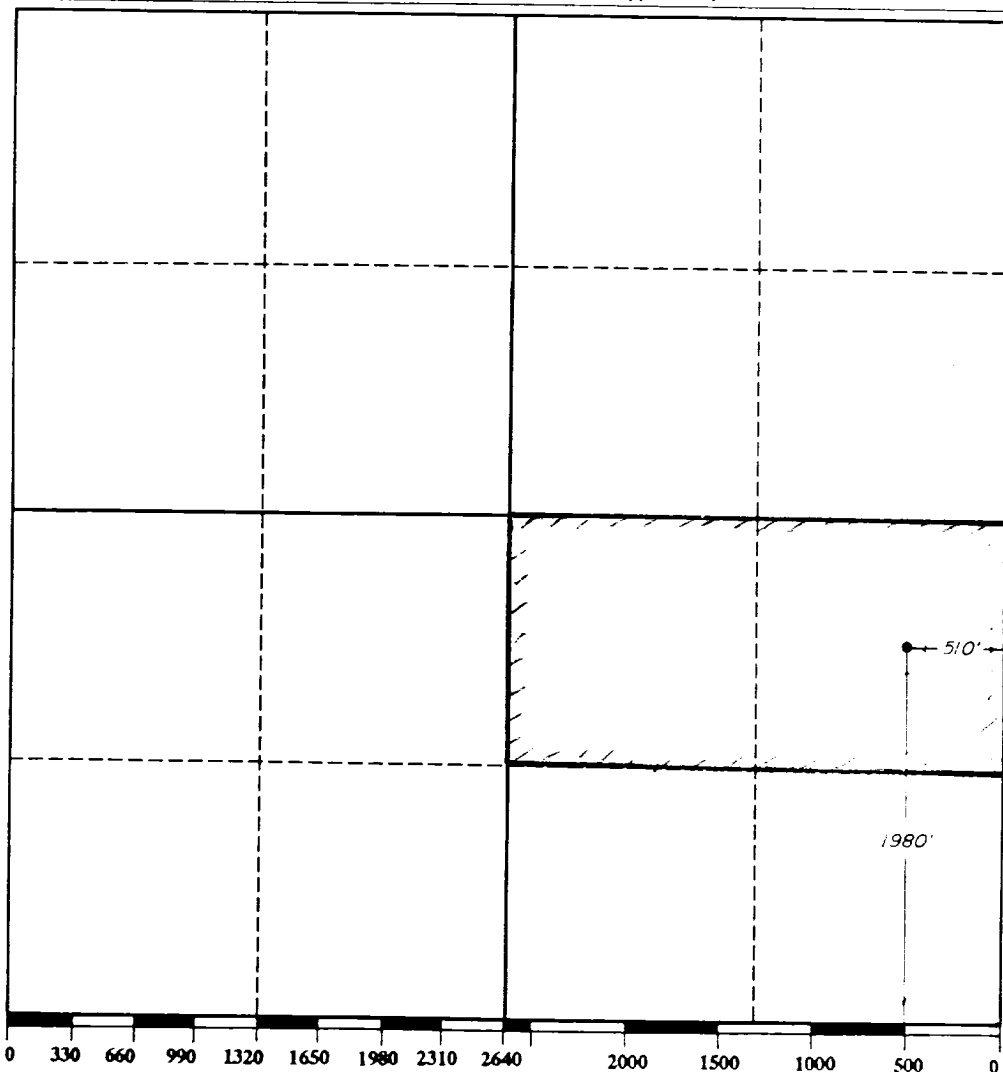

OPERATOR CERTIFICATION

I hereby certify that the information contained herein is true and complete to the best of my knowledge and belief.

Signature *Dorothy Houghton*
Printed Name **Dorothy Houghton**
Position **Regulatory Administrator**
Company **BTA Oil Producers**
Date **12-3-90**

SURVEYOR CERTIFICATION

I hereby certify that the well location shown on this plat was plotted from field notes of actual surveys made by me or under my supervision, and that the same is true and correct to the best of my knowledge and belief.

Date Surveyed **NOVEMBER 1990**
Signature *V. Lynn Bezner*
Professional Surveyor
V. LYNN BEZNER
NO. 7920
Certificate No. _____
V. LYNN BEZNER, R.L.S. #7920

RECEIVED

DEC 31 1990

COPIES
HOBBS OFFICE