

UNITED STATES
DEPARTMENT OF THE INTERIOR
BUREAU OF LAND MANAGEMENT

CONTACT R. VING
OFFICE FOR NUMBER
OF COPIES REQUIRED
(Other instructions on
reverse side)

BLM Roswell District
Modified Form No.
NM060-3160-2

30 025 31172

APPLICATION FOR PERMIT TO DRILL, DEEPEN, OR PLUG BACK

1a. TYPE OF WORK DRILL <input checked="" type="checkbox"/> DEEPEN <input type="checkbox"/> PLUG BACK <input type="checkbox"/>			5. LEASE DESIGNATION AND SERIAL NO. NM-12412			
5. TYPE OF WELL OIL WELL <input checked="" type="checkbox"/> GAS WELL <input type="checkbox"/> OTHER <input type="checkbox"/> SINGLE ZONE <input checked="" type="checkbox"/> MULTIPLE ZONE <input type="checkbox"/>			6. IF INDIAN, ALLOTTEE OR TRIBE NAME			
2. NAME OF OPERATOR Meridian Oil Inc.			7. UNIT AGREEMENT NAME			
3. ADDRESS OF OPERATOR 21 Desta Dr., Midland, TX 79705			8. FARM OR LEASE NAME Federal "AW"			
4. LOCATION OF WELL (Report location clearly and in accordance with any State requirements.)* At surface 660' FSL & 330' FEL At proposed prod. zone Same			9. WELL NO. 3			
14. DISTANCE IN MILES AND DIRECTION FROM NEAREST TOWN OR POST OFFICE* 6 Miles north of Halfway, NM.			10. FIELD AND POOL, OR WILDCAT East Lusk (Delaware)			
15. DISTANCE FROM PROPOSED* LOCATION TO NEAREST PROPERTY OR LEASE LINE, FT. (Also to nearest drlg. unit line, if any) 330'		16. NO. OF ACRES IN LEASE 640	17. NO. OF ACRES ASSIGNED TO THIS WELL 40			
18. DISTANCE FROM PROPOSED LOCATION* TO NEAREST WELL, DRILLING, COMPLETED, OR APPLIED FOR, ON THIS LEASE, FT. 2640'		19. PROPOSED DEPTH 5500'	20. ROTARY OR CABLE TOOLS Rotary			
21. ELEVATIONS (Show Whether DF, RT, GR, ETC.) 3577' GR.			22. APPROX. DATE WORK WILL START* 01 April 1991			
23. PROPOSED CASING AND CEMENTING PROGRAM Capitan Controlled Water Basin Secretary's Potash						
HOLE SIZE	CASING SIZE	WEIGHT/FOOT	GRADE	THREAD TYPE	SETTING DEPTH	QUANTITY OF CEMENT
12-1/4"	8-5/8"	24#	K-55	STC	400'	275 sx-Circ.
7-7/8"	5-1/2"	15.5#	K-55	STC	5500'	1375 sx-Circ.

Drill 12-1/4" hole to 400' and set 8-5/8" csg. Cmt w/275 sx-circulate.
Drill 7-7/8" hole to 5500' and set 5-1/2" csg. Cmt w/1375 sx-circulate.
MUD PROGRAM: 0-400' fresh water/gel/lime; 400-5500' salt water, MW 9.8-10.2. Nor abnormal pressures or temperatures expected.
BOP PROGRAM: 10"-3M BOP stack to be installed on 8-5/8" & left for remainder of drilling. Stack to consist of annular BOP, blind ram BOP, and one pipe ram BOP. Test BOP's using an independent tester after setting the 8-5/8" csg.

APPROVAL SUBJECT TO
GENERAL REQUIREMENTS AND
SPECIAL STIPULATIONS

IN ABOVE SPACE DESCRIBE PROPOSED PROGRAM: If proposal is to deepen or plug back, give data on present productive zone and proposed new productive zone. If proposal is to drill or deepen directionally, give pertinent data on subsurface locations and measured and true vertical depths. Give blowout preventer program, if any.

24. SIGNED Richard L. Bradshaw TITLE Sr. Staff Env./Reg. Spec. DATE 13 February 1991
(This space for Federal or State office use)

PERMIT NO. _____ APPROVAL DATE _____
AREA MANAGER
APPROVED BY Orig. Signed by Richard L. Bradshaw TITLE CARLSBAD RESOURCE AREA DATE 3-15-91
CONDITIONS OF APPROVAL, IF ANY:

*See Instructions On Reverse Side

DISTRICT I

P. O. Box 1980
Hobbs, NM 88240

DISTRICT II

P. O. Drawer DD
Artesia, NM 88210

DISTRICT III

1000 Rio Brazos Rd
Aztec, NM 87410

OIL CONSERVATION DIVISION

P. O. Box 2088
Santa Fe, New Mexico 87504-2088

WELL LOCATION AND ACREAGE DEDICATION PLAT

All distances must be from the outer boundaries of the section

Operator MERIDIAN OIL INC.			Lease FEDERAL "AW"		Well No. 3
Unit Letter P	Section 26	Township 19-SOUTH	Range 32-EAST	NMPM	LEA COUNTY
Actual Footage Location of Well					
660 feet from the SOUTH line and		330 feet from the EAST line			
Ground Level Elev. 3577'	Producing Formation DELAWARE	Pool EAST LUSK			
					40 Acres

- Outline the acreage dedicated to the subject well by colored pencil or hatchure marks on the plot below.
- If more than one lease is dedicated to the well, outline each and identify the ownership thereof (both as to working interest and royalty).
- If more than one lease of different ownership is dedicated to the well, have the interest of all the owners been consolidated by communitization, unitization, forced-pooling, etc.? ☐ Yes ☐ No. If answer is "yes", type of consolidation _____ if the answer is "no", list the owners and tract descriptions which have actually been consolidated. (Use the reverse side of this form if necessary.) _____ No allowable will be assigned to the well until all interests have been consolidated (by communitization, unitization, forced-pooling, or otherwise) or until a non-standard unit, eliminating such interest, has been approved by the division.

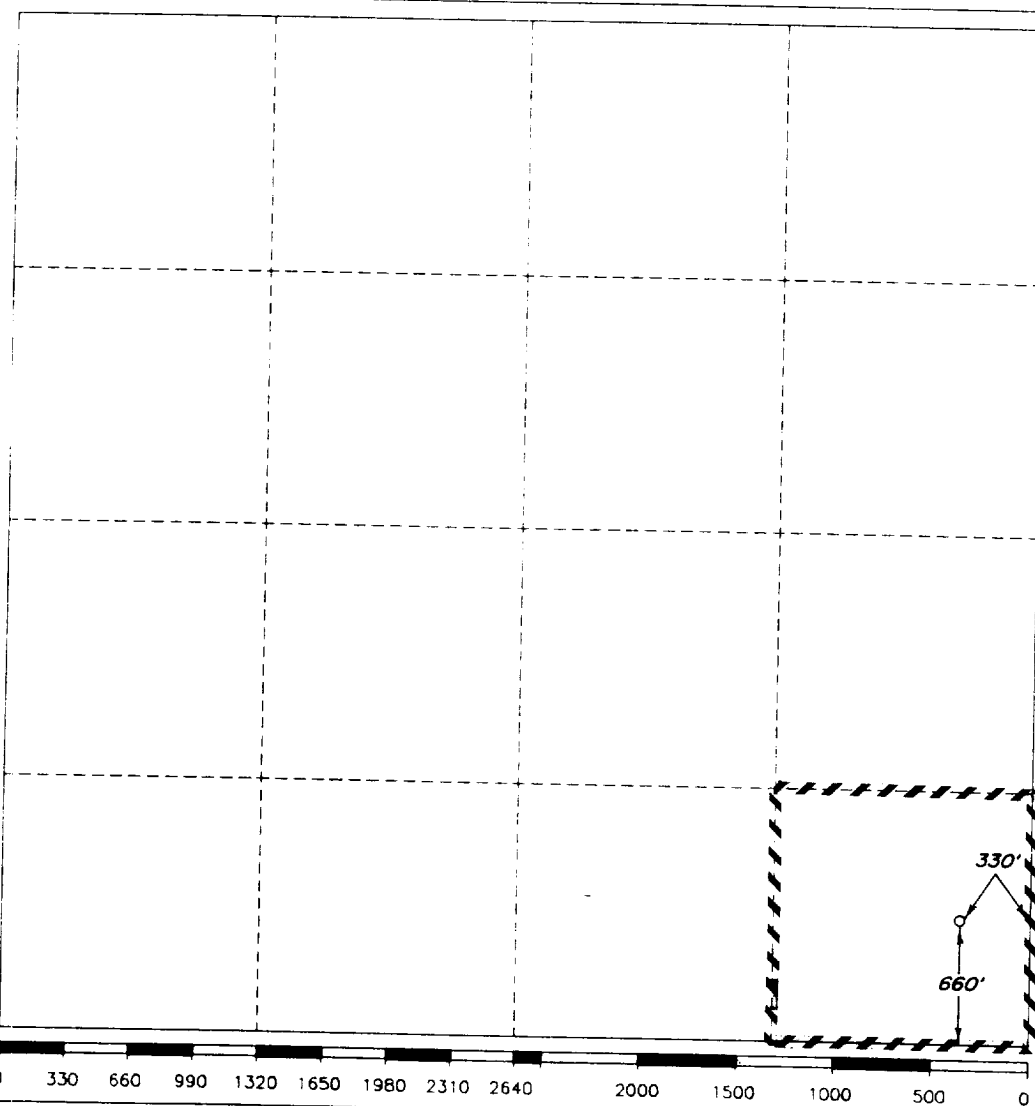

OPERATOR CERTIFICATION

I hereby certify that the information herein is true and complete to the best of my knowledge and belief.

Signature

Robert L. Bradshaw

Printed Name

Robert L. Bradshaw

Position

Sr. Staff Env/Reg Spec.
Company

Meridian Oil Inc.

Date

February 12, 1991

SURVEYOR CERTIFICATION

I hereby certify that the well location shown on this plat was plotted from field notes of actual surveys made by me or under my supervision, and that the same is true and correct to the best of my knowledge and belief.

Date Surveyed

JANUARY 15, 1991

Signature and Seal of
Professional Surveyor

V. LYNN
BEZNER
NO. 7920

Certificate NO. 7920

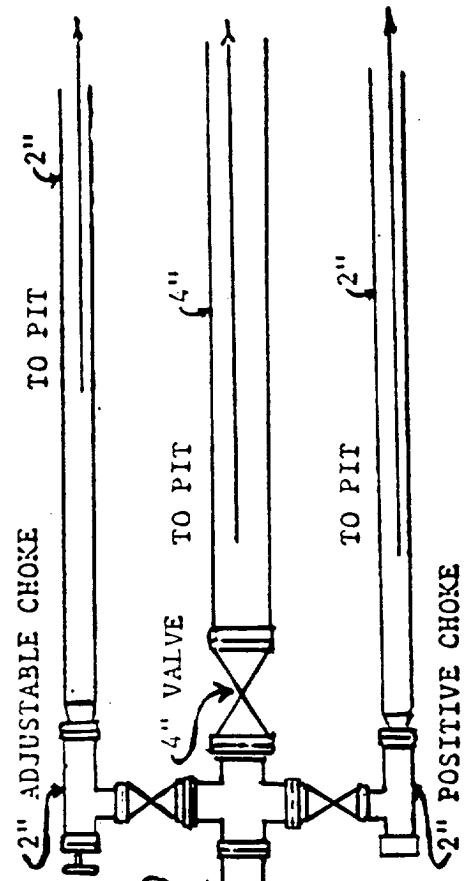
[illegible]

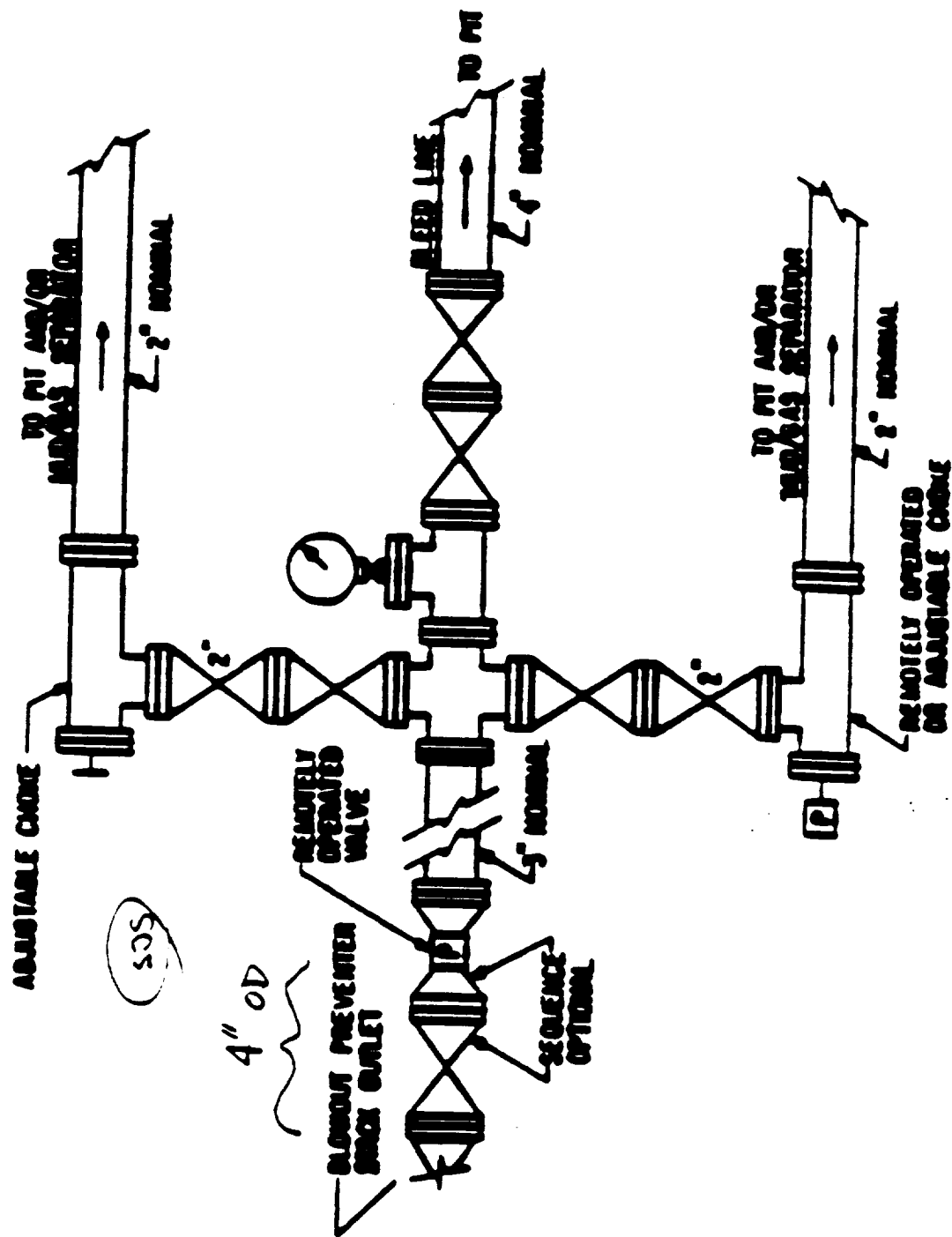

FIG. 3.A.2

TYPICAL CHOKER MANIFOLD ASSEMBLY FOR 6M
RATED WORKING PRESSURE SERVICE --
SURFACE INSTALLATION