

Submit to Appropriate  
District Office  
State Lease - 6 copies  
Fee Lease - 5 copies

State of New Mexico  
Energy, Minerals and Natural Resources Department

Form C-101  
Revised 1-1-89

OIL CONSERVATION DIVISION

P.O. Box 2088  
Santa Fe, New Mexico 87504-2088

DISTRICT I  
P.O. Box 1980, Hobbs, NM 88240

DISTRICT II  
P.O. Drawer DD, Artesia, NM 88210

DISTRICT III  
1000 Rio Brazos Rd., Aztec, NM 87410

API NO. (assigned by OCD on New Wells) <u>30-025-31205</u>
5. Indicate Type of Lease STATE <input checked="" type="checkbox"/> FEE <input type="checkbox"/>
6. State Oil & Gas Lease No. VB-34
7. Lease Name or Unit Agreement Name Pronto AJF State
8. Well No. 1
9. Pool name or Wildcat Reeves Penn <u>52060</u>

10. Proposed Depth 11,350	11. Formation Strawn	12. Rotary or C.T. Rotary
13. Elevations (Show whether DF, RT, GR, etc.) 3909' GR	14. Kind & Status Plug. Bond Blanket	15. Drilling Contractor Undesignated
16. Approx. Date Work will start ASAP		

APPLICATION FOR PERMIT TO DRILL, DEEPEN, OR PLUG BACK

1a. Type of Work: DRILL <input checked="" type="checkbox"/> RE-ENTER <input type="checkbox"/> DEEPEN <input type="checkbox"/> PLUG BACK <input type="checkbox"/>
b. Type of Well: OIL WELL <input checked="" type="checkbox"/> GAS WELL <input type="checkbox"/> OTHER <input type="checkbox"/> SINGLE ZONE <input type="checkbox"/> MULTIPLE ZONE <input type="checkbox"/>
2. Name of Operator Yates Petroleum Corporation <u>225595</u>
3. Address of Operator 105 South Fourth Street Artesia, NM 748-1471
4. Well Location Unit Letter <u>G</u> : <u>2310</u> Feet From The <u>North</u> Line and <u>2236</u> Feet From The <u>East</u> Line

Section <u>10</u>	Township <u>18S</u>	Range <u>35E</u>	NMPM	Lea	County
17. PROPOSED CASING AND CEMENT PROGRAM					
SIZE OF HOLE	SIZE OF CASING	WEIGHT PER FOOT	SETTING DEPTH	SACKS OF CEMENT	EST. TOP
17 1/2"	13 3/8"	54.5#	450'	450 sacks	Circulate
11"	8 5/8"	32#	3800'	1300 sacks	Circulate
7 7/8"	5 1/2"	17# N80	11350'	1300 sacks	

We propose to drill and test the Strawn Formation and intermediate formations. Approximately 450' of surface casing will be set with cement circulated to shut off gravel and cavings. Intermediate casing will be set to approximately 3800' with cement circulated. If productive, 5 1/2" casing will be run and cemented with adequate cover.

MUD PROGRAM: Native/Paper to 450'; Native/Brine to 3800'; FW to 10,000'; FW Gel/Drispak to TD.

BOPE PROGRAM: BOPE to be installed on intermediate casing and tested daily for operational.

IN ABOVE SPACE DESCRIBE PROPOSED PROGRAM: IF PROPOSAL IS TO DEEPEN OR PLUG BACK, GIVE DATA ON PRESENT PRODUCTIVE ZONE AND PROPOSED NEW PRODUCTIVE ZONE. GIVE BLOWOUT PREVENTER PROGRAM, IF ANY.

I hereby certify that the information above is true and complete to the best of my knowledge and belief.

SIGNATURE Clifton R. May TITLE Permit Agent DATE 3/27/91  
TYPE OR PRINT NAME Clifton R. May TELEPHONE NO. 748-1741

(This space for State Use)

APPROVED BY \_\_\_\_\_ TITLE \_\_\_\_\_ DATE \_\_\_\_\_  
CONDITIONS OF APPROVAL, IF ANY:

Permit Expires 5 Months From Approval  
Date Unless Drilling Underway.

MAR 28 1991

Submit to Appropriate  
District Office  
State Lease - 4 copies  
Fee Lease - 3 copies

State of New Mexico  
Energy, Minerals and Natural Resources Department

Form C-102  
Revised 1-1-89

OIL CONSERVATION DIVISION

P.O. Box 2088  
Santa Fe, New Mexico 87504-2088

DISTRICT I  
P.O. Box 1980, Hobbs, NM 88240

DISTRICT II  
P.O. Drawer DD, Artesia, NM 88210

DISTRICT III  
1000 Rio Brazos Rd., Aztec, NM 87410

WELL LOCATION AND ACREAGE DEDICATION PLAT

All Distances must be from the outer boundaries of the section

Operator <b>YATES PETROLEUM CORPORATION</b>			Lease <b>PRONTO "AJF" STATE</b>		Well No. <b>1</b>
Unit Letter <b>G</b>	Section <b>10</b>	Township <b>18 SOUTH</b>	Range <b>35 EAST</b>	County <b>LEA</b>	NMPM

Actual Footage Location of Well:

2310 feet from the NORTH line and		2236 feet from the EAST line	
Ground level Elev. <b>3909</b>	Producing Formation <b>STRAWN</b>	Pool <b>REEVES PENN</b>	Dedicated Acreage: <b>40</b> Acres

- Outline the acreage dedicated to the subject well by colored pencil or hatchure marks on the plat below.
- If more than one lease is dedicated to the well, outline each and identify the ownership thereof (both as to working interest and royalty).
- If more than one lease of different ownership is dedicated to the well, have the interest of all owners been consolidated by communitization, unitization, force-pooling, etc.?  
☐ Yes ☐ No If answer is "yes" type of consolidation \_\_\_\_\_  
If answer is "no" list the owners and tract descriptions which have actually been consolidated. (Use reverse side of this form if necessary).  
No allowable will be assigned to the well until all interests have been consolidated (by communitization, unitization, forced-pooling, or otherwise) or until a non-standard unit, eliminating such interest, has been approved by the Division.

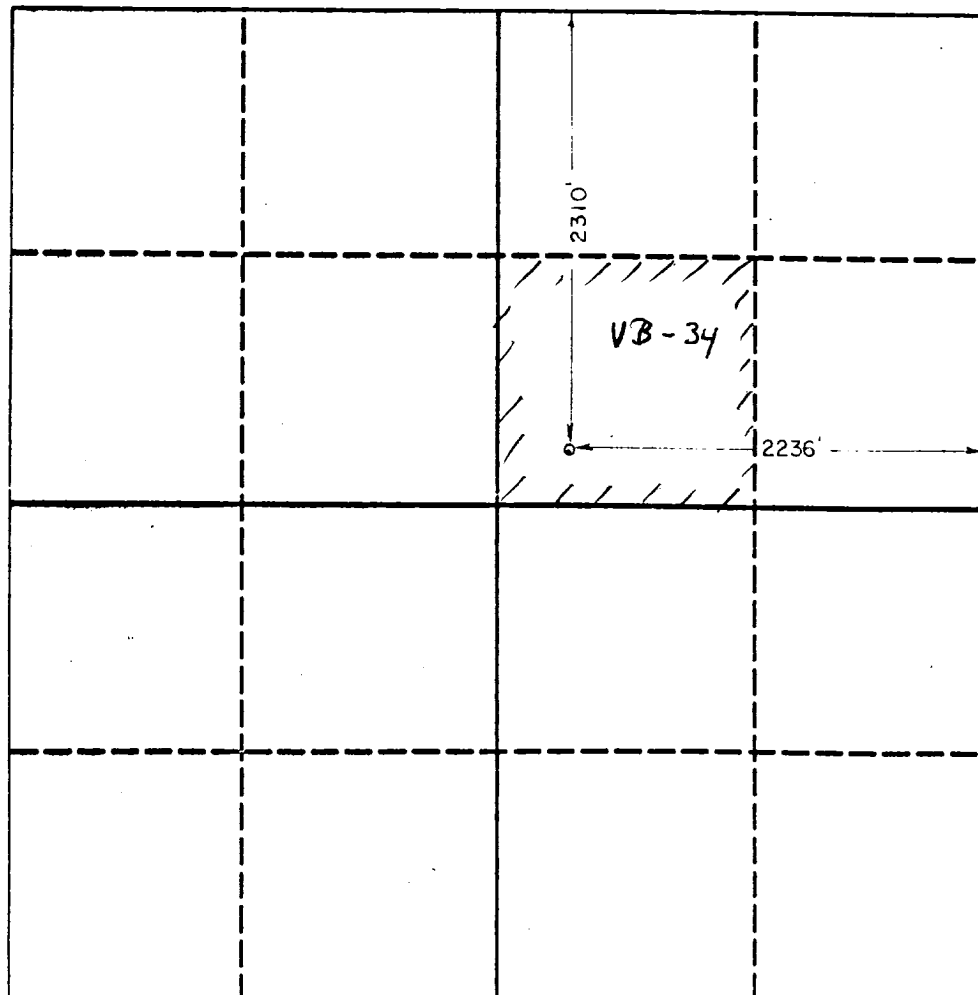

OPERATOR CERTIFICATION

I hereby certify that the information contained herein is true and complete to the best of my knowledge and belief.

Signature  
*Clifton R. May*  
Printed Name  
**Clifton R. May**  
Position  
**Permit Agent**  
Company  
**Yates Petroleum Corp.**  
Date  
**March 27, 1991**

SURVEYOR CERTIFICATION

I hereby certify that the well location shown on this plat was plotted from field notes of actual surveys made by me or under my supervision, and that the same is true and correct to the best of my knowledge and belief.

Date Surveyed  
**3/27/91**  
Signature & Seal of  
Professional Surveyor

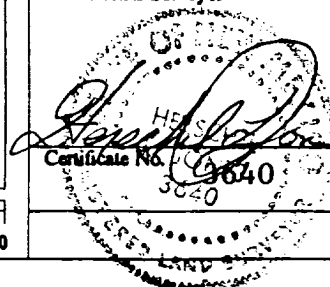

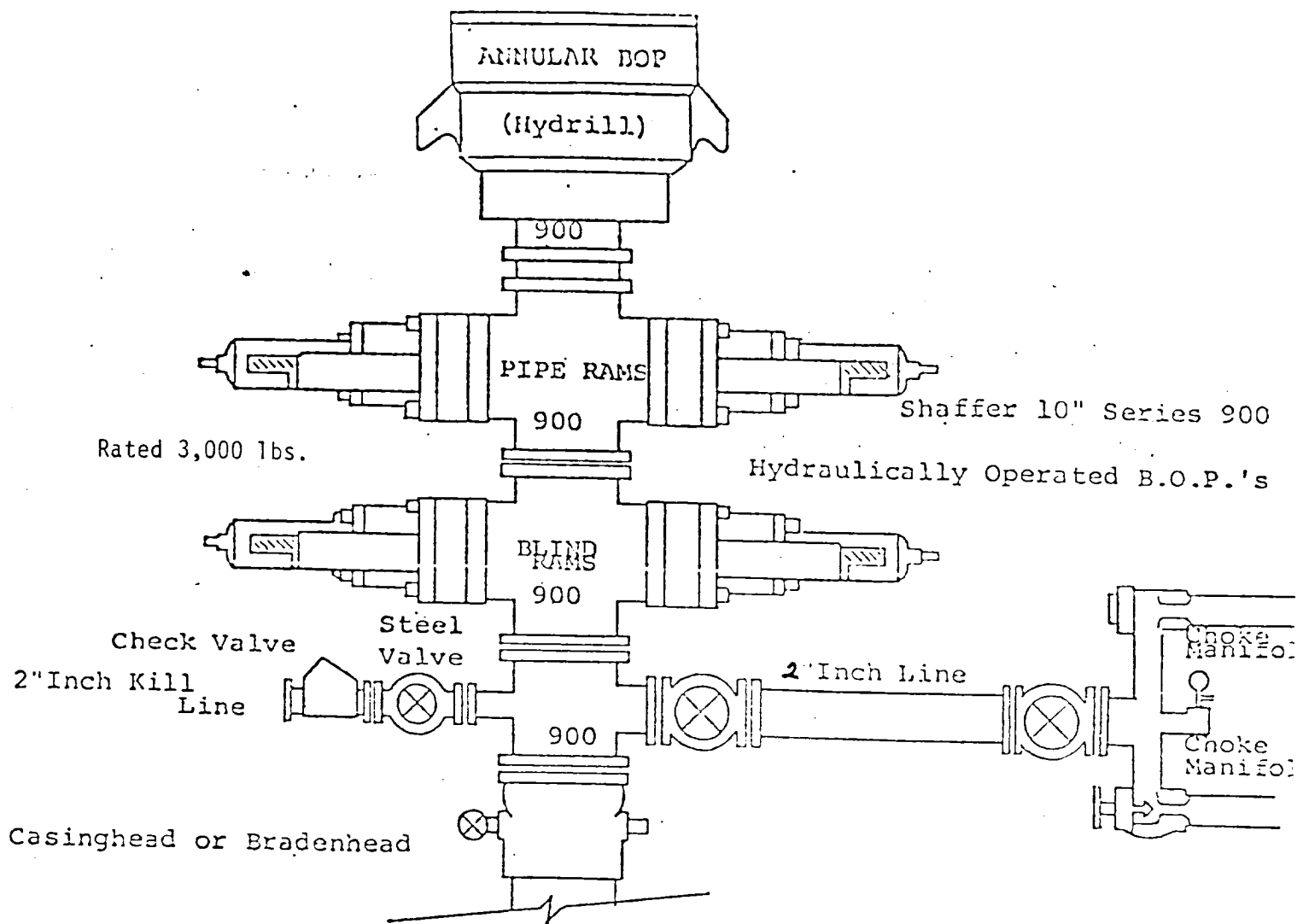

THE FOLLOWING CONSTITUTE MINIMUM BLOWOUT PREVENTER REQUIREMENTS

1. All preventers to be hydraulically operated with secondary manual control installed prior to drilling out from under casing.
2. Choke outlet to be a minimum of 2" diameter.
3. Kill line to be of all steel construction of 2" minimum diameter.
4. All connections from operating manifolds to preventers to be all steel. hole or tube a minimum of one inch in diameter.
5. The available closing pressure shall be at least 15% in excess of that required with sufficient volume to operate the B.O.P.'s.
6. All connections to and from preventer to have a pressure rating equivalent to that of the B.O.P.'s.
7. Inside blowout preventer to be available on rig floor.
8. Operating controls located a safe distance from the rig floor.
9. Hole must be kept filled on trips below intermediate casing.

EX-11  
B

1651-L 7-15-91

173

RECEIVED

MAR 28 1991

OFFICE