

Submit to Appropriate
District Office
State Lease - 6 copies
Fee Lease - 5 copies

State of New Mexico
Energy, Minerals and Natural Resources Department

Form C-101
Revised 1-1-89

OIL CONSERVATION DIVISION

DISTRICT I
P.O. Box 1980, Hobbs, NM 88240

DISTRICT II
P.O. Drawer DD, Artesia, NM 88210

DISTRICT III
1000 Rio Brazos Rd., Aztec, NM 87410

P.O. Box 2088
Santa Fe, New Mexico 87504-2088

API NO. (assigned by OCD on New Wells)

30-025-31222

5. Indicate Type of Lease

STATE ☒

FEE ☐

6. State Oil & Gas Lease No.

K-1860

APPLICATION FOR PERMIT TO DRILL, DEEPEN, OR PLUG BACK

1a. Type of Work:

DRILL ☒

RE-ENTER ☐

DEEPEN ☐

PLUG BACK ☐

b. Type of Well:

OIL
WELL ☒

GAS
WELL ☐

OTHER ☐

SINGLE
ZONE ☒

MULTIPLE
ZONE ☐

7. Lease Name or Unit Agreement Name

Atlantic 32 State

2. Name of Operator

Harvey E. Yates Company

8. Well No.

#2

3. Address of Operator

P.O. Box 1933, Roswell, N.M. 88202

9. Pool name or Wildcat

Wildcat

4. Well Location

Unit Letter E : 1980' Feet From The North Line and 990' Feet From The West Line

Section 32 Township 18S Range 33E NMPM Lea County

10. Proposed Depth

5150

11. Formation Grayburg

Lee Hills

12. Rotary or C.T.

Rotary

13. Elevations (Show whether DF, RT, GR, etc.)

3743.5 GL

14. Kind & Status Plug. Bond

\$50,000

15. Drilling Contractor

TBA

16. Approx. Date Work will start

ASAP

17.

PROPOSED CASING AND CEMENT PROGRAM

SIZE OF HOLE	SIZE OF CASING	WEIGHT PER FOOT	SETTING DEPTH	SACKS OF CEMENT	EST. TOP
12 1/4	8 5/8	32	400	400	circ to surface
7 7/8	5 1/2	17	5150	1400	circ to surface

IN ABOVE SPACE DESCRIBE PROPOSED PROGRAM: IF PROPOSAL IS TO DEEPEN OR PLUG BACK, GIVE DATA ON PRESENT PRODUCTIVE ZONE AND PROPOSED NEW PRODUCTIVE ZONE. GIVE BLOWOUT PREVENTER PROGRAM, IF ANY.

I hereby certify that the information above is true and complete to the best of my knowledge and belief.

SIGNATURE

Vickie Teel

TITLE

Production Analyst

DATE

4/16/91

TYPE OR PRINT NAME

Vickie Teel

TELEPHONE NO. 623-6601

(This space for State Use)

ORIGINAL SIGNED BY JERRY SEXTON

APPROVED BY

TITLE

DATE

APR 18 1991

CONDITIONS OF APPROVAL, IF ANY:

Permit Expires 6 Months From Approval
Date Unless Drilling Underway.

MEXICO OIL CONSERVATION COMMISSION
WELL LOCATION AND ACREAGE DEDICATION PLAT

APR 16 1991

Form C-102
Supersedes C-128
Effective 1-1-65

All distances must be from the outer boundaries of the Section.

Operator HARVEY E. YATES CO.			Lease ATLANTIC 32 STATE		Well No. 2
Unit Letter E	Section 32	Township 18 SOUTH	Range 33 EAST	County LEA	
Actual Footage Location of Well: 1980 feet from the NORTH line and 990 feet from the WEST line					
Ground Level Elev. 3743.5	Producing Formation Lee Hills/Gray/Permian		Pool Wildcat - Grayburg		Dedicated Acreage: 40 Acres

1. Outline the acreage dedicated to the subject well by colored pencil or hachure marks on the plat below.
2. If more than one lease is dedicated to the well, outline each and identify the ownership thereof (both as to working interest and royalty).
3. If more than one lease of different ownership is dedicated to the well, have the interests of all owners been consolidated by communitization, unitization, force-pooling, etc?

☐ Yes ☐ No If answer is "yes," type of consolidation _____

If answer is "no," list the owners and tract descriptions which have actually been consolidated. (Use reverse side of this form if necessary.) _____

No allowable will be assigned to the well until all interests have been consolidated (by communitization, unitization, forced-pooling, or otherwise) or until a non-standard unit, eliminating such interests, has been approved by the Commission.

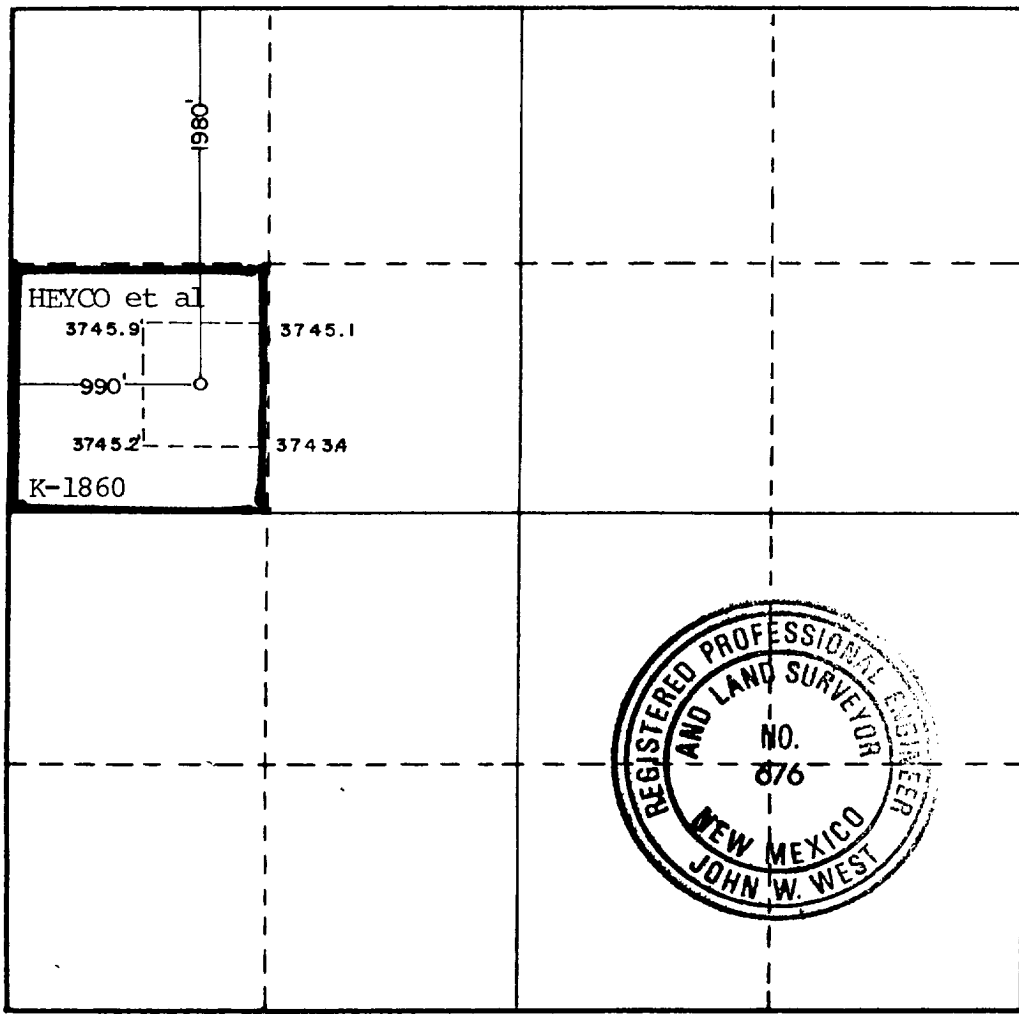

CERTIFICATION

I hereby certify that the information contained herein is true and complete to the best of my knowledge and belief.

Vickie Teel

Name Vickie Teel
Position Production Analyst
Company Harvey E. Yates Company
Date April 16, 1991

I hereby certify that the well location shown on this plat was plotted from field notes of actual surveys made by me or under my supervision, and that the same is true and correct to the best of my knowledge and belief.

Date Surveyed 4-11-91
Registered Professional Engineer and/or Land Surveyor <i>John W. West</i>
Certificate No. JOHN W. WEST, 876 RONALD J. EIDSON, 3239

Atlantic 32 State #2
Sec. 32, T18S, R33E
1980' FNL & 990' FWL
K-1860
Lea County, N.M.

Atlantic 32 State #2
Sec. 32, T18S, R33E
1980' FNL & 990' FWL
K-1860
Lea County, N.M.

900 Series

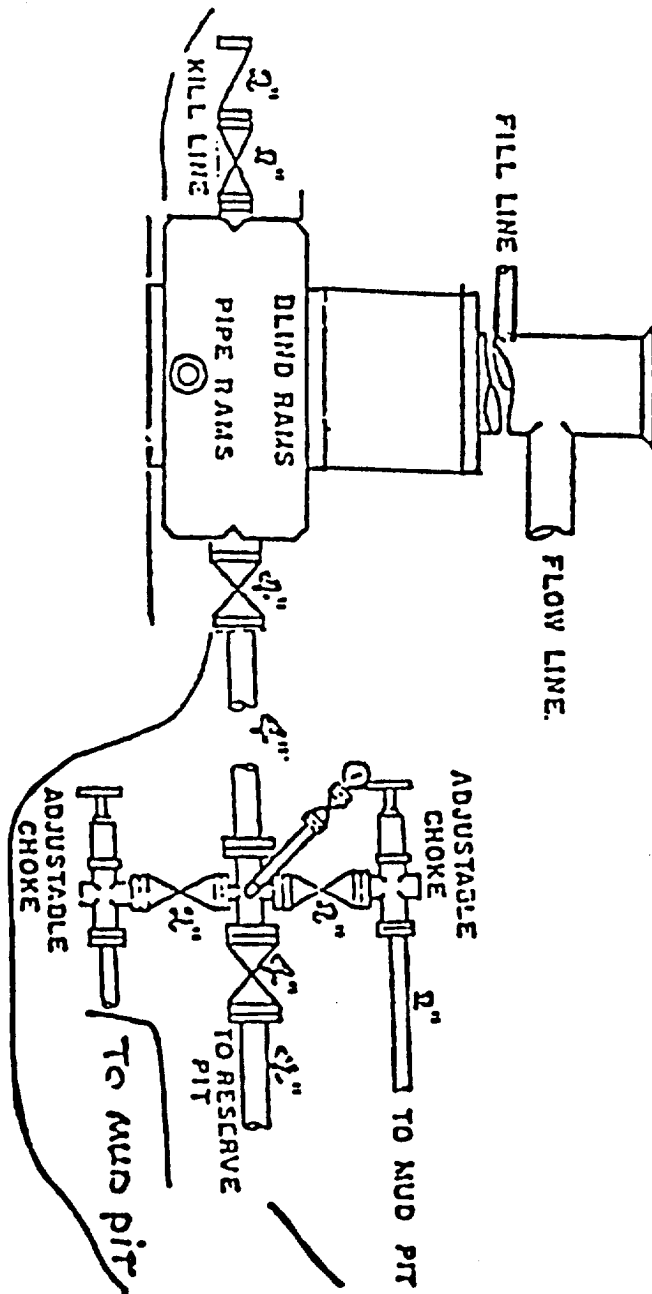

100-7-2-11

ELF

APR 1

100