

District I
1625 N. French Dr., Hobbs, NM 88240
District II
811 South First, Artesia, NM 88210
District III
1000 Rio Brazos Road, Aztec, NM 87410
District IV
2040 South Pacheco, Santa Fe, NM 87505

State of New Mexico
Energy Minerals and Natural Resources

Form C-101
Revised March 17, 1999

Oil Conservation Division
2040 South Pacheco
Santa Fe, NM 87505

Submit to appropriate District Office
State Lease - 6 Copies
Fee Lease - 5 Copies

☐ AMENDED REPORT

APPLICATION FOR PERMIT TO DRILL, RE-ENTER, DEEPEN, PLUGBACK, OR ADD A ZONE

¹ Operator Name and Address EOG RESOURCES, INC. P.O. BOX 2267 MIDLAND, TEXAS 79702		² OGRID Number 7377
		³ API Number 30 - 025-31344
³ Property Code 25581	⁵ Property Name TUERAS STATE	⁶ Well No 1

⁷ Surface Location

UL or lot no.	Section	Township	Range	Lot Idn	Feet from the	North/South line	Feet from the	East/West line	County
O	21	18S	33E		510	SOUTH	1980	EAST	LEA

⁸ Proposed Bottom Hole Location If Different From Surface

UL or lot no.	Section	Township	Range	Lot Idn	Feet from the	North/South line	Feet from the	East/West line	County

⁹ Proposed Pool 1

CORBIN SOUTH BONE SPRING

¹⁰ Proposed Pool 2

¹¹ Work Type Code P	¹² Well Type Code O	¹³ Cable/Rotary	¹⁴ Lease Type Code S	¹⁵ Ground Level Elevation 3815'
¹⁶ Multiple NO	¹⁷ Proposed Depth 11,650'	¹⁸ Formation BONE SPRING	¹⁹ Contractor	²⁰ Spud Date 08/05/91

²¹ Proposed Casing and Cement Program

Hole Size	Casing Size	Casing weight/foot	Setting Depth	Sacks of Cement	Estimated TOC
17-1/2"	13-3/8"	48#	412'	400	CIRC
12-1/4"	8-5/8"	28#	2907'	1250	CIRC
7-7/8"	5-1/2"	17#	11,650'	2035	2646' (CBL)

22 Describe the proposed program. If this application is to DEEPEN or PLUG BACK, give the data on the present productive zone and proposed new productive zone. Describe the blowout prevention program, if any. Use additional sheets if necessary.

1. Set CIBP @ 11,000' w/35' cmt on top to abandon Wolfcamp perms 11,020-11,392'.
2. Perforate 3rd Bone Spring Carbonate 10,065'-10,070' & 10,096-10,120'.
3. Acidize perms 10,065-10,120' w/2500 gals 15% NEFE HCL & 100 ball sealers and swab test.
4. Set CIBP @ 10,040' to SI perms 10,065-10,120' while completing additional pay.
5. Perforate 2nd Bone Spring Sand "B" 9,578-9,606'.
6. Fracture stimulate perms 9,578-9,606'.
7. Set CIBP @ 9,500' and perforate 2nd Bone Spring Sand "A" 9,248-9,260'.
8. Fracture stimulate perms 9,248-9,260'.
9. Drill out CIBP's @ 9,500' and 10,040' and swab/flow well to clean up.
10. Put all Bone Spring perms 9,248-10,120' on production.

Permit Expires 1 Year From Approval
Date Unless Renewed
Plugback

²³ I hereby certify that the information given above is true and complete to the best of my knowledge and belief.

Signature:

William G. Horne

Printed name: William G. Horne

Title: Petroleum Engineer

Date: 03/06/01

Phone: (915) 686-3722

OIL CONSERVATION DIVISION

Approved by:

Title:

Approval Date:

Expiration Date:

Conditions of Approval:

Attached ☐

Submit to Appropriate
District Office
State Lease - 4 copies
Fee Lease - 3 copies

State of New Mexico
Energy, Minerals and Natural Resources Department

Form C-102
Revised 1-1-89

OIL CONSERVATION DIVISION

P.O. Box 2088
Santa Fe, New Mexico 87504-2088

DISTRICT I
P.O. Box 1980, Hobbs, NM 88240

DISTRICT II
P.O. Drawer DD, Artesia, NM 88210

DISTRICT III
1000 Rio Brazos Rd., Aztec, NM 87410

WELL LOCATION AND ACREAGE DEDICATION PLAT

All Distances must be from the outer boundaries of the section

Operator EOG RESOURCES, INC.			Lease TIJERAS STATE		Well No. 1
Unit Letter O	Section 21	Township 18 SOUTH	Range 33 EAST	County NMPM	LEA
Actual Footage Location of Well: 1980 feet from the EAST line and 510 feet from the SOUTH line					
Ground level Elev. 3815.3	Producing Formation BONE SPRING		Pool CORBIN SOUTH	Dedicated Acreage: 4.0 Acres	

1. Outline the acreage dedicated to the subject well by colored pencil or hatchure marks on the plat below.

2. If more than one lease is dedicated to the well, outline each and identify the ownership thereof (both as to working interest and royalty).

3. If more than one lease of different ownership is dedicated to the well, have the interest of all owners been consolidated by communitization, unitization, force-pooling, etc.?

☐ Yes ☐ No If answer is "yes" type of consolidation _____

If answer is "no" list the owners and tract descriptions which have actually been consolidated. (Use reverse side of this form if necessary.)

No allowable will be assigned to the well until all interests have been consolidated (by communitization, unitization, forced-pooling, or otherwise) or until a non-standard unit, eliminating such interest, has been approved by the Division.

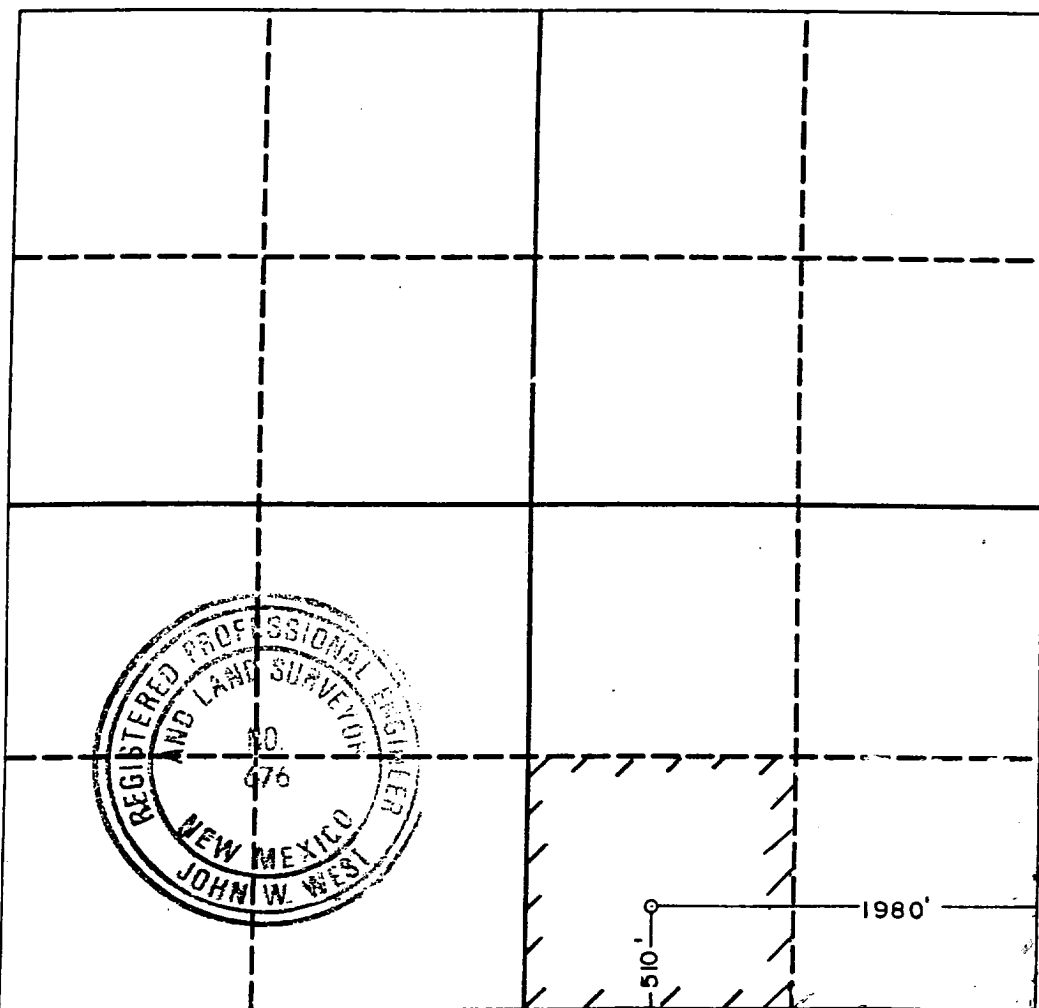

OPERATOR CERTIFICATION

I hereby certify that the information contained herein is true and complete to the best of my knowledge and belief.

Signature: *[Signature]*
Printed Name: **WILLIAM G. HORNE**
Position: **PETR. ENGR.**
Company: **EOG RESOURCES, INC.**
Date: **03/06/01**

SURVEYOR CERTIFICATION

I hereby certify that the well location shown on this plat was plotted from field notes of actual surveys made by me or under my supervision, and that the same is true and correct to the best of my knowledge and belief.

Date Surveyed: **AUG. 1, 1991**
Signature & Seal of Professional Surveyor: *[Signature]*

Certificate No. **JOHN W. WEST, 676**
RONALD J. EIDSON, 3239

0 330 660 990 1320 1650 1980 2310 2640 2000 1500 1000 500 0