

UNITED STATES
DEPARTMENT OF THE INTERIOR
BUREAU OF LAND MANAGEMENT

N. OIL CONS. COMMISSION
P.O. BOX 1980
HOBBS, NEW MEXICO 88240

FORM APPROVED
Budget Bureau No. 1004-0135
Expires: March 31, 1993

SUNDRY NOTICES AND REPORTS ON WELLS

Do not use this form for proposals to drill or to deepen or reentry to a different reservoir.
Use "APPLICATION FOR PERMIT—" for such proposals

SUBMIT IN TRIPLICATE

1. Type of Well <input checked="" type="checkbox"/> Oil Well <input type="checkbox"/> Gas Well <input type="checkbox"/> Other	5. Lease Designation and Serial No. NM 81599
2. Name of Operator Mitchell Energy Corporation	6. If Indian, Allottee or Tribe Name NA
3. Address and Telephone No. P. O. Box 4000, The Woodlands, TX 77387-4000	7. If Unit or CA, Agreement Designation NA
4. Location of Well (Footage, Sec., T., R., M., or Survey Description) 1650' FNL & 990' FWL Unit E, Section 1, T19S, R32E	8. Well Name and No. Cochise "1" Federal #1
	9. API Well No. 30-025-31604
	10. Field and Pool, or Exploratory Area Tonto, West (Bone Spring)
	11. County or Parish, State Lea County, NM

12. CHECK APPROPRIATE BOX(s) TO INDICATE NATURE OF NOTICE, REPORT, OR OTHER DATA

TYPE OF SUBMISSION	TYPE OF ACTION
<input checked="" type="checkbox"/> Notice of Intent	<input type="checkbox"/> Abandonment
<input type="checkbox"/> Subsequent Report	<input type="checkbox"/> Recompletion
<input type="checkbox"/> Final Abandonment Notice	<input type="checkbox"/> Plugging Back
	<input type="checkbox"/> Casing Repair
	<input type="checkbox"/> Altering Casing
	<input checked="" type="checkbox"/> Other <u>Temporarily Abandon</u>
	<input type="checkbox"/> Change of Plans
	<input type="checkbox"/> New Construction
	<input type="checkbox"/> Non-Routine Fracturing
	<input type="checkbox"/> Water Shut-Off
	<input type="checkbox"/> Conversion to Injection
	<input type="checkbox"/> Dispose Water

(Note: Report results of multiple completion on Well Completion or Recompletion Report and Log form.)

13. Describe Proposed or Completed Operations (Clearly state all pertinent details, and give pertinent dates, including estimated date of starting any proposed work. If well is directionally drilled, give subsurface locations and measured and true vertical depths for all markers and zones pertinent to this work.)*

- 1) Notify BLM at (505) 393-3612 24 hours prior to commencing operations.
- 2) MIRU workover unit.
- 3) POOH LD rods and pump.
- 4) ND wellhead and NU BOP.
- 5) Release TA and POOH LD 2 3/4" tubing.
- 6) Set CIBP at $\pm 7450'$. Dump bail 35' of cement on top of CIBP.
- 7) Load hole with 2% KCl + oxygen scavenger. Test CIBP and casing to 500 psi for 30 minutes. Record test on pressure chart and send chart to Midland office. Have BLM witness test if possible.
- 8) ND BOP. NU casing flange with valve and gauge for wellhead.
- 9) File subsequent Sundry Notice.

14. I hereby certify that the foregoing is true and correct

Signed [Signature]

Title Staff Production Engineer

Date 1-4-95

(This space for Federal or State office use)

Orig. Signed by Shannon J. Shaw

Approved by _____
Conditions of approval, if any:

Title **PETROLEUM ENGINEER**

Date 2/1/95

Title 18 U.S.C. Section 1001, makes it a crime for any person knowingly and willfully to make to any department or agency of the United States any false, fictitious or fraudulent statements or representations as to any matter within its jurisdiction.

*See Instruction on Reverse Side

RECEIVED

APR 11 1960
UNITED STATES
OFFICE

KB: 3708'
GL: 3694'

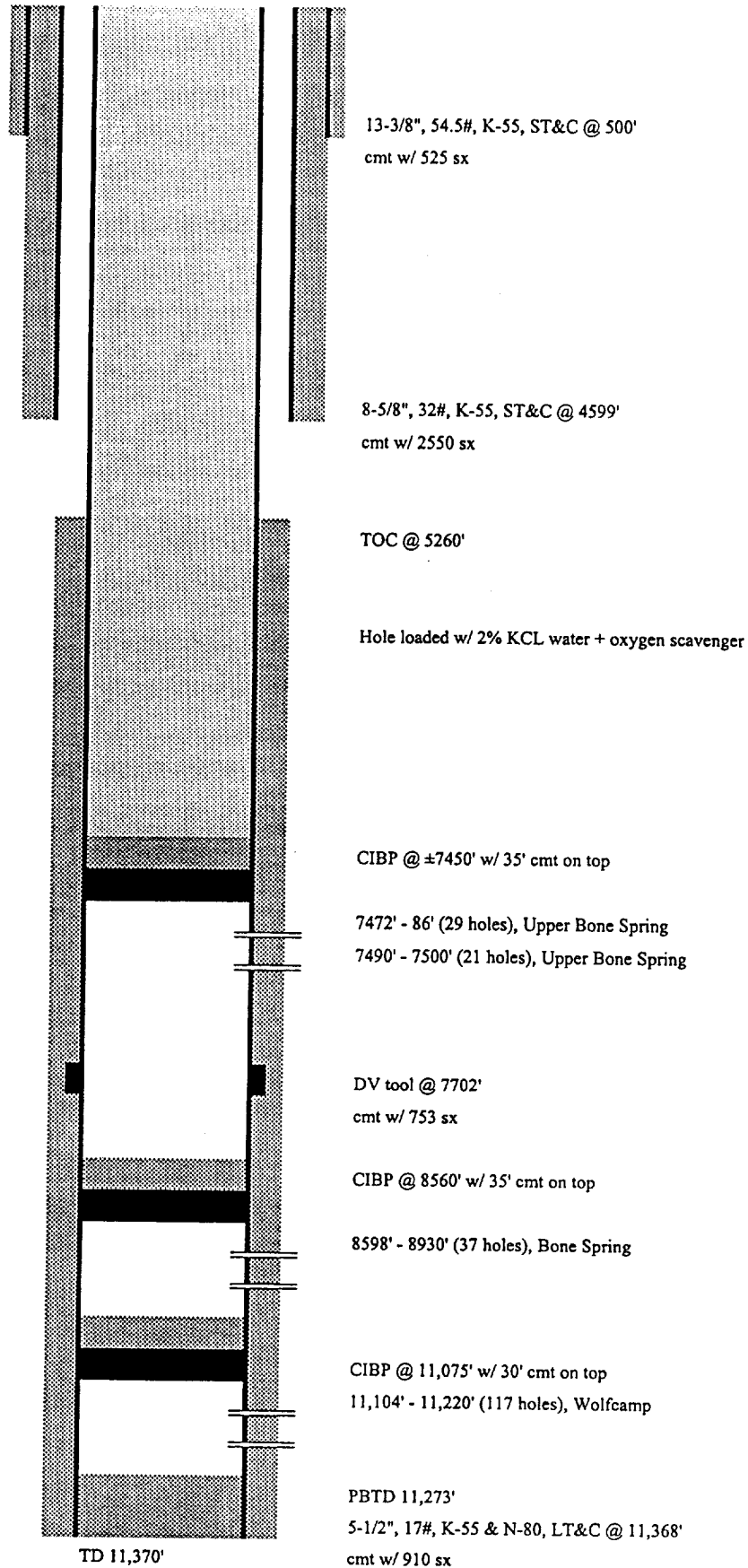

Cochise "1" Federal #1
West Tonto (Bone Spring)
Unit E, S 1, T19S, R32E
Lea Co., NM

JGC 12-5-94

Present

KB: 3708'

GL: 3694'

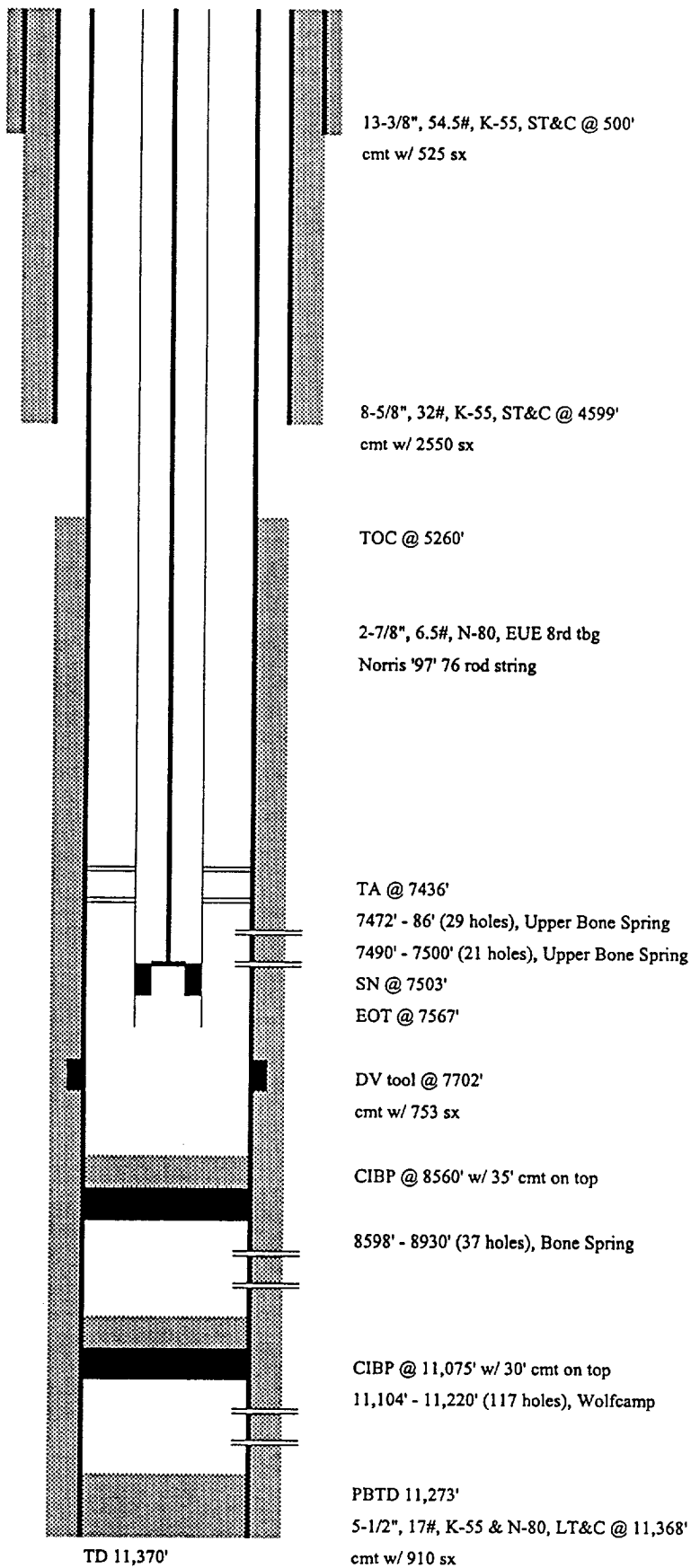

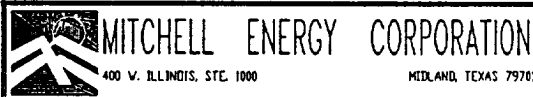
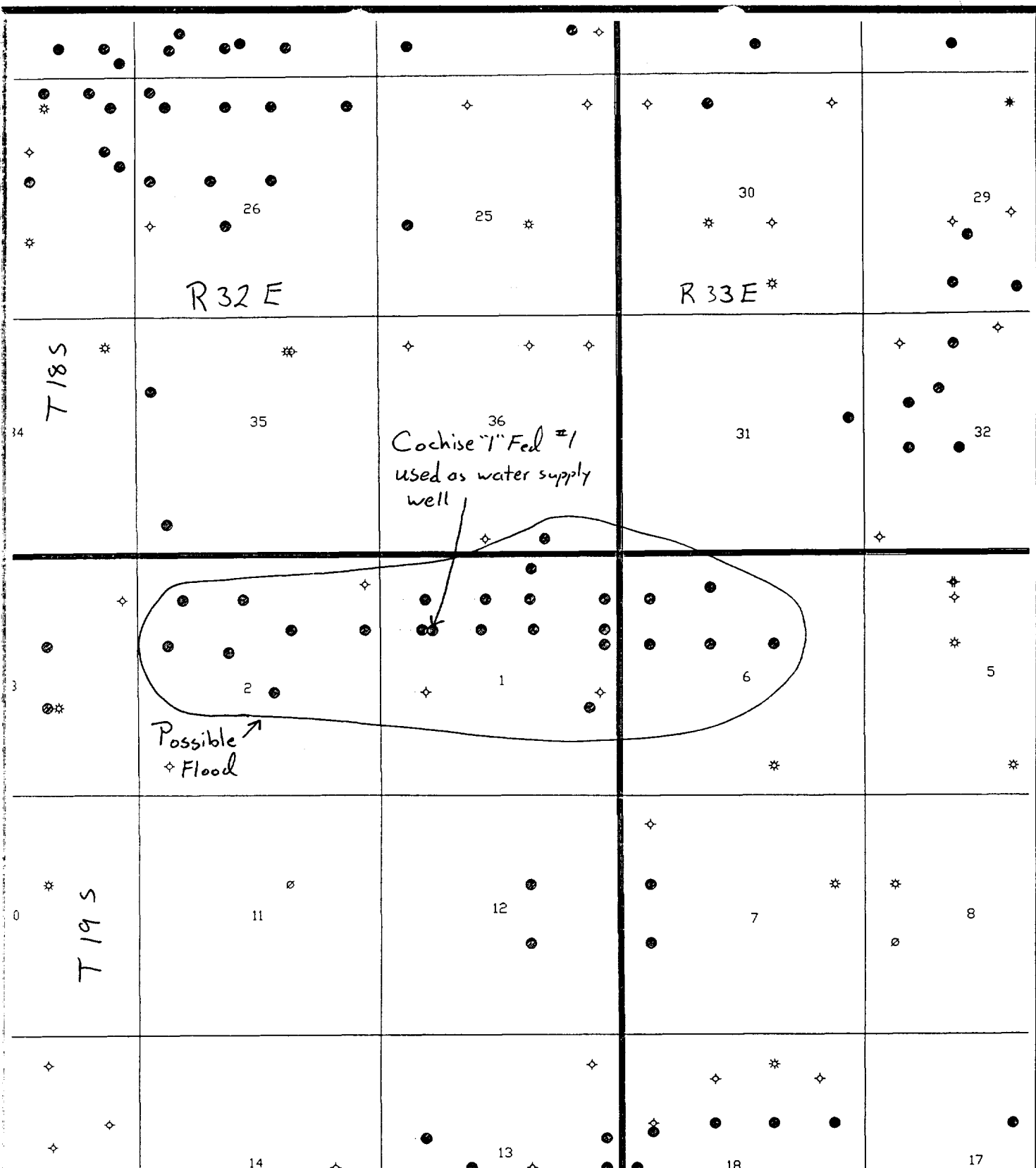

Cochise Area
Lea County, New Mexico

PROPOSED
Buffalo Yates Unit

Geology:
Geophysics:
Drafted:

C.L. :
Date: 1-4-95
Scale: 1" = 3000'