

D: RICI 1
P.O. Box 1980, Hobbs, NM 88241-1980
DISTRICT II
P.O. Box Drawer DD, Artesia, NM 88211-0719
DISTRICT III
1000 Rio Brazos Rd., Aztec, NM 87410
DISTRICT IV
P.O. Box 2088, Santa Fe, NM 87504-2088

State of New Mexico
Energy, Minerals and Natural Resources Department

Form C-101
Revised February 10, 1994
Instructions on back
Submit to Appropriate District Office
State Lease - 6 Copies
Fee Lease - 5 Copies
☐ AMENDED REPORT

OIL CONSERVATION DIVISION

P.O. Box 2088
Santa Fe, New Mexico 87504-2088

APPLICATION FOR PERMIT TO DRILL, RE-ENTER, DEEPEN, PLUGBACK, OR ADD A ZONE

¹ Operator Name and Address TEXACO EXPLORATION & PRODUCTION INC. P.O. BOX 730, HOBBS, NM 88240		² OGRID Number 022351
⁴ Property Code 11052	⁵ Property Name NEW MEXICO R STATE NCT-3	³ API Number 30-025-31993
		⁶ Well No. 26

⁷ Surface Location									
UI or lot no.	Section	Township	Range	Lot.Idn	Feet From The	North/South Line	Feet From The	East/West Line	County
J	1	18-S	34-E		1980	SOUTH	1755	EAST	LEA

⁸ Proposed Bottom Hole Location If Different From Surface									
UI or lot no.	Section	Township	Range	Lot.Idn	Feet From The	North/South Line	Feet From The	East/West Line	County
⁹ Proposed Pool 1 Vacuum Blinebry					¹⁰ Proposed Pool 2				

¹¹ Work Type Code P	¹² WellType Code O	¹³ Rotary or C.T. ROTARY	¹⁴ Lease Type Code S	¹⁵ Ground Level Elevation GR-3987', KB-4001'
¹⁶ Multiple No	¹⁷ Proposed Depth 8000'	¹⁸ Formation BLINEBRY	¹⁹ Contractor PRIDE	²⁰ Spud Date 4/15/96

²¹ Proposed Casing and Cement Program					
SIZE OF HOLE	SIZE OF CASING	WEIGHT PER FOOT	SETTING DEPTH	SACKS OF CEMENT	EST. TOP
11	8 5/8	24#	1470'	CL-C 650 SX CIRC. 14	
7 7/8	5 1/2	15.5# & 17	8000'	CL-H 1750 SX,CIRC. 1	
				DV @ 5003'	

²² Describe the proposed program. If this application is to DEEPEN or PLUG BACK give the data on the present productive zone and proposed new productive zone.
Describe the blowout prevention program, if any. Use additional sheets if necessary.

WELL CURRENTLY COMPLETED AS AN INJECTION WELL IN THE VACUUM DRINKARD POOL WITH PERFS FROM 7585'-7829'. THE FOLLOWING PROCEDURE IS TO PLUGBACK THE WELL INTO THE VACUUM BLINEBRY AS A PRODUCING OIL WELL

1. MIRU. Install BOP & TOH w/ injection tbg & pkr. RIH w/ bit & scraper. Clean out 5-1/2" prod csg to 7550'.
2. TIH w/ 5-1/2" CIBP & set @ 7535'. Cap CIBP w/ 35' cement (New PBTD: 7500').
3. Perforate Vacuum Blinebry from 6664' - 6848' (2 jsf, 94 hles, 120° phasing, .45" holes, 4" gun)
4. TIH w/ 5-1/2" treating pkr & RBP on 2-7/8" WS. Pressure test tbg to 8,000 psi going in hole. Set RBP @ 6898' & pressure test. Set pkr @ 6634'. Load BS w/ 2% KCL water & test to 500 psi.
5. Acidize Vacuum Blinebry perfs (6664'-6848') with 2,500 gallons 15% NEFE HCL. Acid fracture perfs w/ 12,000 gallons 20% HCL.
6. Flow well back immediately until dead. Swab out residue. TOH with WS, pkr, & RBP.
7. TIH with production equipment. Set seating nipple @ ~ 7050'. Return well to production as a oil producer in Vacuum Blinebry pool.

²³ I hereby certify that the rules and regulations of the Oil Conservation Division have been complied with and that the information given above is true and complete to the best of my knowledge and belief.

Signature 

Printed Name Monte C. Duncan

Title Engr Asst

Date 4/8/96

Telephone 397-0418

OIL CONSERVATION DIVISION

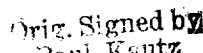
Approved By: 
Paul Kautz
Geologist

Title:

Approval Date: 4, 8, 1996 Expiration Date:

Conditions of Approval:
Attached ☐

DISTRICT I

P.O. Box 1980, Hobbs, NM 88241-1980

DISTRICT II

P.O. Box Drawer DD, Artesia, NM 88211-0719

DISTRICT III

1000 Rio Brazos Rd., Aztec, NM 87410

DISTRICT IV

P.O. Box 2088, Santa Fe, NM 87504-2088

State of New Mexico
Energy, Minerals and Natural Resources Department

OIL CONSERVATION DIVISION

P.O. Box 2088
Santa Fe, New Mexico 87504-2088

Form C-102

Revised February 10, 1994

Instructions on back

Submit to Appropriate District Office

State Lease - 4 Copies

Fee Lease - 3 Copies

☐ AMENDED REPORT**WELL LOCATION AND ACREAGE DEDICATION PLAT**

¹ API Number 30-025-31993	² Pool Code 61850	³ Pool Name VACUUM BLINEBRY
⁴ Property Code 11052	⁵ Property Name NEW MEXICO R STATE NCT-3	
⁷ OGRID Number 022351	⁸ Operator Name TEXACO EXPLORATION & PRODUCTION INC.	⁶ Well No. 26 ⁹ Elevation GR-3987', KB-4001'

¹⁰ Surface Location

UI or lot no.	Section	Township	Range	Lot.Idn	Feet From The	North/South Line	Feet From The	East/West Line	County
J	1	18-S	34-E		1980	SOUTH	1755	EAST	LEA

¹¹ Bottom Hole Location If Different From Surface

UI or lot no.	Section	Township	Range	Lot.Idn	Feet From The	North/South Line	Feet From The	East/West Line	County

¹² Dedicated Acres 40	¹³ Joint or Infill No	¹⁴ Consolidation Code	¹⁵ Order No.
-------------------------------------	-------------------------------------	----------------------------------	-------------------------

NO ALLOWABLE WILL BE ASSIGNED TO THIS COMPLETION UNTIL ALL INTERESTS HAVE BEEN CONSOLIDATED
OR A NON-STANDARD UNIT HAS BEEN APPROVED BY THE DIVISION

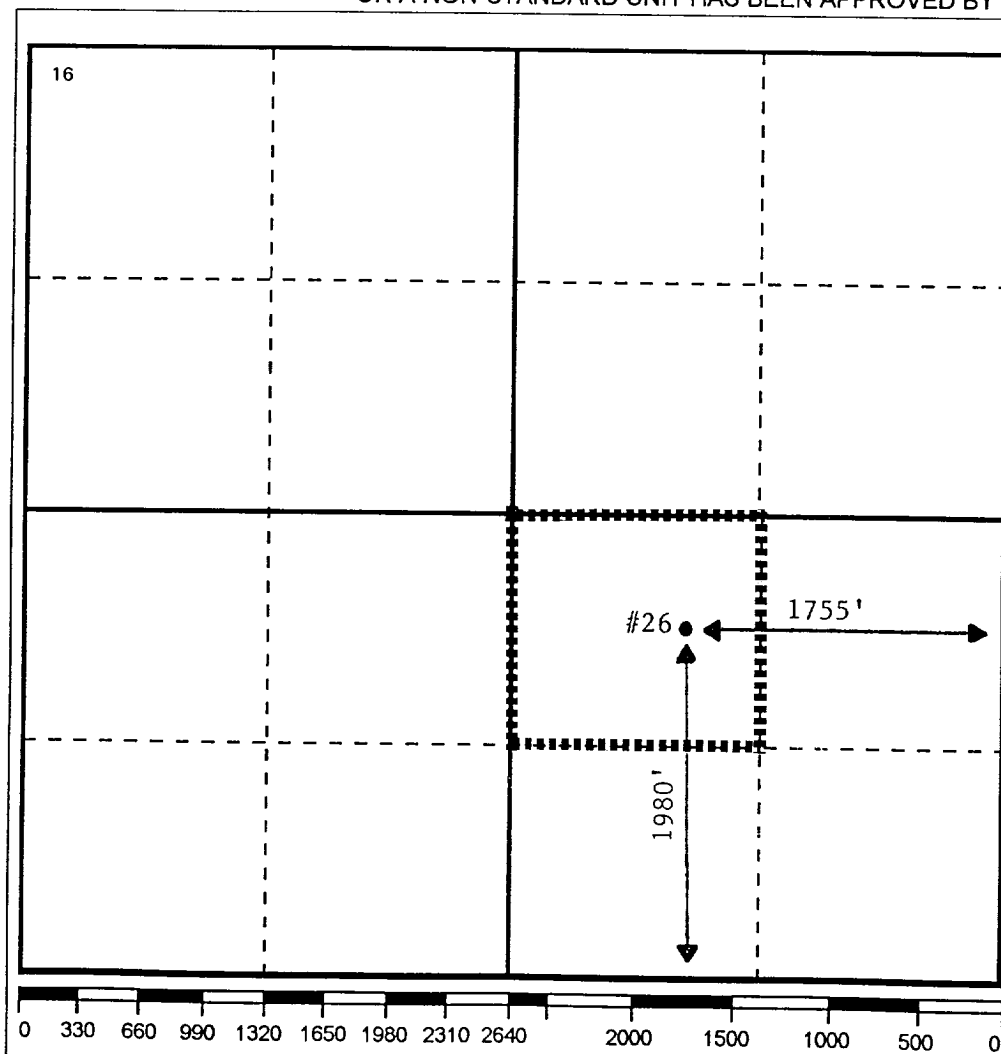
**17 OPERATOR CERTIFICATION**

I hereby certify that the information
contained herein is true and complete to the
best of my knowledge and belief

Signature

Printed Name

Monte C. Duncan

Position

Engr Asst

Date

4/8/96

18 SURVEYOR CERTIFICATION

I hereby certify that the well location shown
on this plat was plotted from field notes of
actual surveys made by me or under my
supervision, and that the same is true and
correct to the best of my knowledge and
belief.

Date Surveyed

Signature & Seal of
Professional Surveyor

Certificate No.