

DISTRICT I
P.O. Box 1980, Hobbs, NM 88241-1980
DISTRICT II
P.O. Box Drawer DD, Artesia, NM 88211-0719
DISTRICT III
1000 Rio Brazos Rd., Aztec, NM 87410
DISTRICT IV
P.O. Box 2088, Santa Fe, NM 87504-2088

State of New Mexico
Energy, Minerals and Natural Resources Department

OIL CONSERVATION DIVISION

P.O. Box 2088
Santa Fe, New Mexico 87504-2088

Form C-101
Revised February 10, 1994
Instructions on back
Submit to Appropriate District Office
State Lease - 6 Copies
Fee Lease - 5 Copies

☐ AMENDED REPORT

APPLICATION FOR PERMIT TO DRILL, RE-ENTER, DEEPEN, PLUGBACK, OR ADD A ZONE

| | | |
|------------------------------------------------------------------------------------------------------------------|----------------------------------------------------|-----------------------------------------|
| ¹ Operator Name and Address TEXACO EXPLORATION & PRODUCTION INC. 205 E. Bender, HOBBS, NM 88240 | | ² OGRID Number 022351 |
| ⁴ Property Code 11046 | ⁵ Property Name NEW MEXICO 'M' STATE | ³ API Number 30-025-32016 |
| | | ⁶ Well No. 9 |

| ⁷ Surface Location | | | | | | | | | |
|-------------------------------|---------|----------|-------|---------|---------------|------------------|---------------|----------------|--------|
| UI or lot no. | Section | Township | Range | Lot.Idn | Feet From The | North/South Line | Feet From The | East/West Line | County |
| C | 1 | 18S | 34E | | 660 | NORTH | 2310 | WEST | LEA |

| ⁸ Proposed Bottom Hole Location If Different From Surface | | | | | | | | | |
|----------------------------------------------------------------------|---------|----------|-------|---------|-------------------------------|------------------|---------------|----------------|--------|
| UI or lot no. | Section | Township | Range | Lot.Idn | Feet From The | North/South Line | Feet From The | East/West Line | County |
| ⁹ Proposed Pool 1 Vacuum Blinebry | | | | | ¹⁰ Proposed Pool 2 | | | | |

| | | | | |
|-----------------------------------|---------------------------------------|--------------------------------------------|------------------------------------|------------------------------------------------------------|
| ¹¹ Work Type Code P | ¹² WellType Code O | ¹³ Rotary or C.T. Rotary | ¹⁴ Lease Type Code S | ¹⁵ Ground Level Elevation GR-3994', KB-4008' |
| ¹⁶ Multiple No | ¹⁷ Proposed Depth 8100' | ¹⁸ Formation Vacuum Blinebry | ¹⁹ Contractor | ²⁰ Spud Date 6/1/99 |

²¹ Proposed Casing and Cement Program

| SIZE OF HOLE | SIZE OF CASING | WEIGHT PER FOOT | SETTING DEPTH | SACKS OF CEMENT | EST. TOP |
|--------------|----------------|-----------------|---------------|-----------------------|----------|
| 11" | 8 5/8" | | 1470' | 650 SX (CIRC 90 SX) | |
| 7 7/8" | 5 1/2" | | 8100' | 1825 SX (CIRC 280 SX) | |
| | | | | | |
| | | | | | |
| | | | | | |

²² Describe the proposed program. If this application is to DEEPEN or PLUG BACK give the data on the present productive zone and proposed new productive zone.
Describe the blowout prevention program, if any. Use additional sheets if necessary.

Texaco intends to recompleat the subject well in the Vacuum Blinebry. The intended procedure is as follows:

1. MIRU PU. Hot oil tbg & TOH w/rds & pmp. NU BOP.
2. TIH w/bit & csg scraper on WS. C/O to TD @ 8100'.
3. TIH w/CIBP & set @ 7300'. TIH w/csg gun & perf 6850-6920'. Place 35' cmt cap on CIBP.
4. TIH w/pkr on tbg. PSA 6800'. Load backside & test pkr to 500#.
5. Acidize w/6000 gals 15% NEFE HCL.
6. Swab back load. Rel pkr & TOH w/tbg.
7. TIH w/pkr on 3 1/2" Tbg. PSA 6750'. Load backside & test to 100#.
8. Frac well & bagin flowback @ 1/2 BPM. Run snkr bar. Rel pkr. TIH w/bit. C/O to top of cmt @ 7235'.
9. TIH w/prod tbg, rds & pmp. When permits are recvd, commingle well.

Permit Expires 1 Year From Approval
Date Unless Drilling Underway
Plug-Back

²³ I hereby certify that the rules and regulations of the Oil Conservation Division have been complied with and that the information given above is true and complete to the best of my knowledge and belief.

Signature *J. Denise Leake*

Printed Name J. Denise Leake

Title Engineering Assistant

Date 5/10/99

Telephone 397-0405

OIL CONSERVATION DIVISION

Approved By: ORIGINAL SIGNED BY CHRIS WILLIAM:
DISTRICT I SUPERVISOR

Title:

Approval Date MAY 13 1999

Expiration Date:

Conditions of Approval:
Attached ☐

DISTRICT I

P.O. Box 1980, Hobbs, NM 88241-1980

DISTRICT II

P.O. Box Drawer DD, Artesia, NM 88211-0719

DISTRICT III

1000 Rio Brazos Rd., Aztec, NM 87410

DISTRICT IV

P.O. Box 2088, Santa Fe, NM 87504-2088

State of New Mexico

Energy, Minerals and Natural Resources Department

Form C-102

Revised February 10, 1994

Instructions on back

Submit to Appropriate District Office

State Lease - 4 Copies

Fee Lease - 3 Copies

☐ AMENDED REPORT

OIL CONSERVATION DIVISION

P.O. Box 2088

Santa Fe, New Mexico 87504-2088

WELL LOCATION AND ACREAGE DEDICATION PLAT

| | | |
|-----------------------------------------|--------------------------------------------------------------------|----------------------------------------------|
| ¹ API Number 30-025-32016 | ² Pool Code 61850 | ³ Pool Name VACUUM BLINEBRY |
| ⁴ Property Code 11046 | ⁵ Property Name NEW MEXICO 'M' STATE | ⁶ Well No. 9 |
| ⁷ OGRID Number 022351 | ⁸ Operator Name TEXACO EXPLORATION & PRODUCTION INC. | ⁹ Elevation GR-3994', KB-4008' |

¹⁰ Surface Location

| UI or lot no. | Section | Township | Range | Lot.Idn | Feet From The | North/South Line | Feet From The | East/West Line | County |
|---------------|---------|----------|-------|---------|---------------|------------------|---------------|----------------|--------|
| C | 1 | 18S | 34E | | 660 | NORTH | 2310 | WEST | LEA |

¹¹ Bottom Hole Location If Different From Surface

| UI or lot no. | Section | Township | Range | Lot.Idn | Feet From The | North/South Line | Feet From The | East/West Line | County |
|---------------|---------|----------|-------|---------|---------------|------------------|---------------|----------------|--------|
| | | | | | | | | | |

| | | | |
|--------------------------------------|-------------------------------------|----------------------------------|-------------------------|
| ¹² Dedicated Acres 4.0 | ¹³ Joint or Infill No | ¹⁴ Consolidation Code | ¹⁵ Order No. |
|--------------------------------------|-------------------------------------|----------------------------------|-------------------------|

NO ALLOWABLE WILL BE ASSIGNED TO THIS COMPLETION UNTIL ALL INTERESTS HAVE BEEN CONSOLIDATED
OR A NON-STANDARD UNIT HAS BEEN APPROVED BY THE DIVISION

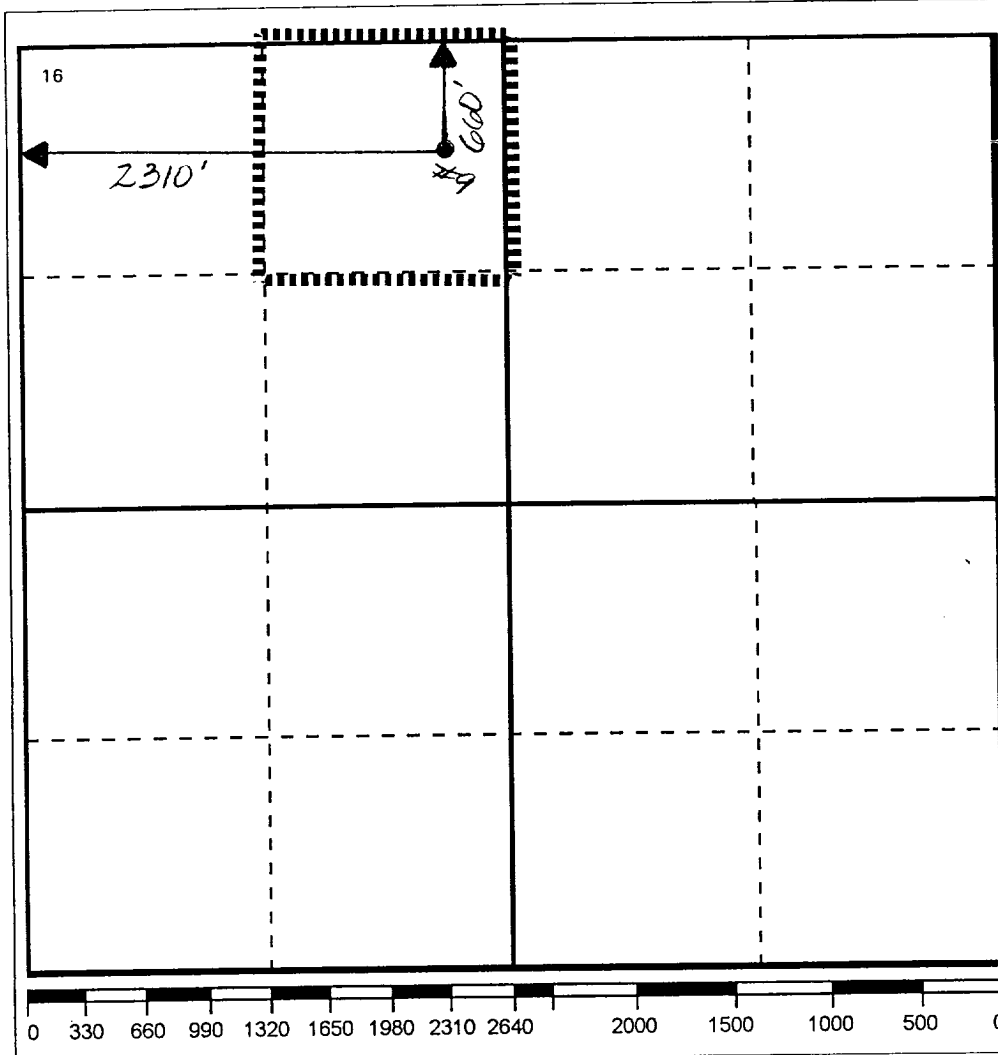

17 OPERATOR CERTIFICATION

I hereby certify that the information contained herein is true and complete to the best of my knowledge and belief

Signature

J. Denise Leake

Printed Name

J. Denise Leake

Position

Engineering Assistant

Date

5/10/99

18 SURVEYOR CERTIFICATION

I hereby certify that the well location shown on this plat was plotted from field notes of actual surveys made by me or under my supervision, and that the same is true and correct to the best of my knowledge and belief.

Date Surveyed

Signature & Seal of
Professional Surveyor

Certificate No.