

N. M. OIL CONS. COMMISSION
P. O. BOX 1980
HOBBS, NEW MEX. 88240
UNITED STATES
DEPARTMENT OF THE INTERIOR
BUREAU OF LAND MANAGEMENT

SUBMIT IN TRIP DATE
(Other instructions on reverse side)

Form approved.
Budget Bureau No. 1004-0136
Expires August 31, 1985

APPLICATION FOR PERMIT TO DRILL, DEEPEN, OR PLUG BACK

1a. TYPE OF WORK
DRILL ☒ PLUG BACK ☐
b. TYPE OF WELL
OIL WELL ☒ GAS WELL ☐ OTHER ☐
2. NAME OF OPERATOR
Santa Fe Energy Operating Partners, L.P.
3. ADDRESS OF OPERATOR
550 W. Texas, Suite 1330, Midland, Texas 79701
4. LOCATION OF WELL (Report location clearly and in accordance with State requirements.)
At surface (M), 660' FSL and 990' FSL, Sec. 5, T-18S, R-33E
At proposed prod. zone
14. DISTANCE IN MILES AND DIRECTION FROM NEAREST TOWN OR POST OFFICE*
10 miles SE from Maljamar, New Mexico
15. DISTANCE FROM PROPOSED* LOCATION TO NEAREST PROPERTY OR LEASE LINE, FT. (Also to nearest drilg. unit line, if any)
660
16. NO. OF ACRES IN LEASE
320
17. NO. OF ACRES ASSIGNED TO THIS WELL
80
18. DISTANCE FROM PROPOSED LOCATION* TO NEAREST WELL, DRILLING, COMPLETED, OR APPLIED FOR, ON THIS LEASE, FT.
1650'
19. PROPOSED DEPTH
11,500'
20. ROTARY OR CABLE TOOLS
Rotary
21. ELEVATIONS (Show whether DF, RT, GR, etc.)
3959' GR
22. APPROX. DATE WORK WILL START*
April 15, 1993

5. LEASE DESIGNATION AND SERIAL NO.
LC-062391
6. IF INDIAN, ALLOTTEE OR TRIBE NAME
7. UNIT AGREEMENT NAME
8. FARM OR LEASE NAME
Kachina "5" Federal
9. WELL NO.
5
10. FIELD AND POOL, OR WILDCAT
South Corbin Wolfcamp
11. SEC., T., R., M., OR BLK. AND SURVEY OR AREA
Sec. 5, T-18S, R-33E
12. COUNTY OR PARISH
Lea
13. STATE
NM

23. PROPOSED CASING AND CEMENTING PROGRAM

SIZE OF HOLE	SIZE OF CASING	WEIGHT PER FOOT	SETTING DEPTH	QUANTITY OF CEMENT
17-1/2"	13-3/8"	48.0	450'	450 sx to circulate
12-1/4"	8-5/8"	32.0	3100'	1500 sx to circulate
7-7/8"	5-1/2"	17.0	11,500'	TOC 600' above possible pays

We propose to drill to a depth sufficient to test the Wolfcamp formation for oil. If productive, 5-1/2" casing will be cemented at TD. If non-productive, the well will be plugged and abandoned in a manner consistent with Federal regulations. Specific programs as per Onshore Oil and Gas Order No. 1 are outlined in the following attachments:

Drilling Program

Exhibit A - Operations Plan
Exhibit B - BOP and Choke Schematic
Exhibit C - Drilling Fluids Program
Exhibit D - Auxiliary Equipment

Exhibit E - Topo Map of Location
Exhibit F - Plat Showing Existing Wells
Exhibit G - Well Site Layout
Hydrogen Sulfide Drilling Operations Plan

- 1) We respectfully request a variance waiver to BLM requirements to install pit monitoring equipment when drilling below the Wolfcamp. The Wolfcamp is not over pressured in the area, therefore, the equipment serves no purpose. This request is based on the data presented with our APD for the Kachina 5 Fed No. 4, for which the waiver was approved.

IN ABOVE SPACE DESCRIBE PROPOSED PROGRAM: If proposal is to deepen or plug back, give data on present productive zone and proposed new productive zone. If proposal is to drill or deepen directionally, give pertinent data on subsurface locations and measured and true vertical depths. Give blowout preventer program, if any.

24. SIGNED Daniel Roberts TITLE Sr. Drilling Engineer DATE March 8, 1993

(This space for Federal or State office use)

PERMIT NO. _____ APPROVAL DATE _____

APPROVED BY (ORIG. SGD) RICHARD L. MANUS TITLE _____ DATE 6-11-93

APPROVAL SUBJECT TO:

GENERAL REQUIREMENTS AND
SPECIAL STIPULATIONS

ATTACHED

*See Instructions On Reverse Side

Title 18 U.S.C. Section 1001, makes it a crime for any person knowingly and willfully to make to any department or agency of the United States any false, fictitious or fraudulent statements or representations as to any matter within its jurisdiction.

RECEIVED

JUN 17 1993

**OCD HOBBS
OFFICE**

Submit to Appropriate
District Office
State Lease - 4 copies
Fee Lease - 3 copies

State of New Mexico
Energy, Minerals and Natural Resources Department

Form C-102
Revised 1-1-89

OIL CONSERVATION DIVISION

P.O. Box 2088
Santa Fe, New Mexico 87504-2088

DISTRICT I

P.O. Box 1980, Hobbs, NM 88240

DISTRICT II

P.O. Drawer DD, Artesia, NM 88210

DISTRICT III

1000 Rio Brazos Rd., Aztec, NM 87410

WELL LOCATION AND ACREAGE DEDICATION PLAT

All Distances must be from the outer boundaries of the section

Operator SANTA FE ENERGY OPERATING PARTNERS, L.P.			Lease KACHINA 5 FEDERAL		Well No. 5
Unit Letter M	Section 5	Township 18 SOUTH	Range 33 EAST	NMPM	County LEA
Actual Footage Location of Well: 660 feet from the SOUTH line and 990 feet from the WEST line					
Ground Level Elev. 3959.0'	Producing Formation Wolfcamp	Pool South Corbin Wolfcamp			Dedicated Acreage: 80 Acres

- Outline the acreage dedicated to the subject well by colored pencil or hatchure marks on the plat below.
- If more than one lease is dedicated to the well, outline each and identify the ownership thereof (both as to working interest and royalty).
- If more than one lease of different ownership is dedicated to the well, have the interest of all owners been consolidated by communitization, unitization, force-pooling, etc.?
☐ Yes ☒ No If answer is "yes" type of consolidation _____
If answer is "no" list of owners and tract descriptions which have actually been consolidated. (Use reverse side of this form necessary.)
No allowable will be assigned to the well unit all interests have been consolidated (by communitization, unitization, forced-pooling, otherwise) or until a non-standard unit, eliminating such interest, has been approved by the Division.

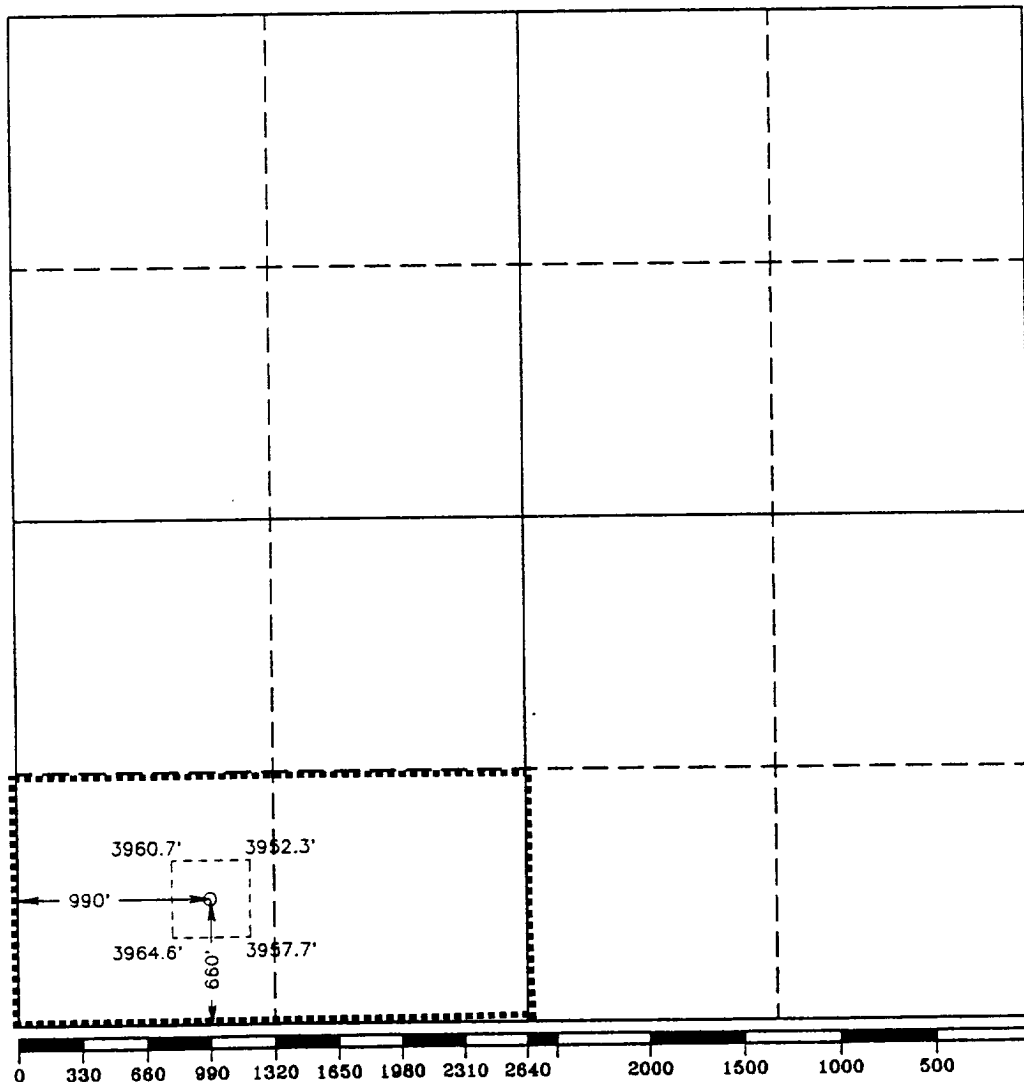

OPERATOR CERTIFICATION

I hereby certify the the information contained herein is true and complete to the best of my knowledge and belief.

Signature
Darrell Roberts
Printed Name
Darrell Roberts
Position
Sr. Drilling Engineer
Company Santa Fe Energy
Operating Partners, L.P.
Date
March 8, 1993

SURVEYOR CERTIFICATION

I hereby certify that the well location shown on this plat was plotted from field notes of actual surveys made by me or under my supervision, and that the same is true and correct to the best of my knowledge and belief.

Date Surveyed
MARCH 1, 1993

Signature & Seal of
Professional Surveyor

GARY L. JONES
NEW MEXICO
7977
JOHN W. WEST. 676
RONALD J. JOHNSON. 3239
GARY L. JONES. 7977
93-11-0338

RECEIVED

JUN 17 1993

GOD HOBBS
OFFICE

DRILLING PROGRAM
SANTA FE ENERGY OPERATING PARTNERS, L.P.
Kachina "5" Federal No. 5

In conjunction with Form 3160-3, Application to Drill the subject well, Santa Fe Energy Operating Partners, L.P., submits the following ten items of pertinent information in accordance with Onshore Oil & Gas Order No. 10.

1. **Geologic Name of Surface Formation:** Alluvium

2. **Estimated Tops of Significant Geologic Markers:**

Rustler Anhydrite	1,450'
Base of Salt	2,880'
Yates	3,120'
Seven Rivers	3,370'
Queen	4,200'
Penrose	4,550'
Delaware	5,590'
Bone Spring	6,510'
First Bone Spring Sand	8,240'
First Carbonate	8,490'
2nd Carbonate	9,340'
3rd Sand	9,550'
Wolfcamp	9,880'
Lower Wolfcamp	10,810'
Pennsylvanian Shale	11,440'
Total Depth	11,500'

3. **The estimated depths at which water, oil, or gas formations are expected:**

Water	None expected in area
Oil	Lower Wolfcamp Carbonate @ 11,000'
Oil	Lower Wolfcamp Carbonate @ 11,200'

4. **Proposed Casing Program:** See Form 3160-3 and Exhibit A.

5. **Pressure Control Equipment:** See Form 3160-3 and Exhibit B.

6. **Drilling Fluid Program:** See Exhibit C.

7. **Auxiliary Equipment:** A mud logging unit will be utilized to monitor penetration rate and hydrocarbon shows while drilling below the Delaware at 5500'.

RECEIVED

JUN 17 1993

OOD HOBBS
OFFICE

PROPOSED 3-M BOPE AND CHOKE ARRANGEMENT

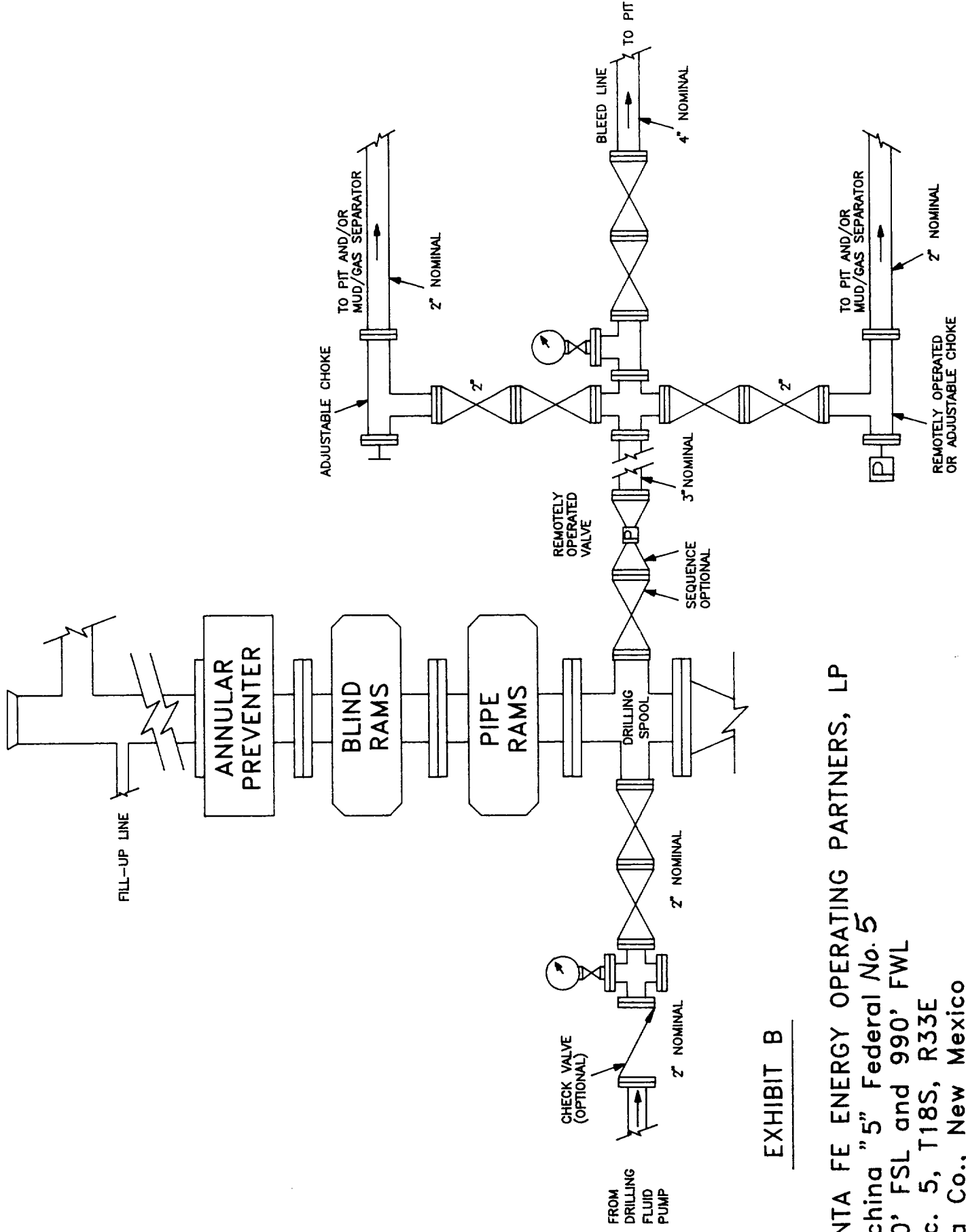

EXHIBIT B

SANTA FE ENERGY OPERATING PARTNERS, LP
 Kachina "5" Federal No. 5
 660' FSL and 990' FWL
 Sec. 5, T18S, R33E
 Lea Co., New Mexico

RECEIVED

JUN 17 1993

GOD HOBBS
OFFICE