

State of New Mexico
Encl. Minerals and Natural Resources Department

OIL CONSERVATION DIVISION
P.O. Box 2088
Santa Fe, New Mexico 87504-2088

Submit to Appropriate
District Office
State Lease - 6 copies
Fee Lease - 5 copies

DISTRICT I
P.O. Box 1980, Hobbs, NM 88240

DISTRICT II
P.O. Drawer DD, Artesia, NM 88210

DISTRICT III
1000 Rio Brazos Rd., Aztec, NM 87410

API NO. (assigned by OCD on New Wells)
32 025 32234

5. Indicate Type of Lease
STATE ☐ FEE ☒

6. State Oil & Gas Lease No.

7. Lease Name or Unit Agreement Name

Santa Fe Exploration

8. Well No.

#2

9. Pool Name or Wildcat

South Corbin Wolfcamp

APPLICATION FOR PERMIT TO DRILL, DEEPEN, OR PLUG BACK

1a. Type of Work:

DRILL ☒

RE-ENTER ☐

DEEPEN ☐

PLUG BACK ☐

b. Type of Well:

OIL WELL ☒

GAS WELL ☐

OTHER ☐

SINGLE ZONE ☐

MULTIPLE ZONE ☐

2. Name of Operator

Harvey E. Yates Company

3. Address of Operator

P.O. Box 1933, Roswell, N.M. 88202 (505) 623-6601

4. Well Location
Unit Letter I : 1980

Feet From The South

Line and 660

Feet From The East

Line

Section 6

Township

18S

Range

33E

NMPM

Lea

County

10. Proposed Depth

11,500

11. Formation

Wolfcamp

12. Rotary or C.T.

Rotary

14. Kind & Status Plug. Bond

\$50,000

15. Drilling Contractor

TBA

16. Approx. Date Work will start

ASAP

13. Elevations (Show whether DF, RT, GR, etc.)

3964.5 GL

PROPOSED CASING AND CEMENT PROGRAM

17. SIZE OF HOLE	SIZE OF CASING	WEIGHT PER FOOT	SETTING DEPTH	SACKS OF CEMENT	EST. TOP
17 1/2"	13 3/8"	54.5	400	400	surface
12 1/4"	8 5/8"	32	3100	1100	surface
7 7/8"	5 1/2"	17	11500	600	600' above pay

IN ABOVE SPACE DESCRIBE PROPOSED PROGRAM: IF PROPOSAL IS TO DEEPEN OR PLUG BACK, GIVE DATA ON PRESENT PRODUCTIVE ZONE AND PROPOSED NEW PRODUCTIVE ZONE. GIVE BLOWOUT PREVENTER PROGRAM, IF ANY.

I hereby certify that the information above is true and complete to the best of my knowledge and belief.

SIGNATURE

[Signature]

N.M. Young

Drlg Superintendent

DATE 9/13/93

TELEPHONE NO.

TYPE OR PRINT NAME

N.M. Young

(This space for State Use)

ORIGINAL SIGNED BY JERRY SEXTON
DISTRICT I SUPERVISOR

TITLE

DATE

APPROVED BY

CONDITIONS OF APPROVAL, IF ANY:

SEP 16 1993

OIL CONSERVATION DIVISION

P.O. Box 2088
Santa Fe, New Mexico 87504-2088

DISTRICT I

P.O. Box 1980, Hobbs, NM 88240

DISTRICT II

P.O. Drawer DD, Artesia, NM 88210

DISTRICT III

1000 Rio Brazos Rd., Aztec, NM 87410

WELL LOCATION AND ACREAGE DEDICATION PLAT

All Distances must be from the outer boundaries of the section

Operator HARVEY E. YATES CO.			Lease SANTA FE EXPLORATION		Well No. 2
Unit Letter 1	Section 6	Township 18 SOUTH	Range 33 EAST	County LEA	
Actual Footage Location of Well: 1980 feet from the SOUTH line and 660 feet from the EAST line					
Ground Level Elev. 3964.5'	Producing Formation Wolfcamp		Pool South Corbin	Dedicated Acreage: 80 Acres	

1. Outline the acreage dedicated to the subject well by colored pencil or hatchure marks on the plat below.
2. If more than one lease is dedicated to the well, outline each and identify the ownership thereof (both as to working interest and royalty).
3. If more than one lease of different ownership is dedicated to the well, have the interest of all owners been consolidated by communitization, unitization, force-pooling, etc.?
☐ Yes ☐ No If answer is "yes" type of consolidation _____

If answer is "no" list of owners and tract descriptions which have actually been consolidated. (Use reverse side of this form necessary.)

No allowable will be assigned to the well unit all interests have been consolidated (by communitization, unitization, forced-pooling, otherwise) or until a non-standard unit, eliminating such interest, has been approved by the Division.

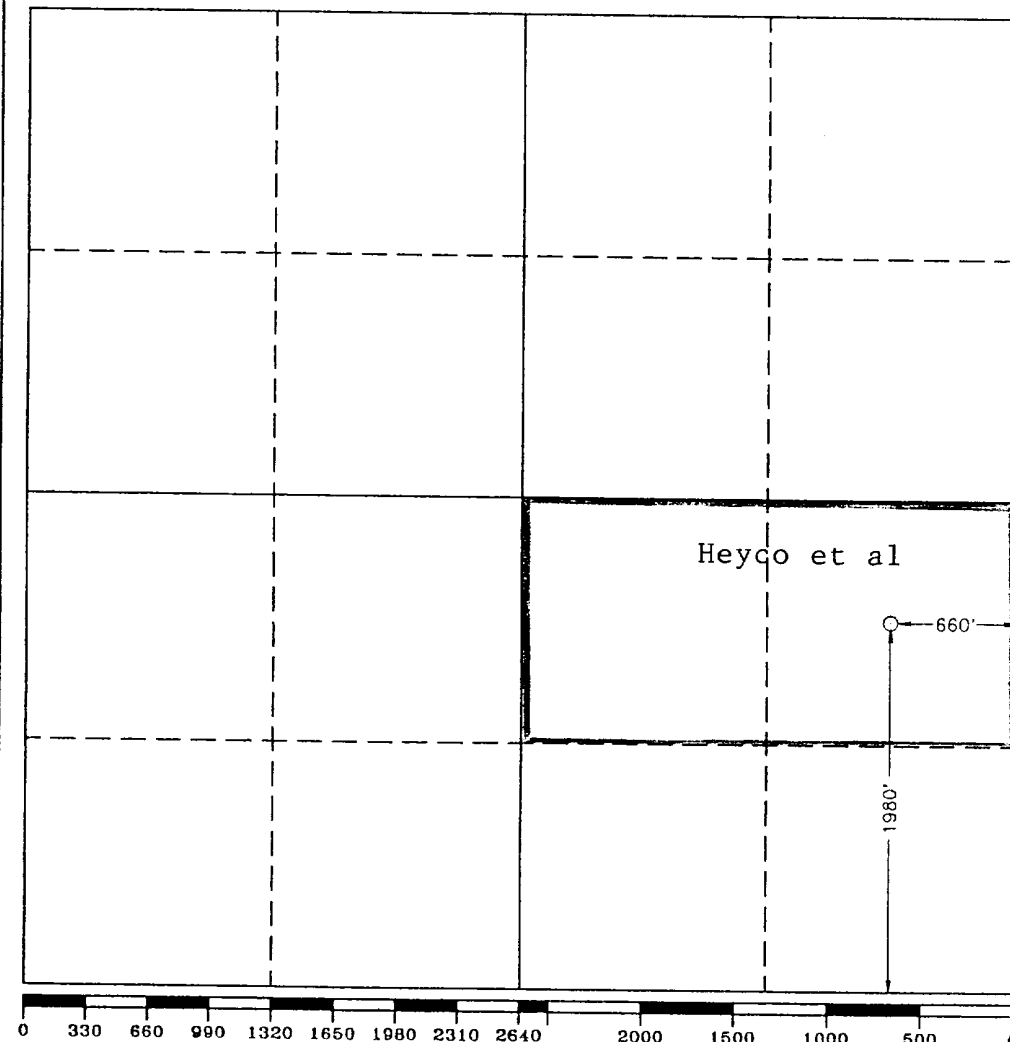

OPERATOR CERTIFICATION

I hereby certify the the information contained herein is true and complete to the best of my knowledge and belief.

Signature

Printed Name

N.M. Young

Position

Drilling Superintendent

Company

Harvey E. Yates Co.

Date

September 15, 1993

SURVEYOR CERTIFICATION

I hereby certify that the well location shown on this plat was plotted from field notes of actual surveys made by me or under my supervision, and that the same is true and correct to the best of my knowledge and belief.

Date Surveyed

SEPTEMBER 14, 1993

Signature & Seal of
Professional Surveyor

GARY L. JONES
NEW MEXICO
7977
Certificate No. JOHN W. WEST 676
RONALD L. BROWN 3239
PROFESSIONAL SURVEYOR JONES 7977
93-11-1759

Harvey E. Yates Company

Santa Fe Exploration #2
1980' FSL & 660' FEL
Sec. 6, T18S, R33E
Lea County, New Mexico

900 Series

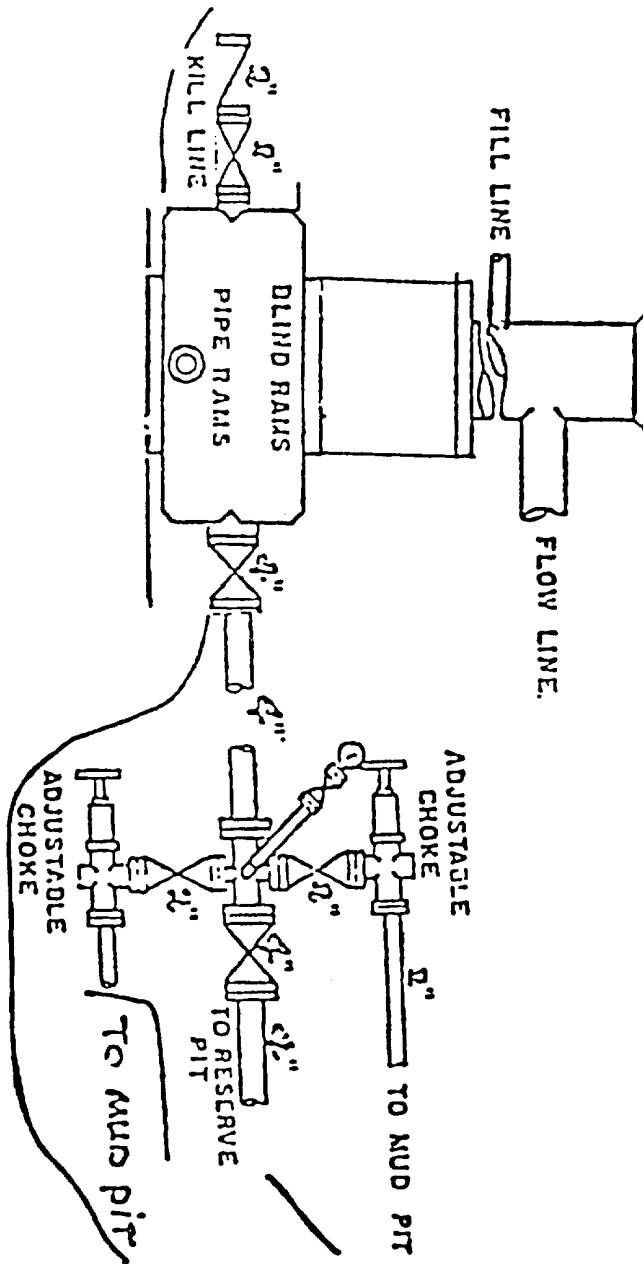

RECEIVED

1. *Pharmaceutical industry* – The pharmaceutical industry is the largest of the three industries, with sales of \$10.5 billion in 1997. It is the only industry that has a significant presence in all three markets.

Journal of Management Education 30(6)p. 789-804
© The Author(s) 2006

VICINITY MAP

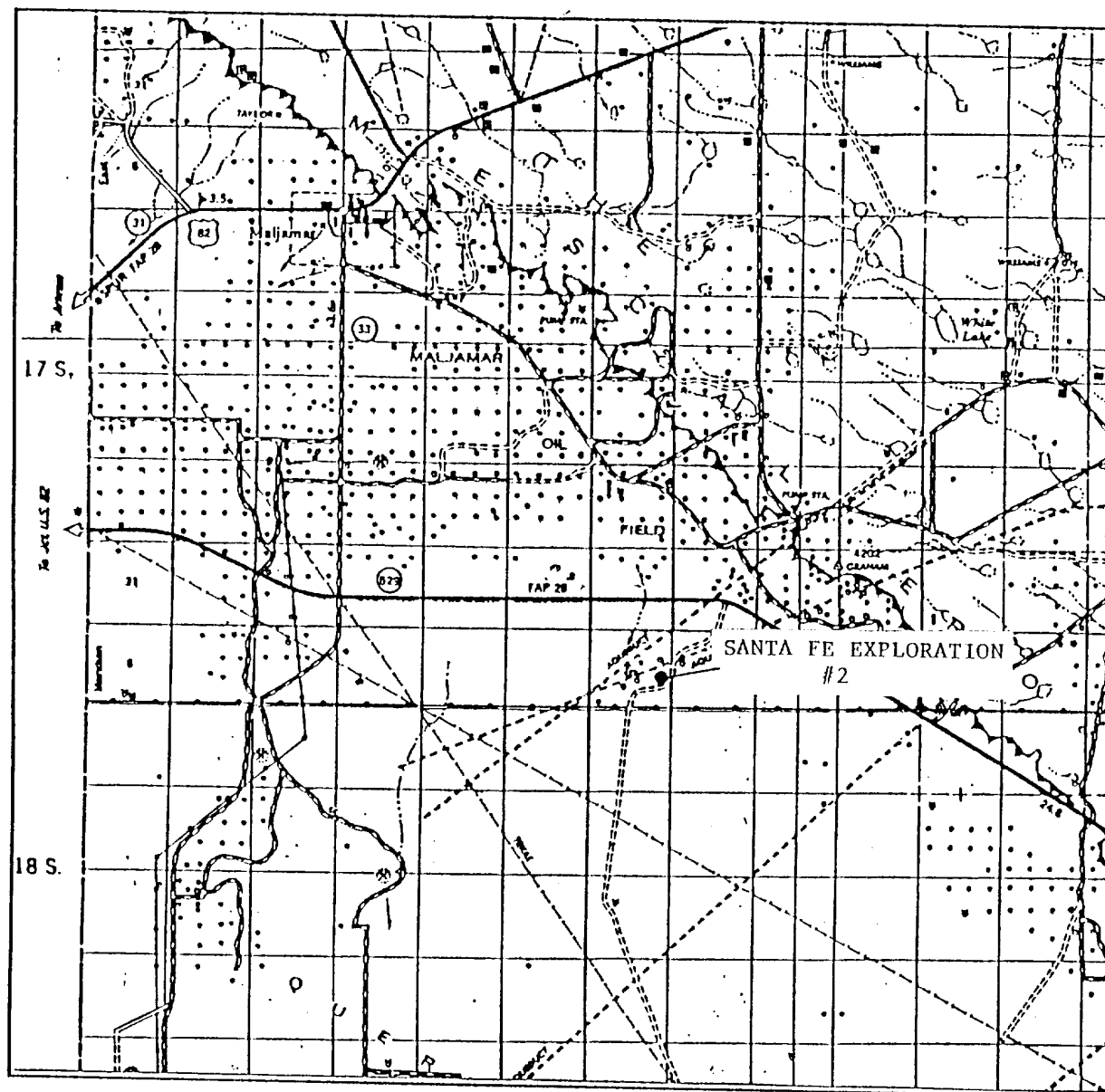

SCALE: 1" = 2 MILES

SEC. 6 TWP. 18S RGE. 33E
SURVEY N.M.P.M.
COUNTY LEA STATE N.M.
DESCRIPTION 1980' FSL & 660' FEL
ELEVATION 3964.5'
OPERATOR HARVEY E. YATES CO.
LEASE SANTA FE EXPLORATION #2

JOHN WEST ENGINEERING
HOBBS, NEW MEXICO
(505) 393-3117

39129121