

Form C-102  
Revised 1-1-88

**All Distances must be from the outer boundaries of the section**

Operator SANTA FE ENERGY RESOURCES, INC.		Lease KACHINA 5 FEDERAL		Well No. 7
Unit Letter E	Section 5	Township 18 SOUTH	Range 33 EAST NMPM	County LEA
Actual Footage Location of Well:				
2130 feet from the NORTH line and		990 feet from the WEST line		
Ground Level Elev. 3988.7'	Producing Formation Bone Spring	Pool Corbin (Bone Spring)		Dedicated Acreage: 40 Acres

1. Outline the acreage dedicated to the subject well by colored pencil or hachure marks on the plat below.
2. If more than one lease is dedicated to the well, outline each and identify the ownership thereof (both as to working interest and royalty).
3. If more than one lease of different ownership is dedicated to the well, have the interest of all owners been consolidated by communitization, unitization, force-pooling, etc.?

☐ Yes ☒ No If answer is "yes" type of consolidation

If answer is "no" list of owners and tract descriptions which have actually been consolidated. (Use reverse side of this form necessary.

No allowable will be assigned to the well unit all interests have been consolidated (by communitization, unitization, forced-pooling, otherwise) or until a non-standard unit, eliminating such interest, has been approved by the Division.

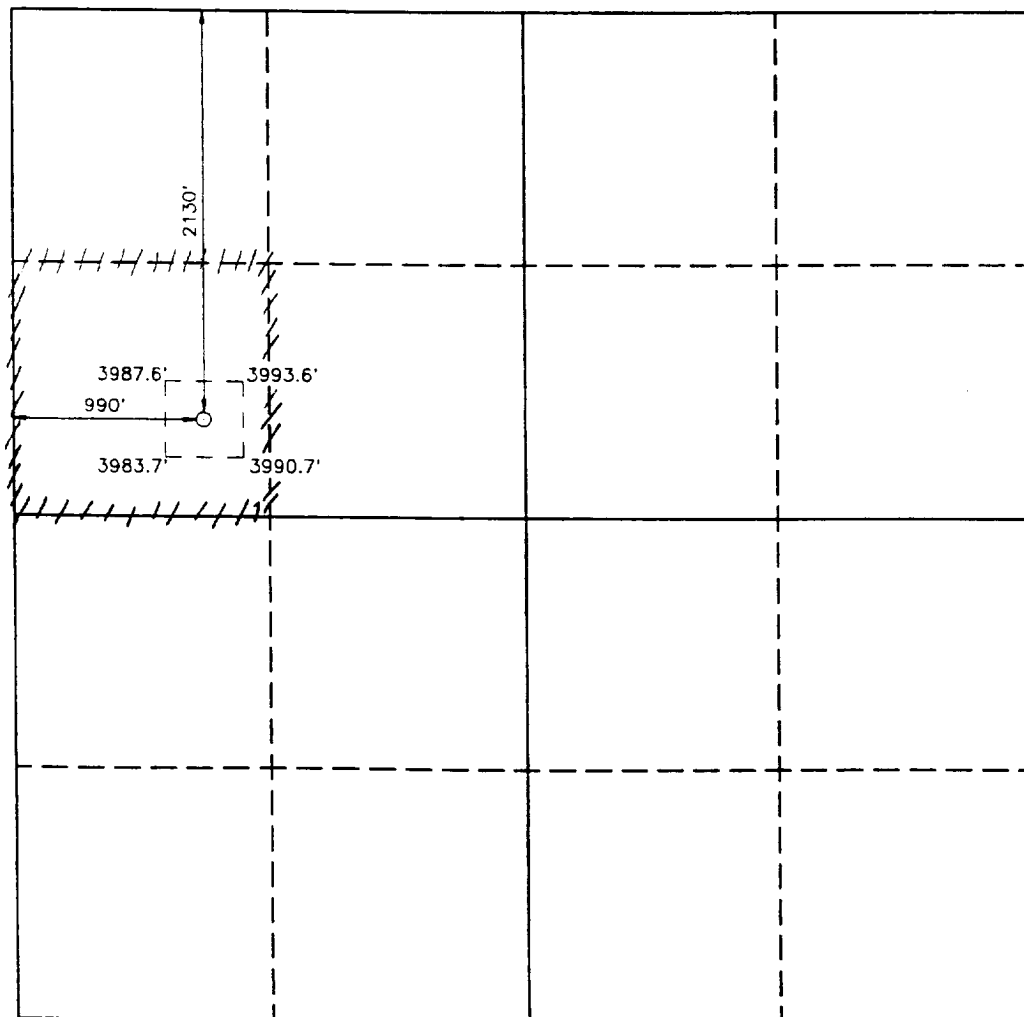

### OPERATOR CERTIFICATION

I hereby certify the the information  
contained herein is true and complete to the  
best of my knowledge and belief.

**Signature**

Printed Name  
Terry McCullough

Position

Sr. Production Clerk

Company	Revenue	Profit	Assets	Liabilities	Equity
ABC Company	100	20	120	80	40
DEF Company	150	30	180	120	60
GHI Company	200	40	240	160	80
JKL Company	250	50	300	200	100
MNO Company	300	60	360	240	120
PQR Company	350	70	420	280	140
STU Company	400	80	480	320	160
VWX Company	450	90	540	360	180
YZA Company	500	100	600	400	200

Santa Fe Energy Resources

Date \_\_\_\_\_

March 16, 1995

### SURVEYOR CERTIFICATION

I hereby certify that the well location shown on this plat was plotted from field notes of actual surveys made by me or under my supervision, and that the same is true and correct to the best of my knowledge and belief.

Date Surveyed

NOVEMBER 24, 1993

**Signature & Seal of  
Professional Surveyor**

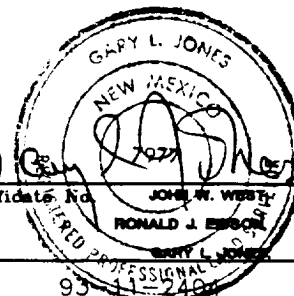

Certificate No.	JOHN W. WEST	676
-----------------	--------------	-----

RECEIVED  
JAN 10 1977