

UNITED STATES
DEPARTMENT OF THE INTERIOR
BUREAU OF LAND MANAGEMENTSUBMIT IN DUPLICATE*
(Other instructions on
reverse side)FORM APPROVED
OMB NO. 1004-0136
Expires: February 28, 1995

APPLICATION FOR PERMIT TO DRILL OR DEEPEN

1a. TYPE OF WORK

DRILL ☒DEEPEN ☐

b. TYPE OF WELL

OIL
WELL ☒GAS
WELL ☐OTHER ☐SINGLE
ZONE ☒MULTIPLE
ZONE ☐

2. NAME OF OPERATOR

OXY USA Inc.

16696

3. ADDRESS AND TELEPHONE NO.

P.O. Box 50250 Midland, TX 79710-0250

915-685-5717

4. LOCATION OF WELL (Report location clearly and in accordance with any State requirements.*)
At surface

660 FNL 1980 FNL NWNE (B)

At proposed prod. zone

14. DISTANCE IN MILES AND DIRECTION FROM NEAREST TOWN OR POST OFFICE*

8 miles Southeast from Maljamar, NM

15. DISTANCE FROM PROPOSED*

LOCATION TO NEAREST
PROPERTY OR LEASE LINE, FT.
(Also to nearest drlg. unit line, if any)

660'

16. NO. OF ACRES IN LEASE

1561

17. NO. OF ACRES ASSIGNED
TO THIS WELL

40

18. DISTANCE FROM PROPOSED LOCATION*
TO NEAREST WELL, DRILLING, COMPLETED,
OR APPLIED FOR, ON THIS LEASE, FT.

1320'

19. PROPOSED DEPTH

4250'

20. ROTARY OR CABLE TOOLS

Rotary

21. ELEVATIONS (Show whether DF, RT, GR, etc.)

4034'

22. APPROX. DATE WORK WILL START*

12/15/95

23.

PROPOSED CASING AND CEMENTING PROGRAM

Capitan Controlled Water Basin

SIZE OF HOLE	GRADE, SIZE OF CASING	WEIGHT PER FOOT	SETTING DEPTH	QUANTITY OF CEMENT
12-1/4"	8-5/8" K55	24#	400'	300sx - Circulate to surface
7-7/8"	5-1/2" K55	15.5#	4250'	1400sx - " " "

It is proposed to drill this well to a TD of 4250' and complete in the Queen formation.

The Blowout Prevention Program is as follows:

- 1) One set of Drill Pipe Rams (3M).
- 2) One set of Blind Rams (3M).
- 3) One Hydrill (3M).

Approval Subject to
General Requirements and
Special stipulations
Attached

IN ABOVE SPACE DESCRIBE PROPOSED PROGRAM: If proposal is to deepen, give data on present productive zone and proposed new productive zone. If proposal is to drill or deepen directionally, give pertinent data on subsurface locations and measured and true vertical depths. Give blowout preventer program, if any.

24.

SIGNED

TITLE

David Stewart

Regulatory Analyst

DATE

10/27/95

(This space for Federal or State office use)

PERMIT NO.

APPROVAL DATE

Application approval does not warrant or certify that the applicant holds legal or equitable title to those rights in the subject lease which would entitle the applicant to conduct operations thereon
CONDITIONS OF APPROVAL, IF ANY:

FOR RECORD ONLY

APPROVED BY

TITLE

APPROVED

DATE

JAN 11 1996

*See Instructions On Reverse Side

Submit to Appropriate
District Office
State Lease - 4 copies
Fee Lease - 3 copies

State of New Mexico
Energy, Minerals and Natural Resources Department

Form C-102
Revised 1-1-89

OIL CONSERVATION DIVISION

P.O. Box 2088
Santa Fe, New Mexico 87504-2088

DISTRICT I

P.O. Box 1980, Hobbs, NM 88240

DISTRICT II

P.O. Drawer DD, Artesia, NM 88210

DISTRICT III

1900 Rio Branson Rd., Aztec, NM 87410

WELL LOCATION AND ACREAGE DEDICATION PLAT

All Distances must be from the outer boundaries of the section

30-025-32608

Operator OXY U.S.A. INC. 16696		Lease 008587 CENTRAL CORBIN QUEEN UNIT		Well No. 216
Unit Letter Lot 2	Section 4	Township 18 SOUTH	Range 33 EAST NMPM	County LEA
Actual Footage Location of Well: 660 feet from the NORTH line and 1980 feet from the EAST line				
Ground Level Elev. 4034'	Producing Formation Queen	Pool 013285 Central Corbin Queen	Dedicated Acreage: 40 Acres	

- Outline the acreage dedicated to the subject well by colored pencil or hatchure marks on the plat below.
 - If more than one lease is dedicated to the well, outline each and identify the ownership thereof (both as to working interest and royalty).
 - If more than one lease of different ownership is dedicated to the well, have the interest of all owners been consolidated by communitization, unitization, force-pooling, etc.?
☐ Yes ☐ No If answer is "yes" type of consolidation _____
- If answer is "no" list of owners and tract descriptions which have actually been consolidated. (Use reverse side of this form necessary.)
- No allowable will be assigned to the well unit all interests have been consolidated (by communitization, unitization, force-pooling, otherwise) or until a non-standard unit, eliminating such interest, has been approved by the Division.

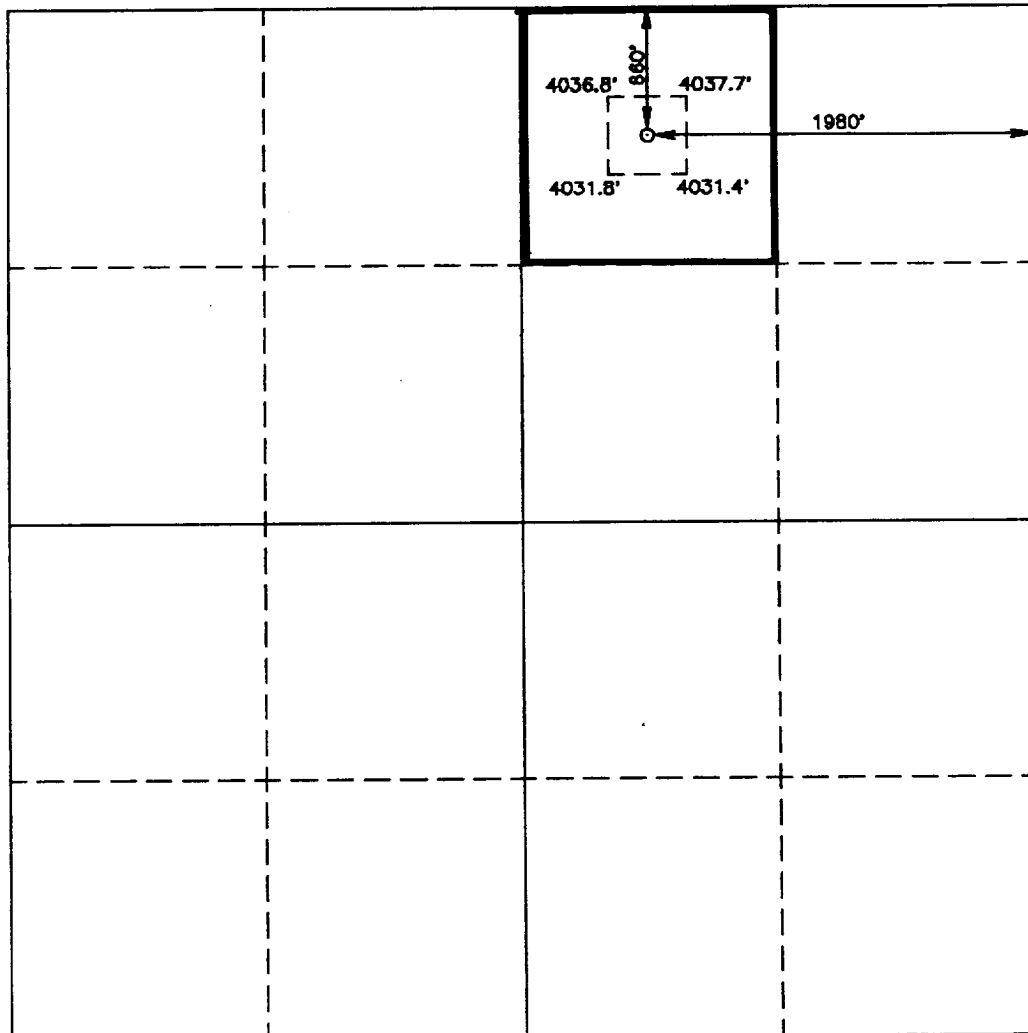

OPERATOR CERTIFICATION

I hereby certify the the information contained herein is true and complete to the best of my knowledge and belief.

Signature
Printed Name
David Stewart
Position
Regulatory Analyst
Company
OXY USA Inc.
Date
10/27/95

SURVEYOR CERTIFICATION

I hereby certify that the well location shown on this plat was plotted from field notes of actual surveys made by me or under my supervision, and that the same is true and correct to the best of my knowledge and belief.

Date Surveyed
JANUARY 25, 1994
Signature of Seal of Professional Surveyor
7977
Certificate No. JOHN W. WEST, 676
RONALD J. EIDSON, 3239
GARY L. JONES, 7977

94-11-0165



OXY USA INC.

Box 50250, Midland, TX 79710

October 27, 1995

United States Department of the Interior
Bureau of Land Management
Carlsbad Resource Area
P.O. Drawer 1778
Carlsbad, New Mexico 88220

Re: Application for Permit to Drill
OXY USA Inc.
Central Corbin Queen Unit #216
API No. 30-025-32608
Lea County, New Mexico
Lease No. LC-029489(b) - Unit No. NMNM84603X

RECEIVED
OCT 30 11 00 AM '95
BUREAU OF LAND MANAGEMENT
CARLSBAD, NEW MEXICO

Gentlemen:

OXY USA Inc. respectfully resubmits our request for permission to drill our Central Corbin Queen Unit #216 located 660 FNL and 1980 FEL of Section 4, T18S, R33E, Lea County, New Mexico, Federal Lease No. LC029489(b). This APD was previously approved 7/22/94. The location, work area and access road have been staked and built. It is approximately 8 miles Southeast of Maljamar, New Mexico.

In accordance with requirements stipulated in Federal Onshore Oil and Gas Order No. 1 under 43 CFR 3162.1, our Application for Permission to Drill and supporting evidence is hereby submitted.

I. Application for Permit to Drill:

1. Form 3160.3, Application for Permit to Drill.
2. Form C-102 Location and Acreage Dedication Plat certified by Gary L. Jones, Registered Land Surveyor No. 7977 in the State of New Mexico, dated January 25, 1994.
3. The elevation of the unprepared ground is 4034 feet above sea level.
4. The geologic name of the surface formation is Tertiary Ogallala.
5. Rotary drilling equipment will be utilized to drill the well to TD 4250' (TVD) and run casing. This equipment will then be rigged down and the well will be completed with a pulling unit.

6. Proposed total depth is 4250' TVD.

7. Estimated tops of important geologic markers.

Anhrdrite	1450' TVD
Yates	2915' TVD
Seven Rivers	3350' TVD
Queen	4120' TVD

8. Estimated depths at which anticipated water, oil, gas or other mineral bearing formations are expected to be encountered:

Primary Objective: Queen 4120' TVD

9. The proposed casing program is as follows:

Surface: 8-5/8" OD 24# K55 ST&C new casing

Production: 5-1/2" OD 15.5# K-55 LT&C new casing

10. Casing setting depth and cementing program:

A. 8-5/8" surface casing set at 400' in 12-1/4" hole. Circulate cement with 300sx Class C with 2% CaCl₂.

If cement does not circulate, a temperature survey will be run to find the TOC and then finish cementing to surface through 1" using Class C with 2% CaCl₂.

C. 5-1/2" production casing set at 4250' in 7-7/8" hole. Circulate cement with 1200sx Class C Light cement with 15#/sx salt + 0.25#/sx cellophane flakes followed by 200sx Class C with 2% CaCl₂.

Note: Cement volumes may need to be adjusted to hole caliper.

11. Pressure Control Equipment

0' - 400' None

400' - 4250' 10" 3000# ram type preventers with one set blind rams and one set pipe rams and a remote operating station. Exhibit A.

A kelly cock will be installed and maintained in operable condition and a drill string safety valve in the open position will be available on the rig floor.

After setting the 8-5/8" casing, the blowout preventers and related control equipment shall be pressure tested to rated working pressures. Any equipment failing to test satisfactorily shall be repaired or replaced. The results of the BOP test will be recorded in the Driller's Log. The BOP's will be maintained ready for use until drilling operations are completed.

BOP drills will be conducted as necessary to assure that equipment is operational and each crew is properly trained to carry out emergency duties.

Accumulator shall maintain a pressure capacity reserve at all times to provide for the close-open-close sequence of the blind and pipe rams of the hydraulic preventers.

12. Mud Program:

0' - 400'	Fresh water spud mud. Lime for pH control (9 to 10). Paper for seepage. Vis 34-36 sec.
400' - 4000'	Brine water. Wt. 10-10.2 ppg, vis 26-28 sec, Lime for pH control (9.5-10). Paper for seepage.
4000' - 4250'	Mud up with salt gel system using gel for viscosity, starch for water loss, and caustic soda/soda ash for pH control to the following characteristics: Wt. 10.1-10.3 ppg - pH 10-10.5 WL - Vis 35-40 sec - WL 10cc or less.

13. Testing, Logging and Coring Program:

- A. Testing program: None planned.
- B. Mud logging program: None planned.
- C. Electric logging program: CNL-LDT-GR DLL-MSFL-CAL-GR
- D. Coring program: 1-60 ' core in the Queen.

14. No abnormal temperatures, pressures or H₂S gas are anticipated. Estimate BHP at TD 500#.

15. Anticipated starting date is December 15, 1995. It should take approximately 5 days to drill the well and another 7-10 days to complete.

16. The Multi-Point Surface Use & Operation Plan is attached.
17. If the Bureau of Land Management needs additional information to evaluate this application, please advise.

Very truly yours,

A handwritten signature in black ink, appearing to read 'David Stewart', with a stylized flourish at the end.

David Stewart
Regulatory Analyst
OXY USA Inc.

DRS/drs

Attachments

EXHIBIT A

