

OPER. OGRID NO. 5382 **ON**PROPERTY NO. 3372

DATE

140

FORM APPROVED
OMB NO. 1004-0136
Expires: February 28, 1995UNIT
DEPARTMENT
BUREAU OFPOOL CODE 43329EFF. DATE 12/11/95API NO. 30-025-33220

APPLICATION FOR P.

1a. TYPE OF WORK

DRILL ☒DEEPEN ☐

b. TYPE OF WELL

OIL
WELL ☒GAS
WELL ☐

OTHER

SINGLE
ZONE ☒MULTIPLE
ZONE ☐

2. NAME OF OPERATOR

Cross Timbers Operating Company

3. ADDRESS AND TELEPHONE NO.

P. O. Box 52070, Midland, Texas 79710-2070 (915)682-8873

4. LOCATION OF WELL (Report location clearly and in accordance with any State requirements.)*

At surface

380' FNL, 350' FWL, Sec 33, T17S, R33E, NMPM

At proposed prod. zone

Same

14. DISTANCE IN MILES AND DIRECTION FROM NEAREST TOWN OR POST OFFICE*

6 miles southeast of Maljamar, New Mexico

15. DISTANCE FROM PROPOSED*

LOCATION TO NEAREST

PROPERTY OR LEASE LINE, FT.

(Also to nearest drlg. unit line, if any)

350'

16. NO. OF ACRES IN LEASE

40

17. NO. OF ACRES ASSIGNED
TO THIS WELL

20 40

18. DISTANCE FROM PROPOSED LOCATION*

TO NEAREST WELL, DRILLING, COMPLETED,
OR APPLIED FOR, ON THIS LEASE, FT.

610'

19. PROPOSED DEPTH

4,500'

20. ROTARY OR CABLE TOOLS

Rotary

21. ELEVATIONS (Show whether DF, RT, GR, etc.)

4,078' GL

Lea County Controlled Water Basin

22. APPROX. DATE WORK WILL START*

10/1/95

23.

PROPOSED CASING AND CEMENTING PROGRAM

SIZE OF HOLE	GRADE SIZE OF CASING	WEIGHT PER FOOT	SETTING DEPTH	QUANTITY OF CEMENT
12-1/4"	8-5/8" J-55	24#	350' 400'	250sx CIRCULATE
7-7/8"	5-1/2" J-55	15.5#	4,500'	975sx

1. Drill 12-1/4" hole & set 8-5/8" surface csg. Circ cmt to surface.

2. NU BOP. Log BOP checks in IADC report & drill 7-7/8" hole to 4,500'.

3. Set 5-1/2" csg at TD. Circ cmt to surface.

4. Run cased hole log. Perforate & stimulate as needed.

EXHIBITS ATTACHED:

Exhibit "A" - Location & Elevation Plat

Exhibit "B" - Ten-Point Compliance Program

Exhibit "C" - Pressure Control Equipment

Exhibit "D" - Surface Use Plan

Exhibit "E" - Existing & Planned Access Roads

Exhibit "F" - Location of Existing Wells

Exhibit "G" - Proposed Well Site Layout

Exhibit "H", "H1" & "H2" - Drill Pad Layout w/Elevations (Cut & fill diagrams)

Exhibit "I" - Surface Owner Damage Agreement

Subject to
State Requirements and
Special Stipulations
Attached

IN ABOVE SPACE DESCRIBE PROPOSED PROGRAM: If proposal is to deepen, give data on present productive zone and proposed new productive zone. If proposal is to drill or deepen directionally, give pertinent data on subsurface locations and measured and true vertical depths. Give blowout preventer program, if any.

24.

SIGNED

George E. Ramsey, Jr.

TITLE

Drilling Engineer

DATE

8/17/95

(This space for Federal or State office use)

PERMIT NO.

APPROVAL DATE

Application approval does not warrant or certify that the applicant holds legal or equitable title to those rights in the subject lease which would entitle the applicant to conduct operations thereon.
CONDITIONS OF APPROVAL, IF ANY:

APPROVED BY

S/ Joe G. Kara

TITLE

Acting

DATE

DEC 00 1995

*See Instructions On Reverse Side

Submit to Appropriate
District Office
State Lease - 4 copies
Fee Lease - 3 copies

State of New Mexico
Energy, Minerals and Natural Resources Department

Form C-102
Revised 1-1-89

OIL CONSERVATION DIVISION

DISTRICT I
P.O. Box 1980, Hobbs, NM 88240

P.O. Box 2088

Santa Fe, New Mexico 87504-2088

DISTRICT II
P.O. Drawer DD, Artesia, NM 88210

DISTRICT III
1000 Rio Brazos Rd., Aztec, NM 87410

WELL LOCATION AND ACREAGE DEDICATION PLAT

All Distances must be from the outer boundaries of the section

Operator Cross Timbers Operating Company			Lease U. S. Minerals		Well No. 3
Unit Letter D	Section 33	Township 17 South	Range 33 East	County NMNM Lea	
Actual Footage Location of Well: 380 feet from the North line and 350 feet from the West line					
Ground level Elev. 4078.0	Producing Formation Grayburg - San Andres		Pool Maljamar	Dedicated Acreage: 40 Acres	

1. Outline the acreage dedicated to the subject well by colored pencil or hatchure marks on the plat below.
2. If more than one lease is dedicated to the well, outline each and identify the ownership thereof (both as to working interest and royalty).
3. If more than one lease of different ownership is dedicated to the well, have the interest of all owners been consolidated by communitization, unitization, force-pooling, etc.?
☐ Yes ☐ No If answer is "yes" type of consolidation _____
If answer is "no" list the owners and tract descriptions which have actually been consolidated. (Use reverse side of this form if necessary.) _____
No allowable will be assigned to the well until all interests have been consolidated (by communitization, unitization, forced-pooling, or otherwise) or until a non-standard unit, eliminating such interest, has been approved by the Division.

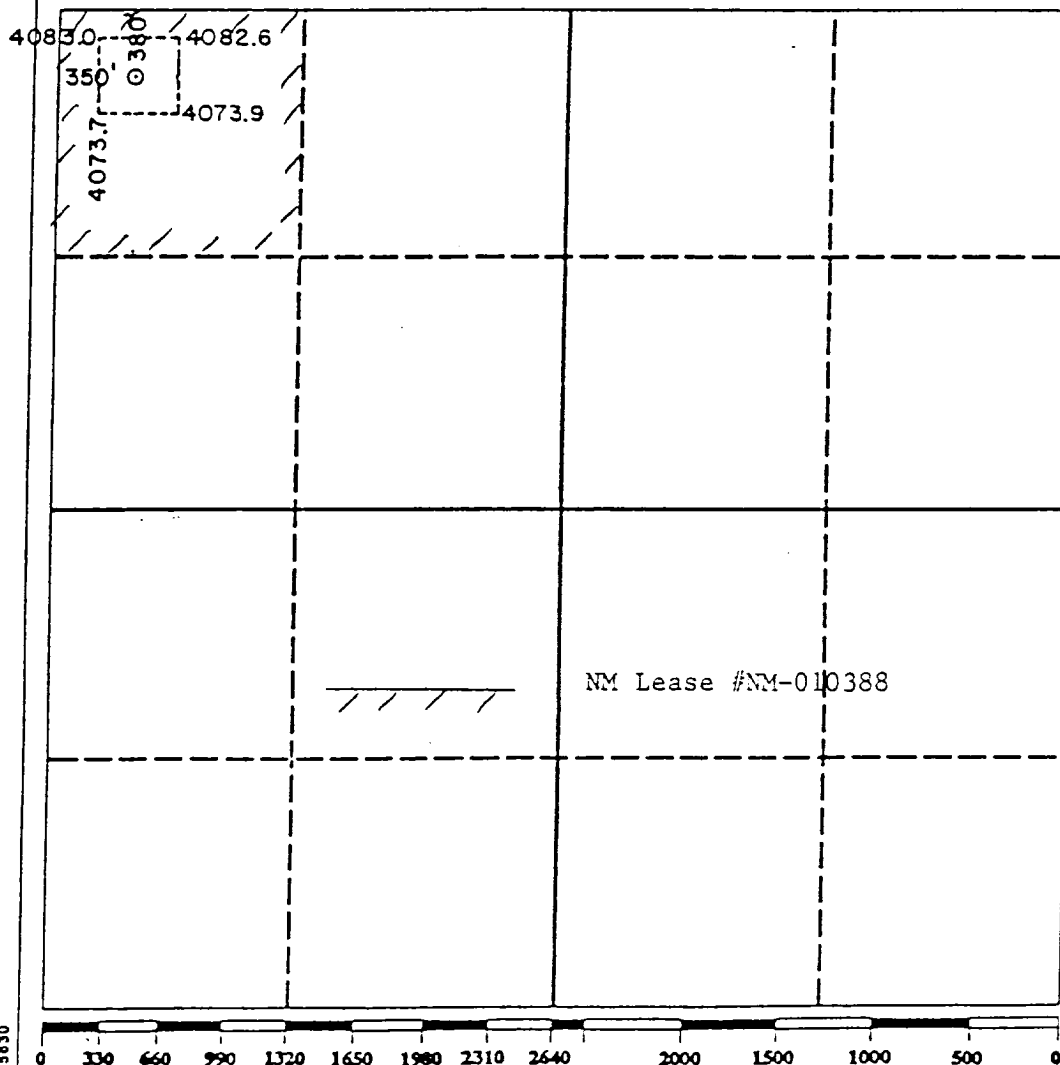

OPERATOR CERTIFICATION

I hereby certify that the information contained herein is true and complete to the best of my knowledge and belief.

Signature

Printed Name

George E. Ramsey Jr.

Position

Drilling Engineer

Company

Cross Timbers Operating Co.

Date

8/14/95

SURVEYOR CERTIFICATION

I hereby certify that the well location shown on this plat was plotted from field notes of actual surveys made by me or under my supervision, and that the same is true and correct to the best of my knowledge and belief.

Date Surveyed

June 19, 1992

Signature & Seal of
Professional Surveyor

Certificate No.

JOHN W. WEST

RONALD J. EICSON

92-11-08371

EXHIBIT "B"
APPLICATION FOR PERMIT TO DRILL
TEN-POINT COMPLIANCE PROGRAM
CROSS TIMBERS OPERATING COMPANY
U. S. MINERALS #3
380' FNL, 350' FWL
SEC 33 - T17S - R33E NMPM
LEA COUNTY, NEW MEXICO

In conjunction with Form 3160-3, Application for Permit to Drill, Cross Timbers Operating Company submits the following items of pertinent information in accordance with Onshore Oil and Gas Order No's 1 and 2, and with all other applicable Federal and State regulations.

1. The geologic surface formation is Quaternary Alluvium.
2. The estimated geologic markers are as follows:

Top of Salt	- 1491'	Queen	- 3521'
Base of Salt	- 2523'	Grayburg	- 3781'
Yates	- 2621'	Premier SS	- 4271'
Seven Rivers	- 3010'	San Andres	- 4363'

3. The estimated depths at which water, oil and/or gas are expected to be encountered:

Fresh Water:	None in the area.
Oil and /or Gas:	Grayburg - 3781' to 4271'
	Premier SS - 4271' to 4363'
	San Andres - 4363' to 4500'

4. Proposed Casing Program:

<u>Hole Size</u>	<u>Setting Depth</u>	<u>Size (OD)</u>	<u>Weight, Grade and Joint</u>	<u>New or Used</u>
12 1/4"	400' 350'	8 5/8"	24#, J55, STC	Used
7 7/8"	4500'	5 1/2"	15.5#, J55, STC	Used

Cement Program:

Surface Casing:	250 sx Premium Plus cement with 2% CaCl and 1/4 #/sx Flocele.
Production Casing:	Lead with 775 sx Premium Plus cement with 3% Econlite and 1/4 #/sx Flocele, Tail in with 200 sx Premium Plus cement with 0.2% Halad-322 and 0.4% Halad-9.

5. Pressure Control Equipment:

The BOPE will be a Shaffer type double gate preventer Series 900 - 3000# W.P. Exhibit "C" is a schematic diagram of the minimum blowout preventer stack that will be used. The BOP's will be hydraulically tested to half the working pressure after nipping up and after any use under pressure. Pipe rams will be operationally checked each 24 hour period, as will the blind rams each time pipe is pulled out of the hole. Such checks will be noted on the daily tour reports.

Accessories to the BOPE will include an upper kelly cock, floor safety valve, and choke manifold with pressure rating equivalent to the BOP stack.

6. Mud Program:

Surface: Fresh water native spud mud.

Production: Brine Envirodrill-NS.

	<u>Depth</u>	<u>Mud Weight</u>	<u>Viscosity</u>	<u>API Filtrate</u>
	0' - 300' 400'	8.4 - 8.8 ppg	32 - 36 sec	No Control
400'	300' - 4500'	10.0 - 10.1 ppg	28 - 30 sec	No Control

7. Auxiliary Equipment:

- An upper kelly cock valve will be used in the kelly.
- A safety valve will be on the floor at all times, to be stabbed into the drill string when the kelly is not in the string.
- H2S compliance package will be installed prior to drilling the Grayburg formation to monitor the system for H2S.

8. Testing, Logging, and Coring Program:

- No drill stem tests are anticipated.
- No open hole logs will be run, a cased hole CNL/Spectral GR will be run prior to completion.
- No coring is anticipated.

9. Anticipated Abnormal Pressure, Temperatures, or Other Hazards:

No abnormal pressures or temperatures have been noted or reported in wells drilled in the area to the anticipated depth of this well.

Anticipated Bottom Hole Pressure (BHP) = 1975 psi.

Hydrogen Sulfide is known to exist in formations at the depths the wellbore will penetrate, a H2S compliance package will be rigged up prior to drilling those formations.

10. Anticipated Starting Date and Duration of Operations:

The anticipated starting date will be as soon as possible after examination and approval of drilling requirements. Drilling operations should be completed within 10 days after spudding the well and drilling to TD.



Revised on 9/13/95 as per deficiency letter dated 8/29/95.

Revisions are in bold.

EXHIBIT "C" - PRESSURE CONTROL EQUIPMENT

BOPE SCHEMATIC FOR DRILLING OPERATIONS
CLASS 1 - NORMAL PRESSURE
CROSS TIMBERS OPERATING COMPANY STANDARD

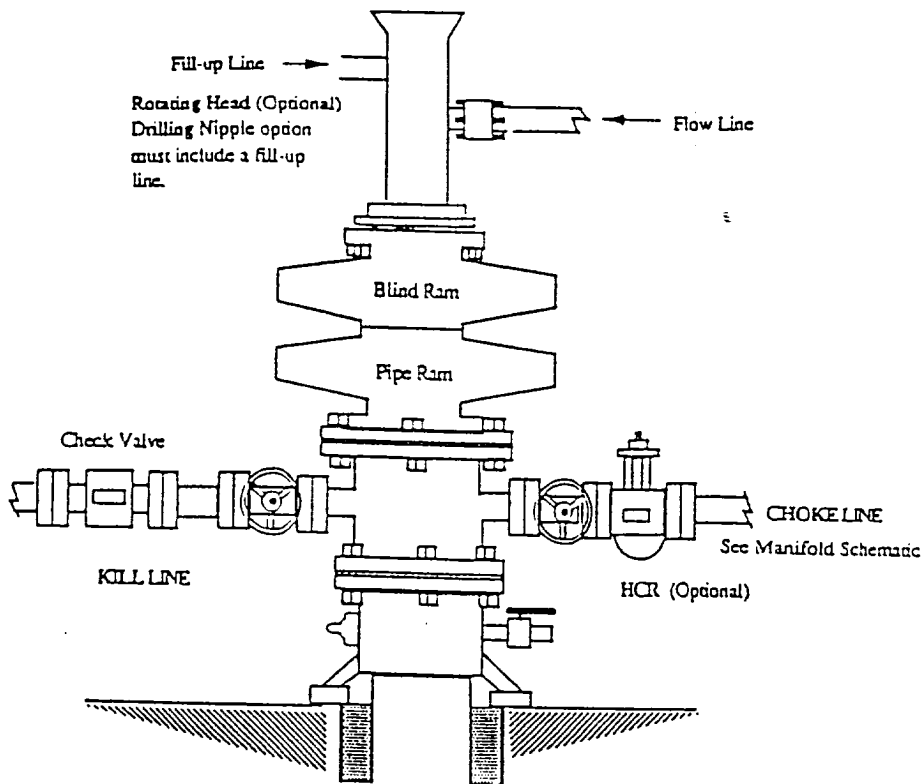

CHOKE MANIFOLD SCHEMATIC FOR DRILLING OPERATIONS
2M & 3M SERVICE
CROSS TIMBERS OPERATING COMPANY STANDARD

