

UNITED STATES
DEPARTMENT OF THE INTERIOR
BUREAU OF LAND MANAGEMENT

APPLICATION FOR PERMIT TO DRILL OR DEEPEN

1a. TYPE OF WORK

DRILL ☒

DEEPEN ☐

b. TYPE OF WELL

OIL
WELL ☒

GAS
WELL ☐

OTHER ☐

SINGLE
ZONE ☒

MULTIPLE
ZONE ☐

2. NAME OF OPERATOR

J. M. HUBER CORPORATION

3. ADDRESS AND TELEPHONE NO.

Ph. 713-871-4474
1900 WEST LOOP SOUTH SUITE 1600 HOUSTON, TEX. 77027

4. LOCATION OF WELL (Report location clearly and in accordance with any State requirements.)*

At surface
1980' FSL & 1980' FWL SEC. 26 T18S-R33E Lea CO. NEW MEXICO
At proposed prod. zone
Unit K
SAME

14. DISTANCE IN MILES AND DIRECTION FROM NEAREST TOWN OR POST OFFICE*

12 MILES SOUTHEAST OF MALJAMAR NEW MEXICO

15. DISTANCE FROM PROPOSED*

LOCATION TO NEAREST
PROPERTY OR LEASE LINE, FT.
(Also to nearest drlg. unit line, if any)

660'

18. DISTANCE FROM PROPOSED LOCATION*

TO NEAREST WELL, DRILLING, COMPLETED,
OR APPLIED FOR, ON THIS LEASE, FT.

1320'

16. NO. OF ACRES IN LEASE

560

19. PROPOSED DEPTH

4800

17. NO. OF ACRES ASSIGNED

TO THIS WELL

40

21. ELEVATIONS (Show whether DF, RT, GR, etc.)

GL. 3810

22. APPROX. DATE WORK WILL START*

As soon as approved

23.

PROPOSED CASING AND CEMENTING PROGRAM

SIZE OF HOLE	GRADE SIZE OF CASING	WEIGHT PER FOOT	SETTING DEPTH	QUANTITY OF CEMENT
12 1/2	K-55 8 5/8	24	350	220 Sx. Class "C" + Additives
7 7/8	K-55 4 1/2	10.5	4800	700 Sx Lite + 300 Sx. Class "C"

1. Drill 12 1/2" hole to 350'. Run and set 350' of 8 5/8" K-55 24# ST&C casing. Cement with 220 Sx. Class "C" cement + additives. Circulate cement to surface.

2. Drill 7 7/8" hole to 4800'. Run and set 4800' of 4 1/2" K-55 10.5# ST&C casing. Cement with 700 Sx. of Lite cement tail in with 300 Sx. Class "C" + additives. Circulate cement to surface.

Above volumes of cement will be confirmed by fluid caliper + 10% excess.

Approved Subject to
General Requirements and
Special Stipulations
Attached

OPER. OGRID NO. 11321

PROPERTY NO. 5297

POOL CODE 13290

EFF. DATE 6/2/97

API NO. 30-025-33993

IN ABOVE SPACE DESCRIBE PROPOSED PROGRAM: If proposal is to deepen, give data on present productive zone and proposed new productive zone. If proposal is to drill or deepen directionally, give pertinent data on subsurface locations and measured and true vertical depths. Give blowout preventer program, if any.

24.

SIGNED

Joe T. Garcia

TITLE

Agent

DATE

04/25/97

(This space for Federal or State office use)

PERMIT NO.

APPROVAL DATE

Application approval does not warrant or certify that the applicant holds legal or equitable title to those rights in the subject lease which would entitle the applicant to conduct operations thereon.
CONDITIONS OF APPROVAL, IF ANY:

APPROVED BY (ORIG. SGD) TONY L. FERGUSON

TITLE

ADM. MINERALS

DATE

5-22-97

DISTRICT I
P.O. Box 1980, Hobbs, NM 88240

DISTRICT II
P.O. Drawer DD, Artesia, NM 88210

DISTRICT III
1000 Rio Brazos Ed., Artesia, NM 87410

State of New Mexico
Energy, Minerals and Natural Resources Department

Form C-102
Revised February 10, 1994
Instruction on back
Submit to Appropriate District Office
State Lease - 4 Copies
Fee Lease - 3 Copies

OIL CONSERVATION DIVISION

P.O. Box 2088
Santa Fe, New Mexico 87504-2088

☐ AMENDED REPORT

WELL LOCATION AND ACREAGE DEDICATION PLAT

API Number 30-025-33993	Pool Code 13290	Pool Name CORBIN, SOUTH - QUEEN
Property Code 5297	Property Name FEDERAL 26-A	Well Number 2
OCRID No. 11321	Operator Name J. M. HUBER CORP.	Elevation 3810

Surface Location

UL or lot No. K	Section 26	Township 18 S	Range 33 E	Lot Idn	Feet from the 1980	North/South line SOUTH	Feet from the 1980	East/West line WEST	County LEA
--------------------	---------------	------------------	---------------	---------	-----------------------	---------------------------	-----------------------	------------------------	---------------

Bottom Hole Location If Different From Surface

UL or lot No.	Section	Township	Range	Lot Idn	Feet from the	North/South line	Feet from the	East/West line	County
Dedicated Acres 40	Joint or Infill	Consolidation Code	Order No.						

NO ALLOWABLE WILL BE ASSIGNED TO THIS COMPLETION UNTIL ALL INTERESTS HAVE BEEN CONSOLIDATED
OR A NON-STANDARD UNIT HAS BEEN APPROVED BY THE DIVISION

	OPERATOR CERTIFICATION I hereby certify the the information contained herein is true and complete to the best of my knowledge and belief. Signature Joe T. Janica Printed Name Agent Title 01/20/95 Date
	SURVEYOR CERTIFICATION I hereby certify that the well location shown on this plat was plotted from field notes of actual surveys made by me or under my supervision and that the same is true and correct to the best of my belief. JANUARY 1995 Date Surveyed Signature and Seal of Professional Surveyor No. 3739 JLP WEST, 676 Certificate No. 3239

EXHIBIT "A"

LOCATION VERIFICATION MAP

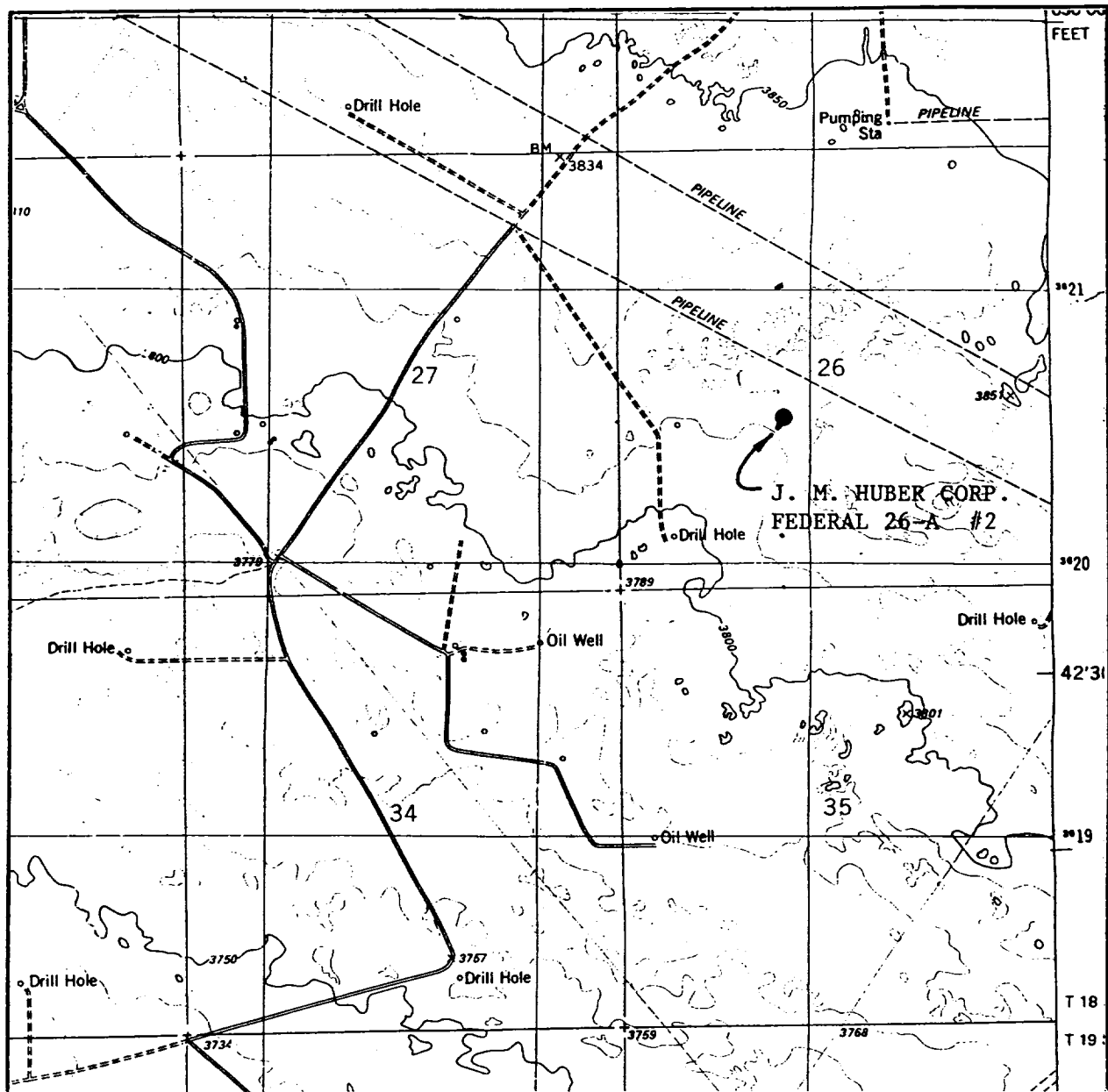

SCALE: 1" = 2000'

CONTOUR INTERVAL 10'

SEC. 26 TWP. 18-S RGE. 33-E

SURVEY N.M.P.M.

COUNTY Lea STATE N.M.

DESCRIPTION 1980 FSL. & 1980' FWL.

ELEVATION 3810

OPERATOR J. M. Huber Corp.

LEASE Federal 26-A #2

U.S.G.S. TOPOGRAPHIC MAP

Laguna Gatuna NW, N. Mex.

**JOHN WEST ENGINEERING
HOBBS, NEW MEXICO
(505) 393-3117**

APPLICATION TO DRILL

J. M. Huber Corporation
Federal "26-A" # 2
1980' FSL & 1980' FWL Sec. 29
T18S-R33E Lea Co. NM

In response to questions asked under Section II B of Bulletin NTL-6, the following information is provided for your consideration:

1. Location: 1980' FSL & 1980' FWL Sec. 26 T18S-R33E Lea County
New Mexico
2. Elevation Above Sea Level:
3. Geologic Name of Surface Formation: Quaternary Aeolian Deposits
4. Drilling Tools and Associated Equipment: Conventional rotary
drilling rig using mud for the circulation medium.
5. Proposed Drilling Depth: 4800'
6. Estimated Geological Marker Tops:

Rustler Anhydrite	1525'
Yates Sand	3170'
7 Rivers	3570'
Queen	4275'
Penrose	4535'
7. Possible Mineral Bearing Formation:
Queen - Oil
Penrose - Oil
8. Casing Program:

Hole Size	Intreval	OD Csg	Weight	Thread	Collar	Grade	Cond.
12 $\frac{1}{4}$	0-350	8 5/8	24#	8-R	ST&C	K-55	New
7 7/8	350-4800	4 $\frac{1}{2}$	10.5#	8-R	ST&C	K-55	New

APPLICATION TO DRILL

J.M. Huber Corporation
Federal "26-A" # 2
1980' FSL & 1980' FWL Sec. 26
T18S-R33E Lea Co. NM

9. Cementing and Setting Depth:

8 5/8"	Surface Casing	Set 350'± of 8 5/8" K-55 24# 8R ST&C casing cement with 220 Sx of class "C" + additives. Circulate cement to surface.
4½"	Production Casing	Set 4800'± of 4½" K-55 10.5# 8R ST&C casing cement with 700 Sx Halliburton Light cement tail in with 300 Sx class "C" + additives. Circulate cement to surface.

10. Pressure Control Equipment: Exhibit "E". A Blow-out Preventer (no less than 900 series 3000 psi working pressure) consisting of double ram type preventer with bag type preventer. Units will be hydraulically operated. Exhibit "E-1" Choke Manifold and Closing Unit. Blind rams on top, pipe rams on bottom to correspond with size of drill pipe in use. BOP will be nipped up, on 8 5/8 casing and remain on well until casing is run and cemented. BOP will be tested as well as choke manifold. BOP will be worked at least once each day while drilling and blind ram will be worked on trips when no drill pipe is in hole. Flow sensor PVT, full opening stabbing valve and upper kelley cock will be utilized. No pressures greater than 2000 psi anticipated.

11. Proposed Mud Circulating System:

Depth	Mud Wt.	Mud Visc.	Fluid Loss	Type Mud
0-350'	8-8.6	30-38	NC	Spud mud, Gel and lime as required for pH control
350-4400	10	28-32	NC	Brine water add paper for seepage and lime for pH control.
4400-4800	10-10.6	32-38	15 cc or less	Add starch for fluid loss control and lime for pH control.

In order to run a DST, log, and run casing the viscosity may have to be raised and the water loss reduced to 8cc or less depending on hole conditions.

APPLICATION TO DRILL

J. M. Huber Corporation
Federal "26-A" # 2
1980' FSL & 1980' FWL Sec 26
T18S-R33E Lea Co. NM

12. Testing, Logging and Coring Programs:

- A. Possible DST if oil and gas shows are encountered.
- B. Mud logger on at 3000' to TD. No coring planned.
- C. Open hole logs: Dual Laterolog, W/Gamma Ray, Caliper, MSFL
CNL-LDT, Gamma Ray, Caliper.

13. Potential Hazards:

No abnormal pressures of temperature zones expected (nothing abnormal in offset wells or other wells in the area). Hydrogen sulfide gas is not anticipated however, precautions for detection will be observed. No major lost circulation is expected (none reported in this area). H2S contingency attached "13-A".

14. Anticipated Starting Date and Duration of Operation: Road and location construction will begin after BLM approval of APD. Anticipated spud date 03/01/95 Drilling expected to take 8 to 10 days If production casing is run an additional 30 days to complete and construct surface facility and place well on production.

15. Other Facets of Operations: After running casing, cased hole gamma ray collar correlation logs will be run from total depth over possible pay

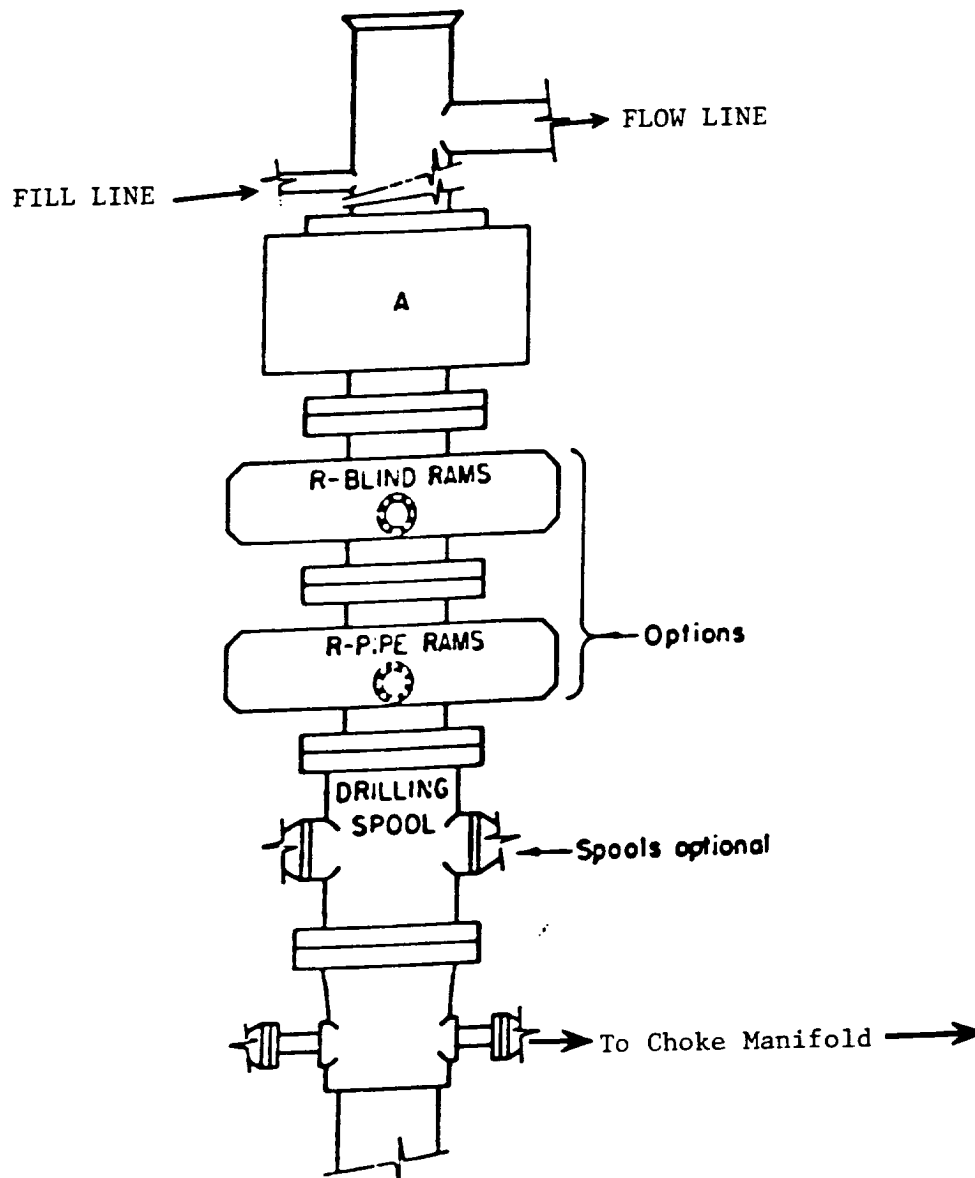

ARRANGEMENT SRRA

900 Series
3000 PSI WP

EXHIBIT "E"
B.O.P. SKETCH TO BE USED ON
J. M. Huber Corporation
Federal "26-A # 2
1980' FSL & 1980' FWL Sec. 26
T18S-R33E Lea Co. NM