

DISTRICT I
P.O. Box 1980, Hobbs, NM 88241-1980
DISTRICT II
P.O. Box Drawer DD, Artesia, NM 88211-0719
DISTRICT III
1000 Rio Brazos Rd., Aztec, NM 87410
DISTRICT IV
P.O. Box 2088, Santa Fe, NM 87504-2088

State of New Mexico
Energy, Minerals and Natural Resources Department

Form C-10/
Revised February 10, 1999
Instructions on back
Submit to Appropriate District Office
State Lease - 6 Copies
Fee Lease - 5 Copies
AMENDED REPORT

OIL CONSERVATION DIVISION

P.O. Box 2088
Santa Fe, New Mexico 87504-2088

APPLICATION FOR PERMIT TO DRILL, RE-ENTER, DEEPEN, PLUGBACK, OR ADD A ZONE

¹ Operator Name and Address TEXACO EXPLORATION & PRODUCTION INC. 205 E. Bender, HOBBS, NM 88240		² OGRID Number 022351
⁴ Property Code 11093	⁵ Property Name STATE 'AN'	³ API Number 30-025-34098 ⁶ Well No. 12

⁷ Surface Location

UI or lot no	Section	Township	Range	Lot.Idn	Feet From The	North/South Line	Feet From The	East/West Line	County
I	7	18-S	35-E		1950	SOUTH	450	EAST	LEA

⁸ Proposed Bottom Hole Location If Different From Surface

UI or lot no	Section	Township	Range	Lot.Idn	Feet From The	North/South Line	Feet From The	East/West Line	County
I	7	18-S	35-E		2326	SOUTH	885	EAST	LEA
⁹ Proposed Pool 1 <i>East</i> MID-VACUUM WOLFCAMP					¹⁰ Proposed Pool 2				

¹¹ Work Type Code P	¹² Well Type Code O	¹³ Rotary or C.T.	¹⁴ Lease Type Code S	¹⁵ Ground Level Elevation 3959'
¹⁶ Multiple No	¹⁷ Proposed Depth 12128'	¹⁸ Formation WOLFCAMP	¹⁹ Contractor	²⁰ Spud Date 8/15/00

²¹ Proposed Casing and Cement Program

SIZE OF HOLE	SIZE OF CASING	WEIGHT PER FOOT	SETTING DEPTH	SACKS OF CEMENT	EST. TOP
14 3/4	11 3/4	42#	650'	450 SACKS	SURFACE
11	8 5/8	24#	3504'	1500 SX	SURFACE
7 7/8	5 1/2	17#	11600'	2600 SX	3400'

22 Describe the proposed program. If this application is to DEEPEN or PLUG BACK give the data on the present productive zone and proposed new productive zone. Describe the blowout prevention program, if any. Use additional sheets if necessary.

TEXACO INTENDS TO RECOMPLETE THE SUBJECT WELL FROM THE DEVONIAN TO THE WOLFCAMP. AN INTENDED PROCEDURE IS AS FOLLOWS:

1. MIRU PU. PULL ESP.
2. TIH W/BIT & SCRAPER TO 11,400'.
3. SET CIBP @ 11,400'. DUMP 2 SX OF CLASS H CMT ON TOP. NEW PBTD-11,365'.
4. PERF WOLFCAMP FR 9258-80,9290-9316. TIH W/PKR & WS TO 9200'. ACIDIZE NEW PERFS W/10,000 GALS 15% HCL NEFE. DROP BALL SEALERS.
5. SWAB TEST PERFS. IF PRODUCTIVE, RUN 2 7/8" TBG TO 9300. OTHERWISE SET CIBP @ 9200.
6. RUN RDS & PMP & PLACE ON PRODUCTION.

23 I hereby certify that the rules and regulations of the Oil Conservation Division have been complied with and that the information given above is true and complete to the best of my knowledge and belief.

Signature *J. Denise Leake*

Printed Name J. Denise Leake

Title Engineering Assistant

Date 8/1/00

Telephone 397-0405

OIL CONSERVATION DIVISION

Approved By:

Title:

Approval Date:

Expiration Date:

Conditions of Approval:

Attached

DISTRICT I

P.O. Box 1980, Hobbs, NM 88241-1980

DISTRICT II

P.O. Box Drawer DD, Artesia, NM 88211-0719

DISTRICT III

1000 Rio Brazos Rd., Aztec, NM 87410

DISTRICT IV

P.O. Box 2088, Santa Fe, NM 87504-2088

State of New Mexico

Energy, Minerals and Natural Resources Department

Form C-102

Revised February 10, 1999

Instructions on back

Submit to Appropriate District Office

State Lease - 4 Copies

Fee Lease - 3 Copies

AMENDED REPORT

OIL CONSERVATION DIVISION

P.O. Box 2088

Santa Fe, New Mexico 87504-2088

WELL LOCATION AND ACREAGE DEDICATION PLAT

1 API Number 30-025-34098	2 Pool Code 62350	3 Pool Name East MD-VACUUM WOLFCAMP
4 Property Code 11093	5 Property Name STATE 'AN'	6 Well No. 12
7 OGRID Number 022351	8 Operator Name TEXACO EXPLORATION & PRODUCTION INC.	9 Elevation 3959'

10 Surface Location

UI or lot no	Section	Township	Range	Lot.Idn	Feet From The	North/South Line	Feet From The	East/West Line	County
I	7	18-S	35-E		1950	SOUTH	450	EAST	LEA

11 Bottom Hole Location If Different From Surface

UI or lot no	Section	Township	Range	Lot.Idn	Feet From The	North/South Line	Feet From The	East/West Line	County
I	7	18-S	35-E		2326	SOUTH	885	EAST	LEA

12 Dedicated Acre 40	13 Joint or Infill No	14 Consolidation Code	15 Order No.
-------------------------	--------------------------	-----------------------	--------------

NO ALLOWABLE WILL BE ASSIGNED TO THIS COMPLETION UNTIL ALL INTERESTS HAVE BEEN CONSOLIDATED
OR A NON-STANDARD UNIT HAS BEEN APPROVED BY THE DIVISION

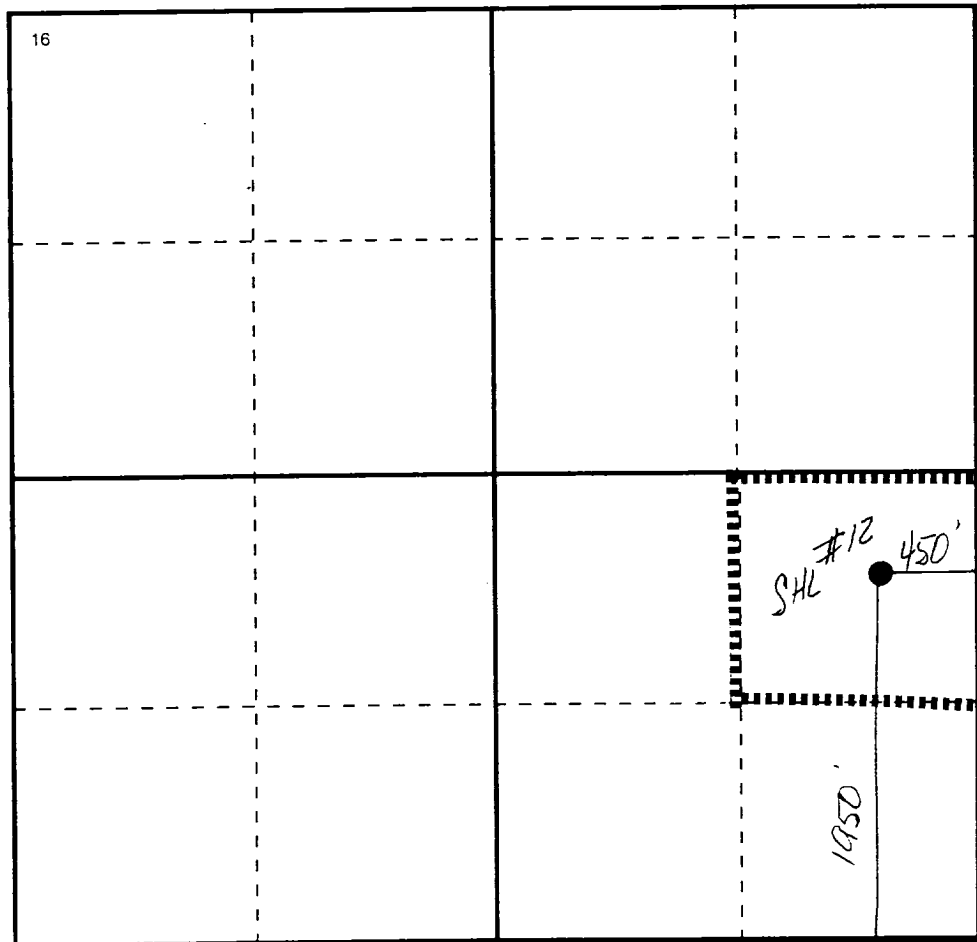

0 330 660 990 132 165 1980 2310 2640 2000 1500 1000 500 0

17 OPERATOR CERTIFICATION

I hereby certify that the information contained herein is true and complete to the best of my knowledge and belief

Signature

Printed Name

J. Denise Leake

Position

Engineering Assistant

Date

8/1/00

18 SURVEYOR CERTIFICATION

I hereby certify that the well location shown on this plat was plotted from field notes of actual surveys made by me or under my supervision, and that the same is true and correct to the best of my knowledge and belief.

Date Surveyed

Signature & Seal of
Professional Surveyor

Certificate No.