

District I  
PO Box 1980, Hobbs, NM 88241-1980  
District II  
811 S. 1st Street, Artesia, NM 88210-2834  
District III  
1030 Rio Brazos Rd., Aztec, NM 87410  
District IV  
2040 South Pacheco, Santa Fe, NM 87505

State of New Mexico  
Energy, Minerals & Natural Resources Department

OIL CONSERVATION DIVISION  
2040 South Pacheco  
Santa Fe, NM 87505

Form C-101  
Revised October 18, 1994  
Instructions on back  
Submit to Appropriate District Office  
State Lease - 6 Copies  
Fee Lease - 5 Copies

☐ AMENDED REPORT

APPLICATION FOR PERMIT TO DRILL, RE-ENTER, DEEPEN, PLUGBACK, OR ADD A ZONE

<sup>1</sup> Operator name and Address Occidental Permian Limited Partnership P.O. Box 4294 Houston, TX 77210-4294		<sup>2</sup> OGRID Number 157984
		<sup>3</sup> API Number 30-025-35370
<sup>4</sup> Property Code 19520	<sup>5</sup> Property Name North Hobbs G/SA Unit	<sup>6</sup> Well No. 613

<sup>7</sup> Surface Location									
UL or lot no.	Section	Township	Range	Lot. Idn	Feet from the	North/South Line	Feet from the	East/West line	County
L	24	18-S	37-E		1605	South	548	West	Lea

<sup>8</sup> Proposed Bottom Hole Location If Different From Surface

UL or lot no.	Section	Township	Range	Lot. Idn	Feet from the	North/South Line	Feet from the	East/West line	County
L	24	18-S	37-E		1714.6	South	548.5	West	Lea
<sup>9</sup> Proposed Pool 1 Hobbs; Grayburg - San Andres					<sup>10</sup> Proposed Pool 2				

<sup>11</sup> Work Type Code N	<sup>12</sup> Well Type Code O	<sup>13</sup> Cable/Rotary R	<sup>14</sup> Lease Type Code S	<sup>15</sup> Ground Level Elevation 3674
<sup>16</sup> Multiple No	<sup>17</sup> Proposed Depth 4500'	<sup>18</sup> Formation San Andres	<sup>19</sup> Contractor Key Energy	<sup>20</sup> Spud Date February, 2001

<sup>21</sup> Proposed Casing and Cement Program

Hole Size	Casing Size	Casing weight/foot	Setting Depth	Sacks of Cement	Estimated TOC
18	14	Conductor	40	50	Surface
12-1/4	8-5/8	24	1650	775	Surface
7-7/8	5-1/2	15.5	4500	750	Surface

<sup>22</sup> Describe the proposed program. If this application is to DEEPEN or PLUG BACK give the data on the present productive zone and proposed new productive zone. Describe the blowout prevention program, if any. Use additional sheets if necessary

Permit Expires 1 Year From Approval  
Date Unless Drilling Underway

See attached for proposed drilling program

BOP Program 3000# Ram Preventer

Well to be drilled as a directional well due to a surface obstruction situated above the bottomhole target

<sup>23</sup> I hereby certify that the information given above is true and complete to the best of my knowledge and belief.

Signature:

*Mark Stephens*

Printed name: Mark Stephens

Title: Business Analyst (SG)

OIL CONSERVATION DIVISION

Approved by:

*ORLANDO J. GARCIA WILLIAMS*

Title:

DISTRICT SUPERVISOR

Approval Date:

JAN 25 2001

Expiration Date:

*MP*

Proposed Drilling Program  
North Hobbs G/SA Unit No. 24-613  
Lea County, New Mexico

---

A 14" conductor will be set and cemented to surface with 50 sx. cement. A 12-1/4" hole will be drilled from surface to approximately 1650'. This will allow for protection of all water zones and casing off of the Red Beds. A full string of 8-5/8", 24#, J-55 surface casing will be run and set 25' into the top of the Rustler Anhydrite with cement circulated to surface. The cement will be allowed to set for a minimum of eight (8) hours (minimum 500# compressive strength) and will then be tested to 1500 psi for 30 minutes before drilling resumes. After the casing is run and cemented, weld on 8-5/8" X 11" 3M casinghead housing and nipple up BOP stack (3000# Ram Preventer).

A 7-7/8" hole will be drilled out from surface casing point (1650') to +/- 4500' TVD. A full string of 5-1/2", 15.5#, J-55 production casing will be run to TD and cemented to surface (casing test to 1500 psi will be done by the completion rig).

---

—

Form C-102  
Revised February 10, 1994  
Submit to Appropriate District Office  
State Lease - 4 Copies  
Fee Lease - 3 Copies

☐ AMENDED REPORT

				<p><b>OPERATOR CERTIFICATION</b></p> <p><i>I hereby certify that the information contained herein is true and complete to the best of my knowledge and belief.</i></p> <p><u>Mark Stephens</u></p> <p><b>Signature</b></p> <p><u>Mark Stephens</u></p> <p><b>Printed Name</b></p> <p><u>Business Analyst (SG)</u></p> <p><b>Title</b></p> <p><u>January 23, 2001</u></p> <p><b>Date</b></p>
	<p>(TRUE BRG.) N04°20'E - 91' SURF. TO PROP. PENETRATION PT. (TRUE BRG.) N09°53'E - 109' SURF. TO PROP. BOTTOM HOLE LOC.</p>	<p>GEOGRAPHIC LOCATION NAD 27 (SURF.) LAT. = 32°43'48.07" N LONG. = 103°12'40.11" W</p>		<p><b>SURVEYOR CERTIFICATION</b></p> <p><i>I hereby certify that the well location shown on this plat was plotted from field notes of actual surveys made by me or under my supervision and that the same is true and correct to the best of my belief.</i></p> <p><b>NOVEMBER 10, 2000</b></p>
				<p><b>Date Surveyed</b> <b>LMP</b></p> <p><b>Signature &amp; Seal of Professional Surveyor</b></p> <p><i>Ronald J. Eidson</i> 1/17/01</p> <p>00-11-1447</p> <p><b>Certificate No.</b> <b>RONALD J. EIDSON</b> <b>3239</b> <b>GARY EIDSON</b> <b>12641</b></p>

# LOCATION VERIFICATION MAP

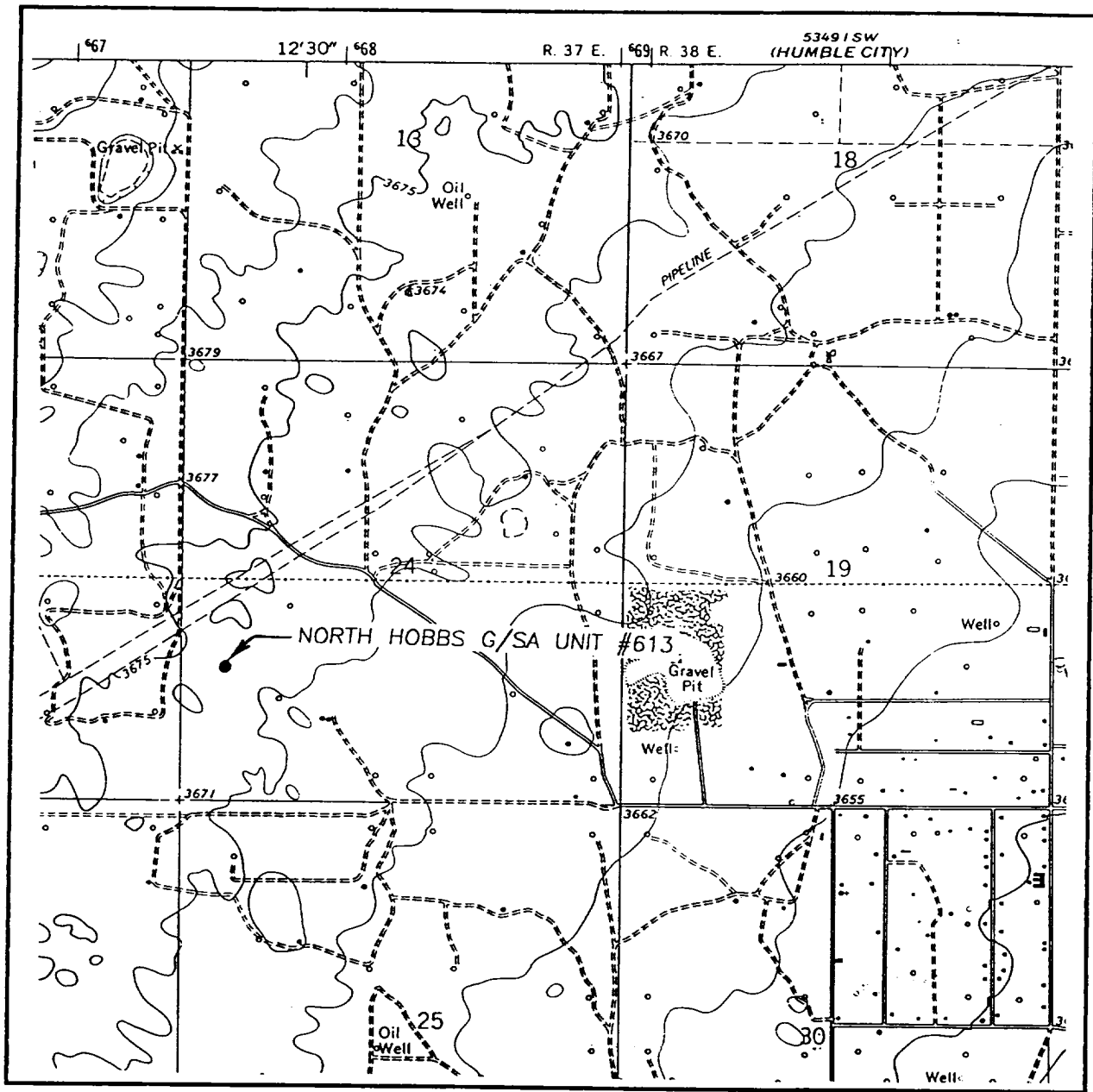

SCALE: 1" = 2000'

CONTOUR INTERVAL:  
HOBBS, N.M. - 5'

SEC. 24 TWP. 18-S RGE. 37-E

SURVEY N.M.P.M.

COUNTY LEA

DESCRIPTION 1605' FSL & 548' FWL

ELEVATION 3674

OPERATOR OCCIDENTAL PERMIAN LTD.

LEASE NORTH HOBBS G/SA UNIT 24

U.S.G.S. TOPOGRAPHIC MAP  
HOBBS, N.M.

JOHN WEST SURVEYING  
HOBBS, NEW MEXICO  
(505) 393-3117