

(SUBMIT IN TRIPLICATE)

Land Office Santa Fe, New Mexico
Lease No. LC 061340
Unit HUNITED STATES
DEPARTMENT OF THE INTERIOR
GEOLOGICAL SURVEY

RECEIVED

AUG 31 1961

SUNDRY NOTICES AND REPORTS ON WELLS

O. C. C.
ARTESIAL OFFICE

NOTICE OF INTENTION TO DRILL.....	<input checked="" type="checkbox"/>	SUBSEQUENT REPORT OF WATER SHUT-OFF.....	
NOTICE OF INTENTION TO CHANGE PLANS.....		SUBSEQUENT REPORT OF SHOOTING OR ACIDIZING.....	
NOTICE OF INTENTION TO TEST WATER SHUT-OFF.....		SUBSEQUENT REPORT OF ALTERING CASING.....	
NOTICE OF INTENTION TO RE-DRILL OR REPAIR WELL.....		SUBSEQUENT REPORT OF RE-DRILLING OR REPAIR.....	
NOTICE OF INTENTION TO SHOOT OR ACIDIZE.....		SUBSEQUENT REPORT OF ABANDONMENT.....	
NOTICE OF INTENTION TO PULL OR ALTER CASING.....		SUPPLEMENTARY WELL HISTORY.....	
NOTICE OF INTENTION TO ABANDON WELL.....			

(INDICATE ABOVE BY CHECK MARK NATURE OF REPORT, NOTICE, OR OTHER DATA)

August 19, 1961

Federal
Well No. 2 is located 1650 ft. from [N] line and 990 ft. from [E] line of sec. 4
SE 1/4 sec. 4 18 South Range 30 East T10N R10E
(1/4 Sec. and Sec. No.) (Twp.) (Range) (Meridian)
Pearse Lea New Mexico
(Field) (County or Subdivision) (State or Territory)

The elevation of the ground level
~~drill floor~~ above sea level is 3375 ft.

DETAILS OF WORK

(State names of and expected depths to objective sands; show sizes, weights, and lengths of proposed casings; indicate mudding jobs, cementing points, and all other important proposed work)

Federal No. 2 will have 7" OD 20# casing set at a proximately 500 feet, and will be circulated to the surface of the ground with cement. If the objective sand (Queen), anticipated at a depth of 3000 feet, is productive, an oil string of 4 1/2" OD casing will be set. This oil string will be set & cemented using 100 sacks on bottom and a sufficient amount in the upper stage to circulate with cement from 1500 feet up into the 7" surface casing.

RECEIVED

AUG 28 1961

I understand that this plan of work must receive approval in writing by the Geological Survey before operations may be commenced.

Company B. M. JacksonAddress 2035 Republic National Bank Bldg.Dallas 1, TexasBy B. M. Jackson
Title Owner

NEW MEXICO OIL CONSERVATION COMMISSION
WELL LOCATION AND ACREAGE DEDICATION PLAT

FORM C-128
Revised 5/1/57

SEE INSTRUCTIONS FOR COMPLETING THIS FORM ON THE REVERSE SIDE

SECTION A

Operator B. M. JACKSON		Lease FEDERAL		Well No. 2	
Unit Letter H	Section 4	Township 18 SOUTH	Range 32 EAST	County LEA	
Actual Footage Location of Well: 1650 feet from the NORTH line and 990 feet from the EAST line					
Ground Level Elev.	Producing Formation		Pool	Dedicated Acreage: Acres	

1. Is the Operator the only owner in the dedicated acreage outlined on the plat below? YES ☒ NO ____ . ("Owner" means the person who has the right to drill into and to produce from any pool and to appropriate the production either for himself or for himself and another. (65-3-29 (a) NMSA 1935 Comp.)
2. If the answer to question one is "no," have the interests of all the owners been consolidated by communitization agreement or otherwise? YES ____ NO ____ . If answer is "yes," Type of Consolidation _____
3. If the answer to question two is "no," list all the owners and their respective interests below:

Owner B. M. Jackson	Land Description SE $\frac{1}{4}$ NE $\frac{1}{4}$ sec. 4, 18S., 32 E.
-------------------------------	--

SECTION B

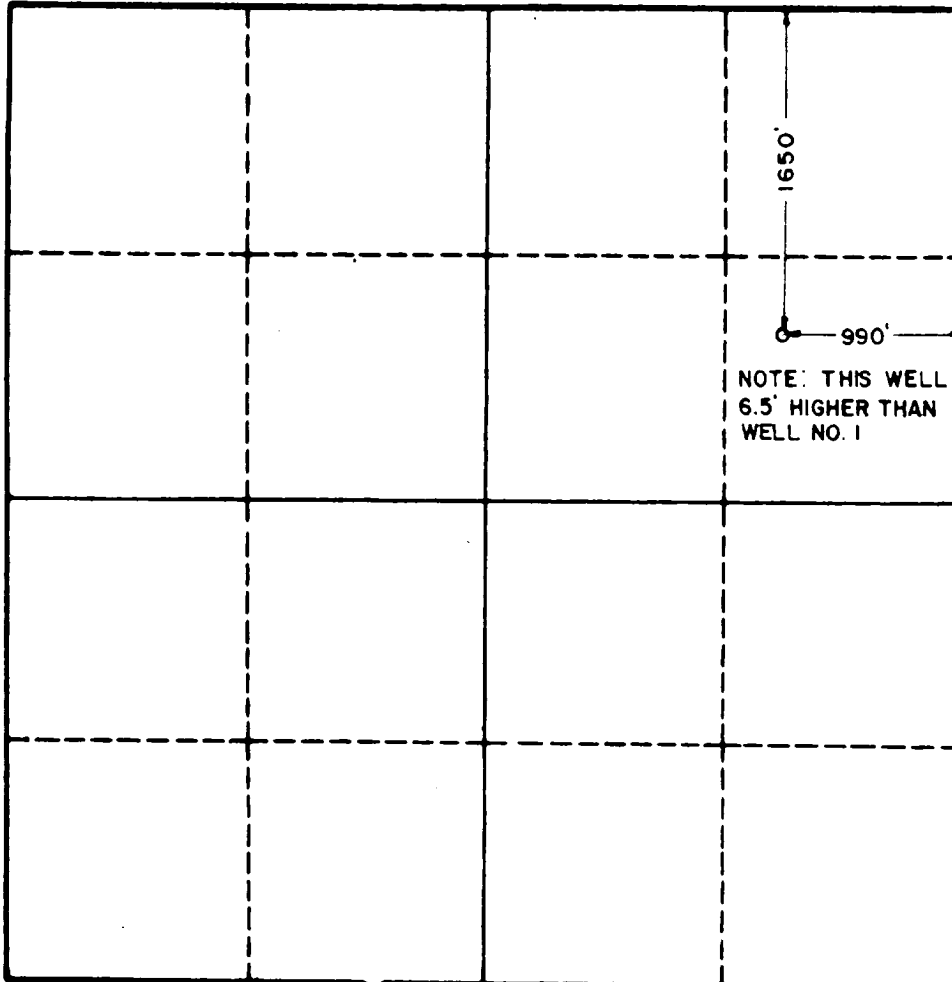

CERTIFICATION

I hereby certify that the information in SECTION A above is true and complete to the best of my knowledge and belief.

Name <i>B. M. Jackson</i>
Position Operator
Company Owner
Date Aug. 19, 1961

AUG 28 1961

I hereby certify that the well location shown on the plat in SECTION B was plotted from field notes of actual surveys made by me or under my supervision, and that the same is true and correct to the best of my knowledge and belief.

Date Surveyed Aug. 19, 1961
Registered Professional Engineer and/or Land Surveyor, JOHN W. WEST
Certificate No. W. M. - P. E. - 1000