

(SUBMIT IN TRIPLICATE)

UNITED STATES
DEPARTMENT OF THE INTERIOR
GEOLOGICAL SURVEY

Budget Bureau No. 49-R368.4
Approval expires 12-31-60.

Land Office Las Cruces, N.M.
Lease No. 029403a
Unit 0

SUNDRY NOTICES AND REPORTS ON WELLS

NOTICE OF INTENTION TO DRILL.....	<input checked="" type="checkbox"/>	SUBSEQUENT REPORT OF WATER SHUT-OFF.....	
NOTICE OF INTENTION TO CHANGE PLANS.....		SUBSEQUENT REPORT OF SHOOTING OR ACIDIZING.....	
NOTICE OF INTENTION TO TEST WATER SHUT-OFF.....		SUBSEQUENT REPORT OF ALTERING CASING.....	
NOTICE OF INTENTION TO RE-DRILL OR REPAIR WELL.....		SUBSEQUENT REPORT OF RE-DRILLING OR REPAIR.....	
NOTICE OF INTENTION TO SHOOT OR ACIDIZE.....		SUBSEQUENT REPORT OF ABANDONMENT.....	
NOTICE OF INTENTION TO PULL OR ALTER CASING.....		SUPPLEMENTARY WELL HISTORY.....	
NOTICE OF INTENTION TO ABANDON WELL.....			

(INDICATE ABOVE BY CHECK MARK NATURE OF REPORT, NOTICE, OR OTHER DATA)

November 7, 1958

Walker

Well No. A-3 is located 1650 ft. from N line and 2310 ft. from E line of sec. 5

SW NE Sec 5 18 19 20 32 N.M.P.M.
(1/4 Sec. and Sec. No.) (Twp.) (Range) (Meridian)

Pearshall
(Field)

Lee
(County or Subdivision)

New Mexico
(State or Territory)

The elevation of the derrick floor above sea level is _____ ft.

DETAILS OF WORK

(State names of and expected depths to objective sands; show sizes, weights, and lengths of proposed casings; indicate mudding jobs, cementing points, and all other important proposed work)

Sands to be tested - Queen Sand approx. 3700'

Casing program - 1000' 8-5/8" 24# 75 ex
3700' 4-1/2" 9.5# 100 ex

I understand that this plan of work must receive approval in writing by the Geological Survey before operations may be commenced.

Company Roy H. Smith Drilling Company

Address 1117 City Bldg.

Wichita Falls, Texas

By H. L. Johnston Jr.
Title Partner

MEXICO OIL CONSERVATION COMMISSION

Well Location and Acreage Dedication Plat

Section A.

Date November 5, 1958

Operator Roy H. Smith Drilling Co. Lease Walker A
Well No. 3 Unit Letter A Section 5 Township 18 South Range 32 East NMPM
Located 1650 Feet From North Line, 2310 Feet From East Line
County Lea G. L. Elevation _____ Dedicated Acreage 40 Acres
Name of Producing Formation Queen Pool Pearsall

1. Is the Operator the only owner* in the dedicated acreage outlined on the plat below?
Yes Yes No _____.
2. If the answer to question one is "no," have the interests of all the owners been consolidated by communitization agreement or otherwise? Yes _____ No _____. If answer is "yes," Type of Consolidation _____
3. If the answer to question two is "no," list all the owners and their respective interests below:

Owner

Land Description

NOV 10 1958

U. S. DEPT. OF THE INTERIOR
ARTESIA, NEW MEXICO

Section B

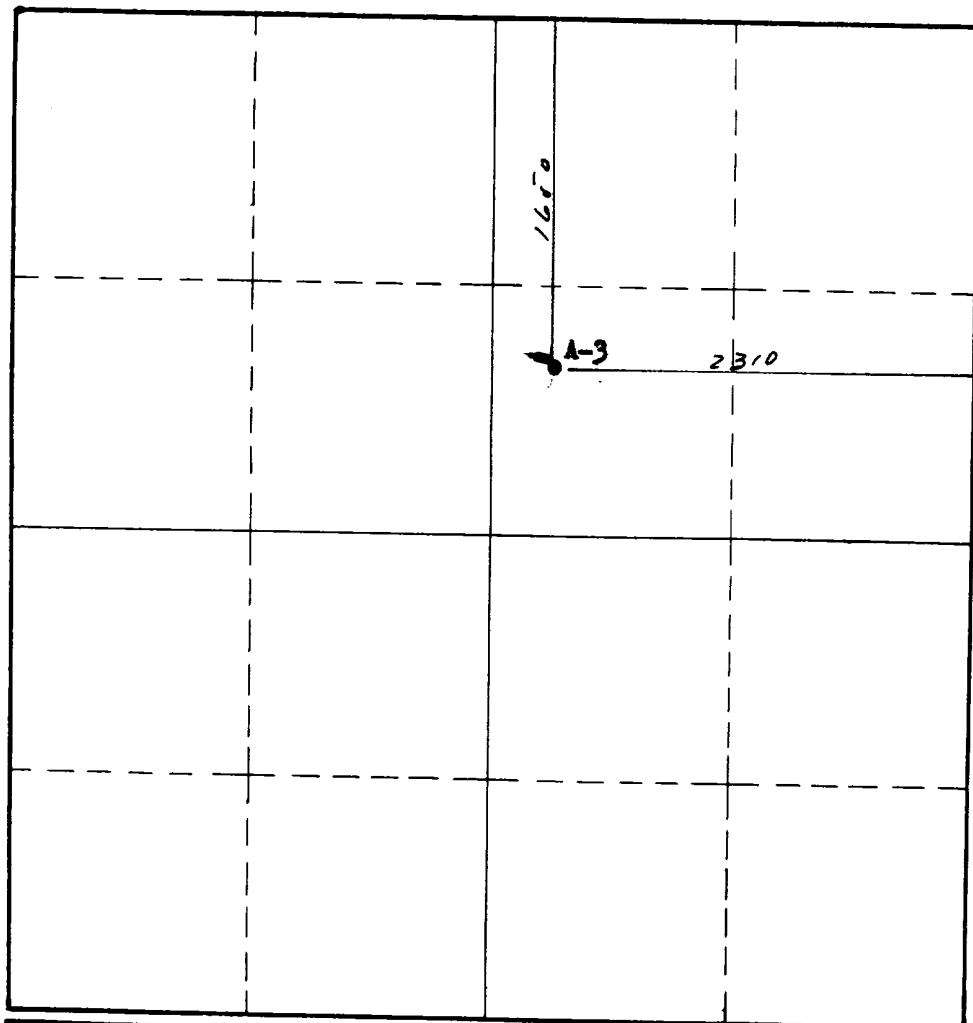

This is to certify that the information in Section A above is true and complete to the best of my knowledge and belief.

Roy H. Smith Drilling Co.
(Operator)

Gray Holman - agent
(Representative)

Box 536, Artesia, N.M.
Address

This is to certify that the well location shown on the plat in Section B was plotted from field notes of actual surveys made by me or under my supervision and that the same is true and correct to the best of my knowledge and belief.

Date Surveyed 11/5/58

John A. Martin, Jr.
Registered Professional
Engineer and/or Land Surveyor.

Certificate No. 1582

(See instructions for completing this form on the reverse side)

INSTRUCTIONS FOR COMPLETION:

1. Operator shall furnish and certify to the information called for in Section A.
2. Operator shall outline the dedicated acreage for both oil and gas wells on the plat in Section B.
3. A registered professional engineer or land surveyor registered in the State of New Mexico or approved by the Commission shall show on the plat the location of the well and certify this information in the space provided.
4. All distances shown on the plat must be from the outer boundaries of Section.
5. If additional space is needed for listing owners and their respective interests as required in question 3, Section A, please use space below

* "Owner" means the person who has the right to drill into and to produce from any pool and to appropriate the production either for himself or for himself and another. (65-3-29 (e) NMSA 1953 Comp.)