

(SUBMIT IN TRIPLICATE)

UNITED STATES
DEPARTMENT OF THE INTERIOR
GEOLOGICAL SURVEYLand Office Santa Fe, N. M.Lease No. NM-01004

Unit _____

SUNDRY NOTICES AND REPORTS ON WELLS

NOTICE OF INTENTION TO DRILL	<input checked="" type="checkbox"/>	SUBSEQUENT REPORT OF WATER SHUT-OFF	
NOTICE OF INTENTION TO CHANGE PLANS		SUBSEQUENT REPORT OF SHOOTING OR ACIDIZING	
NOTICE OF INTENTION TO TEST WATER SHUT-OFF		SUBSEQUENT REPORT OF ALTERING CASING	
NOTICE OF INTENTION TO RE-DRILL OR REPAIR WELL		SUBSEQUENT REPORT OF RE-DRILLING OR REPAIR	
NOTICE OF INTENTION TO SHOOT OR ACIDIZE		SUBSEQUENT REPORT OF ABANDONMENT	
NOTICE OF INTENTION TO PULL OR ALTER CASING		SUPPLEMENTARY WELL HISTORY	
NOTICE OF INTENTION TO ABANDON WELL			

(INDICATE ABOVE BY CHECK MARK NATURE OF REPORT, NOTICE, OR OTHER DATA)

January 28, 1962

Well No. 1 is located 660 ft. from N line and 1980 ft. from E line of sec. 12
NE 1/4 NW 1/4 Sec. 12 18-S 32-E NM-TM
(1/4 Sec. and Sec. No.) (Twp.) (Range) (Meridian)
Wildcat Lea New Mexico
(Field) (County or Subdivision) (State or Territory)

The elevation of the derrick floor above sea level is _____ ft.

DETAILS OF WORK

(State names of and expected depths to objective sands; show sizes, weights, and lengths of proposed casings; indicate mudding jobs, cementing points, and all other important proposed work)

Intend to drill 4100 foot Queen Sand test with rotary tools. Will drill 9-3/8" hole to 700 feet and run 7" 17# casing with 75 sacks cement; then drill to T.D. with 6-1/4" bit. If productive, will set 4100 feet of 4-1/2" 9.6# pipe and cement from bottom of pipe to base of salt; then stage cement above salt to 7" casing.

RECEIVED

JAN 29 1962

U. S. GEOLOGICAL SURVEY,
ARTESIA, NEW MEXICO

I understand that this plan of work must receive approval in writing by the Geological Survey before operations may be commenced.

Company HELDING AND PODPECHANAddress 418 Hinkle Building
Roswell, New MexicoBy F. W. Podpechan
(F. W. Podpechan)Title Partner

NUMBER OF COPIES RECEIVED	
DISTRIBUTION	
SANTA FE	
FILE	
U.S.S.	
LAND OFFICE	
TRANSPORTER	OIL GAS
PRODUCTION OFFICE	
OPERATOR	

NEW MEXICO OIL CONSERVATION COMMISSION

WELL LOCATION AND ACREAGE DEDICATION PLAT

SEE INSTRUCTIONS FOR COMPLETING THIS FORM ON THE REVERSE SIDE

FORM C-128
Revised 5/1/57

SECTION A

Operator Helbing & Podpechan			Lease Yates Fed.		Well No. 1
Unit Letter C	Section 12	Township 18 S	Range 32 E	County Lea	
Actual Footage Location of Well: 660 feet from the N line and 1980 feet from the W line					
Ground Level Elev.	Producing Formation Queen		Pool Wildcat	Dedicated Acreage: 40 Acres	

1. Is the Operator the only owner in the dedicated acreage outlined on the plat below? YES ☒ NO ☐ ("Owner" means the person who has the right to drill into and to produce from any pool and to appropriate the production either for himself or for himself and another. (65-3-29 (e) NMSA 1935 Comp.)
2. If the answer to question one is "no," have the interests of all the owners been consolidated by communitization agreement or otherwise? YES ☐ NO ☐ If answer is "yes," Type of Consolidation _____
3. If the answer to question two is "no," list all the owners and their respective interests below:

Owner	Land Description

SECTION B

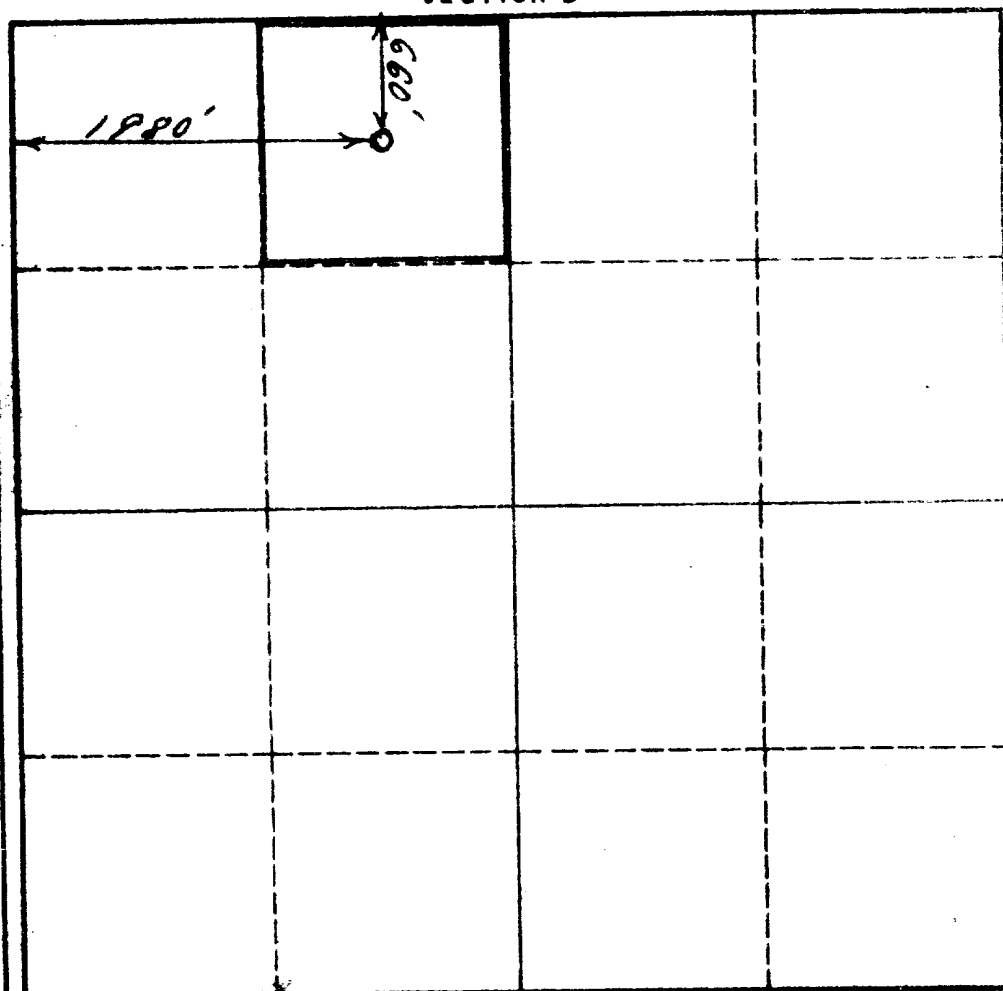

CERTIFICATION

I hereby certify that the information in SECTION A above is true and complete to the best of my knowledge and belief.

Joe Podpechan

Name

Position

Company

Date

I hereby certify that the well location shown on the plat in SECTION B was plotted from field notes of actual surveys made by me or under my supervision, and that the same is true and correct to the best of my knowledge and belief.

Date Surveyed

Registered

and/or filed

Certified

0 320 640 960 1280 1600 1920 2240 2560 2880 3200 3520 3840 4160 4480 4800 5120 5440 5760 6080 6400 6720 7040 7360 7680 8000 8320 8640 8960 9280 9600 9920 10240 10560 10880 11200 11520 11840 12160 12480 12800 13120 13440 13760 14080 14400 14720 15040 15360 15680 16000