

Company EDWARD E. KINNEY

Lease STATE (E8013) Well No. 1

Sec. 32 T. 19 S., R. 33 E., N.M.P.M.

Location 660'/North & 2310'/West

County LEA, New Mexico

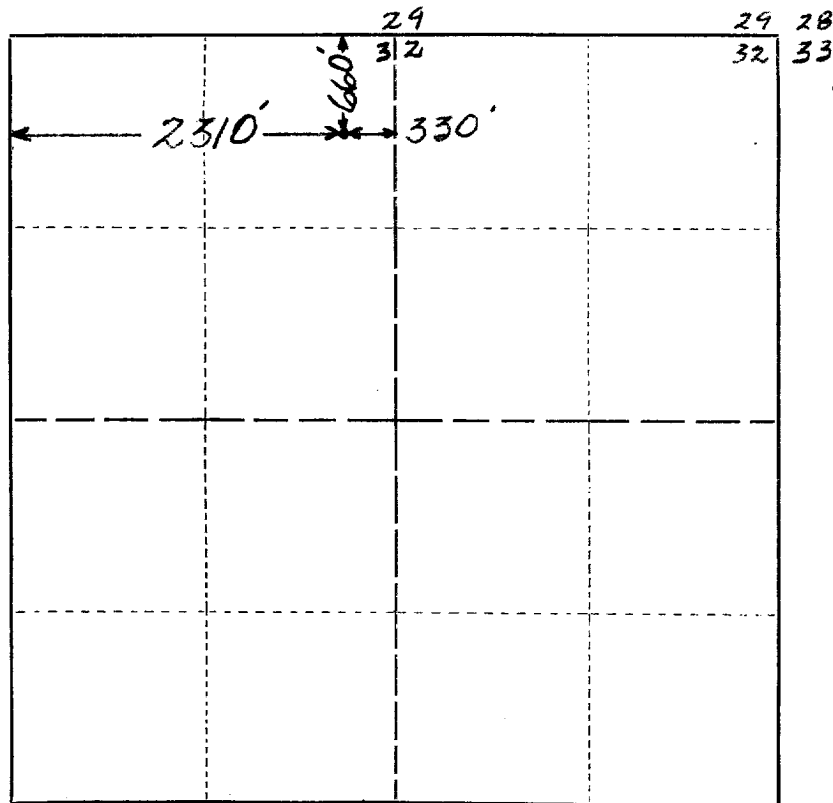

Scale 4" = 1 mile.

This is to certify that the above plat was prepared from field notes of actual surveys made by me or under my supervision and that the same are true and correct to the best of my knowledge and belief.

Seal:
Artesia, New Mexico

Edward E. Kinney
Registered Professional
Engineer and Land Surveyor.

Surveyed November 13, 1954

17532 Advocate Print

