

NEW MEXICO
OIL CONSERVATION COMMISSION

Form C-128

Well Location and/or Gas Proration Plat

Date July 27, 1956

Operator Western Drilling Co. Inc. Lease Gulf Oil, Les. No. 57,045
State Les. No. 1054

Well No. 1 Section 17 Township 17 South Range 34 East NMPM

Located 660 Feet From East Line, 660 Feet From South Line,

Lea County, New Mexico. G. L. Elevation _____

Name of Producing Formation _____ Pool Vacuum Dedicated Acreage 160

(Note: All distances must be from outer boundaries of Section)

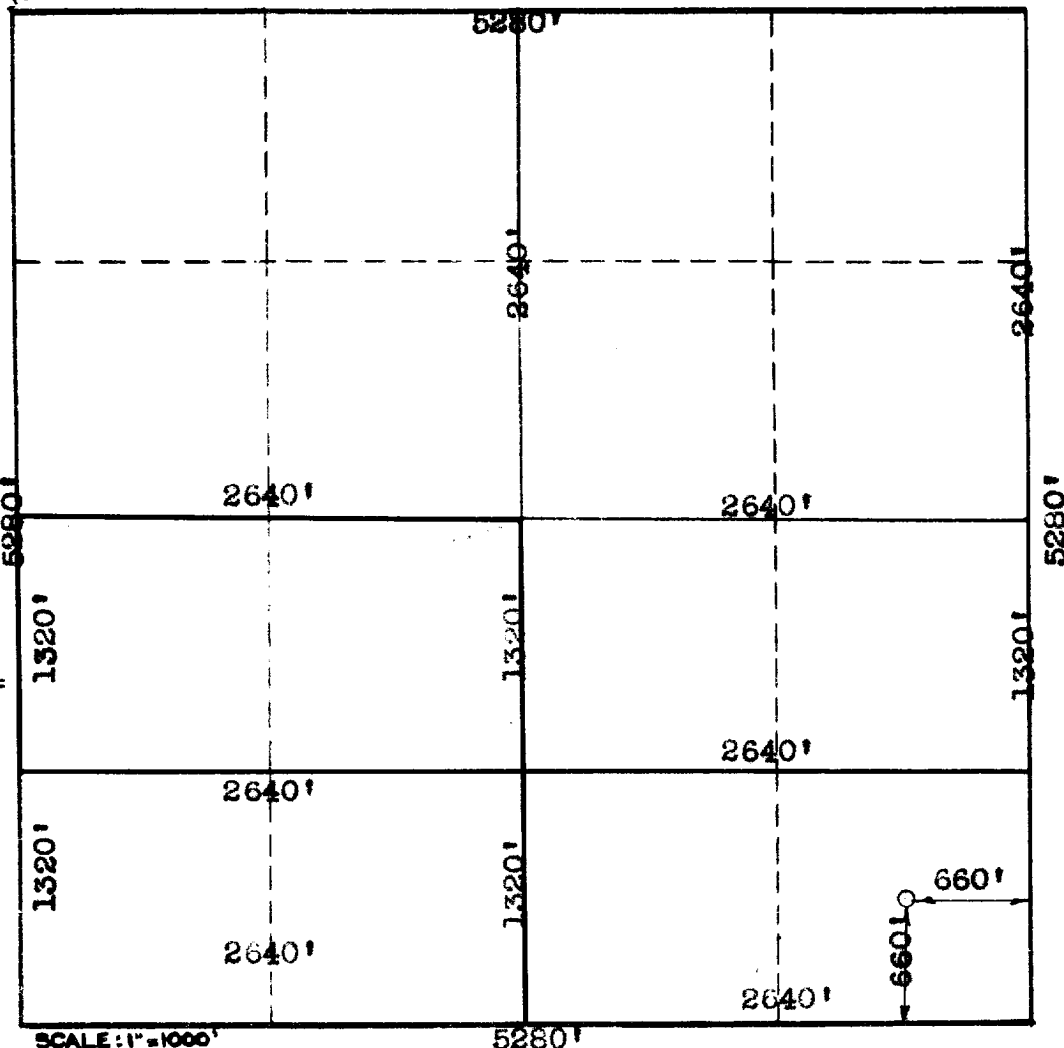

NOTE

This section of
form is to be
used for gas
wells only.

1. Is this Well a Dual Comp.? Yes ___ No ___
2. If the answer to Question 1 is yes, are there
any other dually completed wells within the
dedicated acreage? Yes ___ No ___

This is to certify that the above plat was
prepared from field notes of actual surveys
made by me or under my supervision and
that the same are true and correct to the
best of my knowledge and belief.

Name _____
Position _____
Representing _____
Address _____

Date Surveyed July 27, 1956
W. H. Garner
Registered Professional Engineer and/or
Land Surveyor