

NEW MEXICO OIL CONSERVATION COMMISSION

Well Location and Acreage Dedication Plat

Section A.

Date December 13, 1962

Operator	Socor	Mobil Oil Company, Inc.	Lease	State Bridges
Well No.	11	Unit Letter	F	Section 25 Township 17S Range 34E NMPH
Located	1978	Feet From	West Line, 1980	Feet From North Line
County	Lea			
Name of Producing Formation		L. Elevation	4013	Dedicated Acreage 40 Acres
		Paddock		Pool Undesignated

1. Is the Operator the owner of the dedicated acreage outlined on the plat below?
Yes X No
2. If the answer to question one is "no," have the interests of all the owners been consolidated by common titlization agreement or otherwise? Yes No . If answer is "yes," Type of Consolidation
3. If the answer to question two is "no," list all the owners and their respective interests below:

Owner

Land Description.

Section B.

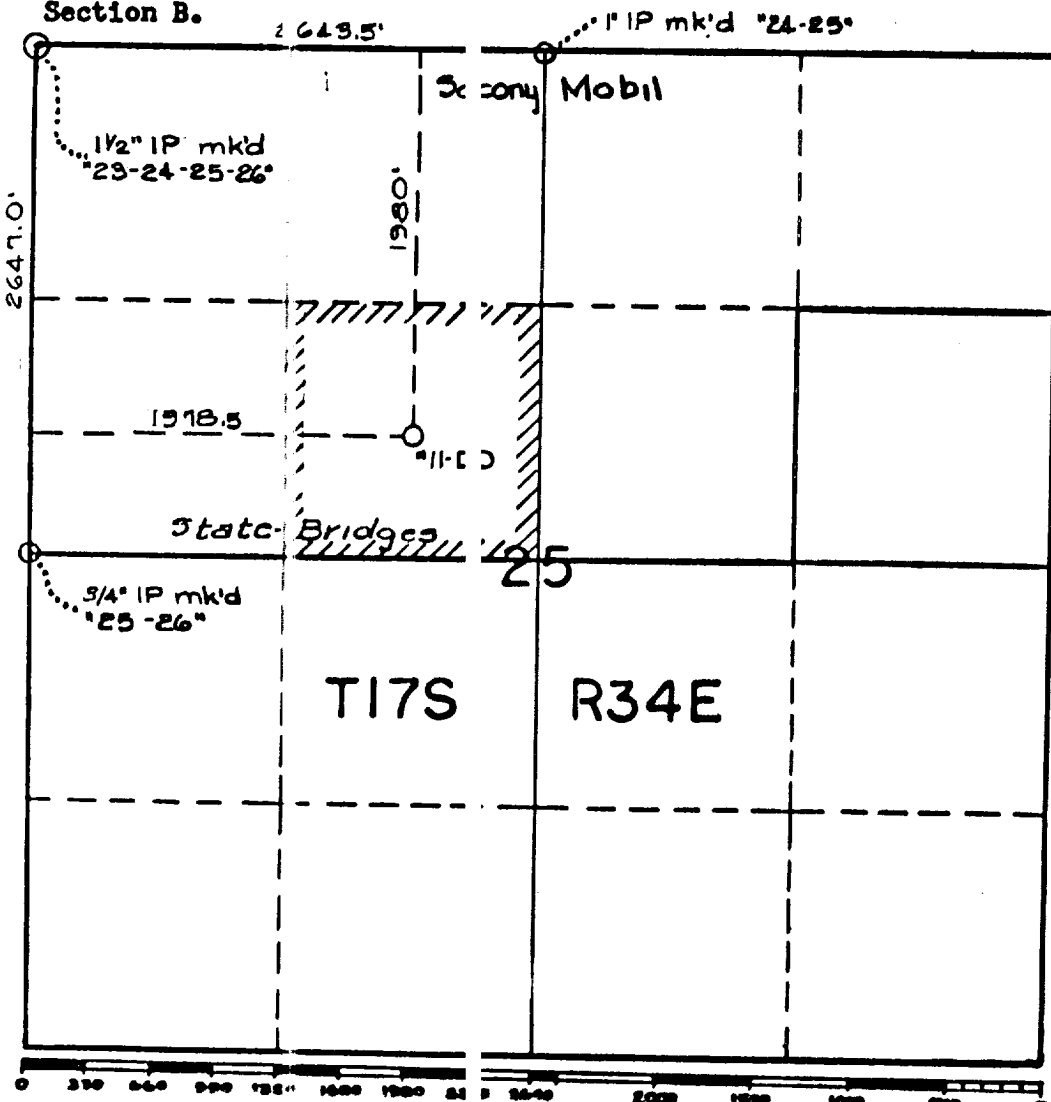

This is to certify that the information in Section A above is true and complete to the best of my knowledge and belief.

Socony Mobil Oil Co., Inc.

(Operator)

(Representative)

Box 2406, Hobbs, New Mexico

Address

This is to certify that the well location shown on the plat in Section B was plotted from field notes of actual surveys made by me or under my supervision and that the same is true and correct to the best of my knowledge and belief.

Date Surveyed _____

**Registered Professional
Engineer and/or Land Surveyor.**

Certificate No.