

NEW MEXICO OIL CONSERVATION COMMISSION

Well Location and Acreage Dedication Plat

Section A.

Date November 21, 1962

Operator Socony Mobil Oil Company, Inc. Lease State Bridges  
Well No. 13 Unit Letter E Section 25 Township 17S Range 34E NMPN  
Located 1980 Feet From North Line, 660 Feet From West Line  
County Lea G. L. Elevation 4019 Dedicated Acreage 40 Acres  
Name of Producing Formation Yeco Pool Undesignated

1. Is the Operator the only owner\* in the dedicated acreage outlined on the plat below?  
Yes X No       .
2. If the answer to question one is "no," have the interests of all the owners been consolidated by communitization agreement or otherwise? Yes        No       . If answer is "yes," Type of Consolidation
3. If the answer to question two is "no," list all the owners and their respective interests below:

Owner

Land Description

Section B.

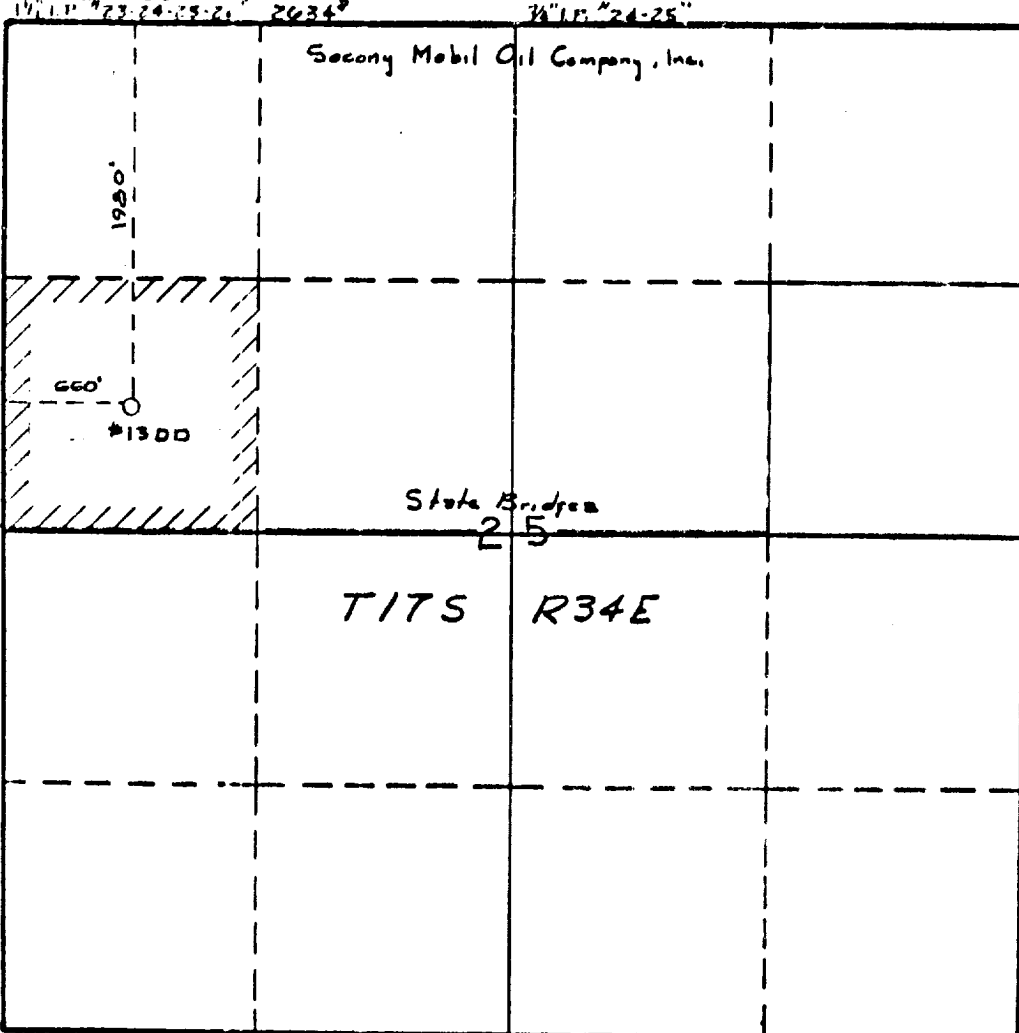

This is to certify that the information in Section A above is true and complete to the best of my knowledge and belief.

Socony Mobil Oil Co., Inc.

(Operator)

(Representative)

Box 2406, Hobbs, New Mexico

Address

This is to certify that the well location shown on the plat in Section B was plotted from field notes of actual surveys made by me or under my supervision and that the same is true and correct to the best of my knowledge and belief.

Date Surveyed       

Registered Professional  
Engineer and/or Land Surveyor.

Certificate No.