

NEW MEXICO OIL CONSERVATION COMMISSION

Well Location and Acreage Dedication Plat

Section A.

Date January 5, 1963

Operator Socony Mobil Oil Company, Inc. Lease State Bridges
Well No. 32 Unit Letter C Section 25 Township 17S Range 34E NMPM
Located 1700 Feet From West Line, 660 Feet From North Line
County Lea G. L. Elevation 4013 Dedicated Acreage 40 Acres
Name of Producing Formation Isiblock Pool Undesignated

1. Is the Operator the only owner* in the dedicated acreage outlined on the plat below?
Yes X No .
2. If the answer to question one is "no," have the interests of all the owners been consolidated by communitization agreement or otherwise? Yes No . If answer is "yes," Type of Consolidation
3. If the answer to question two is "no," list all the owners and their respective interests below:

Owner

Land Description

Section B.

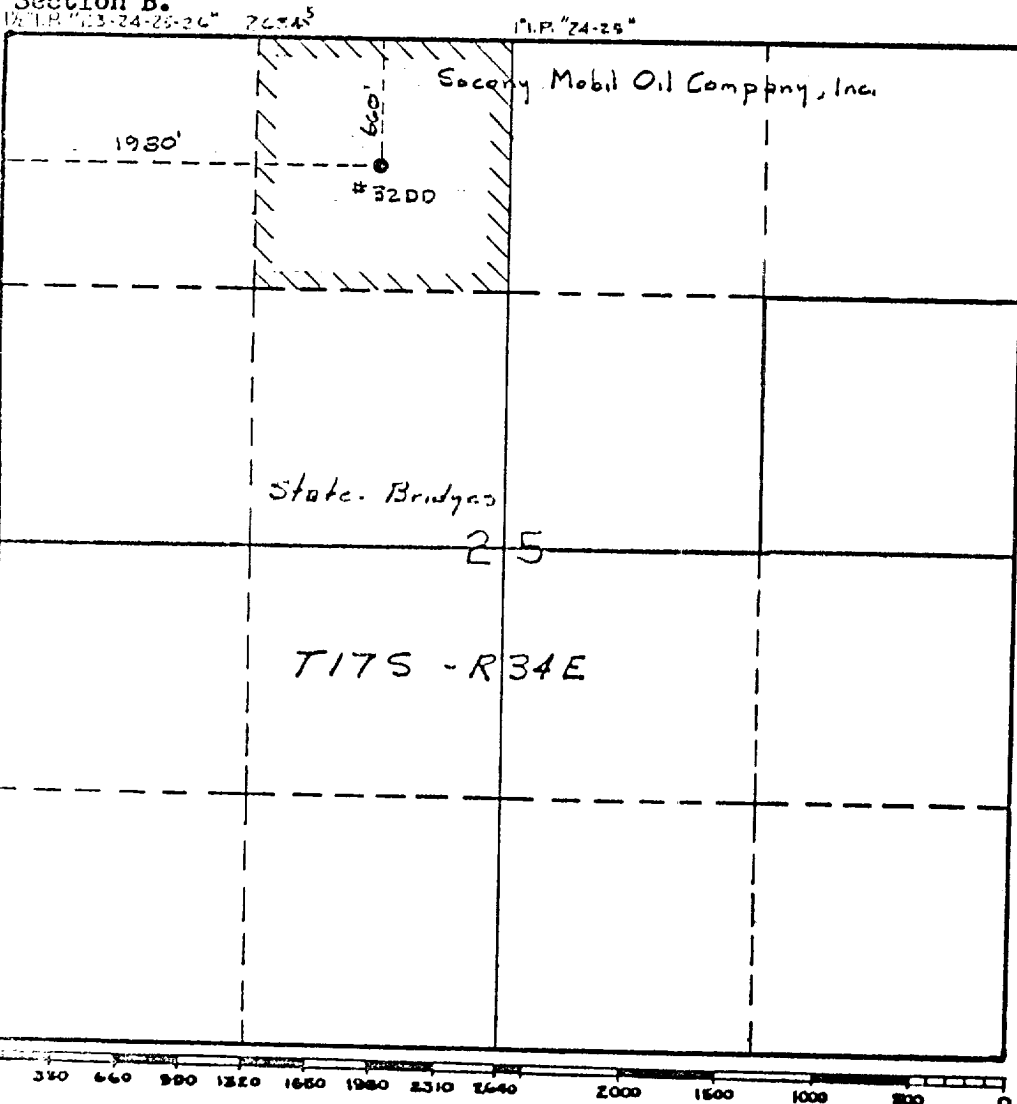

This is to certify that the information in Section A above is true and complete to the best of my knowledge and belief.

Socony Mobil Oil Co., Inc.

(Operator)

(Representative)

Box 2406, Hobbs, New Mexico

Address

This is to certify that the well location shown on the plat in Section B was plotted from field notes of actual surveys made by me or under my supervision and that the same is true and correct to the best of my knowledge and belief.

Date Surveyed

Registered Professional Engineer and/or Land Surveyor.

Certificate No.