

APPROVED

Form 9-331a  
(Feb. 1951)

SUBJECT: T. C. LOWE  
OCT 23 1962

COPY TO O.C.C.  
10855

Budget Bureau No. 42-R358.4.  
m Approved.

Land Office **New Mexico**

Lease No. **N.M. 056376  
L.C. 008310**

Unit **Mescalero Ridge**

**RECEIVED**

OCT 23 1962

**SUNDRY NOTICES AND REPORTS ON WELLS**

NOTICE OF INTENTION TO DRILL.....	<input checked="" type="checkbox"/>	SUBSEQUENT REPORT OF WATER SHUT-OFF.....
NOTICE OF INTENTION TO CHANGE PLANS.....		SUBSEQUENT REPORT OF SHOOTING OR ACIDIZING.....
NOTICE OF INTENTION TO TEST WATER SHUT-OFF.....		SUBSEQUENT REPORT OF ALTERING CASING.....
NOTICE OF INTENTION TO RE-DRILL OR REPAIR WELL.....		SUBSEQUENT REPORT OF RE-DRILLING OR REPAIR.....
NOTICE OF INTENTION TO SHOOT OR ACIDIZE.....		SUBSEQUENT REPORT OF ABANDONMENT.....
NOTICE OF INTENTION TO PULL OR ALTER CASING.....		SUPPLEMENTARY WELL HISTORY.....
NOTICE OF INTENTION TO ABANDON WELL.....		

(INDICATE ABOVE BY CHECK MARK NATURE OF REPORT, NOTICE, OR OTHER DATA)

October 19, 1962

**MESCALERO RIDGE UNIT**

Well No. **3** is located **1980** ft. from **NE** line and **1980** ft. from **DE** line of sec. **21**

**31/4 Sec 21**  
(1/4 Sec. and Sec. No.)

**19S**  
(Twp.)

**3E**  
(Range)

**1NPM**  
(Meridian)

**Quail Ridge-Bone Springs**  
(Field)

**Lea**  
(County or Subdivision)

**New Mexico**  
(State or Territory)

The elevation of the derrick floor above sea level is **3766** ft. (Est)

**DETAILS OF WORK**

(State names of and expected depths to objective sands; show sizes, weights, and lengths of proposed casings; indicate mudding jobs, cementing points, and all other important proposed work)

This well to be drilled with rotary tools from surface to estimated total depth of 10,200 feet, testing the Bone Springs Formation.

Surface : 8 5/8" 24# J-55 casing set at 1850' with cement circulated.

Production: 2 7/8" H-80 Non-upset casing set at total depth with cement above Bone Springs formation.

- \* Cementing program on the 2-7/8" casing to be cleared by this office prior to running casing.

I understand that this plan of work must receive approval in writing by the Geological Survey before operations may be commenced.

Company **Drilling & Exploration Co., Inc.**

Address **Box 2075**

**Hobbs, New Mexico**

By *[Signature]*

Title **Division Production Manager**

NEW MEXICO OIL CONSERVATION COMMISSION  
WELL LOCATION AND ACREAGE DEDICATION PLAT

FORM C-128  
Revised 5/1/57

SEE INSTRUCTIONS FOR COMPLETING THIS FORM ON THE REVERSE SIDE

SECTION A

Operator <b>DRILLING &amp; EXPLORATION CO., INC.</b>		Lease <b>MESCALERO RIDGE UNIT</b>		Well No. <b>3</b>
Unit Letter <b>K</b>	Section <b>21</b>	Township <b>19 SOUTH</b>	Range <b>34 EAST</b>	County <b>LEA</b>
Actual Footage Location of Well: <b>1980</b> feet from the <b>SOUTH</b> line and <b>1980</b> feet from the <b>WEST</b> line				
Ground Level Elev. <b>3734.3</b>	Producing Formation		Pool	Dedicated Acreage: Acres

1. Is the Operator the only owner in the dedicated acreage outlined on the plat below? YES \_\_\_\_\_ NO \_\_\_\_\_. ("Owner" means the person who has the right to drill into and to produce from any pool and to appropriate the production either for himself or for himself and another. (65-3-29 (e) NMSA 1935 Comp.)
2. If the answer to question one is "no," have the interests of all the owners been consolidated by communization agreement or otherwise? YES \_\_\_\_\_ NO \_\_\_\_\_. If answer is "yes," Type of Consolidation \_\_\_\_\_
3. If the answer to question two is "no," list all the owners and their respective interests below:

Owner	Land Description

SECTION B

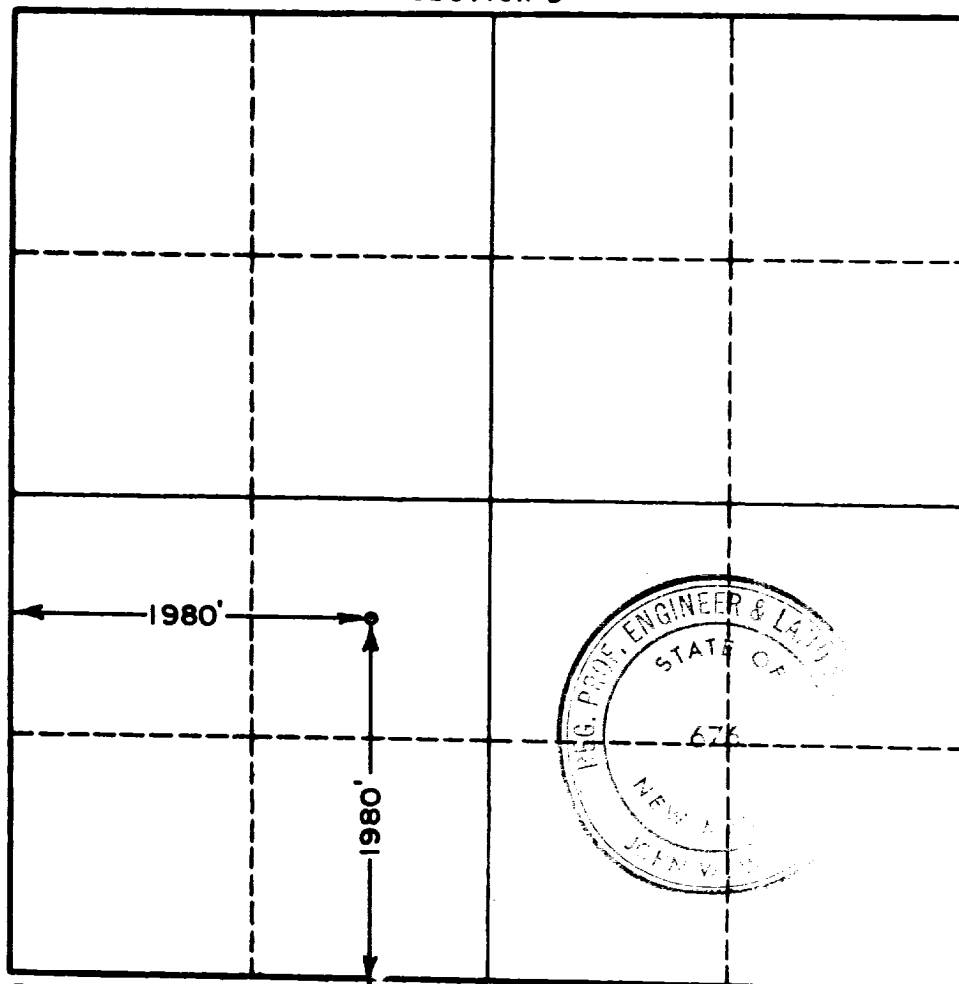

CERTIFICATION

I hereby certify that the information in SECTION A above is true and complete to the best of my knowledge and belief.

Name <b>Karl A. Peterson</b>
Position <b>Divn. Prod. Manager</b>
Company <b>Drilling &amp; Exploration Co.</b>
Date <b>October 22, 1962</b>

I hereby certify that the well location shown on the plat in SECTION B was plotted from field notes of actual surveys made by me or under my supervision, and that the same is true and correct to the best of my knowledge and belief.

Date Surveyed <b>10-19-62</b>
Registered Professional Engineer and/or Land Surveyor, <b>JOHN W. WEST</b>
Certificate No. <b>N.M. - P.E. &amp; L.S. NO. 676</b>