

NEW MEXICO
OIL CONSERVATION COMMISSION

Form C-128

~~HOLES OFFICE DEC~~
Well Location and/or Gas Proration Plat

Date 2-15-57

Operator Drilling & Exploration Co. Inc. Lease Nell Gillespie et al "A"
1957 FEB 21 PM 3:19

Well No. 1 Section 28 Township 19 S Range 34 E NMPM

Located 2310 Feet From North Line, 2310 Feet From West Line,

Lea County, New Mexico. G. L. Elevation 3704'

Name of Producing Formation _____ Pool _____ Dedicated Acreage _____

(Note: All distances must be from outer boundaries of Section)

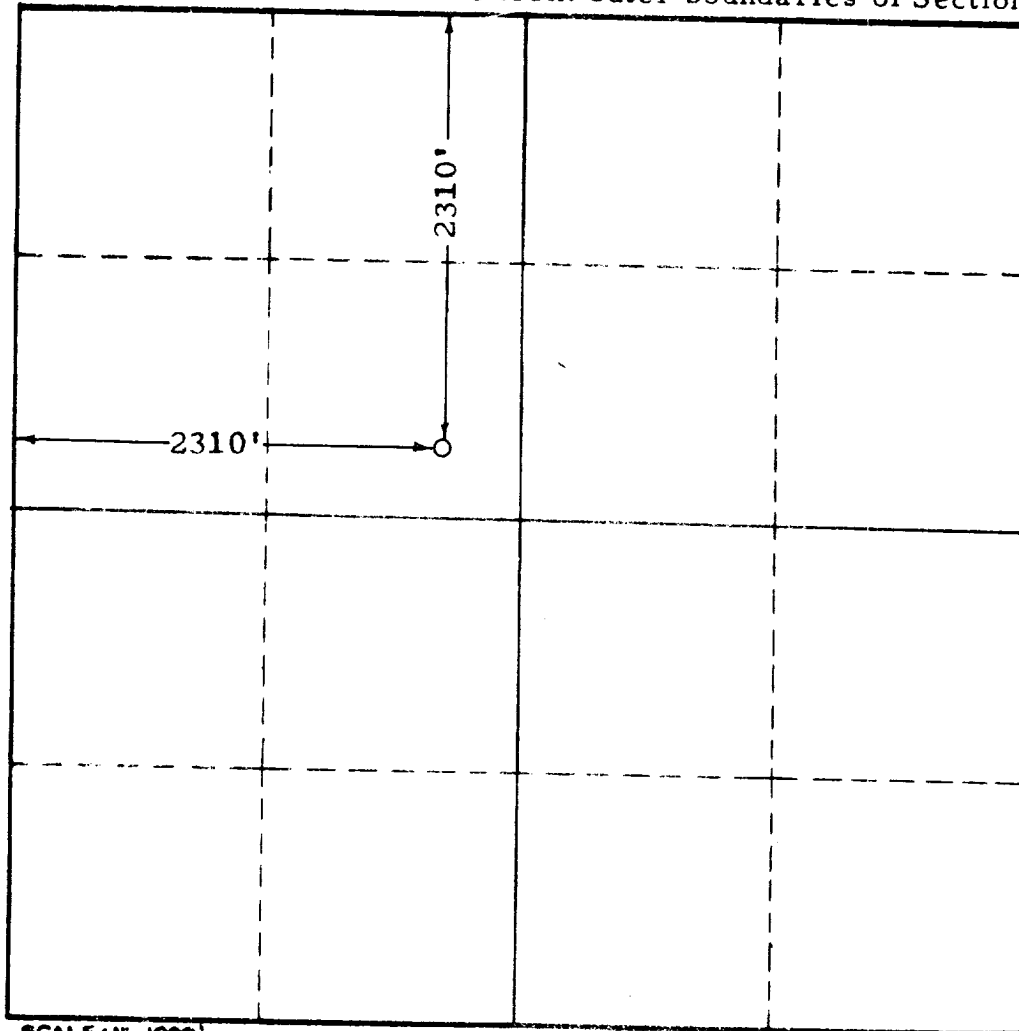

SCALE: 1" = 1000'

1. Is this Well a Dual Comp. ? Yes ___ No ___.
2. If the answer to Question 1 is yes, are there any other dually completed wells within the dedicated acreage? Yes ___ No ___.

This is to certify that the above plat was prepared from field notes of actual surveys made by me or under my supervision and that the same are true and correct to the best of my knowledge and belief.

Name _____
Position _____
Representing _____
Address _____

Date Surveyed 2-15-57
John W. West
Registered Professional Engineer and/or
Land Surveyor