

COUNTY TEA FIELD Undesignated STATE NM OWWO
 OPR SINCLAIR OIL CORP. MAP
2 Mescalero Ridge Unit DE CO-ORD
Sec. 28, T-19-S, R-34-E
660' ENL, 1980' FEL of Sec.
Re-Spd 8-23-68
Re-Cmp 10-1-68
 CSG & SX - TUBING

FORMATION	DATUM	FORMATION	DATUM
13 3/8" 880' 900			
9 5/8" 5560' 2584			
5 1/2" 13587' 360			

 LOGS EL GR RA IND HC A
 TD 13710', PBD 3970'
 TEMPORARILY ABANDONED

Distribution limited and publication prohibited by subscribers' agreement.
 Reproduction rights reserved by Williams & Lee Scouting Service, Inc.

CONT.
 DATE

PROP DEPTH 5535' TYPE WO

F.R.C. 11-21-68; OWWO
 PD 5535' - Yates
 (Orig. El Paso Nat. Gas Co., #2 Mescalero
 Ridge Unit-Federal, Cmp 1-18-62 thru perfs
 13132-148', OTE 13710', OPB 13170')
 TD 13710', PBD 3970', TEMPORARILY ABANDONED
 Cut & Pulled 5 1/2" casing @ 5000'
 PB to 4969'
 Perf (Yates) 4020-50' W/42 shots
 Swbd 94 B Salt Wtr in 6 hrs (4020-50')
 Scsd 4020-50' W/250 sx.

LEA Undesignated NM Sec. 28-19S-34E
SINCLAIR OIL CORP., #2 Mescalero Ridge Unit DE Page #2

11-18-68

Cont.

Perf (Yates) 3860-80' w/28 shots

Acid (3860-80') 500 gals.

Swbd 16 BLW & Swbd dry in 1 hr (3860-80')

Frac (3860-80') 15,000 gals brine + 30,000# sd.

Pmpd 9 BLW (1% oil) in 24 hrs (3860-80')

NEW MEXICO OIL CONSERVATION COMMISSION
WELL LOCATION AND ACREAGE DEDICATION PLAT

Form C-102
Supersedes C-128
Effective 1-1-65

All distances must be from the outer boundaries of the Section.

Operator SINCLAIR OIL & GAS COMPANY		Lease NECALERO RIDGE UNIT DE		Well No. 2
Unit Letter B	Section 28	Township 19S	Range 34E	County Lea
Actual Location of Well: 660 feet from the North line and 1980 feet from the East line				
Ground Level Elev. 3720.5	Producing Formation Yates	Pool Undesignated	Dedicated Acreage: 160 Acres	

1. Outline the acreage dedicated to the subject well by colored pencil or hachure marks on the plat below.
2. If more than one lease is dedicated to the well, outline each and identify the ownership thereof (both as to working interest and royalty).
3. If more than one lease of different ownership is dedicated to the well, have the interests of all owners been consolidated by communitization, unitization, force-pooling, etc?

☒ Yes ☐ No If answer is "yes," type of consolidation Unit Agreement

If answer is "no," list the owners and tract descriptions which have actually been consolidated. (Use reverse side of this form if necessary.) _____

No allowable will be assigned to the well until all interests have been consolidated (by communitization, unitization, forced-pooling, or otherwise) or until a non-standard unit, eliminating such interests, has been approved by the Commission.

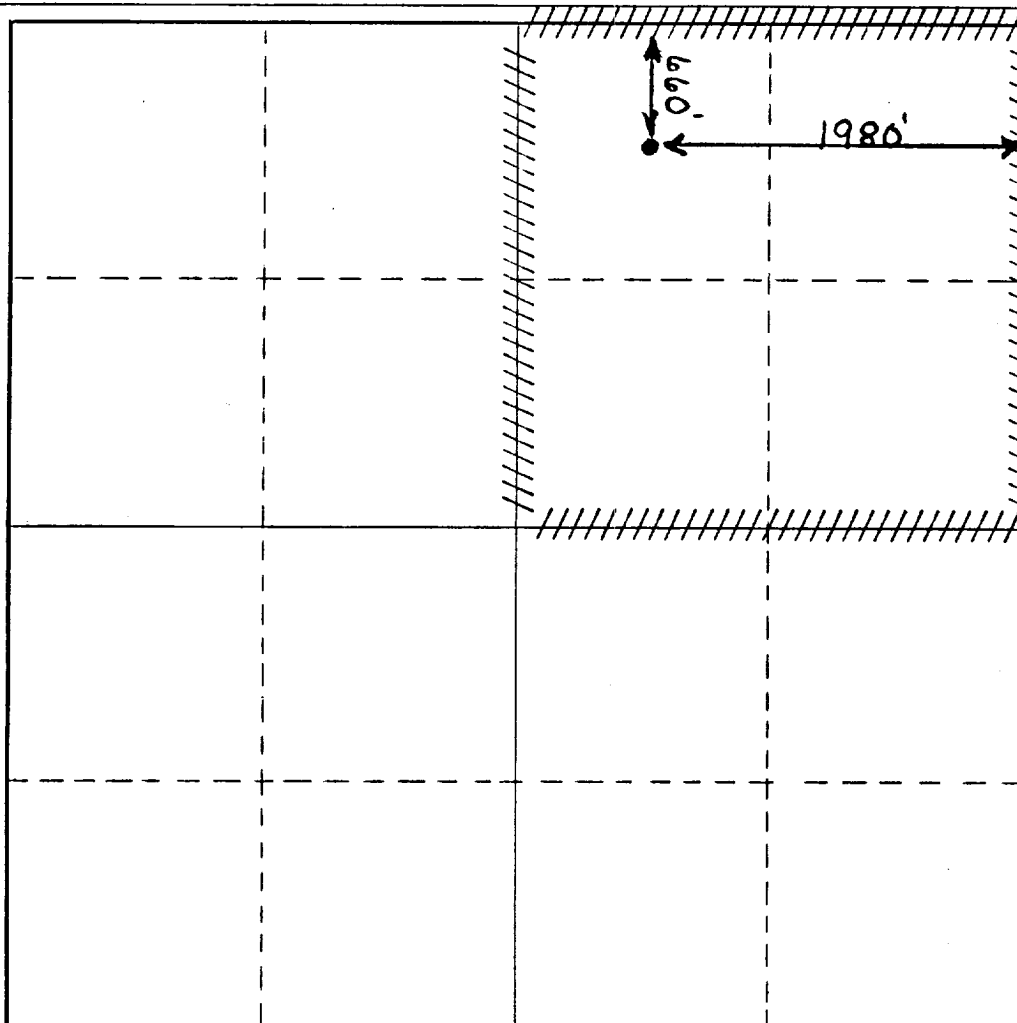

CERTIFICATION

I hereby certify that the information contained herein is true and complete to the best of my knowledge and belief.

Name

Position

Field Engineer

Company

Sinclair Oil Gas Company

Date

August 21, 1968

I hereby certify that the well location shown on this plat was plotted from field notes of actual surveys made by me or under my supervision, and that the same is true and correct to the best of my knowledge and belief.

Date Surveyed

Registered Professional Engineer
and/or Land Surveyor

Certificate No.



NEW MEXICO OIL CONSERVATION COMMISSION
Well Location and Acreage Dedication Plat

Section A.

Date **February 6, 1962**

Operator **El Paso Natural Gas Company** Lease **Mescalero Ridge Unit**
Well No. **2** Unit Letter **B** Section **28** Township **19-S** Range **34-E** NMPM
Located **660** Feet From **north** Line, **1980** Feet From **east** Line
County **Lea** G. L. Elevation **3720** Dedicated Acreage **160** Acres
Name of Producing Formation **Morrow** Pool **Wildcat - Undesignated**

1. Is the Operator the only owner* in the dedicated acreage outlined on the plat below?
Yes _____ No **X**
2. If the answer to question one is "no," have the interests of all the owners been consolidated by communitization agreement or otherwise? Yes **X** No _____. If answer is "yes," Type of Consolidation **Unit Agreement**
3. If the answer to question two is "no," list all the owners and their respective interests below:

Owner

Land Description

Section B

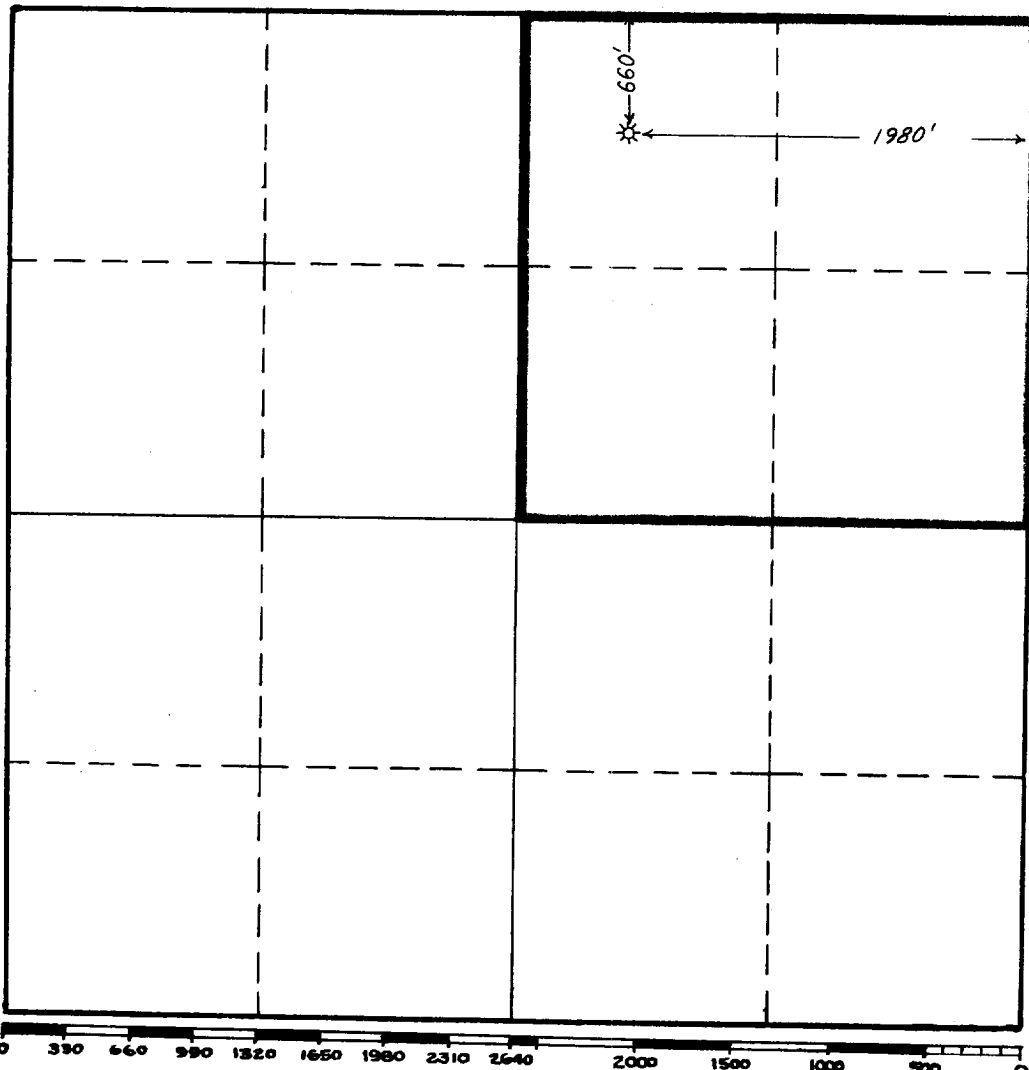

This is to certify that the information in Section A above is true and complete to the best of my knowledge and belief.

El Paso Natural Gas Company

(Operator)

D. E. Lockett

(Representative)

D. E. Lockett

2005 Wilco Bldg., Midland, Tex.

Address

This is to certify that the well location shown on the plat in Section B was plotted from field notes of actual surveys made by me or under my supervision and that the same is true and correct to the best of my knowledge and belief.

Date Surveyed **10-2-61**

Registered Professional
Engineer and/or Land Surveyor.

Certificate No. **3067**

(See instructions for completing this form on the reverse side)

INSTRUCTIONS FOR COMPLETION:

1. Operator shall furnish and certify to the information called for in Section A.
2. Operator shall outline the dedicated acreage for both oil and gas wells on the plat in Section B.
3. A registered professional engineer or land surveyor registered in the State of New Mexico or approved by the Commission shall show on the plat the location of the well and certify this information in the space provided.
4. All distances shown on the plat must be from the outer boundaries of Section.
5. If additional space is needed for listing owners and their respective interests as required in question 3, Section A, please use space below

* "Owner" means the person who has the right to drill into and to produce from any pool and to appropriate the production either for himself or for himself and another. (65-3-29 (e) NMSA 1953 Comp.)