

NEW MEXICO OIL CONSERVATION COMMISSION
Santa Fe, New Mexico

Form C-101
Revised (12/1/55)

AMENDED LOCATION
NOTICE OF INTENTION TO DRILL

Notice must be given to the District Office of the Oil Conservation Commission and approval obtained before drilling or recompletion begins. If changes in the proposed plan are considered advisable, a copy of this notice showing such changes will be returned to the sender. Submit this notice in QUINTUPLICATE. One copy will be returned following approval. See additional instructions in Rules and Regulations of the Commission. If State Land submit 6 Copies Attach Form C-128 in triplicate to first 3 copies of form C-101

Lubbock, Texas

(Place)

November 9, 1959

(Date)

OIL CONSERVATION COMMISSION
SANTA FE, NEW MEXICO

Gentlemen:

You are hereby notified that it is our intention to commence the Drilling of a well to be known as

CARTHAY LAND COMPANY

(Company or Operator)

Carthay State

(Lease)

Well No. 1, in P The well is

located 2310 feet from the North line and 1980 feet from the

West

line of Section 20, T. 17S, R. 35E, NMPM.

(GIVE LOCATION FROM SECTION LINE) Pool, Lea County

If State Land the Oil and Gas Lease is No. B-2363

If patented land the owner is

Address

We propose to drill well with drilling equipment as follows: Rotary

The status of plugging bond is In effect

Drilling Contractor Robert Travis Canon
807 Lubbock Nat'l Bank Bldg.
Lubbock, Texas

We intend to complete this well in the San Andres formation at an approximate depth of 4450 feet.

CASING PROGRAM

We propose to use the following strings of Casing and to cement them as indicated:

| Size of Hole | Size of Casing | Weight per Foot | New or Second Hand | Depth | Sacks Cement |
|--------------|----------------|-----------------|--------------------|-------|--------------|
| 12-3/4" | 8-5/8" | 224 | N | 300' | 290 |
| 7-7/8" | 5-1/2" | 140 | N | 4900' | 380 |
| | | | | | |
| | | | | | |

If changes in the above plans become advisable we will notify you immediately.

ADDITIONAL INFORMATION (If recompletion give full details of proposed plan of work.)

C-128 to follow

Approved, 19.....
Except as follows: MUST BE CEMENTED BOND

CASING.

OIL CONSERVATION COMMISSION

By

Sincerely yours,

CARTHAY LAND CO., (Robert Travis Canon, Opr.)
(Company or Operator)

By

Agent-Melan Smith

Position: Send Communications regarding well to

Robert Travis Canon

Name: 807 Lubbock Nat'l Bank Bldg. Lubbock, Tex.

Address

NEW MEXICO OIL CONSERVATION COMMISSION
WELL LOCATION AND ACREAGE DEDICATION PLAT

FORM C-128
 Revised 5/1/57

SEE INSTRUCTIONS FOR COMPLETING THIS FORM ON THE REVERSE SIDE

SECTION A

| | | | | | |
|---|--|-------------------------|---|----------------------|---------------------------------------|
| Operator Carthay Land Co. | | | Lease Carthay State | | Well No. 1 |
| Unit Letter F | Section 20 | Township 17 S | Range 35 E | County Lea | |
| Actual Footage Location of Well: 2510 feet from the N line and 1980 feet from the W line | | | | | |
| Ground Level Elev. | Producing Formation San Andres | | Pool Vacuum Vacuum | | Dedicated Acreage: 40 Acres |

1. Is the Operator the only owner in the dedicated acreage outlined on the plat below? YES ☒ NO ☐ ("Owner" means the person who has the right to drill into and to produce from any pool and to appropriate the production either for himself or for himself and another. (65-3-29 (e) NMSA 1935 Comp.)
2. If the answer to question one is "no," have the interests of all the owners been consolidated by communization agreement or otherwise? YES ☐ NO ☐ . If answer is "yes," Type of Consolidation _____
3. If the answer to question two is "no," list all the owners and their respective interests below:

| Owner | Land Description |
|-------|------------------|
| | |

SECTION B

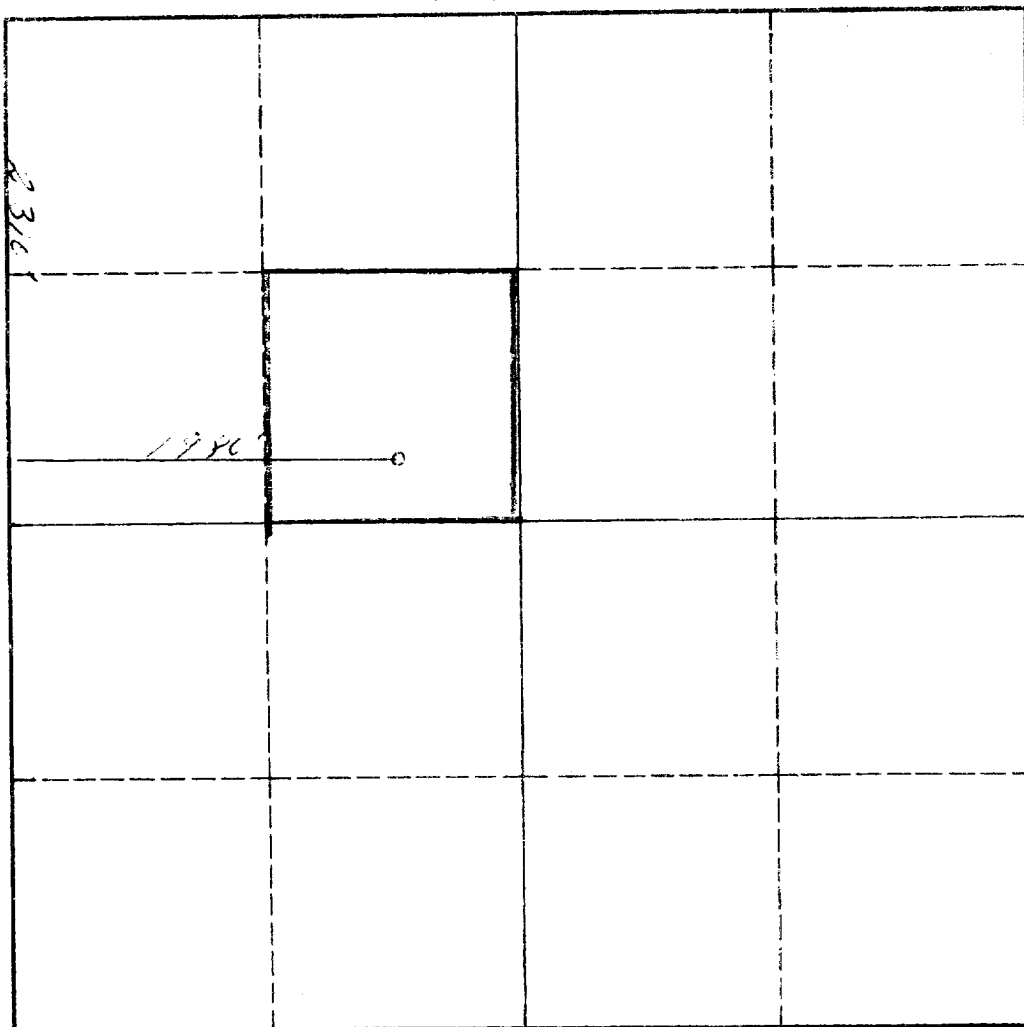

CERTIFICATION

I hereby certify that the information in SECTION A above is true and complete to the best of my knowledge and belief.

Name **D. L. ... Agent**
 Position
Carthay Land Co.
 Company

Date
11/9/59

I hereby certify that the well location shown on the plat in SECTION B was plotted from field notes of actual surveys made by me or under my supervision, and that the same is true and correct to the best of my knowledge and belief.

Date Surveyed
11/9/59
 Registered Professional Engineer
 and/or Land Surveyor

V. P. Sheldon
 Certificate No. **863**

0 330 660 990 1320 1650 1980 2310 2640 2000 1500 1000 500 0

INSTRUCTIONS FOR COMPLETION OF FORM C-128

1. Operator shall furnish and certify to the information called for in Section A.
2. Operator shall outline the dedicated acreage for *both* oil and gas wells on the plat in Section B.
3. A registered professional engineer or land surveyor registered in the State of New Mexico or approved by the Commission shall show on the plat the location of the well and certify this information in the space provided.
4. All distances shown on the plat must be from the outer boundaries of the Section.
5. If additional space is needed for listing owners and their respective interests as required in question 3 of Section A, please use space below.