

NEW MEXICO OIL CONSERVATION COMMISSION

Santa Fe, New Mexico

000-6 copies

Form C-101
Revised (12/1/55)

NOTICE OF INTENTION TO DRILL

Notice must be given to the District Office of the Oil Conservation Commission and approval obtained before drilling or recompletion begins. If changes in the proposed plan are considered advisable, a copy of this notice showing such changes will be returned to the sender. Submit this notice in **QUINTUPLICATE**. One copy will be returned following approval. See additional instructions in Rules and Regulations of the Commission. If State Land submit 6 Copies Attach Form C- 128 in triplicate to first 3 copies of form C-101

Lubbock, Texas

October 21, 1959

(Place)

(Date)

OIL CONSERVATION COMMISSION
SANTA FE, NEW MEXICO

Gentlemen:

You are hereby notified that it is our intention to commence the Drilling of a well to be known as

CARTHAY LAND COMPANY

(Company or Operator)

Carthay State

(Lease)

Well No. 2

G

The well is

(Unit)

located 1980 feet from the North line and 1980 feet from the

East

line of Section 20

T. 17S

R. 35E

1980

feet from the

(GIVE LOCATION FROM SECTION LINE)

Vacuum

Pool,

Lea

County

If State Land the Oil and Gas Lease is No. B-2388

If patented land the owner is

Address

We propose to drill well with drilling equipment as follows Rotary

The status of plugging bond is In effect

Drilling Contractor Robert Travis Canon

809 Lubbock Nat'l Bank Bldg.

Lubbock, Texas

We intend to complete this well in the San Andres

formation at an approximate depth of 4450 feet.

CASING PROGRAM

We propose to use the following strings of Casing and to cement them as indicated:

Size of Hole	Size of Casing	Weight per Foot	New or Second Hand	Depth	Sacks Cement
12-3/4"	8-5/8"	28#	N	300'	250
7-7/8"	5-1/2"	14#	N	4900'	300

If changes in the above plans become advisable we will notify you immediately.

ADDITIONAL INFORMATION (If recompletion give full details of proposed plan of work.)

C-128 attached 3 copies

Approved _____, 19____
Except as follows:

OIL CONSERVATION COMMISSION

By _____

Sincerely yours,

CARTHAY LAND COMPANY

(Company or Operator)

By Agent Robert Travis Canon, Opr.

Position _____ Send Communications regarding well to

Name 809 Lubbock Nat'l Bank Bldg., Lubbock, Texas

Address _____

NEW MEXICO OIL CONSERVATION COMMISSION

Well Location and Acreage Dedication Plat

NOBBS OFFICE 0000 E 000
Date October 21, 1959

Section A.

Operator Carthay Land Co. Lease Carthay 1930 No. 20
Well No. 2 Unit Letter G Section 20 Township 17 S Range 35 E NMPM
Located 775 1980 Feet From N Line, 1930 Feet From E Line
County Lea G. L. Elevation _____ Dedicated Acreage 40 Acres
Name of Producing Formation San Andres Pool Vacuum

1. Is the Operator the only owner* in the dedicated acreage outlined on the plat below?
Yes X No _____.
2. If the answer to question one is "no," have the interests of all the owners been consolidated by communitization agreement or otherwise? Yes _____ No _____. If answer is "yes," Type of Consolidation _____
3. If the answer to question two is "no," list all the owners and their respective interests below:

Owner

Land Description

Section B

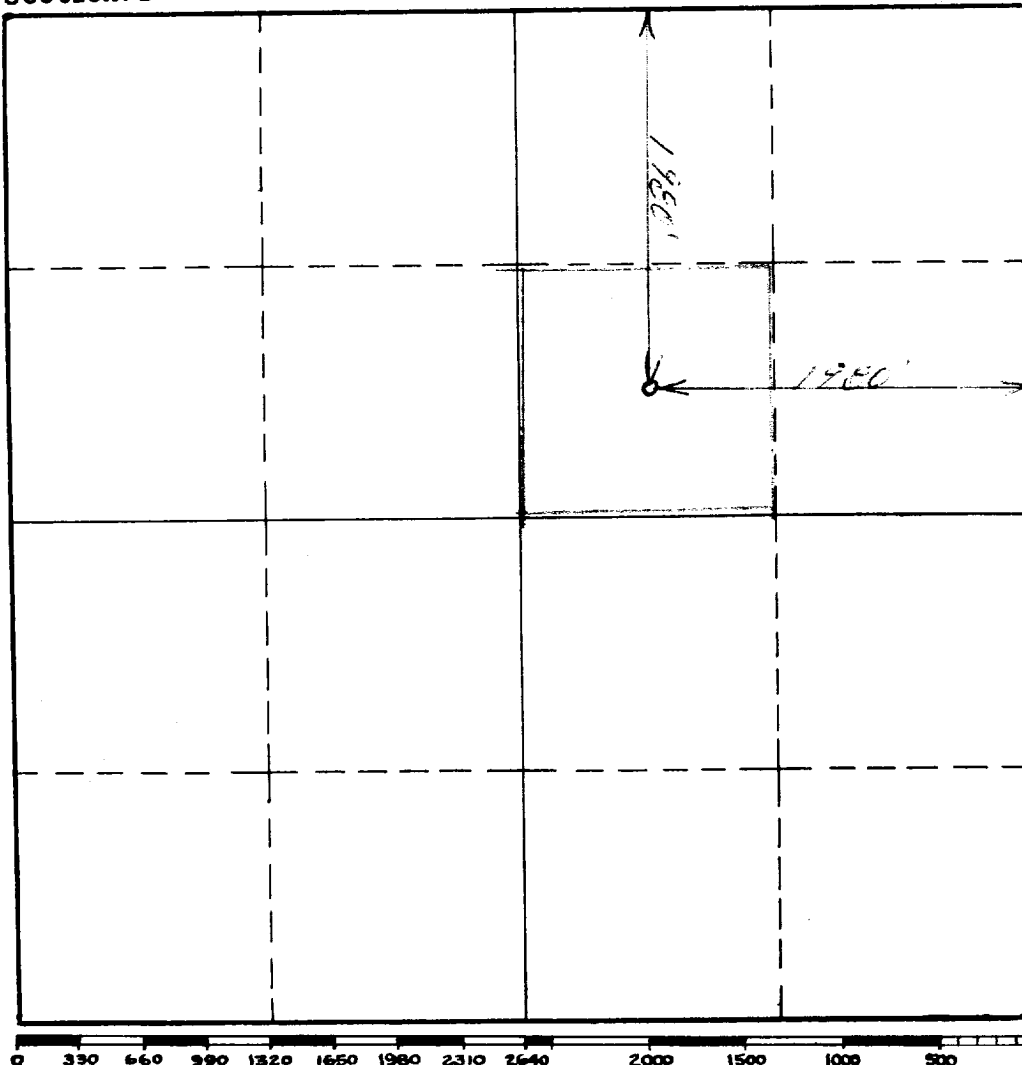

This is to certify that the information in Section A above is true and complete to the best of my knowledge and belief.

Carthay Land Co.

(Operator)

G. L. Frymer
(Representative)

Lubbock, Texas

Address

This is to certify that the well location shown on the plat in Section B was plotted from field notes of actual surveys made by me or under my supervision and that the same is true and correct to the best of my knowledge and belief.

Date Surveyed 10/21/59

W. P. Sheldon
Registered Professional
Engineer and/or Land Surveyor.

Certificate No. 963

(See instructions for completing this form on the reverse side)

INSTRUCTIONS FOR COMPLETION:

1. Operator shall furnish and certify to the information called for in Section A.
2. Operator shall outline the dedicated acreage for both oil and gas wells on the plat in Section B.
3. A registered professional engineer or land surveyor registered in the State of New Mexico or approved by the Commission shall show on the plat the location of the well and certify this information in the space provided.
4. All distances shown on the plat must be from the outer boundaries of Section.
5. If additional space is needed for listing owners and their respective interests as required in question 3, Section A, please use space below

*Corrected by
L. J. Ford*

* "Owner" means the person who has the right to drill into and to produce from any pool and to appropriate the production either for himself or for himself and another. (65-3-29 (e) NMSA 1953 Comp.)