

NEW MEXICO OIL CONSERVATION COMMISSION
Santa Fe, New Mexico

NOTICE OF INTENTION TO DRILL

Notice must be given to the District Office of the Oil Conservation Commission and approval obtained before drilling or recompletion begins. If changes in the proposed plan are considered advisable, a copy of this notice showing such changes will be returned to the sender. Submit this notice in QUINTUPPLICATE. One copy will be returned following approval. See additional instructions in Rules and Regulations of the Commission. If State Land submit 6 Copies Attach Form G-128 in triplicate to first 3 copies of Form G-101

Midland, Texas

(Place)

December 9, 1957

(Date)

OIL CONSERVATION COMMISSION
SANTA FE, NEW MEXICO

Gentlemen:

You are hereby notified that it is our intention to commence the Drilling of a well to be known as

Zapata Drilling Company

(Company or Operator)

Adams & Peterson Shell State

(Lease)

Well No. 1

in 0

(Unit)

The well is

located 660 feet from the South line and 1960 feet from the East

(GIVE LOCATION FROM SECTION LINE)

line of Section 23, T 17-S, R 35-E, NMPM.

Vacuum

Pool,

Lea

County

If State Land the Oil and Gas Lease is No. B-1398

If patented land the owner is -

Address

We propose to drill well with drilling equipment as follows:

Brewster N-45

The status of plugging bond is Applied for - will be deposited with O.C.C. Santa Fe, New Mexico immediately.

Drilling Contractor

Zapata Drilling Company

Box 2216, Midland, Texas

We intend to complete this well in the Grayburg-San Andres

formation at an approximate depth of 4800 feet.

CASING PROGRAM

We propose to use the following strings of Casing and to cement them as indicated:

Size of Hole	Size of Casing	Weight per Foot	New or Second Hand	Depth	Sacks Cement
12-1/4"	8-5/8	24#	New	350	175
7-7/8"	5-1/2	15.5#	New	4800	175

If changes in the above plans become advisable we will notify you immediately.

ADDITIONAL INFORMATION (If recompletion give full details of proposed plan of work.)

DEC 11 1957

Approved _____, 19____
Except as follows:

Sincerely yours,

Zapata Drilling Company

(Company or Operator)

By M. E. Volitz

Position President

Send Communications regarding well to

Name Zapata Drilling Company

Address Box 2216, Midland, Texas

OIL CONSERVATION COMMISSION

By E. J. Fischer

Engineer District 1

NEW MEXICO OIL CONSERVATION COMMISSION
Well Location and Acreage Dedication Plat

Revised 5/1/57
DUPLICATE
OFFICE DEC
Date December 5, 1957

Section A.

Operator ZAPATA DRILLING COMPANY Lease Adams & Peterson Shell State 35
Well No. 1 Unit Letter 0 Section 23 Township 17 South Range 35 East NMFM
Located 660 Feet From South Line, 1980 Feet From East Line
County Lea G. L. Elevation 3918 Dedicated Acreage 40 Acres
Name of Producing Formation Grayburg - San Andres Pool Vacuum

1. Is the Operator the only owner* in the dedicated acreage outlined on the plat below?
Yes x No .
2. If the answer to question one is "no," have the interests of all the owners been consolidated by communitization agreement or otherwise? Yes No . If answer is "yes," Type of Consolidation
3. If the answer to question two is "no," list all the owners and their respective interests below:

OwnerLand Description

Section B

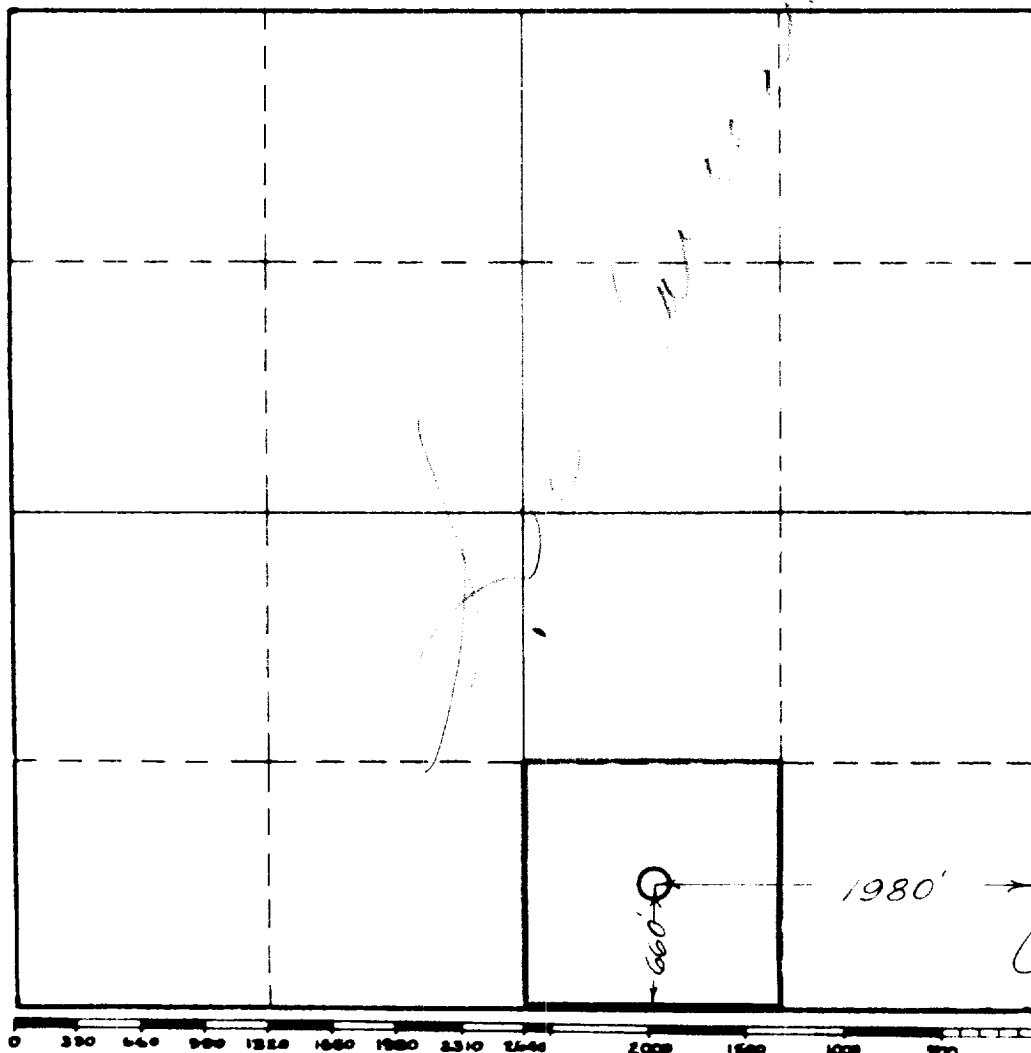

This is to certify that the information in Section A above is true and complete to the best of my knowledge and belief.

Zapata Drilling Company
(Operator)

M. R. VORSE
(Representative)

Box 2216, Midland, Texas
Address

This is to certify that the well location shown on the plat in Section B was plotted from field notes of actual surveys made by me or under my supervision and that the same is true and correct to the best of my knowledge and belief.

Date Surveyed Dec. 5, 1957

John W. Shearn
Registered Professional
Engineer and/or Land Surveyor.

Certificate No. 1559

(See instructions for completing this form on the reverse side)