

NOTICE OF INTENTION TO DRILL

Notice must be given to the District Office of the Oil Conservation Commission and approval obtained before drilling or recompletion begins. If changes in the proposed plan are considered advisable, a copy of this notice showing such changes will be returned to the sender. Submit this notice in QUINTUPLICATE. One copy will be returned following approval. See additional instructions in Rules and Regulations of the Commission. If State Land submit 6 Copies Attach Form C-128 in triplicate to first 3 copies of form C-101

Roswell, New Mexico

July 14, 1960

(Place)

(Date)

OIL CONSERVATION COMMISSION  
SANTA FE, NEW MEXICO

Gentlemen:

You are hereby notified that it is our intention to commence the Drilling of a well to be known as

Shell Oil Company

(Company or Operator)

State I

Well No. 2

E

(Unit)

located 2310 feet from the north line and 130 feet from the

west

line of Section 29, T. 17S, R. 35E, NMPM.

(GIVE LOCATION FROM SECTION LINE)

Vacuum

Pool,

Lee

County

R-35-E

If State Land the Oil and Gas Lease is No. B-2423

If patented land the owner is -

Address -

We propose to drill well with drilling equipment as follows: Rotary Tools

The status of plugging bond is Blanket

Drilling Contractor undetermined

We intend to complete this well in the Grayburg-San Andres

formation at an approximate depth of 4730 feet.

CASING PROGRAM

We propose to use the following strings of Casing and to cement them as indicated:

Size of Hole	Size of Casing	Weight per Foot	New or Second Hand	Depth	Sacks Cement
11"	8 5/8"	32#	new	300'	300
7 7/8"	5 1/2"	15.5#	new	4730'	200

If changes in the above plans become advisable we will notify you immediately.

ADDITIONAL INFORMATION (If recompletion give full details of proposed plan of work.)

JUL 16 1960

Approved \_\_\_\_\_, 19\_\_\_\_\_  
Except as follows:

OIL CONSERVATION COMMISSION

By Leslie A. Clements

Oil & Gas Inspector

Sincerely yours,

Shell Oil Company

(Company or Operator) Original Signed By

By R. A. Lowery R. A. LOWERY

Position District Exploitation Engineer

Send Communications regarding well to

Name Shell Oil Company

Address Box 845, Roswell, New Mexico

NEW MEXICO OIL CONSERVATION COMMISSION  
WELL LOCATION AND ACREAGE DEDICATION PLAT

FORM C-128  
Revised 5/1/57

SEE INSTRUCTIONS FOR COMPLETING THIS FORM ON THE REVERSE SIDE

SECTION A

Operator <b>Shell Oil Company</b>		Lease <b>State I</b>		Well No. <b>9 31 2</b>
Unit Letter <b>E</b>	Section <b>29</b>	Township <b>17S</b>	Range <b>35E</b>	County <b>Lea</b>
Actual Footage Location of Well: <b>2310</b> feet from the <b>north</b> line and <b>330</b> feet from the <b>west</b> line				
Ground Level Elev. <b>not available</b>	Producing Formation <b>Grayburg-San Andres</b>		Pool <b>Vacuum</b>	Dedicated Acreage: <b>40</b> Acres

1. Is the Operator the only owner in the dedicated acreage outlined on the plat below? YES ☒ NO ☐ . ("Owner" means the person who has the right to drill into and to produce from any pool and to appropriate the production either for himself or for himself and another. (65-3-29 (e) NMSA 1935 Comp.)
2. If the answer to question one is "no," have the interests of all the owners been consolidated by communitization agreement or otherwise? YES ☐ NO ☐ . If answer is "yes," Type of Consolidation \_\_\_\_\_
3. If the answer to question two is "no," list all the owners and their respective interests below:

Owner	Land Description

SECTION B

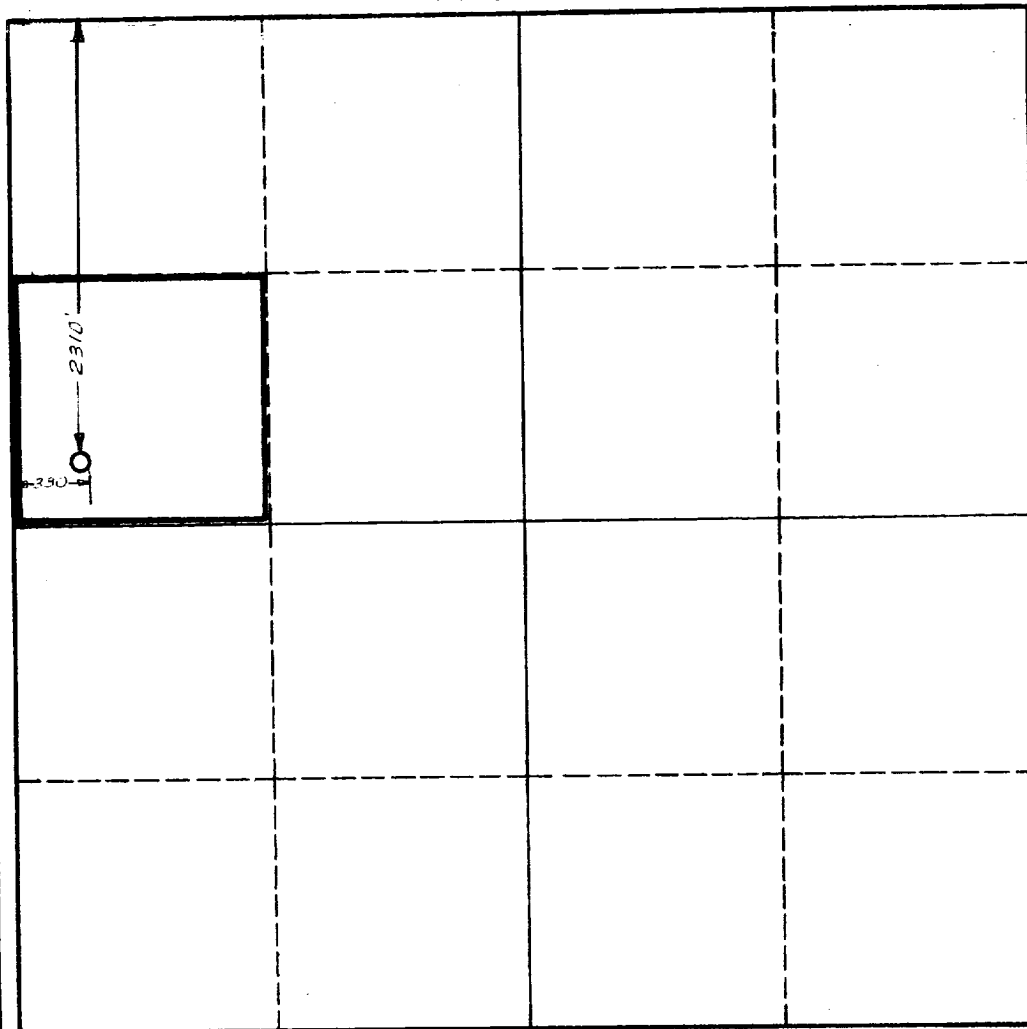

CERTIFICATION

I hereby certify that the information in SECTION A above is true and complete to the best of my knowledge and belief.

Name <b>R. A. Lowery</b>	Original Signed By <b>R. A. LOWERY</b>
Position <b>District Exploitation Engineer</b>	
Company <b>Shell Oil Company</b>	
Date <b>July 14, 1960</b>	

I hereby certify that the well location shown on the plat in SECTION B was plotted from field notes of actual surveys made by me or under my supervision, and that the same is true and correct to the best of my knowledge and belief.

Date Surveyed <b>July 13, 1960</b>
Registered Professional Engineer and/or Land Surveyor <b>S. S. Ball and</b>

Certificate No. **3068**

0 330 660 990 1320 1650 1980 2310 2640 2000 1500 1000 500 0

### INSTRUCTIONS FOR COMPLETION OF FORM C-128

1. Operator shall furnish and certify to the information called for in Section A.
2. Operator shall outline the dedicated acreage for *both* oil and gas wells on the plat in Section B.
3. A registered professional engineer or land surveyor registered in the State of New Mexico or approved by the Commission shall show on the plat the location of the well and certify this information in the space provided.
4. All distances shown on the plat must be from the outer boundaries of the Section.
5. If additional space is needed for listing owners and their respective interests as required in question 3 of Section A, please use space below.