

NEW MEXICO OIL CONSERVATION COMMISSION
WELL LOCATION AND ACREAGE DEDICATION PLAT

FORM C-128
Revised 5/1/57

SEE INSTRUCTIONS FOR COMPLETING THIS FORM ON THE REVERSE SIDE

SECTION A

1962 SEP 4 AM 10

W.D. No. 4

Operator

CABOT CORPORATION

Lease

STATE I

Unit Letter
E

Section
23

Township
19 SOUTH

Range
35 EAST

County
LEA

Actual Footage Location of Well:

1650 feet from the NORTH line and 990 feet from the WEST line

Ground Level Elev.

3763.44

Producing Formation

Queen Sand

Pool

Pearl Queen

Dedicated Acreage:

40 Acres

1. Is the Operator the only owner in the dedicated acreage outlined on the plat below? YES ☒ NO ____ . ("Owner" means the person who has the right to drill into and to produce from any pool and to appropriate the production either for himself or for himself and another. (65-3-29 (e) NMSA 1935 Comp.)
2. If the answer to question one is "no," have the interests of all the owners been consolidated by communitization agreement or otherwise? YES ____ NO ____ . If answer is "yes," Type of Consolidation ____
3. If the answer to question two is "no," list all the owners and their respective interests below:

Owner

Cabot Corporation

Land Description

SW/4 of the NW/4 of Section 23, T-19-S,
R-35-E, Lea County, New Mexico

Box 4395, Midland, Texas

SECTION B

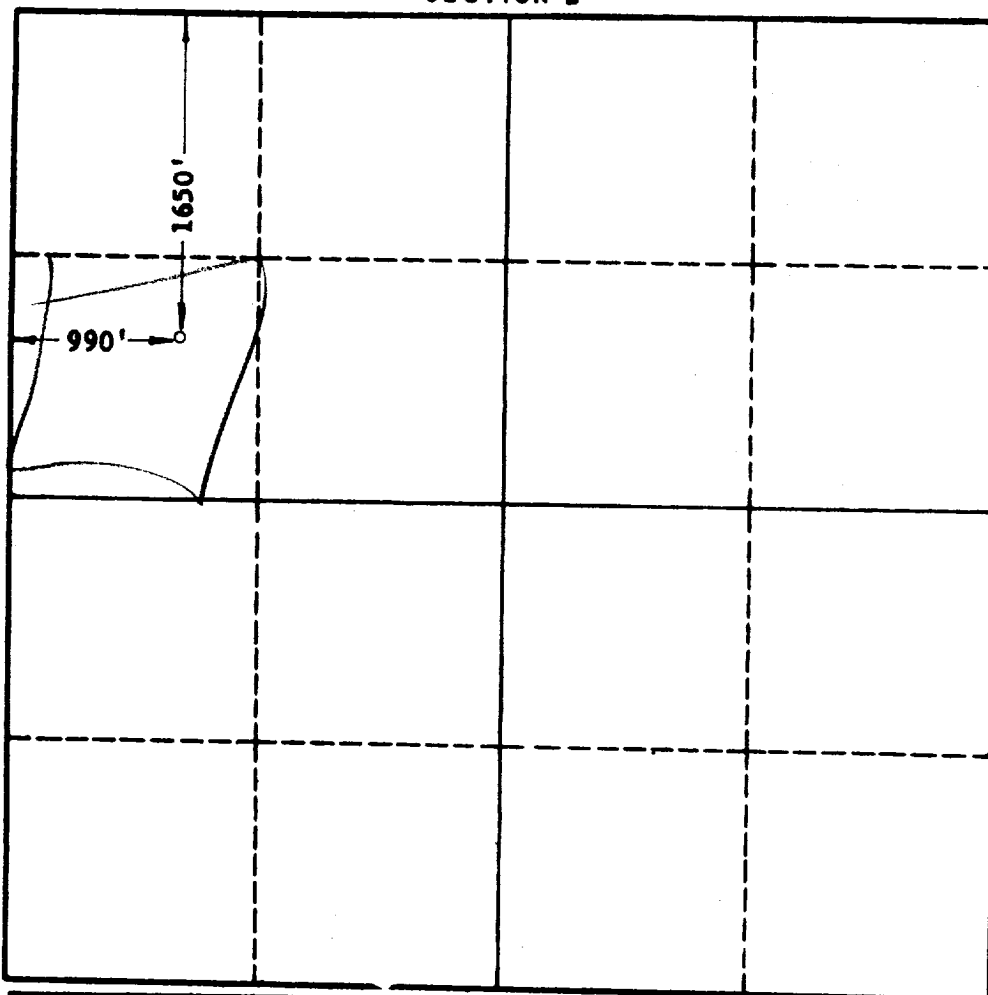

CERTIFICATION

I hereby certify that the information in SECTION A above is true and complete to the best of my knowledge and belief.

Name

Percy C. Givins

Position

Dist. Prod. Sup't.

Company

Cabot Corporation

Date

September 4, 1962

I hereby certify that the well location shown on the plat in SECTION B was plotted from field notes of actual surveys made by me or under my supervision, and that the same is true and correct to the best of my knowledge and belief.

Date Surveyed

9-1-62

Registered Professional Engineer

and/or Land Surveyor, JOHN M. WEST

Certificate No.

N. M. - P. E. & L. S. NO. 676