

NUMBER OF COPIES RECEIVED	
DISTRIBUTION	
SANTA FE	
FILE	
U.S. S	
LAND OFFICE	
TRANSPORTER	OIL GAS
PROBATION OFFICE	
OPERATOR	

NEW MEXICO OIL CONSERVATION COMMISSION
Santa Fe, New Mexico

Form C-101
Revised (12/1/55)

HOBBS OFFICE OCC
JUN 15 1962

NOTICE OF INTENTION TO DRILL

Notice must be given to the District Office of the Oil Conservation Commission and approval obtained before drilling or recompletion begins. If changes in the proposed plan are considered advisable, a copy of this notice showing such changes will be returned to the sender. Submit this notice in QUINTUPLICATE. One copy will be returned following approval. See additional instructions in Rules and Regulations of the Commission.

If State Land submit 6 Copies Attach Form C-128 in triplicate to first 3 copies of Form C-101

Hobbs, New Mexico
(Place)

June 11, 1962
(Date)

OIL CONSERVATION COMMISSION
SANTA FE, NEW MEXICO

Gentlemen:

You are hereby notified that it is our intention to commence the Drilling of a well to be known as

Earl G. Colton

(Company, or Operator)

Tenneco Hamon
(Lease)

, Well No. 2, in G The well is

located 1980 feet from the North line and 2310 feet from the

East line of Section 23, T. 19 S, R. 35 E, NMPM.

(GIVE LOCATION FROM SECTION LINE) Pearl Queen Pool, Lea County

If State Land the Oil and Gas Lease is No.

If patented land the owner is H. S. Record Estate

Address Monument, New Mexico

We propose to drill well with drilling equipment as follows: Rotary

The status of plugging bond is Blanket

Drilling Contractor

We intend to complete this well in the Queen formation at an approximate depth of 5100 feet.

CASING PROGRAM

We propose to use the following strings of Casing and to cement them as indicated:

Size of Hole	Size of Casing	Weight per Foot	New or Second Hand	Depth	Sacks Cement
11	8 5/8	24#	New	120	Circ
7 7/8	4 1/2	9.5#	New	5100	200

If changes in the above plans become advisable we will notify you immediately.

ADDITIONAL INFORMATION (If recompletion give full details of proposed plan of work.)

Approved....., 19.....
Except as follows:

Sincerely yours,

Earl G. Colton

(Company or Operator)

By

Position Agent

Send Communications regarding well to

Name Earl G. Colton

Address % OIL REPORTS & GAS SERVICES

BOX 763 HOBBS, NEW MEXICO

OIL CONSERVATION COMMISSION

NEW MEXICO OIL CONSERVATION COMMISSION
WELL LOCATION AND ACREAGE DEDICATION PLAT

FORM C-128
Revised 5/1/57
HOBBS OFFICE OCC

SEE INSTRUCTIONS FOR COMPLETING THIS FORM ON THE REVERSE SIDE

SECTION A

Operator EARL G. COLTON		Lease TEXACO HAMON		Well No. 2
Unit Letter G	Section 23	Township 19 SOUTH	Range 35 EAST	County LEA COUNTY
Actual Footage Location of Well: 1980 feet from the NORTH line and 2310 feet from the EAST line				
Ground Level Elev. 3774.3	Producing Formation Queen		Pool Pearl Queen	Dedicated Acreage: 40 Acres

1. Is the Operator the only owner in the dedicated acreage outlined on the plat below? YES ☒ NO ☐ ("Owner" means the person who has the right to drill into and to produce from any pool and to appropriate the production either for himself or for himself and another. (65-3-29 (e) NMSA 1955 Comp.)
2. If the answer to question one is "no," have the interests of all the owners been consolidated by communitization agreement or otherwise? YES ☐ NO ☐ If answer is "yes," Type of Consolidation _____
3. If the answer to question two is "no," list all the owners and their respective interests below:

Owner	Land Description

SECTION B

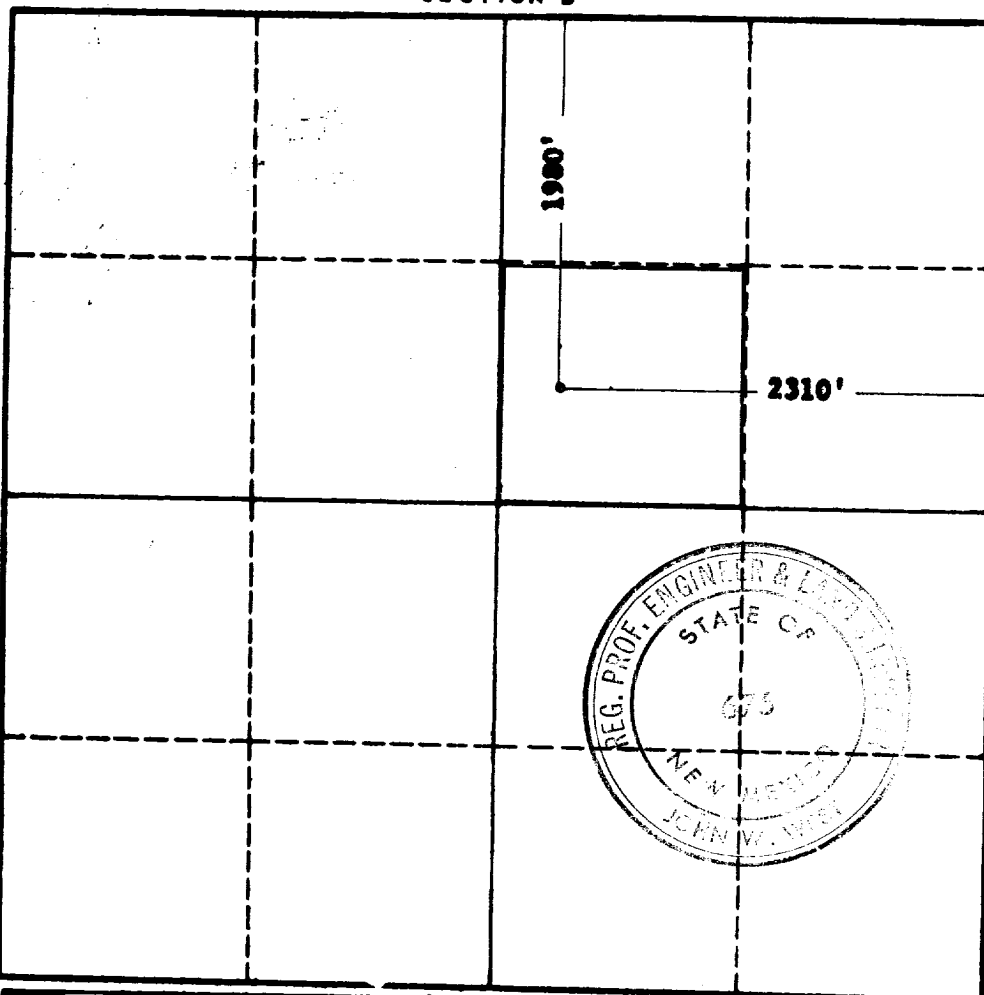

CERTIFICATION

I hereby certify that the information in SECTION A above is true and complete to the best of my knowledge and belief.

Name
A. L. Smith
Position
Agent
Company
Earl G. Colton
Date
June 11, 1962

I hereby certify that the well location shown on the plat in SECTION B was plotted from field notes of actual surveys made by me or under my supervision, and that the same is true and correct to the best of my knowledge and belief.

Date Surveyed
6-6-62
Registered Professional Engineer and/or Land Surveyor, **JOHN W. WEST**
Certificate No.
N.M. - P.E. & L.S. NO. 676

0 330 660 990 1320 1650 1980 2310 2640 2000 1500 1000 500 0